

LEGISLATIVE REFERENCE LIBRARY



3 0307 00015 3109

Watsonwan

Blue Earth

Waseca

Martin

Faribault

region nine development commission

841091

annual report - fy '84

HT
393
.M62
R46x
1984

P.O. BOX 3367 / PHONE 507 387-5643 / MANKATO, MINNESOTA 56001

Pursuant to Mn Stat 462.393

rmc

annual report - fy '84



region nine development commission

My first year as Chairman of the Region Nine Development Commission has been a challenging one. I have become better acquainted with the variety of programs the Commission is involved with and have seen first hand some of the problems our communities face. The opportunity to meet with regional representatives from around Minnesota and from other states has presented to me a broader view of some of our local concerns.

If one impression stands out, it is that continuous discussion of ideas and solutions is the best way to begin getting things done. There are few really new problems confronting units of government, just different parts of the same old problem: maintaining and improving services to our communities and at the same time facing difficult financial times.

I believe that problems are more easily solved through cooperative efforts between those concerned - and I see the Region Nine Development Commission and its staff as the logical catalyst for that cooperation. The process is in place and appears to be improving with increased use.

I look forward to my second year as Chairman with enthusiasm and I am counting on the active involvement of each Commission member in next year's efforts.

James E. Stangler

James Stangler, Chairman
Region Nine Development Commission



region nine development commission

This year has been an interesting period in the evolution of the Region Nine Development Commission.

After several years of little or no staff turnover, we experienced some major changes in our staff. Opportunities seemed to open up for a number of staff people to improve their earnings and responsibilities. We wish them the very best and express our appreciation to them for the fine work they did for us while they were on our staff. While staff turnover has called for adjustments, we have been able to obtain the services of very well qualified persons to fill those positions, so our capability to deliver a quality program has not been interrupted.

Quality programs should be expected of us by the local units of government we work for. We continue to emphasize to all those we work with that quality is one of the major assets we have to offer them.

As you read this report you will see that some new programs have been initiated and other programs remain the same. The capacity of the Region to adopt changes in programs to meet local needs is a continuing goal.

Economic Development continues to increase in importance and the Emergency Medical Services programs is off to a good start. Other programs continue to improve with experience.

We are here to serve so if you feel we can be of assistance to you please call our office.

Terence Stone

Terence Stone
Executive Director
Region Nine Development
Commission

INTRODUCTION TO REGION NINE AND THE REGION NINE DEVELOPMENT COMMISSION

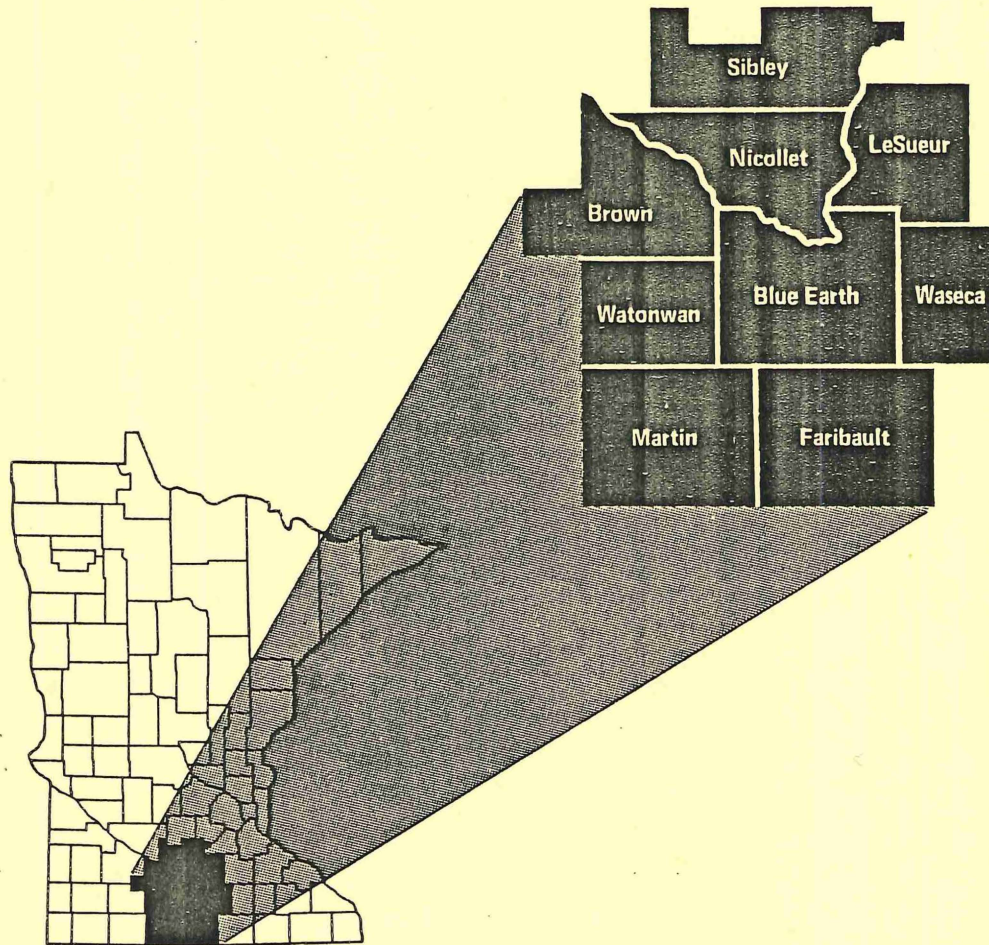

In 1972 the Region Nine Development Commission (RNDC) was organized by local elected officials as authorized by the Regional Development Act of 1969. Its purpose according to the legislation is "to facilitate intergovernmental cooperation and to insure the orderly and harmonious coordination of state, federal and local comprehensive planning and development programs for the solution of economic, social, physical and governmental problems of the state and its citizens." (Minnesota Statutes, Section 462.383; Subdivision 2.)

The nine counties that make up the Region Nine area, specifically Blue Earth, Brown, Faribault, LeSueur, Martin, Nicollet, Sibley, Waseca and Watonwan have a population of 204,010 of the state's 4,075,970 persons according to the 1980 census. The area is stable and prosperous with a strong economy, good facilities and services and has three major cities over 10,000 population, Mankato, New Ulm and Fairmont.

Serving on the RNDC are elected officials who represent 9 counties, 72 cities, 147 townships, 45 school districts, 9 soil and water conservation districts and the Minnesota Valley Council of Governments. They are joined by a representative of business and industry in the region.

The 35 member RNDC meets monthly to respond to the need for counties, cities, townships, school districts and other groups to work together on a regional basis to address economic, social, physical and environmental problems. About 300 citizens of Region Nine are actively involved in regional planning as advisory council, committee and subcommission members. Each year since 1972 has noted an increase in citizen and elected official participation as more people discover how they can best assist with the planning programs and be served by the RNDC.

With its many planning functions, the RNDC has a professional planning staff to assist itself, subcommissions and committees in carrying out the activities they have defined. The staff consists of the executive director, deputy director and specialists in the fields of recreation, land use, community/economic development, housing, transportation, water quality, energy, solid/hazardous waste, cable television, aging, arts and developmental disabilities. They are assisted by an accountant, a public information coordinator, a bookkeeper, secretaries, a graphics coordinator and interns.

July

1984

SUN	MON	TUE	WED	THU	FRI	SAT
1	2	3	4 INDEPENDENCE DAY	5	6	7
8	9	10 Human Resource Subcommission - 9:30	11 RNDC Bd. - 4:00 Full Commission Annual Mtg. - 7:15 Phys. Dev. Subcomm. - 2:30 (as needed)	12 EMS Critical Care Subcomm. - 7:00	13	14 NACO Annual Conf. - Seattle, WA -----
15	16	17	18	19 EMS Advisory Committee - 7:00	20	21
22	23 Minnesota Municipal Clerks Institute - St. Paul -----	24 Computer Symposium for Local Government - Bloomington -----	25 Area Agency on Aging Advisory Council - 9:30 Arts Advisory Council - 7:00 -----	26 EMS Joint Powers Board - 7:30 -----	27	28
29	30	31				

Organizational Chart

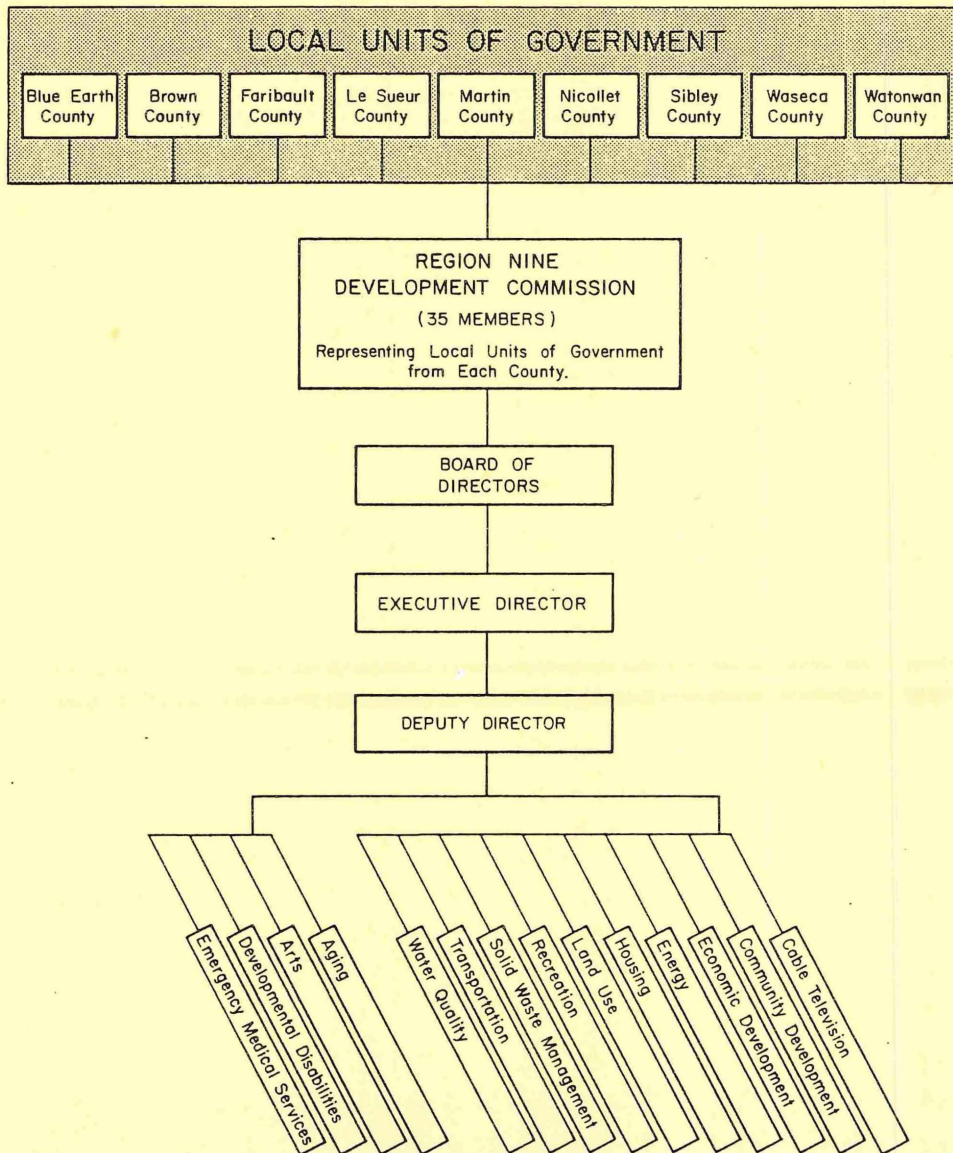

Internal Works Committees

POLICY AND PROCEDURES REVIEW

LESTER ANDERSON
JACK FITZSIMMONS
STEVAN ZOELLER

COMPREHENSIVE PLANNING

KENNETH ALBRECHT
LESTER ANDERSON
ROBERT BARRETT
RAY ECKES
PAUL HADLEY
LARRY LLOYD
ALLAN SIGAFUS

BY-LAWS

LESTER ANDERSON
DOUG PYAN

PERSONNEL

KENNETH ALBRECHT
ORVILLE HANSON
CARRIE HUFFER
ELMER KADING
HAROLD WIEST
CARL WYCZAWSKI

BUDGET

KENNETH ALBRECHT
LESTER ANDERSON
JACK FITZSIMMONS
ROBERT GUSTAFSON
BABE MILLER
DOUG PYAN
ROLAND THIESSE
HAROLD WIEST
CARL WYCZAWSKI
STEVAN ZOELLER

12372 REVIEW

HERBERT MOCOL
KATY OLSON
CARL WYCZAWSKI

BOARD OF DIRECTORS

KENNETH ALBRECHT
ELDO BRANDENBERG
ROBERT GUSTAFSON
ELMER KADING
HERBERT MOCOL
ROGER OLDFATHER
ADLOR OLSEN
KATY OLSON
JEROME SCHLEIS
ERHART STANKE
VIRGIL WELLNER

August

1984

SUN	MON	TUE	WED	THU	FRI	SAT
			Transportation Comm. - 7:00 (as needed) 1 EMS Radio Communi- cations Subcomm.- 7:00 AMC District Mtg. No. Mankato Happy Chef	2	3	4
5	6	7	RNDC Bd. - 4:00 8 Full Commission Mtg. - 7:15 Phys. Dev. Subcomm. - 2:30 (as needed)	EMS Critical Care Subcomm. - 7:00 9	10	11
12	Developmental Disabilities Advisory Council - 1:30 13	Human Resource Subcommission - 9:30 14	15	EMS Advisory Committee - 7:00 16	AMC Policy Committee Mtg. 17	18
19	20	21	Area Agency on Aging Advisory Council - 9:30 22 Arts Advisory Council - 7:00	EMS Joint Powers Board - 7:30 23	24	25
26	27	28	29	30	31	

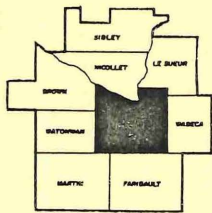

Blue Earth County

Senior Citizens Health Screening Clinics - \$12,177

Lutheran Social Services Share-A-Home and Housing Advocacy Project - \$18,061

Mankato Lutheran Home Adult Day Care Project - \$21,439

Mapleton Senior Center - \$20,522

Mankato Senior Center - \$2,647

Mankato Senior Center Self-Help Project - \$1,500

Mapleton Senior Center Self-Help Project - \$675

Minnesota Valley Chorale - \$2,000

Mankato Youth Symphony Orchestra - \$1,500

Leisure Education for Exceptional People (arts grant) - \$1,360

Mankato Ballet Company - \$1,300

Mankato Symphony Orchestra - \$3,000

Minnesota Valley Regional Library - \$500

Mankato Area Arts Council - \$1,814

Mankato Symphony Orchestra (McKnight arts grant) - \$6,000

Mankato Area Arts Council (McKnight arts grant) - \$46

Amboy - Community needs assessment

Lake Crystal - Market study for FmHA 515 Loan Program

Mapleton - Prepared and processed 503 Loan for Dietz Super Valu

Mankato - Prepared and processed 503 Loan for Mathes Printing

Blue Earth County - Completed LAWCON/LCMR grant application

Provided technical assistance to Highway 169 Improvement Association

Good Thunder - Small Cities Development Grant application

Blue Earth County - Participated in development of Economic Development Grant program

Amboy meeting on Blue Earth County grant

Mankato - Prepared and processed loan for Brakke-Snell Auto Dealership

Provided extensive technical assistance to Leisure Education for Exceptional People (LEEP)

Attended Agri-Business and Industry Development group

Wage Survey of Blue Earth County City Employees, 1983

Vernon Center - LMI Survey

Presentation to Golden K Kiwanis Club on Region 9 and the aging program

Full Commission Members

LESTER ANDERSON, County Commissioner, Blue Earth County
QUENTIN MARSH, Business & Industry, Blue Earth County
HERBERT MOCOL, Mayor, City of Mankato, Blue Earth County
ADLOR OLSEN, Cities Under 10,000, Blue Earth County
ERHART STANKE, Township Board, Blue Earth County

September

1984

SUN	MON	TUE	WED	THU	FRI	SAT
						1
2	LABOR DAY 3	4	Transportation Comm. - 7:00 (as needed) 5 EMS Radio Communica- tions Subcomm. - 7:00 Nat'l Assn. of Towns and Twps. Conf. - Cap. Hilton, Washington, D.C. - - - -	6	7	8
9	10	STATE PRIMARY Human Resource Subcommission - 9:30 11	RNDC Bd. - 4:00 Full Commission Mtg. - 7:15 12	EMS Critical Care Subcomm. - 7:00 13	14	15
16	17	18	19	EMS Advisory Committee - 7:00 20 League of Minn. Cities Regional Mtg. - New Ulm	21	22
23	24	25	Area Agency on Aging Advisory Council - 9:30 26 Arts Advisory Council - 7:00	EMS Joint Powers Board - 7:30 27	28	29
Arts Grants Deadline - Production and Sponsorship 30		State Senior Center Conference - St. Cloud - - - - -	- - - - -			

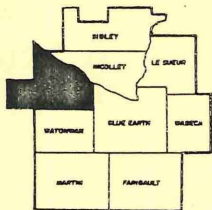

Brown County

Senior Citizens' Chore/Home Maintenance Project - \$33,334

New Ulm Senior Center - \$675

Springfield Community Theatre - \$1,200

New Ulm Noteables - \$750

Brown County 4H (arts grant) - \$708

Springfield - Small Cities Development grant application

New Ulm - Prepared and processed 503 loan for SAR, Inc.

Census presentation to Springfield Chamber of Commerce

Full Commission Members

ORVILLE HANSON, Township Board, Brown County

HAROLD PIDDE, Cities Under 10,000, Brown County

VIRGIL WELLNER, County Commissioner, Brown County

CARL WYCZAWSKI, Mayor, City of New Ulm, Brown County



Faribault County

Elmore Senior Center - \$20,357

Frost Senior Center - \$9,349

Minnesota Lake Senior Center - \$810

Walters Senior Center - \$675

Frost Senior Citizens Self-Help Project - \$2,039

Kiester - Assisted in production of LAWCON/LCMR grant application

Provided technical assistance to Highway 169 Improvement Association

Bricelyn - Small Cities Development Grant application

Full Commission Members

THOMAS BROWN, County Commissioner, Faribault County

ROGER OLDFATHER, Cities Under 10,000, Faribault County

DONALD TOPPIN, Township Board, Faribault County

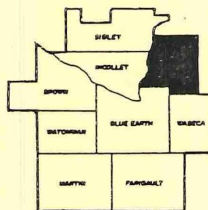

Le Sueur County

Senior Citizens Chore/Home Maintenance Project - \$9,195

Kilkenny Senior Center - \$2,460

Elysian Senior Center - \$1,075

LeSueur Senior Center - \$1,300

LeSueur Concert Association - \$2,000

Elysian - Prepared application for tourism grant and produced ads for campaign

Elysian - Administration of Small Cities Development Grant

Full Commission Members

JOHN KING, Cities Under 10,000, LeSueur County

"BABE" MILLER, Minnesota Valley COG, LeSueur County

JEROME SCHLEIS, County Commissioner, LeSueur County

JAMES STANGLER, Township Board, LeSueur County

October

1984

SUN	MON	TUE	WED	THU	FRI	SAT
	1	2	3 Transportation Committee - 7:00 (as needed) EMS Radio Communications Subcomm. - 7:00	4	5	6
7	8 COLUMBUS DAY Developmental Disabilities Advisory Council - 1:30 Aging Fall Conference - Mankato State U.	9 Human Resource Subcommission - 9:30	10 RNDC Bd. - 4:00 Full Commission Mtg. - 7:15 Phys. Dev. Subcomm. - 2:30 (as needed)	11 EMS Critical Care Subcomm. - 7:00	12 MSSA Fall Conference - Holiday Inn Downtown, Mankato	13
14	15	16	17	18 EMS Advisory Committee - 7:00	19	20
21	22	23 Area Agency on Aging Advisory Council - 9:30 Arts Advisory Council - 7:00	24 EMS Joint Powers Board - 7:30	25	26	27
28	29	30	31			

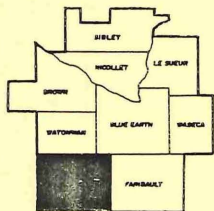

Martin County

Fairmont - Emergency Response System (Senior Self-Help) - \$6,950

Truman Stagemasters - \$500

Fairmont Opera House - \$1,040

Heritage Acres, Fairmont (arts grant) - \$2,000

Fairmont Opera House (McKnight arts grant) - \$2,954

Participated in meetings of the Fairmont Regional Solid Waste Management Board

Contributed materials for county-wide aging conference

Full Commission Members

ROBERT MALLIET, Mayor, City of Fairmont, Martin County

KATY OLSON, School Board, Martin County

BRYAN SCHULTZ, Cities Under 10,000, Martin County

ROLAND THIESSE, Township Board, Martin County

STEVAN ZOELLER, County Commissioner, Martin County

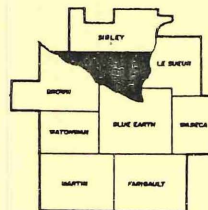

Nicollet County

St. Peter - Cleveland Senior Center - \$5,711

St. Peter Nursing Home Self-Help Project - \$4,098

St. Peter Community Choir - \$756

Lafayette Band - \$500

Network Communications of the Minnesota River Valley (arts grant) - \$1,050

North Star Summer Theatre - \$900

Nicollet County Solid Waste Management Plan

North Mankato - Prepared and processed 503 Loan for Frost Drug

Lafayette - Small Cities Development Grant application

St. Peter - Market Study for FmHA 515 Loan Program

Informational presentation to St. Peter Rotary Club

Informational presentation to Nicollet Chamber of Commerce

Full Commission Members

KENNETH ALBRECHT, County Commissioner, Nicollet County

CARRIE HUFFER, School Board, Nicollet County

JOHN PROSCH, Township Board, Nicollet County

DOUGLAS PYAN, Cities Under 10,000, Nicollet County

HARRY TIMM, Soil & Water Conservation Districts, Nicollet County

November

1984

SUN	MON	TUE	WED	THU	FRI	SAT
				1	2	3
4	5	ELECTION DAY 6	Transportation Committee - 7:00 (as needed) 7 EMS Radio Communi- cations Subcomm. - 7:00	EMS Critical Care Subcomm. - 7:00 8	9	10
11 NADO Annual Conference - New Orleans	VETERANS DAY 12	Human Resource Subcommission - 9:30 13	RNDC Bd. - 4:00 Full Commission Mtg. - 7:15 14 Phys. Dev. Subcomm. - 2:30 (as needed)	EMS Advisory Committee - 7:00 15	16	17
18	19	20	21	THANKSGIVING DAY 22	23	24
25	26	27	Area Agency on Aging Advisory Council - 9:30 28 Arts Advisory Council - 7:00	29	30	

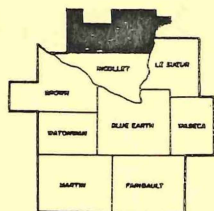

Sibley County

Senior Citizens' Assessments and Service Coordination - \$13,185
 Henderson Senior Center - \$1,500
 Arlington Senior Center - \$900
 Winthrop Senior Center - \$585
 Winthrop Community Theatre - \$495
 Sibley County Choral Society - \$300
 Arlington - Small Cities Development Grant proposal
 New Auburn - Assisted in the production of LAWCON/LCMR grant application
 Contributed materials for county-wide aging conference

Full Commission Members

ELMER KADING, Cities Under 10,000, Sibley County
 GERALD KREGER, County Commissioner, Sibley County
 HAROLD WIEST, Township Board, Sibley County

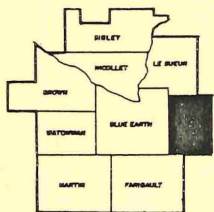

Waseca County

Senior Citizens' In-Home Service Project - \$27,500

Waseca Area Senior Citizens Center Volunteer Coordinator - \$11,907

Waseca Area Senior Citizens Center Self-Help - \$6,939

Waseca Chorale - \$1,300

Waseca Arts Council - \$1,500

Waseca - Market study for FmHA 515 Loan Program

Full Commission Members

ELDO BRANDENBERG, Township Board, Waseca County
 JACK FITZSIMMONS, County Commissioner, Waseca County
 AVERY HALL, Cities Under 10,000, Waseca County

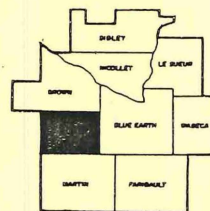

Watonwan County

Madelia Nursing Home Senior Self-Help Project - \$965

Butterfield Strawhat Players - \$200

St. James Community Theatre - \$500

Madelia - Small Cities Development Grant application.

Madelia - Market Study for FmHA 515 Loan Program

Odin - LMI Survey

Full Commission Members

ROBERT GUSTAFSON, Township Board, Watonwan County
 "PETE" JOHNSON, County Commissioner, Watonwan County
 WILTON SULFLOW, Cities Under 10,000, Watonwan County

December

1984

SUN	MON	TUE	WED	THU	FRI	SAT
						1
2	3	4	Transportation Committee - 7:00 (as needed) EMS Radio Communications Subcomm. - 7:00	6	Minnesota Assn. of Townships Mtg. - Radisson Arrowwood, Alexandria - - - - -	8
9	Developmental Disabilities Advisory Council - 1:30	10	Human Resource Subcommission - 9:30 RNDC Bd. - 4:00 Physical Dev. Subcomm. - 2:30 (as needed)	12	EMS Critical Care Subcomm. - 7:00	15
16	17	18	19	EMS Advisory Committee - 7:00	20	21
23	24	CHRISTMAS DAY	Arts Advisory Council - 7:00	EMS Joint Powers Board - 7:30	28	29
30	31					

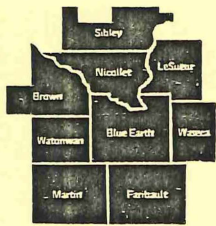

Multi-County or Regionwide Activities

Tri-County Conservation Tillage Grant (second year) - Blue Earth, Nicollet, LeSueur counties - \$20,000

South Central Minnesota Senior Federation Self-Help Project - \$2,504

Informational presentations at city council meetings in all Region Nine cities.

Southwest Area Senior Ombudsman Program - \$20,000

Legal Advocacy for Older Americans - \$65,500

SMILINE (information and referral for senior citizens) - \$20,000

Congregate Meal Program - \$510,000

Home Delivered Meals Program - \$69,133

Provided census data to numerous individuals and units of government

McKnight Capacity Building Grant for the Arts - \$2,125

Secured private foundation grants for the arts: McKnight - \$9,000, Blandin (including 50% match from the Legislature in a supplemental appropriation) - \$9,300.26

Census presentation to Traverse des Sioux Library System directors

Participation in Traverse des Sioux Library System program on aging

Presentation to Region Nine Home Ec Association

Physical Development Planning

PHYSICAL DEVELOPMENT SUBCOMMISSION

The Physical Development Subcommittee is advisory to the Region Nine Development Commission in establishing Physical Development policies and priorities for the region. In this capacity, the Subcommittee reviews plans, policies and activities in a variety of program areas including land use, housing, community development, economic development, transportation and recreation. Membership consists of 14 persons including one representative from each of the nine counties, one representative from each of the cities of Fairmont, Mankato and New Ulm, one representative from the Soil and Water Conservation Districts of Region Nine.

Many diverse physical planning activities were addressed by the Physical Development Subcommittee last year: review of the Small City Development Grant Program applications; review of the Governor's Council on Rural Development grants; discussion of the hazardous waste siting program; the conduct of all required reviews; and the review of all of the physical development programs and initiatives.

During FY1985, the Physical Development Subcommittee will continue its efforts as outlined. It is expected that new concerns, including business and rural development, will be addressed as they arise.

Physical Development Subcommittee Members

LARRY HANSEN, LeSueur County

DALE DARROW, Mankato

JACK FITZSIMMONS, Waseca County

PETE JOHNSON, Watonwan County

BOB MALLIET, Fairmont

ROY NELSON, DNR

FRANK A. ROGRIGUEZ, Rural Environmental Educational Council

DAVE SCHNOBRICH, New Ulm

ERHART STANKE, Blue Earth County

HARRY TIMM, Nicollet County

DON TOPPIN, Faribault County

HAROLD WIEST, Sibley County

BRYAN SCHULTZ, Martin County

1985

AMC Annual Mtg.
-St. Paul Radisson -

COMPREHENSIVE PLAN

The Regional Development Act mandated that regional commissions "shall prepare and adopt, after appropriate study and such public hearings as may be necessary, a comprehensive development plan for the Region." Region Nine formally commenced its effort in July of 1978 and has completed long term goals and policies for the Commission. The annual Overall Program Design serves as the work program.

Also, as part of this program area, Region Nine completed the annual salary survey which was then forwarded to interested local units of government.

LAND USE

The primary emphasis of the Land Use Program has been in providing technical assistance to local units of government. The staff has assisted communities with a variety of land use matters ranging from minimum tillage concerns to capital improvement considerations.

Technical Assistance

Last year, Region Nine assisted a number of communities in developing new maps to depict zoning modifications.

A major project was the formulation of an assessments policy manual for the City of Elysian.

Minimum Tillage

The Tri-County Conservation Tillage Program applied for and received second year funding for their program from the Governors council on Rural Development.

HOUSING

The regional Housing Program in FY1984 primarily focused on activities oriented toward effective implementation of the Region Nine Housing Plan, and on the provision of technical assistance to local units of government and the general public. Greater emphasis has been placed on the availability and utilization of local, state and federal housing assistance programs as a result of escalating housing costs and interest rates.

RNDC staff are continuing to work closely with representatives from Housing and Urban Development (HUD), Minnesota Housing Finance Agency (MHFA), Farmers Home Administration (FmHA) and local housing and redevelopment officials in attempting to satisfy the housing needs of area residents.

The Region Nine Housing Plan has been updated to reflect 1980 census information.

TRANSPORTATION

The Transportation Committee concentrated its attention on the movement of agricultural and commercial products, on improving the mobility of its citizens and on other concerns of the region.

At the Transportation Committee meetings a variety of transportation experts gave presentations. Some of the issues discussed were:

- Mn/DOT 1984-85 transportation projects in the region
- Developments on the Norwood/Hanley Falls rail line
- Mn/DOT State Rail Bank Program
- Functional classification of public roads in Minnesota
- Highway Patrol-portable scales, civil weights

The Transportation Committee reaffirmed these transportation issues:

- Support of Mn/DOT's effort to create a 10-ton route system
- Request to local road authorities to determine if some roads should be legally abandoned
- Support for commercial transportation within 10 miles of each person in Region Nine

The Transportation Committee also reaffirmed issues that were adopted 4 years ago.

During FY1985, the Committee will update the Regional Transportation Plan and will continue to carry out its responsibilities in the areas noted above. These activities will be expanded to include any emerging issues or areas of concern which the Committee sees as significant to the Region.

Transportation Committee

LESTER ANDERSON, Blue Earth County
TOM BROWN, Faribault County
EARL CUNNINGHAM, Brown County
PAUL HADLEY, Nicollet County
AVERY HALL, Waseca County
JOHN KING, LeSueur County
HERSHEL KOENIG, Engineer-Faribault County
DON LINDLEY, At-Large
KEN SAFFERT, At-Large
RON SANDVIK, Engineer-LeSueur County
Brown County-Vacancy
WILTON SULFLOW, Watonwan County
ROLAND THIESSE, Martin County
HAROLD WIEST, Sibley County

SOLID/HAZARDOUS WASTE

Staff provides technical assistance and information to local units of government. The Solid Waste Plan for Nicollet County was completed and approved by the County Board.

February

1985

SUN	MON	TUE	WED	THU	FRI	SAT
					Small Cities Development Grant Deadline 1	2
3 NARC Federal Briefing -Hyatt Regency, Washington, D.C. -----	4	5	6 Transportation Comm. - 7:00 (as needed) EMS Radio Communi- cations Subcomm. - 7:00	7	8	9
10 Developmental Disabilities Advisory Council - 1:30	11	12 LINCOLN'S BIRTHDAY Human Resource Subcommission - 9:30	13 RNDC Bd. - 4:00 Full Commission Mtg. - 7:15 Phys. Dev. Subcomm. - 2:30	14 ST. VALENTINE'S DAY EMS Critical Care Subcomm. - 7:00	15	16
17 WASHINGTON'S HOLIDAY	18	19	20	21 EMS Advisory Committee - 7:00	22	23
24	25	26	27 Area Agency on Aging Advisory Council - 9:30 Arts Advisory Council - 7:00	28 EMS Joint Powers Board - 7:30 Arts Grants Deadline (McKnight)		

SBA 503 LOAN PROGRAM

The 503 Loan Program, offered through the federal government's Small Business Administration, is administered locally by the Region Nine Development Corporation. The program makes joint federal and private sector financing available to small and medium size businesses. Its purpose is to stimulate growth and expansion of small businesses by combining the incentives of long term (15-25 years), low down payment (10%), and reasonable rates (near long term U.S. Treasury bond rates) to business development projects.

Within the past year, the Region Nine Development Corporation has received approval of four loans through the 503 program:

- Dietz Super Valu, Mapleton
- Frost Drug Store, North Mankato
- Mathes Printing, Mankato
- Sar, Inc., New Ulm

The total dollar amount of both the private and public financing has been \$990,000 of which \$440,000 was financed through the Region Nine Development Corporation. This effort has resulted in creating 15 additional jobs and increasing the tax base in Nicollet, Blue Earth and Brown counties.

The Corporation has seen a steady increase in both activity and interest. Two additional applications have been submitted to SBA for approval and staff is presently working with several businesses which have expressed an interest in the program.

Region Nine Development Corporation Board of Directors

BLUE EARTH COUNTY - Norb Harrington, Mankato, Roger Nygaard, Mankato
BROWN COUNTY - Denis Warta, New Ulm; Richard Salvati, New Ulm
FARIBAULT COUNTY - Roger Oldfather, Kiester; Frank Rodriguez, Elmore
LESUEUR COUNTY - Arlen Krugerud, LeCenter; Jerome Schleis, Montgomery
MARTIN COUNTY - James Lytle, Sherburn; Harris Sorenson, Fairmont
NICOLLET COUNTY - Paul Hadley, North Mankato; Ken Albrecht, North Mankato
SIBLEY COUNTY - William Cowell, Gaylord; Larry Sorenson, Arlington
WASECA COUNTY - Joe Finley, Janesville; Ruth Schoer, Waseca
WATONWAN COUNTY - Earl Henderson, St. James; Sue Milbrath, St. James

RECREATION

The Region Nine Recreation Program is focused primarily on the development and promotion of the area's outdoor recreation resources. In fiscal year 1984, development was achieved through grant programs such as the LAWCON/LCMR program which provides

matching grant monies to local jurisdictions for parks and open space. Promotion of the area's outdoor recreational facilities has been accomplished through tourism advertising and soon a recreation atlas.

Recreation Grants

The Department of Energy and Economic Development offered matching grant money to local units of government in the form of a LAWCON/LCMR grant program. RNDC staff advertised the program, provided technical assistance to many of the grant applicants, assisted in the production of 2 applications for the cities of Kiester and New Auburn, and completed an application for Blue Earth County.

Local ranking criteria which have been developed by the Region Nine Development Commission were used to promote the area's outdoor recreation needs. This ranking is used on a 50/50 basis with a ranking done at the state level to determine sites to be programmed for funding. This process has proved successful in promoting the outdoor recreation needs of the Region Nine area. The total amount of programmed costs for parks in Region Nine was \$111,752.

Another grant program, spawned by the Federal Emergency Jobs bill, became available in the spring and summer of 1983. It was the Small Business Administration's Parks and Recreational Area Development Program. RNDC staff provided assistance to 27 units of government requesting information on the program.

Recreation Promotion

A series of tourism ads, part of the "Explore Minnesota" promotion, were produced for the City of Elysian by Region Nine staff. The advertisements were printed in numerous major papers in the State of Iowa.

Information for the production of a recreation atlas or brochure has been fully compiled and it will be printed either as an independent product or as part of an existing publication, such as the items produced by Pioneerland.

High transportation costs coupled with increasing pressure on our existing outdoor recreation base is a recreation problem of regional significance. Region Nine will continue to promote the addition of facilities in this area through grant programs such as LAWCON/LCMR while promoting our local parks through a recreation atlas and tourism publications. This will not only reduce pressure on heavily used areas by alerting people to little used facilities, but will decrease the amount of travel out of the Region for recreational activities which duplicate similar activities existing within the Region Nine area.

Communication with such agencies as the Department of Energy and Economic Development and the Department of Natural Resources (DNR) will continue and technical assistance will be provided where needed or requested

Recreation Advisory Committee

MARK BARTELT, Waseca
PAUL BREMER, Department of Natural Resources
JIM JACK, Mankato State University
JOHN ZIMMERMAN, LeSueur County Office of Planning and Zoning

March

1985

SUN	MON	TUE	WED	THU	FRI	SAT
					1	2
						NACO Legislative Conference - Washington Hilton - - -
3	4	5	6	7	8	9
	- NACO -		Transportation Committee - 7:00 (as needed) EMS Radio Communi- cations Subcomm. - 7:00			
10	11	12	13	14	15	16
		Human Resource Subcommission - 9:30	RNDC Bd. - 4:00 Full Commission Mtg. - 7:15 Phys. Dev. Subcomm. - 2:30 (as needed)	EMS Critical Care Subcomm. - 7:00		
			MSSA Spring Conf. - Radisson, St. Paul			
ST. PATRICK'S DAY 17	18	19	20	21	22	23
				EMS Advisory Committee - 7:00		National League of Cities Congressional - City Conference - Washington, D.C. - - -
24	25	26	27	28	29	30
			Area Agency on Aging Advisory Council - 9:30 Arts Advisory Council - 7:00	EMS Joint Powers Board - 7:30		
Arts Grants Deadline (Production and Sponsorship) 31	- League of Cities -					

CABLE TELEVISION

The Region Nine Cable Program was developed as a result of the fact that Regional Development Commissions have the responsibility to review cable territory requests in their respective geographic areas. A cable policy document has been formulated for use when territory requests come before the Region for consideration.

During the coming year, Region Nine will continue to monitor the federal legislation. Also, staff will be available to assist small communities in the development of their cable ordinances and services.

COMMUNITY/ECONOMIC DEVELOPMENT

Over the past year the Region Nine Development Commission has greatly expanded its involvement in community/economic development programs. The present staff offers comprehensive, professional expertise to communities and individual businesses seeking to accomplish development projects. A sample of the programs and skills which are available include:

- Development and implementation of tax increment finance plans
- Research for and writing of Small Cities Development Block Grants and Urban Development Action Grants
- Financial analysis and application for small business loans
- Preparation of community development plans and implementation of corresponding commercial rehabilitation bond programs.

A partial list of the accomplishments in the past year include:

- Met with the city councils of each city in the Region to discuss the Region and its programs
- Worked with Blue Earth County to develop guidelines for their Economic Development Grant Program

Human Resource Planning

HUMAN RESOURCE SUBCOMMISSION

The Human Resource Subcommittee is advisory to the RNDC in planning and policy development related to human resources. In this capacity, the Subcommittee reviews plans and policies recommended by the advisory councils on aging, arts, developmental disabilities, emergency medical services and employment and training. Membership consists of 12 citizens, one from each county and one from each city over 10,000, who are appointed by the RNDC.

The HRS has been assigned responsibility for coordination of planning efforts in human resources. As part of this responsibility, HRS members regularly attend meetings of the aforementioned advisory councils, as well as the meetings of organizations providing human services in the region, such as Human Service Boards and mental health boards. Specific activities conducted in FY1984 under this coordinative role included: review of all plans and recommendations developed by RNDC advisory councils in human resources; other grant reviews, i.e., Community Health Service Plans, Community action Agency grants, etc.; recommendations on appointments to advisory councils.

Human Resource Subcommittee Members

VACANCY, LeSueur County
MIKE KEARNEY, Nicollet County
AUDREY ANNIS, Blue Earth County
VACANCY, Fairmont
JANE JACOBSEN, Martin County
BETTY MARTINKA, New Ulm
BERNARD MCLAIN, Sibley County
LORNA MONTZKA, Faribault County
CAROLYN SHREWSBURY, Mankato
ROY TRULLINGER, JR., Watonwan County
MYRTLE TURBES, Brown County
MARGARET ZIMMERMAN, Waseca County

CENSUS - DATA CENTER AFFILIATE

In October, 1982, the Region Nine Development Commission was designated an affiliate of the Minnesota State Data Center, as part of a national Census Bureau program to increase access by the public to census information.

As an affiliate, Region Nine receives printed census documents upon release by the Census Bureau, and makes this information available to anyone needing information from the 1980 or past censuses.

Region Nine will continue to provide census data, assistance in using census documents, and prepare community profiles. Staff will be available for training or speaking engagements, and continue to prepare analyses of census data.

April

1985

SUN	MON	TUE	WED	THU	FRI	SAT
	1	2	3 Transportation Committee - 7:00 (as needed) EMS Radio Communi- cations Subcomm. - 7:00	4	5	6
EASTER 7	8 Developmental Disabilities Advisory Council - 1:30	9 Human Resource Subcommission - 9:30	10 RNDC Bd. - 4:00 Full Commission Mtg. - 7:15 Phys. Dev. Subcomm. - 2:30 (as needed)	11 EMS Critical Care Subcomm. - 7:00	12	13
14	15	16	17	18 EMS Advisory Committee - 7:00	19	20
21	22	23	24 Area Agency on Aging Advisory Council - 9:30 Arts Advisory Council - 7:00	25 EMS Joint Powers Board - 7:30	26	27
28	29	30				

AREA AGENCY ON AGING

The Region Nine Development Commission has been designated as the Area Agency on Aging (AAA) for the nine counties of southcentral Minnesota since 1976. The Area Agency receives its funding from the federal Administration on Aging under the Older Americans Act as administered through the Minnesota Board on Aging.

The Area Agency on Aging is expected to fulfill the many responsibilities outlined in the Older Americans Act:

- to serve as a focal point on aging
- to disseminate information on aging in the nine county area
- to coordinate and co-locate services to older people
- to seek private financial and human resources
- to provide training to the aging network
- to advocate on behalf of older people
- to plan for services by identifying needs and matching resources to those needs
- to make grants for new expanded services
- to ensure the maintenance of priority services in region

1984-86 Area Plan

The Region Nine Area Agency on Aging is required under the Older Americans Act and by the Minnesota Board on Aging to regularly assess the needs of older persons in the region. The assessment of these needs and the plan for action that addresses them is known as the Area Plan on Aging. The Plan acts as a guideline for the Area Agency's activities.

Under the priorities of the 1984-86 Area Plan on Aging (amended annually), the following grants were awarded by the Region Nine Development Commission:

Grantee	Service	Amount
Southern Mn. Regional Legal Services, Inc.	Southwest Area Ombudsman Consortium	\$20,000
Southern Mn. Regional Legal Services, Inc.	Legal Advocacy for Older Americans	\$65,500
LeSueur County Welfare	LeSueur County Chore/Home Maintenance	\$ 9,195
Southcentral Mn. Inter-Library Exchange	SMILINE	\$20,000
Blue Earth County Human Services	Blue Earth County Senior Citizens Health Screening Clinics	\$12,177
Waseca County Welfare & Social Services	Waseca County In-Home Service Project	\$27,500
Sibley County Public Health Nursing	Sibley County Assessment & Service Coordination	\$13,185
Brown County Family Service Center	Brown County Chore/Home Maintenance	\$33,334
Waseca Area Senior Citizens Center	Volunteer Coordinator	\$11,907
Lutheran Social Services	Share-a-Home & Housing Advocacy	\$18,061
Mankato Lutheran Home	Adult Day Care Project	\$21,439

Title III-B Older American Act

Grantee	Service	Amount
Elmore	Senior Center	\$20,357
Mapleton	Senior Center	\$20,522
Mankato	Senior Center	\$ 2,647

Title III-C-1 Older Americans Act

Grantee	Service	Amount
Minnesota Valley Action Council	Congregate Meals	\$510,000

Title III-C-2 Older Americans Act

Grantee	Service	Amount
Minnesota Valley Action Council	Home Delivered Meals	\$ 69,133

McKnight Foundation

(private foundation monies for rural senior clubs/centers)

Frost	Senior Center	\$ 9,349
St. Peter-Cleveland	Senior Center	5,711
Kilkenny	Senior Center	2,460
Elysian	Senior Center	1,705
Henderson	Senior Center	1,500
LeSueur	Senior Center	1,300
Arlington	Senior Center	900
Minnesota Lake	Senior Center	810
Walters	Senior Center	675
New Ulm	Senior Center	675
Winthrop	Senior Center	585

McKnight Foundation

(private foundation monies for community-based self-help projects)

Fairmont	Emergency Response System	\$ 6,950
Waseca	Popcorn Wagon	6,939
St. Peter Nursing Home	Thrift Shop	4,098
Senior Federation	Outreach	2,504
Frost	Quilt Project	2,039
Mankato	Ceramics Kiln	1,500
Madelia Nursing Home	Pottery Wheel Project	965
Mapleton	Doughnut Machine	675

Aging Advisory Council

SANDRA ALLAIRE-Public Agency, U of M Tech. College
 KATE ALSWORTH-Public Agency, FMW Human Service Board
 EDGAR ANDERSON-Watonwan County
 KEN BROWN-At-Large
 RAY ECKES-At-Large
 JUDY EHMKE-Public Agency, Blue Earth County Human Services
 VANDA HEDGES-At-Large

(Cont. next page)

May

1985

<i>SUN</i>	<i>MON</i>	<i>TUE</i>	<i>WED</i>	<i>THU</i>	<i>FRI</i>	<i>SAT</i>
			Transportation Committee - 7:00 (as needed) 1 EMS Radio Commu- nications Subcomm. - 7:00	2	3	4
5	6	7	RNDC Bd. - 4:00 Full Commission Mtg. - 7:15 Phys. Dev. Subcomm. - 2:30 (as needed) 8	EMS Critical Care Subcommittee - 7:00 9	10	11
MOTHER'S DAY 12	13	Human Resource Subcommission - 9:30 14	15	EMS Advisory Committee - 7:00 16	17	18
19	20	21	Area Agency on Aging Advisory Council - 9:30 22 Arts Advisory Council - 7:00	EMS Joint Powers Board - 7:30 23	24	25
26	MEMORIAL DAY 27	28	29	30	31	

(Aging Advisory Council Cont.)

MARY LOU IHRKE-Public Agency, Blue Earth County Ag. Extension
 RODERICK JOYCE-At-Large
 LOREN KNAUSS-LeSueur County
 JOHN LAUX-Brown County
 GLORIA MCCULLOUGH-At-Large
 ETHEL MEDALAN-Blue Earth County
 DALE MILLER-Private, Non-Profit Agency, Good Samaritan Center
 ALICE OSBORNE-Nicollet County
 CARL OSLUND-Waseca County
 BEN PORTNER-Sibley County
 T.R. SCHAFFLER-At-Large
 THELMA SCHUELER-At-Large
 WANDA WEBSTER-Public Agency, Brown-Nicollet Human Service Board
 EDWARD WILCOX-Martin County
 AUDREY WOLFE-Faribault County
 *LORNA MONTZKA-HRS Liaison
 *PEGGY SASSEN-HRS Liaison
 **ERHART STANKE-RNDC Liaison

*Ex-officio, non-voting member serving as liaison between the Advisory Council and the Human Resource Subcommittee
 **Ex-officio, non-voting member serving as liaison between the Advisory Council and the RNDC

ARTS

The Region Nine Arts Council is a volunteer group of citizens representing a broad base of regional arts interests from each county and from each city over 10,000 in the region. The Council reviews grant applications submitted by arts organizations within the region and forms arts policies, goals and priorities in the region. The Council members also provide technical assistance to those local arts organizations and serve as advocates for local and regional arts development.

The regranting of funds allocated by the Minnesota State Legislature was again the major activity of the Arts Council in FY1984. Two grant review rounds were held combining the reviews for sponsorship, production and McKnight applications. The criteria for the sponsorship and production grants are: artistic merit of the project, the ability of the organization to successfully complete it, and the need for the project within the designated area. The applicant is required to provide at least 50% match for the project.

Production Project Assistance Grants - provide funds for local/regional arts development and enhancement of artists or arts resources within a community or region.

Applicant	County	Amount
Strawhat Players	Watonwan	\$ 200.
Winthrop Community Theatre	Sibley	495
LeSueur Concert Association	LeSueur	2,000
St. Peter Community Choir	Nicollet	756
Sibley County Choral Society	Sibley	300
Minnesota Valley Chorale	Blue Earth	2,000
Mankato Youth Symphony Orchestra	Blue Earth	1,500

Leisure Education for Exceptional People	Blue Earth	1,360
Artpaper	Region-wide	800
Lafayette Band	Nicollet	500
Springfield Community Theatre	Brown	1,200
Stagemasters	Martin	500
Waseca Chórale	Waseca	1,300
Network Communications of the Minn. River Valley	Nicollet	1,050
Mankato Ballet Company	Blue Earth	1,300
Mankato Symphony Orchestra	Blue Earth	3,000
St. James Community Theatre	Watonwan	500
New Ulm Noteables	Brown	750
North Star Summer Theatre	Nicollet	900
Brown County 4H	Brown	708

Sponsor Assistance Grants - provide funds to schools and community non-profit tax exempt organizations which present art activities to the general public for their enrichment, education and enjoyment.

Applicant	County	Amount
Waseca Arts Council	Waseca	\$ 1,500
Minnesota Valley Regional Library	Blue Earth	500
Mankato Area Arts Council	Blue Earth	1,814
Fairmont Opera House	Martin	1,040
Heritage Acres	Martin	2,000

McKnight Arts Development Grants - The Arts Council again received funds from the McKnight Foundation for regranting to local arts organizations in the region.

Organizations applying for these funds must meet the following criteria: employ paid staff, present at least three programs a year on an on-going basis, show innovation and quality in programming and show evidence of community support. Projects to be funded may include programs which maintain or enhance the professional capabilities of groups, purchase of equipment or minor renovation of buildings and limited duration projects of high quality.

Applicant	County	Amount
Fairmont Opera House	Martin	\$ 2,954
Mankato Symphony Orchestra	Blue Earth	6,000
Mankato Area Arts Council	Blue Earth	46

Region Nine Arts Council

MARK SIEVERT, Blue Earth County
 MARY LARAWAY, Brown County
 NANCY K. STEELE, Faribault County
 C. EDWARD WILLIAMS, LeSueur County
 VIVA JEAN BOSSHART, Martin County
 LARRY MALLETT, Nicollet County
 SHIRLEY SOMMER, Sibley County
 PAT BECKMANN, Waseca County
 JOHN BAERG, Watonwan County
 LAVONNE BOWMAN, City of Fairmont
 SISTER NORLEEN RANS, City of Mankato
 SYLVIA SALVATI, City of New Ulm
 CAROLYN SHREWSBURY, HRS Liaison

June

1985

SUN	MON	TUE	WED	THU	FRI	SAT
						1
2	3	4	Transportation Committee - 7:00 EMS Radio Communications Subcomm. - 7:00	5 6	7	8
9	Developmental Disabilities Advisory Council - 1:30 10	Human Resource Subcomm. - 9:30 League of Minnesota Cities Annual Meeting - St. Paul 11	RNDC Bd. - 4:00 Full Commission Mtg. - 7:15 Phys. Dev. Subcomm. - 2:30 (as needed) 12	EMS Critical Care Subcomm. - 7:00 13	FLAG DAY 14	15
NARC Annual Conference - Pittsburgh FATHER'S DAY 16	17	18	19	EMS Advisory Committee - 7:00 20	21	22
23	24	25	Area Agency on Aging Advisory Council - 9:30 Arts Advisory Council - 7:00 26	EMS Joint Powers Board - 7:30 27	28	29
30						

DEVELOPMENTAL DISABILITIES

The Region Nine Developmental Disabilities Program, which has been in existence for 11 years, is funded through a grant from the Governor's Council on Developmental Disabilities. (Developmental disabilities are severely handicapping conditions that begin early in life and substantially limit the ability of persons to develop normally and perform normal activities.)

The Developmental Disabilities Advisory Council is comprised of developmentally disabled persons or their parents, service providers and members of consumer groups. The Council reviews programs and proposals, provides training and information and promotes the provision of services in the least restrictive environment.

During the past year, topics such as Welsch vs. Levine, the criminal justice system as it relates to the developmentally disabled and the Title XIX waiver were addressed. In support of this year's grant focus on day programs, four workshops on vocational training alternatives were held. The workshops dealt with training developmentally disabled clients to perform real work in non-sheltered environments.

The D.D. Program responds to numerous requests for information from service providers and consumer groups and is represented on task forces serving hearing impaired persons and other disability groups.

The MA Waiver Bill passed last year created some confusion about how services will be changed and how they will be provided under the new law. To provide answers, the Council sponsored an informational forum on the bill and its possible effects. Although the waiver has not yet been implemented, its potential effects on the service system are being studied.

The D.D. Council and the Minnesota Valley Social Adaptation Center received a McKnight Foundation grant for developing behavior management services in the region. The behavior specialist and project director has worked with 12 facilities in 7 communities, as well as provided direct client consultation to 30 individuals.

Developmental Disabilities Planning Council

PAUL BERGQUIST, Consumer
SANDY BOHNEMBLUST, parent
PAMELA BROWER, Rehabilitation Center
HARRIET BURGESSON, Hearing impaired, Department of Public Welfare
DALE ELSE, Department of Vocational Rehabilitation
CAROLYN ENGQUIST, Developmental Achievement Center
LOUISE FOLEY, Minnesota Department of Health
PAT HALLIDAY, Faribault County HSC
GINNY HANEL, Parent
SARAH HASS, Minnesota Valley Social Adaptation Center
TOM HENDERSON, Welfare Director, Brown County
KAREN KASTUS, Special Education
CAROL LEE, Harry Meyering Center
HAROLD LYNCH, Parent
JEAN MUELLER, Region 7 & 10, Association for Retarded Citizens
ANNE NEWMAN, Parent, Developmental Achievement Center
CAROLINE RHODA, Parent
DAVID SCHAEZTKE, Sioux Trails Mental Health Center
CAROLYN SHUETTE, Parent
DOTTIE SPENCER, Parent
MARY STEVENS, Parent

LORI UFKIN, Parent
KAREN WALLIN, Parent
CINDY YESS, Parent

EMERGENCY MEDICAL SERVICES

The Southcentral Emergency Medical Services Joint Powers Board has contracted with the Region Nine Development Commission for technical assistance and staffing toward implementing improvements in the EMS system in the region. Last year the Joint Powers Board contracted with RNDC to develop the first year implementation plan. The Joint Powers Board is comprised of one county commissioner from each of the nine counties, and is responsible for the use of EMS implementation funds available from the Minnesota Department of Health.

To advise it in its planning and implementation activities, the Joint Powers Board has established an Advisory Committee, a Critical Care Subcommittee and a Radio Communications Subcommittee. Each group has members from throughout the region, representing various aspects of the EMS system. The groups played a major role during the planning stage of the project, assisting the Joint Powers Board in examining the needs in the area and developing an implementation plan to begin addressing those needs.

Priority I activities scheduled for completion during the first year of implementation include:

- Trained Personnel: assist first responder squads; encourage EMT training; encourage EMS dispatcher training.
- Transportation: develop ambulance trip report forms.
- Radio Communications: encourage compliance.
- Public Involvement: design public information tool; establish pilot Good Neighbor program.
- System Management: designate medical directors; reorganize committees.

Priority II activities are:

- Trained Personnel: assist ACLS training; encourage medical personnel training.
- Radio Communications: develop radio communications plan; provide purchasing assistance; provide 911 assistance.
- Public Involvement: provide newsletter, news releases, coordination.
- Facilities: assess trauma patient data; assess cardiac patient data.
- System Management: manage grant; assess RFP process.

Priority III includes:

- Trained Personnel: assess EMT-1 training needs; conduct regionwide EMS conference.
- Transportation: analyze trip report data.
- Public Safety Coordination: examine disaster plans.
- Facilities: categorize hospitals; assist Critical Care (directory, ER log, ACLS, ATLS).

(Cont. next page)

Emergency Medical Services Joint Powers Board

Emergency Medical Services Advisory Committee

Emergency Medical Services Advisory Council

Radio Communications Subcommittee

Critical Care Subcommittee

Blue Earth County - R.H. MEYER (general surgeon)
JEAN JAVENS (e.d. nurse)
TED WILCOX (paramedic)

Brown County - Vacancy

Faribault County - SANDY SPRENGER (e.d. nurse)
MONTE SKAULTE (physician)

LeSueur County - HAROLD CHRISTIANSON (ambulance service-BLS)

Martin County - CELESTE PERRSON (c.c.u. nurse)

Nicollet County - WILLIAM SHORES (family physician)

Sibley County - Vacancy

Waseca County - JAMES DEY (family physician)
JUNE OLSTAD (MSU paramedic program)

Watsonwan County - WILLIAM HALVORSON (general)
JULIE HALVERSON (e.d. nurse)

Studies/ Documents

Wage and Salary Survey 1984 - looks at salaries for positions considered important by managers throughout the region and reviews benefit packages of local units of government.

Region Nine Report - monthly newsletter which informs local elected officials and the interested public of the Region's programs and activities.

Region Nine Annual Report - yearly summary of grants, programs and activities, as well as lists of staff, Commission and advisory committee members.

Trunk Highway Analysis - a study of the region's trunk highways with maps, condition ratings and load restrictions.

Directory of Senior Citizen Clubs/Centers - complete listing by county of senior clubs and centers in the region with information about election of officers, programs and location.

Directory of Home Delivered Meals Programs - A listing of area home delivered meal programs which state the city, meal provider, meal cost, dietetic information and days of service.

Consumer's Guide to Long-Term Care - helpful information on choosing a long-term care facility, and a complete directory of such facilities in the region.

Community Services for Preschool Children - a directory of services and programs in the region for children 0-5 years of age who have special needs.

Emergency Medical Services Implementation Plan - outlines the steps to be taken in planning for emergency medical services to the nine county area for the first phase of implementation - April, 1984-June, 1985.

1984-86 Region Nine Area Plan on Aging - A three year plan that outlines the major work activities, budget and needs assessment of the Region Nine Area Agency on Aging.

Aging Action - A periodic news bulletin sent to members of the aging network regarding local services, workshop offerings, and other information.

Small Cities Development Grants for the cities of Springfield, Arlington, Bricelyn, Madelia, Lafayette, Good Thunder.

Nicollet County Solid Waste Management Plan - analysis of existing collection and disposal system, recycling and waste reduction methods. Legislation, laws, future need projection and recommendations.

Workshops / Seminars

"Learning Is For Life" - Fourth annual conference on aging offered sessions on a variety of subjects to older adults, students and professional people.

Financial Management for Grantees - Annual workshop offered for recipients of Title III-B Older Americans Act grant funds.

"Aging Network Meeting" - A meeting of persons in the aging network that focused on local educational opportunities in the field of aging.

"Chemical Use and Issues" - A cross-discipline training for persons in the field of aging, chemical dependency, and mental health regarding chemical use by older adults.

"What Is Aging?" - A training session for members of the Advisory Council on Aging on myths, stereotypes and demographics of today's older population.

"Making Meetings Work" - A session for Advisory Council on Aging members regarding listening skills, communication and parliamentary procedure.

"Aids to Operation of Home Delivered Meals Programs" - A workshop co-sponsored with Minnesota Valley action Council for coordinators and board members of home delivered meals programs.

"Integrating the Handicapped Into the Workplace" - A series of four workshops dealing with practical aspects of such integration, presented by experts in the field.

Legislative Concerns

The Region Nine Development Commission voiced their concerns through the passage of resolutions which:

- supported improvements on the section of Highway 169 from the Iowa border to the junction of Highway 60.

- supported the accelerated transfer of State tax funds into the Highway User Fund

Staff

TERRY STONE - Executive Director

PAMELA BYERS - Deputy Director

BETTY ABRAHAM - Planner, Physical Development

FRANK CESARIO - 503 Loan Program

ROBERT DAHM - Planner, Emergency Medical Services

DEBRA GAPPA - Secretary

LINDA GIERSDORF - Bookkeeper

LOWELL JOHNSON - Planner, Emergency Medical Services

MARLISS JOHNSTON - Planner, Arts, Public Information Coordinator

KRISTIN JULIAR - Planner, Developmental Disabilities, Census

TONI MARTIN - Accountant

TONI NESHEIM - Director, Area Agency on Aging

CINDY PETRIE - Planner, Developmental Disabilities

SHERY RISTAU - Planner, Area Agency on Aging

CRAIG SHIRK - Planner, Recreation, Graphics & Cartography

MARY UTERMOHLEN - Planner, Area Agency on Aging

CHERYL WESTON - Secretary

LORI WIDMARK - Senior Physical Planner, Transportation Planner

A-95 Review

APPLICANT	PROJECT	AGENCY	FUNDING	RECOMMENDATION
Sherburn Senior Citizens Housing, Inc.	HUD 202 Elderly/Handicapped Housing	HUD	\$ 835,200	A
Winthrop Manor	HUD 202 Elderly/Handicapped Housing	HUD	\$ 700,000	A
New Ulm Associates	FmHA 515 Rural Rental Housing	FmHA	\$ 425,000	A
Mapleview Partnership (LeCenter)	FmHA 515 Rural Rental Housing	FmHA	\$ 600,000	A
MSU	Dept. of Ed. Rehab Service	Dept. of Ed.	\$ 89,415	A
Mankato Rehabilitation Center	Dept. of Ed. Rehab Service	Dept. of Ed.	\$ 90,000	A
Hanska Housing Limited Partnership	FmHA 515 Rural Rental Housing	FmHA	\$ 296,400	A
Northstar Consortium	Summer Youth Employment Program	Dept. of Labor	\$ 870,437	A
Assissi Group Homes (Blue Earth)	HUD 202 Direct Loan	HUD	\$ 1,279,500	A
Mankato Barrier Free Housing	HUD 202 Direct Loan	HUD	\$ 1,044,000	A
Delavan	Farmers Home-Storm Sewer	Farmers Home	\$ 440,200	A
Rehab Center	Training & work hardening	DES/DUR	\$ 46,692	A
Rehab Center	Increase productive efficiency of sheltered workshop employment	DES	\$ 32,784	A
Rehab Center	Establishment of a fiscal data management system	DES	\$ 9,640	A
Rehab Center	Electronic assembly project	DES	\$ 29,500	A
Rehab Center	Micro computers in extended employment	DES	\$ 31,030	A
Watonswan County	Replace township bridge #L8029 South Branch Township Road #112	MN/DOT	\$ 120,000	A
Watonswan County	Replace township bridge #L8039 Long Lake Township Road #120	MN/DOT	\$ 130,000	A
Watonswan County	Replace township bridge #L8041 Nelson Township Road #125	MN/DOT	\$ 110,000	A
Watonswan County	Replace township bridge #L8044 Long Lake Township Road #128	MN/DOT	\$ 115,000	A
Watonswan County	Replace bridge #L8050 Nelson Township Road 138	MN/DOT	\$ 110,000	A
Brown County	Grading & Bituminous CSAH 29: 1.7 mi. N.W. of New Ulm	MN/DOT	\$ 360,000	A
LeSueur County	Bituminous-Resurfacing & aggregate-shouldering CSAH 15	MN/DOT	\$ 120,000	A
Watonswan County	Bituminous resurfacing CSAH-5	MN/DOT	\$ 240,000	A
Watonswan County	Replace bridge #5828 on CSAH 13 Watonswan River	MN/DOT	\$ 225,000	A
City of LeSueur	Urban Development Action Grant	HUD	\$ 600,000	A
Gaylord	E.P.A. Construction	E.P.A./P.C.A.	\$ 720,000	A
Thomas Apartments (Lake Crystal)	515 Rural Rental Housing	FmHA	\$ 205,200	A
Minn. Dept. of Education Vo-Tech Division	Education & Vocational Training	Minn. Dept. of Economic Security	\$ 500,000	A
Greenleaf Properties (Waseca)	515 Rural Rental Housing	FmHA	\$ 839,000	A
Pegasus Properties (Madelia)	515 Rural Rental Housing	FmHA	\$ 300,000	A

APPLICANT	PROJECT	AGENCY	FUNDING	RECOMMENDATION
Minn. Migrant Council	Dislocated Workers Program	Minn. Dept. of Economic Security	\$ 36,000	A
LeSueur County Day Activity Center, Inc.	10-16 Passenger Small-Bus with Lift & Tie Down	Mn/DOT	\$ 18,900	A
Blue Earth County	Youth Intervention	D.E.E.D	\$ 10,000 State 42,958 Local	A
Minn. Migrant Council	Hispanic Older Worker Program	Minn. Dept. of Economic Security	\$ 61,362	A
Sunset Apts. (New Ulm)	11-15 Passenger Van for Elderly	Mn/DOT	\$ 17,860	A
Leo Hoffman Center	Youth Intervention Funds	Energy & Economic Development	\$ 10,000 State 31,054 Local	A
Blue Earth County Extension	MCH Special Project	MDH	\$ 600	A
LeSueur/Waseca CHS	MCH Special Project	MDH	\$ 34,550	A
Brown/Nicollet HSB	MCH Special Project	MDH	\$ 27,000	A
Immanuel-St. Joseph's Hospital	MCH Special Project	MDH	\$ 13,056	A
Gillette Children's Hospital	MCH Special Project	MDH	\$ 52,021	A
Minn. School District #88	MCH Special Project	MDH	\$ 28,004	A
Meeker/McLeod/Sibley Community Health Services	MCH Special Project	MDH	\$ 52,339	A
University of Minn. Neonatal Intensive Care Center	MCH Special Project	MDH	\$ 56,451	A
Ceylon	Water & Waste Disposal	Farmers Home	\$ 1,640,000	A
Faribault County Development Achievement Center	18-Passenger Bus with Lift & Tie Downs	MN/DOT	\$ 22,260	A
Mankato Rehabilitation Center, Inc.	30-Plus Passenger Bus	MN/DOT	\$ 26,124	A
Volunteer Services Council, Inc.	10-16 Passenger Van with Tie Downs & Lift	MN/DOT	\$ 18,900	A
Strawhat Players	Production Assistance		\$ (200) 250	A
Arlington-Green Isle Community Education	Production Assistance		\$ 112.50	D
Winthrop Community Theatre	Production Assistance		\$ 495	A
LeSueur Concert Association	Production Assistance		\$ (2,000) 2,250	A
Waseca Arts Council	Production Assistance		\$ (1,500) 1,750	A
St. Peter Community Choir	Production Assistance		\$ 756	A
Pioneer Players	Production Assistance		\$ 2,175	D
Sibley County Choral Society	Production Assistance		\$ (300) 700	A
Minnesota Valley Regional Library	Sponsorship Assistance		\$ (500) 1,000	A
Mankato Area Arts Council	Sponsorship Assistance		\$ 1,814	A

APPLICANT	PROJECT	AGENCY	FUNDING	RECOMMENDATION
Minnesota Valley Regional Library	Production Assistance		\$ 310	D
Minnesota Valley Chorale	Production Assistance		\$ 2,000	A
Mankato Youth Symphony Orchestra	Production Assistance		\$ (1,500) 1,936	A
Leisure Education for Exceptional People (LEEP)	Production Assistance		\$ (1,360) 2,360	A
Visual Arts Information Service	Production Assistance		\$ 800	A
City of Blue Earth	Title II Library Services & Construction	Office of Public Libraries	\$ 106,348-Fed. 106,348-Local	A
Maplewood Properties (St. Peter)	515 Rural Rental Housing	FmHA	\$ 679,736	A
Wend-Don Partnership (Waseca)	515 Rural Rental Housing	FmHA	\$ 750,000	A
Nicollet County	Replace Culvert at Bridge #89424 over Ditch #86	MN/DOT	\$ 75,000	A
RNDG and MVSAC	DD McKnight	Governor's DD Council	\$ 14,911	A
Minn. Valley Action Council; Nutrition for the Elderly	Title III-C-1 Older Americans Act Nutrition (Congregate)	HHS/Admin. on Aging	\$ 1,055,238 Total 410,023 Federal 87,370 State 153,557 USDA 72,357 Local 331,931 Other	A
Minn. Valley Action Council; Home Delivered Meals	Title III-C-2 Older Americans Act Nutrition (Home Delivered Meals)	HHS/Admin. on Aging	\$ 201,760 Total 85,000 Federal 34,531 USDA 15,000 Local 67,229 Other	A
Southern Minn. Regional Legal Services, Inc.	Title III-B Older Americans Act	HHS/Admin. on Aging	\$ 22,000	A
Faribault County	Replace Bridge #L-5326	MN/DOT	\$ 95,000	A
Faribault County	Grading C.S.A.H. Huntley-West of Winnebago	MN/DOT	\$ 130,000	A
Faribault County	Bituminous Base & Surfacing Huntley-West of Winnebago	MN/DOT	\$ 360,000	A
Watonswan County	Replace Bridge #L-8040 Township Road #122	MN/DOT	\$ 110,000	A
MN/DOT	MN/DOT Programs for Fiscal Years 1984-1989	MN/DOT	\$ N/A	A
MN/DOT	MN/DOT Program for Highway Planning & Research-Project Jan 1-84 - Dec 31-84	MN/DOT	\$ N/A	A

12372 Review

APPLICANT	PROJECT	AGENCY	FUNDING	RECOMMENDATION
Minn. Valley Action Council Head Start	Admin. for Children, Youth & Family	MVAC	\$ 765,461	A
Nicollet County	Bituminous Overlay on CSAH 1 From CASH 16 to Trunk Highway 15 in Lafayette	MN/DOT	\$ 390,000	A
MN/DOT	Weigh-In-Motion Facility Highway 99 West of St. Peter	MN/DOT	\$ 150,000	A
City of Mankato	Deficit-Fixed Route Bus Service	MN/DOT	\$ 349,756	A
City of Mankato	Deficit-Dial-A-Ride Bus Service	MN/DOT	\$ 67,309	A
Public Access Authority-Mankato/North Mankato	Public Telecommunications Facilities Program	Dept. of Commerce	\$ 45,490	A
Mankato State University	Public Telecommunications Facilities Program	Dept. of Commerce	\$ 45,750	A
LeSueur County	Replace Bridge #L-0026 in Derrynane Township	MN/DOT	\$ 34,500	A
Foster Grandparent Program; Assn. of Retarded Citizens		ACTION/HHS Mn. Board on Aging	\$ 1,137,946 (statewide) 14,521 (Region 9 only)	A
Senior Companion Program; Assn. of Retarded Citizens		ACTION/HHS Mn. Board on Aging	\$ 23,856 (Region 9 only)	A
Martin County	Replace Old Bridge #L-7235 Fremont Township	MN/DOT	\$ 55,000	A
Hilltop Plaza Assoc.	Two Eight Unit Apartment Buildings	U.S. Dept. of Agriculture	\$ 410,000	A
Springfield Housing Limited Partnership	12-unit Apartment	Farmers Home	\$ 313,500	A
Minnesota Historical Society	1984 annual program - 50-50 portion 1984 annual program - 70-30 portion	U.S. Dept. of Interior	\$ 312,625	A
City of Ceylon	Preparation of plans & specs. for the const. of wastewater treatment facility improvements	Environmental Protection Agency	\$	A
Blue Earth County	Replace Old Bridge #90565 on county road #183	MN/DOT	\$ 140,000	A
City of Springfield	Storm sewer system SCDP	DEED	\$ 266,665	A
City of Brice lyn	Storm sewer SCDP	DEED	\$ 177,885	A
Good Thunder	SCDP	DEED	\$ 378,901	A
Blue Earth County	SCDP	DEED	\$ 1,400,000	A
City of Waterville	SCDP	DEED	\$ 532,408	A
City of Henderson	SCDP	DEED	\$ 656,200	A
Madelia	SCDP	DEED	\$ 411,200	A
Green Isle	SCDP	DEED	\$ 250,750	A
Lafayette	SCDP	DEED	\$ 88,200	A
Arlington	SCDP	DEED	\$ 378,550	A
New Ulm	SCDP	DEED	\$ 250,000	A
St. James	SCDP	DEED	\$ 210,000	A
Fairmont	SCDP	DEED	\$ 600,000	A

12372 Review

APPLICANT	PROJECT	AGENCY	FUNDING	RECOMMENDATION	APPLICANT	PROJECT	AGENCY	FUNDING	RECOMMENDATION
Winnebago	SCDP	DEED	\$ 594,750	A	Nicollet County	Replace Bridge #L-7157 Over Roberts Creek Road #213 in Lake Prairie Township	MN/DOT	\$ 60,000	A
Mankato	SCDP	DEED	\$ 600,000	A	Mankato Rehabilitation Center	Governor's DD Planning Council	MN/DOT	\$	A
Waseca	SCDP	DEED	\$ 350,000	A	Fairmont Opera House	Arts Grant		\$ 1,040	A
Blue Earth County	Bituminous Resurfacing CSAH 13-South of Lake Crystal	MN/DOT	\$ 450,000	A	Civic Summer Theatre	Arts Grant		\$ 2,000	A
Brown County	Replace Bridge #4165-Stark Township Road	MN/DOT	\$ 130,000	A	Heritage Acres	Arts Grant		\$ 2,000	A
Nicollet County	Bituminous Resurfacing CSAH-1 16 to 15 at Lafayette	MN/DOT	\$ 390,000	A	Stagemasters	Arts Grant		\$ 500	A
Waseca County	Grading CSAH-3 South of Janesville	MN/DOT	\$ 240,000	A	Springfield Community Theatre	Arts Grant		\$ (1,200) 1,700	A
Waseca County	Concrete pavement CSAH-3	MN/DOT	\$ 900,000	A	St. James Summer Theatre	Arts Grant		\$ (500) 970	A
Martin County	SCDP	DEED	\$ 600,000	A	Brown County 4-H Federation	Arts Grant		\$ (708) 2,550	A
Southern Minn. Regional Legal Services, Inc.	Title III-B Older Americans Act	HHS/AoA	\$ 69,000	A	Pioneer Players	Arts Grant		\$ 5,325	D
Sibley County	FmHA-515	U.S. Dept. of Agriculture	\$ 410,000	A	Pioneer Players	Arts Grant		\$ 1,000	D
Waterville/Elysian	Cable Service Territory Proposed	Minn. Cable Communications Board	\$ ---	A	New Ulm Noteables	Arts Grant		\$ (750) 1,250	A
Butterfield	Cable Service Territory Proposed	Minn. Cable Communications Board	\$ ---	A	George Marti Mem. Performing Arts Center	Arts Grant		\$ (0) 3,700	A
Winnebago	Storm Sewer	Farmers Home USDA	\$ 500,000	A	Lafayette Band	Arts Grant		\$ 500	A
Dunnell	Economic Development	DEED	\$ 244,000	A	Waseca Chorale	Arts Grant		\$ 1,300	A
Minnesota Lake	Wastewater Stop 1	MPCA	\$	A	Summer at Fort Ridgely	Arts Grant		\$ 2,000	D
Mankato State University	Rehabilitation Services/ Special Project	USDOE	\$ 95,258	A	LeSueur County Pioneer Power Assoc.	Arts Grant		\$ 530	D
Fairmont Opera House, Inc.	McKnight Arts Development		\$ 2,954	A	Network Communications of the MN River Valley	Arts Grant		\$ 1,050	A
Brown County 4H	McKnight Arts Development		\$ (0) 2,550	A	North Star Summer Theatre	Arts Grant		\$ 900	A
Pioneer Players	McKnight Arts Development		\$ (0) 9,000	D	Peppermint Players Children's Theatre Co.	Arts Grant		\$ 1,690	D
Gustavus Adolphus College Gallery	McKnight Arts Development		\$ (0) 3,050	A	Dept. of Philosophy, MSU	Arts Grant		\$ 900	A
Mankato Area Arts Council	McKnight Arts Development		\$ (46) 725	A	KMSU, MSU	Arts Grant		\$ 1,245	A
Mankato State University - Dance	McKnight Arts Development		\$ (0) 2,870	A	So. Central MN Film Society	Arts Grant		\$ 2,000	D
Mankato Youth Symphony Orchestra	McKnight Arts Development		\$ (0) 625	A	Mankato Ballet Company	Arts Grant		\$ (1,300) 2,330	A
Mankato Symphony Orchestra	McKnight Arts Development		\$ (6,000) 9,000	A	Mankato Area Jaycees	Arts Grant		\$ 5,000	D
Mankato State University - Theatre	McKnight Arts Development		\$ (0) 5,000	A	Mankato Area Arts Council	Arts Grant		\$ (1,500) 4,530	A
Nicollet County	Replace Bridge #89447 on County Road #71	MN/DOT	\$ 95,000	A	Mankato Symphony Orchestra	Arts Grant		\$ (3,000) 3,500	A
Nicollet County	Replace Bridge #L-7152 Over Fritsche Creek Road #142 in Lafayette Township	MN/DOT	\$ 120,000	A	Minn. Alliance for Arts in Education	Arts Grant		\$ 600	D
					City of St. James	Wastewater Treatment	Farmers Home	\$	A
					Minn. Assoc. of County Planning & Zoning Administrators	Governor's Council on Rural Government	GCRD	\$ 24,817	A
					Waseca County Welfare & Social Services Dept.	Title III-B OAA-Aging	HHS-AoA	\$ 30,000	A
					Blue Earth County Human Services	Title III-B OAA-Aging	HHS-AoA	\$ 6,118	A
					Mankato Lutheran Home	Title III-B OAA-Aging	HHS-AoA	\$ 23,030	A
					Sibley County Community Health Services	Title III-B OAA-Aging	HHS-AoA	\$ 11,323	A

<u>APPLICANT</u>	<u>PROJECT</u>	<u>AGENCY</u>	<u>FUNDING</u>	<u>RECOMMENDATION</u>
Waseca Area Senior Citizens Center	Title III-B OAA-Aging	HHS-AoA	\$ 11,852	A
Partners in Care	Title III-B OAA-Aging	HHS-AoA	\$ 26,437	D
Lutheran Social Service	Title III-B OAA-Aging	HHS-AoA	\$ 23,073	A
Nicollet County Public Health Nursing Service	Title III-B OAA-Aging	HHS-AoA	\$ 9,227	A
SMILE Library System	Title III-B OAA-Aging	HHS-AoA	\$ 22,442	A
LeSueur County Welfare Dept.	Title III-B OAA-Aging	HHS-AoA	\$ 9,177	A
Brown County Family Service Center	Title III-B OAA-Aging	HHS-AoA	\$ 31,122	A
Sleepy Eye Housing Limited Partnership	Section 515 Rural Rental Housing Loan Program	FmHA	\$ 440,000	A

<u>APPLICANT</u>	<u>PROJECT</u>	<u>AGENCY</u>	<u>FUNDING</u>	<u>RECOMMENDATION</u>
Sherburn Housing Limited Partnership	Section 515 Rural Rental Housing Loan Program	FmHA	\$ 220,000	A
New Prague Housing Limited Partnership	Section 515 Rural Rental Housing Loan Program	FmHA	\$ 550,000	A
Mankato Rehabilitation Center, Inc.	McKnight Problem Solving	Governor's DD Council	\$ 15,000	A
Council for Exceptional Children	McKnight Problem Solving	Governor's DD Council	\$ 1,400	A
Blue Earth County	Replace Bridge 90556	Mn/DOT	\$ 215,000	A
Sibley County	Grade Widening, Bituminous Resurfacing, Aggregate Shoulding CSAN 11	Mn/DOT	\$ 200,000	A
Brown County	Grade, Base & Bituminous Surfacing CSAN 29	Mn/DOT	\$ 200,000	A
Nicollet County	Repair Bridge L-9486	Mn/DOT	\$ 44,000	A
City of Kilkenney	Facility Plan for Waste-Water Treatment Facility	MPCA	\$ ---	A

Budget

REGION NINE DEVELOPMENT COMMISSION
STATEMENT OF REVENUES AND EXPENDITURES



ARNE H. CARLSON,
State Auditor

STATE OF MINNESOTA
OFFICE OF THE STATE AUDITOR
SUITE 400
355 PARK STREET
SAINT PAUL 55103

296-2551

AUDITOR'S OPINION

Honorable James Stangler, Chairman
Region Nine Development Commission
410 South Fifth Street
Mankato, Minnesota 56001

We have examined the combined financial statements of the Region Nine Development Commission, as of and for the year ended June 30, 1983, as listed in the table of contents. Our examination was made in accordance with generally accepted auditing standards and, accordingly, included such tests of the accounting records and such other auditing procedures as we considered necessary in the circumstances.

In our opinion, the combined financial statements referred to above present fairly the financial position of the Region Nine Development Commission at June 30, 1983, and the results of its operations and the changes in financial position of its proprietary fund types for the year then ended, in conformity with generally accepted accounting principles applied on a basis consistent with that of the preceding year.

Our examination was made for the purpose of forming an opinion on the combined financial statements taken as a whole. The combining, individual fund statements and schedules listed in the table of contents are presented for purposes of additional analysis and are not a required part of the combined financial statements of the Region Nine Development Commission. This information has been subjected to the auditing procedures applied in the examination of the combined financial statements and, in our opinion, is fairly stated in all material respects in relation to the combined financial statements taken as a whole.

Arne H. Carlson

ARNE H. CARLSON
State Auditor

August 24, 1983

	FY1983 ACTUAL	FY1984 BUDGET REV.6/84	FY1985 PROPOSED BUDGET
REVENUES:			
TAXES	\$ 197967	204511	234101
STATE GENERAL SUPPORT	51626	50180	50162
PHYSICAL PLANNING PROJECTS	9518	20000	20000
SMALL CITIES TECHNICAL ASST.	12000	8000	8000
TRANSPORTATION	8000	10000	10000
COMMUNITY DEVELOPMENT CHG./SERVICES	4389	0	0
RURAL DEVELOPMENT COUNCIL	960	0	0
EMERGENCY MEDICAL SERVICES	8313	50000	85000
ARTS	14503	17000	19500
MC KNIGHT ARTS ADM.	3722	SEE ARTS	SEE ARTS
EMPLOYMENT & TRAINING	1254	0	0
AGING ADMINISTRATION	92346	102000	120000
TITLE IV AGING PROJECTS	1500	0	0
DEVELOPMENTAL DISABILITIES	21381	25495	37000
MC KNIGHT PROBLEM SOLVING GRANT	2123	5000	0
INTEREST	46678	40000	40000
TOTAL REVENUES	\$ 476280	532186	623763
EXPENDITURES:			
SALARIES	\$ 292599	317446	388425
PAYROLL TAXES & FRINGE BENEFITS	51734	60342	67198
PRINTING & COPYING	19036	24000	24000
OFFICE SPACE	29805	25447	25447
POSTAGE	7376	9630	9608
TELEPHONE	14377	14000	14000
MEMBERSHIPS & SUBSCRIPTIONS	3381	4000	3990
INSURANCE	706	1800	2400
TRAVEL, STAFF	22840	28000	27900
TRAVEL, OTHER	27837	35600	36000
REGISTRATION	5321	6000	6000
SUPPLIES	3612	6541	7500
PUBLICATIONS	1076	2950	3000
EQUIPMENT MAINTENANCE	855	2000	4000
AUDIT & LEGAL	3517	11500	12500
CONSULTANT	3201	10000	6000
OTHER--INCL. TITLE IV	5676	7900	7588
EQUIPMENT	6890	3000	3600
TOTAL EXPENDITURES	\$ 499839	570156	649156
EXCESS REVENUES OVER (UNDER)			
EXPENDITURES CARRY-OVER USED	\$ -23559	-37970	-25393