

Title of Undertaking: PolyMet Land Exchange/ACOE and SNF Survey

District: Laurentian

County: St. Louis

State: Minnesota

USGS Quadrangle(s): Isaac Lake, Babbitt, Allen, and Babbitt SW 7.5' USGS Quadrangles

Legal Description: Township: 59 and 60 North, Range: 12 and 13 West, Section: 1-12, 17, 18, and 33-35

Location Description: The project is located just south of the current Erie Mine and just east of the old LTV Mine near Hoyt Lake, Minnesota.

Project Acres: ~6,495 acres

Planning Unit: Lands/Minerals

Description of Undertaking: Land exchange between the PolyMet Mining Corporation and the SNF. The proposed land exchange is a connected action within the mining and operations proposal for the NorthMet mining project.

Nature and Severity of Direct and Indirect Impacts: The project has the potential to have direct impacts on cultural properties due to the exchange to non-federal ownership, hence no federal cultural resource laws can be enforced for protection and management of historic properties. This project also has the potential for indirect impacts through future mining operations if the land exchange proceeds.

Reconnaissance Conducted By: William Clayton; Heather Hoffman; Brett Ewald; and Brad Johnson

Title: Archaeologist; Archaeologist; Archaeological Technician; ACOE Archaeologist

Dates of Field Research: 10/19/2010-10/20/2010

Acres Inspected: ~190 acres

Pre-field Research

The following sources were consulted for this project:

- | | |
|---|--|
| <input checked="" type="checkbox"/> a. Forest Cultural Resource Files | <input checked="" type="checkbox"/> d. Other FS Files, Maps: (specify site and survey atlases) |
| <input type="checkbox"/> b. Aerial Photos | <input type="checkbox"/> e. Informants: (name, address, qualifications) |
| <input type="checkbox"/> c. SHPO (attach correspondence) | <input checked="" type="checkbox"/> f. Reports, Documents, Publications: |

Results of Pre-field Research: The heritage survey coverage atlases were consulted. A total of ~6,578 acres has been previously surveyed in or adjacent to by block and walkover/shovel testing coverage. The following CRRR documents this survey coverage within or adjacent to the project area: 8501004, 9001013, 9701003, and 9701004. Additionally, contracted archaeological survey was done within the project area by Foth and Van Dyke and Caine/Goltz. About 83 acres of ground survey was done by the two parties (reports can be found within the Heritage Resources Office at the Supervisor's Office in Duluth, MN). One historic logging camp site was identified through these surveys (FS Site # 09-09-01-314), which has since lost integrity as a result of adjacent historic logging activities which impacted the camp area. A prehistoric feature was located through shovel testing by Caine and Goltz in their 2005 survey. However, a subsequent Phase II test excavation determined that the site was ineligible for inclusion in the NRHP. Survey has also been done recently within the project boundaries via the Army Corps of Engineers archaeologist Brad Johnson. The survey location and information will be able to be referenced at a later date.

Field Research

- a. **Methodology:** Approximately 190 acres of survey was conducted. Intensive walkover survey was performed as well as 10 meter shovel testing in areas/ground applicable for such testing, mainly along the Partridge River.
- b. **Portions of Project Area Not Inspected:** Areas of boggy/marshy terrain were not inspected or tested.

Results of Field Research

- a. **Summary of Findings and Observations:** No cultural materials were identified during field survey that included 52 negative shovel tests. An unknown metal pipe was found coming up vertically from the ground, but no other associated materials were identified.

b. **Previously Unknown Cultural Resources Identified?** ☐ Yes ☒ No

c. **Artifacts Collected?** ☐ Yes ☒ No

Cultural Resources Summary

a. **Cultural Resources Recorded:** (Attach inventory forms and site location map for district copy)

No cultural resources were identified beyond the said metal isolate. There was potential to come across evidence of an overland "Indian Trail(s)" that has been identified via Trygg Maps going through the project area. No evidence of these trails was identified during this specific survey.

Recommendations

Historic Properties Affected: ☐ Yes ☒ No

Mitigation Required: ☐ Yes* ☒ No

***Recommended Mitigation:** It should be noted that mitigation *may* be required prior to project implementation in other areas beyond this particular survey area within the land exchange boundaries.

Other Remarks:

Attachments:

<input checked="" type="checkbox"/> Undertaking Vicinity Map	<input type="checkbox"/> SHPO Correspondence
<input type="checkbox"/> Location Map (7.5' Topographic Quad)	<input checked="" type="checkbox"/> Cultural Resource Inventory Forms
<input checked="" type="checkbox"/> Survey Coverage Map (7.5' Topographic Quad)	<input type="checkbox"/> Photo(s)
<input type="checkbox"/> Site Location Map (7.5' Topographic Quad)	<input type="checkbox"/> Other

Certification and Professional Review

Certification: I certify that I conducted the Cultural Resource Reconnaissance reported here, that my observations and methods are fully reported, and that this CRR Report is complete and accurate to the best of my knowledge:

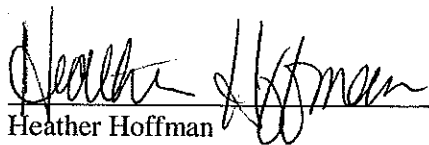
Heather Hoffman
Archaeologist

10/30/10
Date

Professional Review: I have reviewed this report and find it acceptable according to professional standard:

I determine this project to be:

- ☒ No Effect
☐ No Adverse Effect
☐ Adverse Effect

* Additional consultation is necessary re:
"Trygg trail". L.H.J.

Remarks:

Lee Johnson
Heritage Resources Program Manager

10/30/11
Date

PolyMet Land Exchange/ACOE and SNF Survey; CRRR #1101001
Babbitt SW 7.5' USGS Quadrangle
Township: 59 North, Range: 12 and 13 West, Section: 1, 6, 7, and 12
Site, Survey, and Project Location Map
1:24000

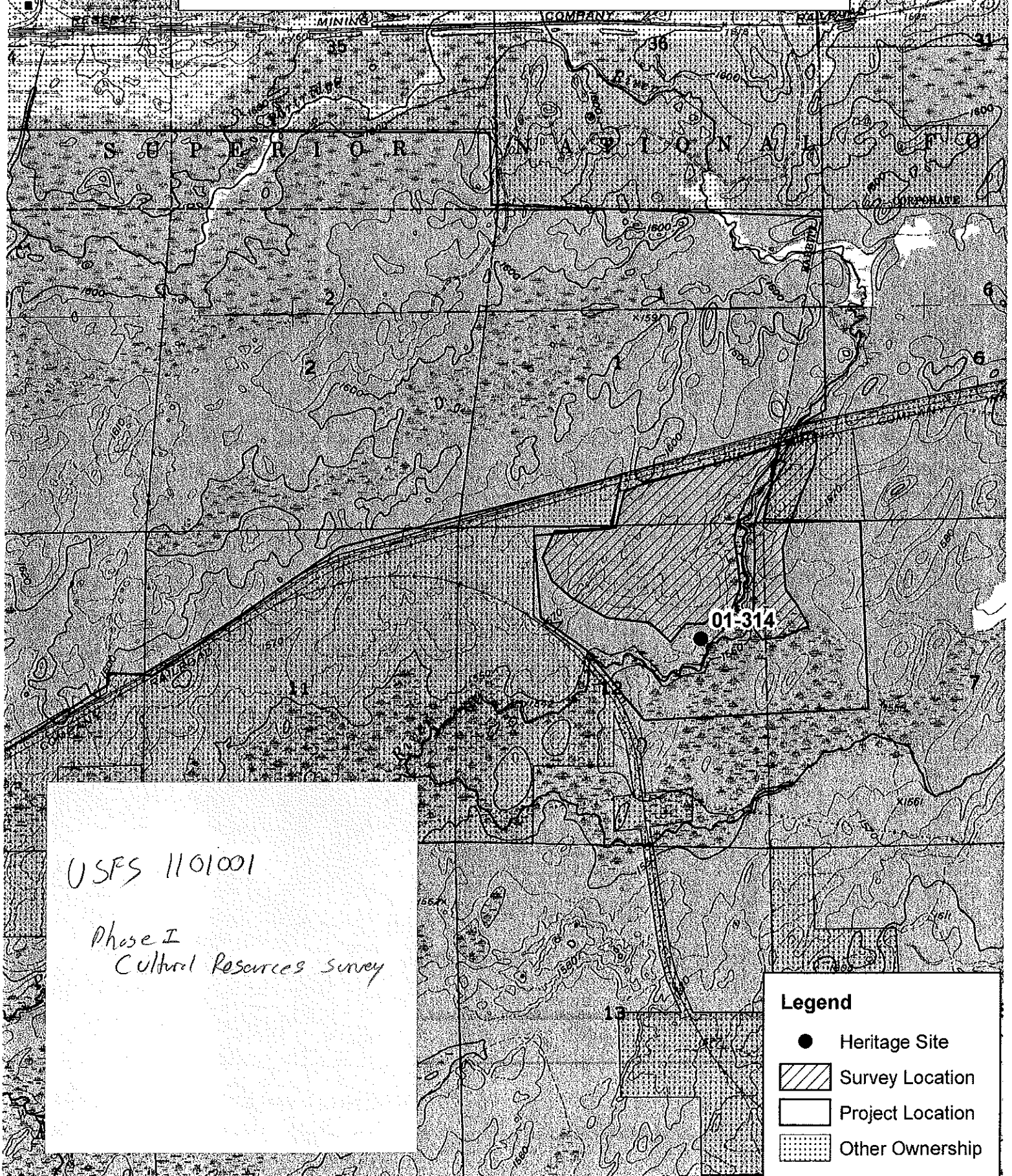

USFS 1101001

Phase I
Cultural Resources Survey

