

ABSTRACT

Regional Trailhead Building
5(n) \$135,000 MFRF
Roger Clark
Itasca County Land Department
123 NE 4th Street
Grand Rapids, MN 55744
Telephone: (218) 327-7347
Fax: (218) 327-2848
E-mail: Roger.Clark@co.itasca.mn.us

Completed construction of the Itasca County Regional Trailhead Building located at the Fairgrounds in Grand Rapids, MN. The facility is approximately 5000 square feet in size and is designed to function as a multi-purpose trail user information center, including external and internal kiosks, a contact station, handicapped accessible restrooms, a multi-purpose meeting room for trail user groups, training needs, and other activities. The facility also provides an office space for the County Park System and the Itasca County Agricultural Association. Grand Rapids is a popular tourist area for thousands of visitors. Many visitors are including recreational trail use in their vacation plans. This facility is the starting/ending point for several well known and popular public recreational trails.

The State Taconite Snowmobile Trail running from Grand Rapids to Ely (170 miles), connecting hundreds of miles of snowmobile trail. External kiosk and bathroom facilities are available during daylight hours and internal information will be made available during special events.

The Itasca County bike trail running 6 miles north to Gunn Park located along the Highway 38 National Scenic Byway and,

The Mesabi Bike Trail (bituminous), currently being developed from Grand Rapids to Ely, connecting 20 plus Iron Range communities (132 miles in length). As this trail gains more popularity, this facility will be made available to thousands of visitors to the Itasca County area. This facility is the first of several main trailheads which are planned to be located along the Mesabi Bike Trail.

This project completed June 30, 2003.

JUL 24 2003

Itasca County Trailhead Building 2003

FINAL REPORT



LCMR 2001 project

Nagel Lake

47°14'54.0"N, 93°31'23.7"W, dms
47 14.9, -93 31.395, dm
47.24833, 93.52325, dd

Itasca County
Trailhead Building

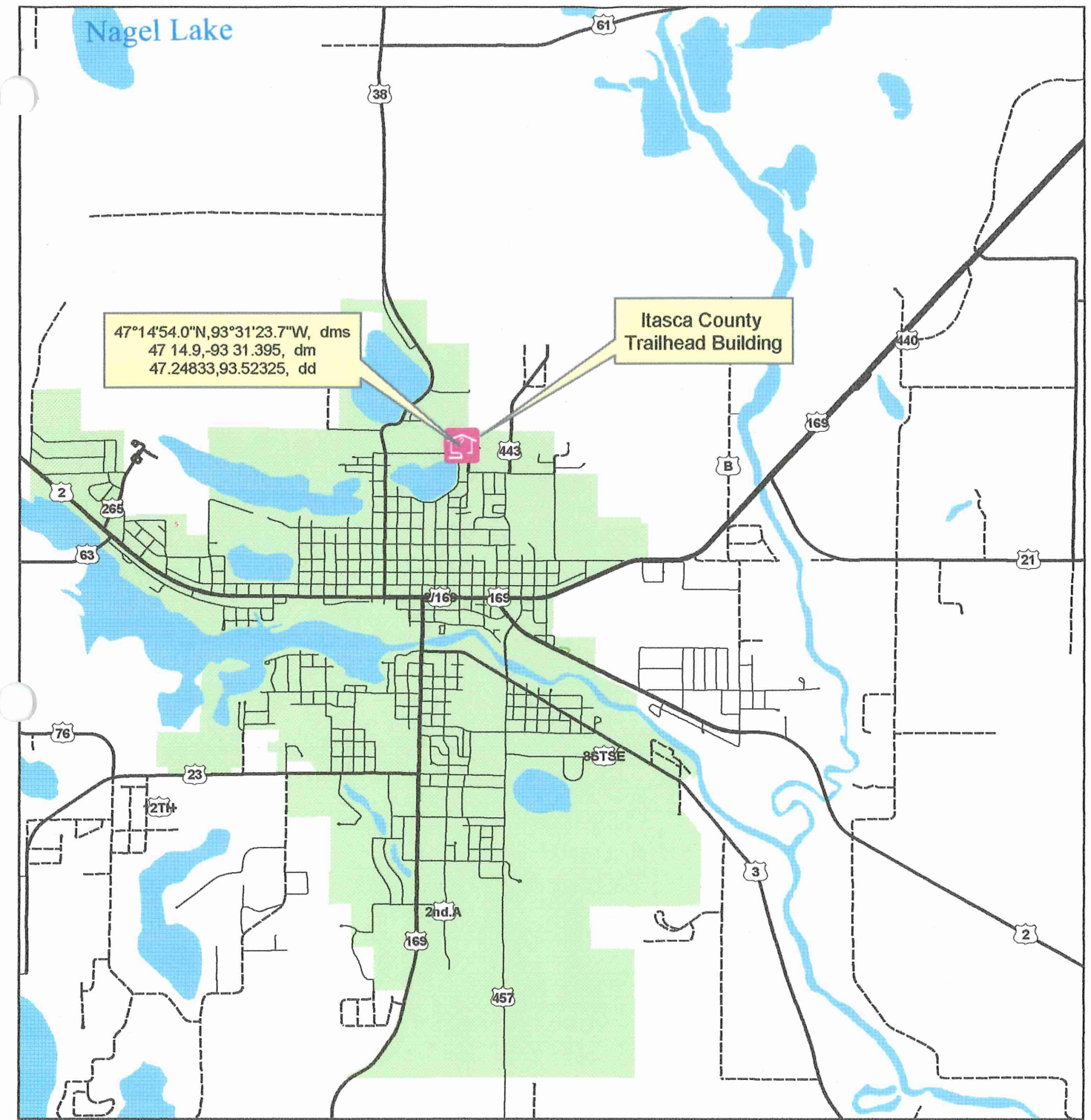

0 1,200 2,400 4,800 7,200 9,600 Feet



Itasca Geographic Information System
on support through automation

RIGHT - ITASCA COUNTY
ALL RIGHTS RESERVED

No reproduction of this map is allowed by any
method or in any form without written permission.



This information is a compilation of
data from different sources with
varying degrees of accuracy and requires
a qualified field survey to verify.

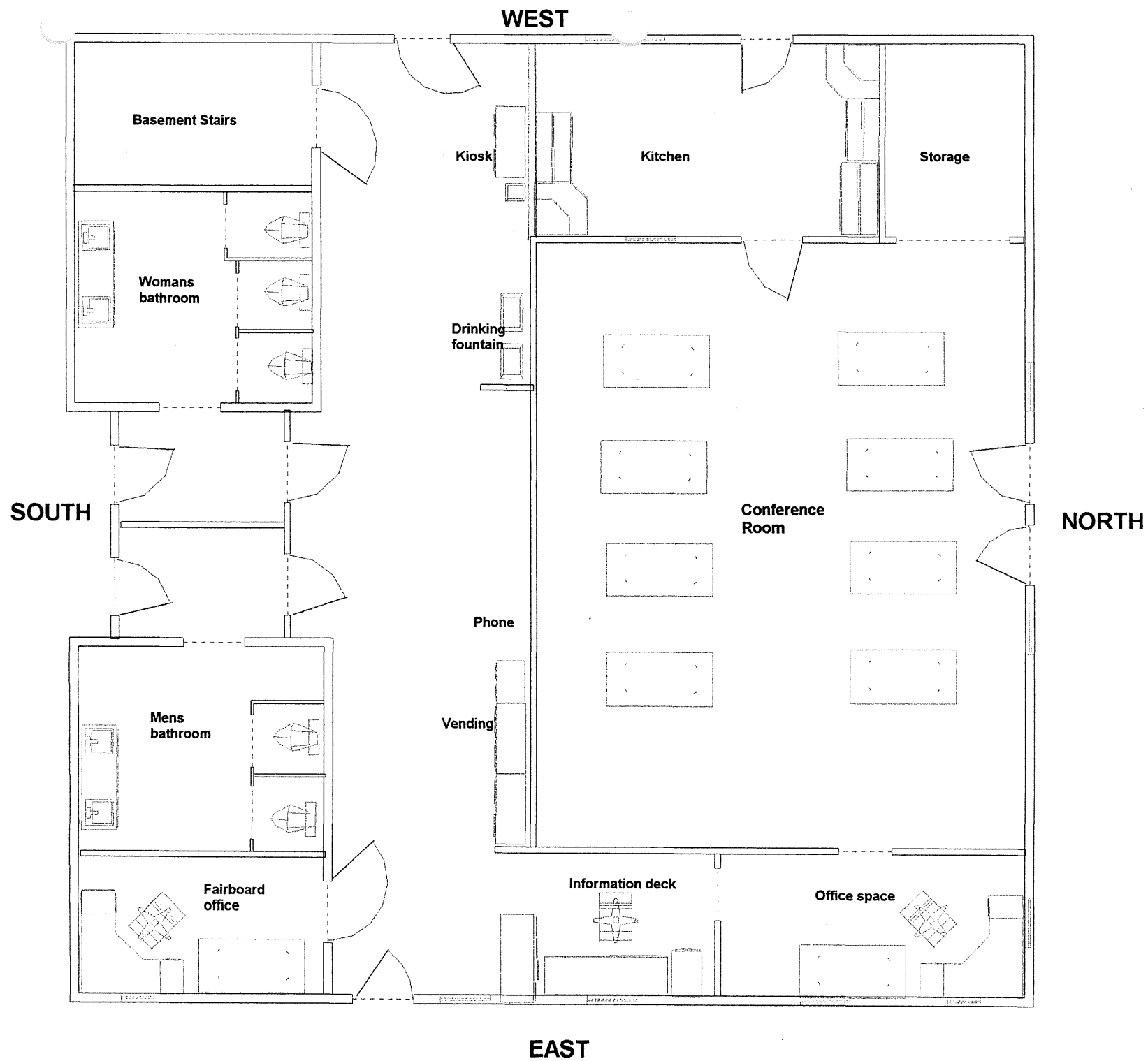

LCMR Work Program Final Report

Date of Report:

~~February 26, 2003~~; **June 19, 2003**

LCMR Final Work Program Report**Date of Next Status Report:**

~~January 30, 2002; July 30, 2002; January 30, 2003; June 30, 2003~~; **Final Report**

Date of Work program Approval:

July 01, 2001

Project Completion Date:

June 30, 2003

LCMR Work Program 2001**I. PROJECT TITLE:**

Regional Trailhead Building

Project Manager:

Roger Clark, Park System Manager

Affiliation: Itasca County

Mailing Address: 123 NE 4th St. Grand Rapids, MN 55744

Telephone Number: (218) 327-7347

E-Mail: roger.clark@co.itasca.mn.us

Fax: (218) 327-7334 327-2848

Web Page address: NA

Total Biennial Project Budget:	\$ 135,000.00
\$ LCMR Appropriation	0.00; \$135,000.00 to be paid
- \$ Amount Spent:	0.00; <u>\$135,000.00</u>
= \$ Balance:	\$ <u>135,000.00</u>; 0.00

Legal Citation: ML 2001, [Chap. 02], Sec. [14], Subd. 05n.

Appropriation Language:

\$ 135,000.00 is from the future resources fund to the commissioner of natural resources for an agreement with the Itasca County Land Department to complete construction of a trailhead building at the Itasca County Fairgrounds to serve regional trail users.

II. And III. FINAL PROJECT SUMMARY:

We have successfully completed the construction of the Itasca County Regional Trailhead Building located at the Fairgrounds in Grand Rapids, MN. The facility is approximately 5000 square feet in size. This facility is designed to function as a multi-purpose trail user information center, including external and internal kiosks, a contact station, handicapped accessible restrooms, a multi-purpose meeting room for trail user groups, training needs, and other activities, and office space for the County Park System and the Itasca County Agricultural Association. Grand Rapids is a popular tourist area for thousands of visitors. Many visitors are including recreational trail use in their vacation plans. This facility is the starting/ending point for several well known and popular public recreational trails

The **State Taconite Snowmobile Trail** running from Grand Rapids to Ely (170 miles), connecting hundreds of miles of snowmobile trail. External kiosk and bathroom facilities are available during daylight hours and internal information will be made available during special events.

The **Itasca County bike trail** running 6 miles north to Gunn Park located along the Highway 38 National Scenic Byway and,

The **Mesabi Bike Trail** (bituminous), currently being developed from Grand Rapids to Ely, connecting 20 plus Iron Range communities (132 miles in length). As this trail gains more popularity, this facility will be made available to thousands of visitors to the Itasca County area. This facility is the first of several main trailheads which are planned to be located along the Mesabi Bike Trail.

This project has been a great success and will provide many services to the community while enhancing local tourism well into the future. Please see the attached abstract for additional information.

IV. OUTLINE OF PROJECT RESULTS:

Result 1: Professional Services; total \$39,313.99

Other Funds: \$ 36,794.55 plus Misc. @ \$2,519.44 for a total of \$39,313.99

Balance: \$0.00

Personnel \$ 0.00

Equipment \$ 0.00

Development \$ 36,794.00 construction design plans.

\$39,313.99 Paid by other Funds

Acquisition \$ 0.00

Other Plus \$2,519.44 for Misc. such as advertisements, soil boring and fuel tank setup.

Completion Date: ~~August 2001 Sept. 2002~~ Feb. 03, 2003

Result Status: Architect continued with the project throughout the construction phase. Savings were made possible by having County staff available to help with construction supervision and inspection. Change orders created an additional work load for the Architect which

exceeded the estimated contract. Change orders were also kept down to a minimum on this project.

Result 2: **Site Work; \$19,666.00 Total**
 Other Funds: \$19,666.00 (paid with other funds)
 Balance: \$0.00

Personnel \$ 0.00
Equipment \$ 0.00
Development \$ \$19,666.00 Excavation, filling, grading.
Acquisition \$ 0.00
Other LCMR Funds: \$0.00

Completion Date: ~~June 2002~~ **August 2002**

Result Status: **Contract saving and deducts were made possible by using County staff and work crews to complete final landscapes and erosion control measures. Seeding was replaced by sod due to the late growing season and to enhance the final visual results.**

Result 3: **Building Construction; \$418,327.00**
 Other Funds: \$283,327.00
 LCMR Funds: \$ 135,000.00 To be paid
 Balance: 0.00

Personnel \$ 0.00
Equipment \$ 0.00
Development **\$418,327.00** Building Construction and materials. (\$437,993.00 total contract with Hawk Construction minus earth work of \$19,666.00)
Acquisition \$ 0.00
Other

Completion Date: **June 19, 2003**

Result Status: Due to \$13,093.00 in change orders the original contract with Hawk Construction went from \$424,900.00 to \$437,993.00. On a project this size we were able to keep change orders down to a minimum. The final product was further enhanced by improved landscaping and the addition of a basement which improved the placement of utilities and any future technological additions which may be needed for kiosk and visitor information. The Itasca County Park System will be expending funds from our account to take care of the overage that was not covered by other grants during the planning of this project. Please see the attached Abstract for additional information as to the success of this project.

V. TOTAL PROJECT BUDGET:

\$ 135,000.00 from LCMR will be used for the construction of the facility. Total project cost to be **\$477,306.99**

All Results: Personnel: \$

All Results: Equipment: \$

All Results: Development: \$477,306.99

All Results: Acquisition: \$

All Results: Other: \$

TOTAL BUDGET: \$

Building construction

(Restrooms, office, multi-purpose meeting room,
kiosk and visitor information) **Actual**

2872 sq. ft. @ \$126/sq. ft. \$418,327.00 (\$135,000.00 from LCMR with \$283,327.00 from other funds)

Site Work \$ 19,666.00 (other funds)

Professional services \$ 36,794.55 (other funds)

Other Cost \$ 2,519.44 (other funds)

Total Cost \$477,306.99

A. SEE ATTACHMENT A and Billing Data Sheet at the end of this report.

VI. PAST, PRESENT AND FUTURE SPENDING:**A. Past Spending:**

Land owned by Itasca County

Preliminary architectural services paid by Itasca County in 2000 -\$1,500

B. Current and Future Spending:

Current Funding includes:

Itasca County Challenge Grant	\$ 62,896.00	In hand
Blandin Foundation	\$150,000.00	In hand
Federal Highway recreation grant	\$ 90,000.00	In hand
Volunteers for the Handicapped	\$ 7,215.00	In Hand
Multiple Sclerosis Society	\$ 10,000.00	In Hand
LCMR	\$135,000.00	Pledged
Grand Rapids Township	\$ 5,000.00	In hand
Itasca Co. Trails Task Force	<u>\$ 10,000.00</u>	<u>In hand</u>
	<u>\$470,111.00</u>	

Minus \$8,550.00 to Fair Board from Blandin Grant for grant writing = \$461,561.00 Total Budget

C. Project Partners:

Project Partners: At no cost to the project. @

Itasca County	\$ 62,896	
Blandin Foundation, Liam Clark	\$ 150,000	
MN-DNR Trails & Waterways, Bob Moore	\$ 90,000	(Federal Highway Grant)
Volunteers for the Handicapped	\$ 7,215	
Multiple Sclerosis Society	\$ 10,000	
Grand Rapids Township	\$ 5,000	
LCMR	\$ 135,000	Pledged
Itasca Co. Trails Task Force	\$ 10,000	
Fair Board, Ron Oleheiser		Support
Park & Rec. Commission, Michelle Heiker		Support
City of Grand Rapids, Marilyn Isaacs		Support
G. R. Chamber of Commerce, Sue Helmbrecht		Support
G. R. Convention/Visitors Bureau, Cheri Bialke		Support
St. Louis/Lake RRA, Bob Manzoline		Support
Mesabi work Group, Cavour Johnson		Support

D. Time: June 2001 to June 2003

VII. DISSEMINATION: The Grand Rapids Trailhead Building is the first of several large and small trailheads which will be placed along the Mesabi Bike Trail. The large sites will include Grand Rapids, Hibbing, Chisholm, Virginia, and Ely. Smaller communities along the trail will have small stop-in kiosk trailheads to serve the trail users. All of these sites will be identified on the Mesabi Trail Web page and all printed maps. The Grand Rapids Visitor and Convention Bureau will be provided trail maps and Trailhead information to distribute. The County and Fair Board will be renting out the meeting room for community events.

VIII. LOCATION:

Itasca County Fairgrounds

1336 NE 3rd Ave.

Grand Rapids, MN 55744

Itasca County is the owner of the property and the Itasca County Fair Board manages the property and will also be a partner in the management and maintenance of the new trailhead building. Please see the attached map.

IX. REPORTING REQUIREMENTS:

Periodic work program progress reports will be submitted not later than

January 30, 2002

July 30, 2002

January 30, 2003

A final work program report and associated products will be submitted by August 6, 2003, or by the completion date as set in the appropriation.

X. RESEARCH PROJECTS: N/A

The commission will not allow office space rental fees or salary payments to officers or directors, this applies to ALL PROJECTS. See page 9 for Eligible and Ineligible expenses. GENERAL OTHER WILL NOT BE ACCEPTED. BE SPECIFIC AND USE AS MANY LINES AS NECESSARY.

Project Number: REC 46

Attachment A Deliverable Products and Related Budget												
2001 LCMR Project Biennial Budget				Objective/ Result								
	Result 1 Budget:	Result 1 Current Invoice:	Result 1 Balance:	Result 2 Budget:	Result 2 Current Invoice:	Result 2 Balance:	Result 3:	Result 3 Current Invoice:	Result 3 Balance:	PROJECT TOTAL: \$460,000.00 - \$477,306.99		
Budget Item (Title of Result)	Design and Engineering			Excavation , filling, and grading contract			Title Building Contractor for Construction			BUDGET TOTAL: \$461,561.00	CURRENT INVOICE TOTAL	Balance Total
Wages, salaries & benefits - Be specific on who is paid \$												
Contracts												
Professional/technical (with whom?) With Roger Saccoman Architecture for \$28,500.00 Plus expenses. Plus Misc. @ \$2,519.44	\$61,748.00 - \$36,764.55 Roger Saccoman Arch. Other funds not LCMR	\$0.00 - \$36,764.55	\$61,748.00 - \$0.00 NA							\$61,748.00 \$36,794.55	\$0 \$36,794.55 paid by other funds	\$61,748.00 \$0.00 NA
Other contracts (with whom?) Construction Contractor not known to date. Contract With Hawk construction of grand Rapids, MN \$424,900.00 Plus \$13,093.00 for change orders.							\$135,000.00 LCMR \$283,327.00 Other Funds Contract for the Construction of a 2872 sq. ft. building with restrooms, office, multi use meeting room, kiosk, and visitor information center	<u>\$283,327.00 paid from other funds With \$135,000.00 expended from County Funds and billed to LCMR at this time.</u>	\$361,872.00 - \$28,220.00 Plus - \$406,780.00 not billed to LCMR on - the Jan. 03 Report - \$135,000.00 billed to LCMR with final report	\$361,872.00 - \$416,163.00 - \$418,327.00	\$0.00 - \$386,933.00 - \$283,327.00 paid by other funds \$135,000.00 billed to LCMR	\$361,872.00 \$28,220.00 Plus - \$406,780.00 not billed to LCMR on the Jan - 03 Report - 0.00 when paid by LCMR
Other land improvement (for what?) Contract with Hawk construction of Grand Rapids, MN				\$36,187.00 - \$21,420.00 - \$19,666.00 Excavation, filling, grading, utilities Other funds not LCMR	\$0.00 - \$16,760.0 - \$19,666.00 other funds NA	\$36,187.00 - \$4,670.00 - \$0.00 NA			\$36,187.00 \$21,420.00 - \$19,666.00 savings due to using county crew to finish.	\$0.00 \$16,760.00 - \$19,666.00 paid by other funds	\$36,187.00 \$4,670.00 \$0.00 NA	
Miscellaneous (for what?) Fuel tank and soil boring									Other expenses \$2,519.44	Other expenses \$2,519.44	\$2,519.44 Fuel Tank and Soil Boring	\$0
COLUMN TOTAL	\$61,748.00 - \$36,764.55			\$36,187.00 - \$21,420.00 - \$19,666.00			\$361,872.00 \$416,163.00 due to change orders \$418,327.00		Other expenses \$2,519.44	\$442,996.00 \$477,306.99 \$135,000.00 from LCMR	\$15,745.99 Over Budget	



LCMR Abstract

2001 Project Abstract

For the period ending June 30, 2003

PROJECT TITLE:

Regional Trailhead Building, Grand Rapids, MN

Project Manager: Roger Clark, Park System Manager

Organization: Itasca County

Mailing Address: 123 NE 4th St. Grand Rapids, MN 55744

Telephone Number: (218) 327-7347

E-Mail: roger.clark@co.itasca.mn.us

Fax:(218) 327-2848

Web Page address: NA

Fund: Minnesota Resource Fund Project

Legal Citation: ML 2001, [Chap. 02], Sec. [14], Subd. 05n.

Appropriation Amount: \$ 135,000.00

Overall Project Outcome and Results

We have successfully completed the construction of the Itasca County Regional Trailhead Building located at the Fairgrounds in Grand Rapids, MN. The facility is approximately 5000 square feet in size. This facility is designed to function as a multi-purpose trail user information center, including external and internal kiosks, a contact station, handicapped accessible restrooms, a multi-purpose meeting room for trail user groups, training needs, and other activities; and office space for the County Park System and the Itasca County Agricultural Association. Grand Rapids is a popular tourist area for thousands of visitors. Many visitors are including recreational trail use in their vacation plans. This facility is the starting/ending point for several well known and popular public recreational trails

The **State Taconite Snowmobile Trail** running from Grand Rapids to Ely (170 miles), connecting hundreds of miles of snowmobile trail. External kiosk and bathroom facilities are available during daylight hours and internal information will be made available during special events.

The **Itasca County bike trail** running 6 miles north to Gunn Park located along the Highway 38 National Scenic Byway and,

The **Mesabi Bike Trail** (bituminous), currently being developed from Grand Rapids to Ely, connecting 20 plus Iron Range communities (132 miles in length). As this trail gains more popularity, this facility will be made available to thousands of visitors to the Itasca County area. This facility is the first of several main trailheads which are planned to be located along the Mesabi Bike Trail.

This project has been a great success and will provide many services to the community while enhancing local tourism well into the future.

Project Results Use and Dissemination

Primary results; this facility is providing

1. Community information, (hotels, motels, food, directions, and other services to enhance the trail user experience. Current counts for the Mesabi Trail are around 400 to 800 users per week entering and exiting the trailhead area.
2. Improved overall user safety, information and experience for all.
3. Trail interpretation, as these trails traverse mining and timbered areas of Northeast Minnesota.
4. A learning center to bring user groups together for safety training, environmental education, and trail user activities.

Currently several groups have been scheduled to make use of the facility, they include the:

International Snowmobile Hall of Fame

DNR Trails and Waterways Grooming Demo

North Country National Scenic Trail Open House

DNR staff Training and MCC program Training

4H Horse Clinic

Itasca County Fair

Chippewa National Forest Planning Committee

Itasca County Sheriff/DNR ATV Training Course

Congressman Jim Oberstar's 2003 Bike Ride

Itasca County Vintage Car Show and Swap Meet

Local meeting groups include: Horse clubs, Fairboard, County Park Commission, Car Club, Kiwanis Club, 4H, Family Reunions, and Baby Showers.

We would like to thank you for your participation with this project and we invite your staff to stop in and visit the facility while you are in the Grand Rapids area. You will also be receiving an invite to a picnic lunch at the New Trailhead Building for Congressman Jim Oberstar's Annual Bike Ride on August 23rd, 2003. The Itasca County Trails Task Force will be providing the lunch at the end of the ride.

BILLING DATA SHEET

Invoice # _____ Project # 0009-99-2A Federal ID# 41-6005810

Project Title Grand Rapids Trailhead Center Project

Local Sponsor Itasca County County Name Itasca County

Contractor Vendor/ Grantor	Description	Payment #	Check #	Check Date	\$ Funds Spent Out	Funds Received
Roger Saccoman Architecture 05/06/02	Professional Services/ Schematic Design & Design Development	1A & 1B	224199	05/16/02	\$15,675.00	
Herald Review 06/02/02 Grand Rapids, MN	Advertisement For Bids	#1	81459	06/28/02	\$ 51.08	
Roger Saccoman Architecture 06/16/02	Professional Services Construction Documents	#2	82125	07/26/02	\$ 7,944.05	
Braun Intertec 07/02/02	Soil Boring & Testing	#1	82391	08/30/02	\$ 1,200.00	
Roger Saccoman Architecture 07/08/02	Bid Administration Architectural Fees	#3	224543	09/12/02	\$ 7,769.73	
Hawk Construction 08/01/02	Earthwork, Footings, Pre-Cast Planks, Materials	#1	224568	09/16/02	\$19,666.00	
Hawk Construction 08/27/02	Earthwork, Concrete, Structural Steel, Carpentry	#2	83456	10/25/02	\$96,474.00	
Hawk Construction 09/27/02	Carpentry, Masonry, Materials, Mechanical	#3	224724	11/07/02	\$98,692.00	
Roger Saccoman Architecture 11/02/02	Reimbursable plus Construction Administration	#4	84171	11/29/02	\$ 2,855.77	
Trails Task Force 12/18/02	Grant To add Basement to project.	#1	96482	12/18/02	0.00	\$10,000.00
MN DNR Trails and Waterways 12/23/02	Grant request for State Trails Fund Grant	#1	96587 Elec. Wire	12/23/03	0.00	\$90,000.00
				Sub Total as of 12/23/02	\$250,327.63	\$100,000.00

BILLING DATA SHEET

Project Title Grand Rapids Trailhead Center Project

Local Sponsor Itasca County

Data Sheet Continued Page 2

Contractor Vendor/ Grantor	Description	Payment #	Check #	Check Date	\$ Funds Spent Out	Funds Received
				Sub Total From Above	\$250,327.63	\$100,000.00
Hawk Construction 10/29/02	Concrete work, Insulation, Siding, Trim, Windows	#4	84526	12/27/02	\$84,067.00	0.00
Northwest Gas 11/20/02	Set and Lease of Propane tank	#1	84653	12/27/02	\$1,268.36	0.00
Hawk Construction 11/27/02	Finish Carpentry, Doors, Bathroom tile, painting, mech.,	#5	85099	01/31/03	**\$52,323.00	0.00
I.T.C. Agricultural Association 01/07/03	Grant request –Blandin Foundation	#1	11456	02/04/03	0.00	\$163,665.00
I.T.C. Agricultural Association 02/10/03	Grant request – Challenge Grant Amount	#2	11472	02/10/03	0.00	\$ 62,896.00
Hawk Construction 12/27/02	Bathroom tile, Painting, Acous. Ceiling, Mechanical, fixtures	#6	225068	02/13/03	**\$52,461.00	0.00
Roger Saccoman Architecture 02/03/03	Reimbursable plus Construction Administration	#5	225069	02/13/03	\$2,550.00	0.00
Hawk Construction 03/04/03	Electrical install	#7	86004	03/28/03	\$1,513.00	0.00
Hawk Construction 06/12/03	Finished masonry work, earth work leveling	#8	225483	06/16/03	**\$5,035.00	0.00
Hawk Construction 06/19/03 work completed	Change orders and final retention funds	#9	225548	07/09/03	**\$27,762.00	** notes LCMR funds
	LCMR Grant Request					\$135,000.00
				Total as of 06/19/03	\$477,306.99	\$461,561.00 When received from LCMR

FINAL REPORT

2001 Project Abstract
For the Period Ending June 30, 2003

See edit
SIM

PROJECT TITLE: Forest History Center Interpretive Trail
Project Manager: Robert "Skip" Drake
Affiliation: Minnesota Historical Society,
Mailing Address: Forest History Center, 2609 County Road 76, Grand Rapids, MN
55744
Telephone Number: 218-327-4482
E-mail: skip.drake@mnhs.org
Fax: 218-327-4483
Web Address: www.mnhs.org/foresthstory

Total Biennial Project Budget: \$90,000
LCMR Appropriation: \$ 90,000
Amount Spent: \$49,714.43 6-30-2003
Balance: \$40,285.57 6-30-2003

Legal Citation: LAWS 2001, First Special Session, Chapter 2, Section 14,
Subd.5(l).

Appropriation Language: Forest History Center Interpretive Trail--\$90,000 is
from the future resources fund to the Minnesota Historical Society to design and
upgrade trails at the Forest History Center in Grand Rapids.

21 The complexities and mysteries of the forest are better understood when one
can become immersed in wooded surroundings and experience nature's
solitude. For a physically challenged person, the natural barriers associated
with heavily wooded forests make it nearly impossible for them to experience
these feelings. The newly redesigned and re-engineered Forest of Today Trail
at the Minnesota Historical Society Forest History Center makes this
possible for all persons regardless of their physical limitations.

The one mile long, Forest of Today trail, an integral part of a 3-mile trail
system, has been re-graded and resurfaced with class five aggregate to be
fully ADA wheel chair accessible. It has been augmented with two Minnesota
Historical Society funded learning stations designed to enhance the usability
of the trail and to increase educational programming opportunities for all
persons.

Twenty thousand people, including between 4000-5000 students visit the
Center annually and experience how the Center connects people to forests
through educational, meaningful and entertaining experiences so they
appreciate and understand the importance of forests past, present and future
to their lives. To fully integrate the upgraded trail and learning stations, new
educational programs are being developed by forestry experts and exhibit
professionals that will take students and the public into the woods for
meaningful and memorable immersion experiences.

FINAL REPORT
WORK PLAN Project Status Completion Report

June 30, 2003

LCMR WORK PROGRAM UPDATE REPORT

Date of Final Report: August 6, 2003

Date of Workprogram Approval: June 29, 2001

Project Completion Date: June 30, 2003

LCMR Work Program 2001

PROJECT TITLE: Forest History Center Interpretive Trail

Project Manager: Robert "Skip" Drake

Affiliation: Minnesota Historical Society,

Mailing Address: Forest History Center, 2609 County Road 76, Grand Rapids, MN 55744

Telephone Number: 218-327-4482

E-mail: skip.drake@mnhs.org

Fax: 218-327-4483

Web Address: www.mnhs.org/foresthstory

Total Biennial Project Budget: \$90,000

LCMR Appropriation: \$ 90,000

Amount Spent: \$49,714.43 6-30-2003

Balance: \$40,285.57 6-30-2003

Legal Citation: LAWS 2001, First Special Session, Chapter 2, Section 14, Subd.5(l).

Appropriation Language: Forest History Center Interpretive Trail--\$90,000 is from the future resources fund to the Minnesota Historical Society to design and upgrade trails at the Forest History Center in Grand Rapids.

I. PROJECT SUMMARY AND RESULTS: Upgrade one mile of existing trail. This trail has reached the end of its useful life, and needs resurfacing to meet current standards, including compliance with ADA requirements. The trail will be reconstructed with crushed aggregate and linked to an existing ADA compliant trail completed in 1997. This trails services the Forest History Center as a self-guided nature trail and is part of the Center's Woodland Stewardship - Public Education program to enhance the public awareness of goals, methods and quality of life issues of forest management decisions and actions. Once completed this trail will be used by 20,000 visitors to the Forest History Center including 5,000 students on school field trips studying a multidisciplinary course of study including social studies, natural sciences and environmental science.

III. PROGRESS SUMMARY:

Staff from the Northern Department—Historic Sites and Forest History Center appointed a Forest History Center Interpretive Trail Advisory Committee. The Advisory Committee is comprised of professionals knowledgeable in public nature trail layout and construction, forestry and forest resource management, ecology and environmental education and will assist the Center in the trail project. The five-member Advisory Committee met on June 18, 2002 with Forest History Center staff and discussed interpretive trail layout and design concepts, areas along the trail that will match the site's Woodland Stewardship Plan goals and the mission and goals for the Center. The Committee members also discussed how the trail would best serve multiple uses such as: school groups, natural resource and forestry students and the general public. Center staff will incorporate those ideas into the overall trail project. The Advisory Committee will meet with the project's landscape design architect in July of 2002. Due to a delay in signing the contract, the Advisory committee Meeting was postponed until Sept. 17, 2002.

Society staff also prepared a Request for Proposals for Professional Planning, Design & Engineering Services for the Interpretive Trail Project. The RFP is currently out for proposals from landscape design and architectural firms. All proposals are required to be returned by July 15, 2002. The Society awarded the design and engineering contract on August 27, 2002.

S E H was awarded the design and engineering contract and has completed survey work and trail renovation specifications. The bid package was prepared and the notice published in the State Register, Construction Bulletin and the Grand Rapids Herald Review as well as being sent directly to several area contractors. A mandatory pre-bid meeting is scheduled for January 6, 2003 with the bid opening on January 14, 2003. (12-23-02)

503 Request for Purchases were written to encumber funds to cover estimated construction trail renovation--\$49,000; to S E H for \$8905 for design and engineering plus an additional \$1000 for added design work for a trail spur and \$1000 for design of 2 shelters along the trail; and \$700 to multiple vendors for the advertising for bids. (12-23-02)

Summary of expenditures
S E H trail design \$10,905

Architectural Resources structure design \$7450
 Archeology review \$619.66
 Advertising for bids \$850.00
 3 B's Construction completed the trail work per contract specifications \$24,070.70
 Trail spur construction \$608.40 3 B's Construction
 Trail Shelter groundwork preparation including excavation, landing pads, aggregate
 3 B's Construction \$5210.68
 Total \$49,714.43 LCMR funded
 Trail Shelter Construction funded by Minnesota Historical Society \$46,104.65
 Total project value \$95,819.08

IV. OUTLINE OF PROJECT RESULTS:

- ☐ Result 1: Upgrade one mile of existing trail. The trail will be reconstructed with crushed aggregate and linked to an existing ADA compliant trail completed in 1997. Once completed this trail will be used by 20,000 visitors to the Forest History Center including 5,000 students on school field trips studying a multidisciplinary course of study including social studies, natural sciences and environmental science.

- ☐ Result 2: Construct two trail shelters as designed with LCMR funding. Funds for the shelters provided by the Minnesota Historical Society

Amendment:

Design for the one mile trail upgrade and ¼ mile trail spur
\$10,905 S E H

Design for trail shelters/learning stations. Trail structures must be ADA compliant and accessible from the trail. \$7,450 Architectural Resources

Bid advertising for trail and trail shelters \$850

Archeology prior to trail construction \$619.65

Trail construction \$24,070.70 3-B's Construction

Trail spur construction \$608.40 3 B's Construction

Trail shelter groundwork i.e. excavation, landing pads, aggregate

\$5210.68 3 B's Construction

Total 49,714.43

Two handicapped accessible trail shelters/learning stations were built with Minnesota Historical Society dollars. The MHS contribution is \$46,104.65. The total value for the project is \$95,819.08

Result 1 LCMR Budget: \$ 90,000

Balance: \$40,285.57

☐ Personnel: \$ 0

☐ Equipment: \$ 0

■ Development: \$ 81,000 \$79,095 (\$49,700 encumbered as of 12-16-02)
\$49,714.43 expended as of 6-30-2003

■ Acquisition: \$ 0

■ Other: Architectural and engineering design services will be secured to draw up plans, create construction drawings and help oversee project contractors.

Result 1 LCMR Budget: \$9,000 \$10,905 (\$10,905 encumbered as of 12-16-02)

Balance: \$0

Completion Date:

■ Result 1 on or before June 30, 2003

Result Status: NA

V. Total Project Budget:

■ All Results: Personnel: \$ 0

■ All Results: Equipment: \$ 0

■ All Results: Development: \$81,000 \$ 79,095 12-23-02
\$95,819.08 complete 6-3-2003 Includes all matching dollars from MHS

■ All Results: Acquisition: \$ 0

■ All Results: Other: \$9,000 \$ 10,905 (increase from original \$9,000 to cover increased architectural fees for additional plan review and survey work—note development phase decreased by \$1,905. 12-23-02

■ Total Budget: \$ 95,819.08

VI. PAST, PRESENT AND FUTURE SPENDING:

A. Past Spending: The Society has funded the ADA compliance on one mile of and existing public trail in 1997 (\$51,000) with crushed aggregate and leveling grades to meet ADA and public needs. The Society annually funds trail upkeep and maintenance through its Forest History Center maintenance line item budget. Over the years, cash and in-kind contributions of materials, equipment, labor and technical assistance have been provided by Blandin Paper Company, Potlatch—Minnesota Wood Products, Department of Natural Resources and the Minnesota Conservation Corps.

B. Current and Future Spending: The Society has sought funding from other private and public sources to enhance the Woodland Stewardship Program—Public Education project. This funding will be utilized to construct a ¼ mile new trail to interconnect the existing trail system with the LCMR funded trail reconstruction project. Once completed this new

trail will connect and complete the Center's Woodland Stewardship Trail Program. Additional funding has been sought to construct and place a total of 18 wayfinding informational-directional signs along the trail system to enable visitors to easily maneuver through the trail system and become active participants in its messages. To aid in this effort, the Trail Guide Brochures will be created to give visitors a physical sense of the overall trail system and information to aid their understanding of forest issues of the past, present and future. This is a \$58,5000 fundraising effort and initial indications are that the Society will be successful in raising those funds. In addition, the Forest History Center will continue to invest its annual maintenance budget to maintain these trails.

C. Project Partners: The Society's Woodland Stewardship Program - Public Education project has great appeal with the timber industry and organizations. Project partners which will provide in-kind and granting support are: Itasca Community College - Natural Resource Program, Independent School District # 318 - Forestry Technical Program, Department of Natural Resources - Region I, Minnesota Forestry Association and UPM - Blandin Paper Company. The Society of American Forester's is considering a partnership with the FHC to provide assistance with a trail signage program identifying the Forest History Center as a state forest education site.

D. Time: NA

VII. DISSEMINATION: The Society views this project as the kickoff project for the Forest History Center's mission of addressing Minnesota's forest management issues and public education. Program information dissemination will occur daily on the enhanced Woodland Stewardship Program Trails through wayfinding - informational signs and trail brochure. The Forest History Center will incorporate the Woodland Stewardship Program into its annual Special Event portfolio and daily special events. School groups (5,000 students annually) will utilize the Woodland Trails in curricula based educational programming. The Center is presently seeking a major grant to expand its land base and establish new trails to add to its Woodland Stewardship Program and expand its public education and forest partnerships. The Society has dedicated staff resources to the redevelopment of the Forest History Center's exhibition program at the Interpretive Building within the next five years to expand on sharing and teaching the forest management program. The Center will be used as an information dissemination site for other forest management venues throughout northern Minnesota. Staff from the Forest History Center and MHS Education Department are developing an outreach program to schools based on the successful "Historian in the Classroom" program. This program will work with regional schools to take the message of forest change, challenge and responsibility out to Minnesota's students, beyond the Forest History Center's walls. MHS exhibits trail team has begun the process of researching and writing trail text for the signs. Trail sign furniture has been ordered with MHS exhibit funds. Sign fabrication and installation is expected by June 2004. Blandin Paper

has been approached about a hands-on paper making activity utilizing the trail entrance shelter. Plans call for education activities focusing on forest management, plants, animals, insects and river ecology to be based out of the riverside screen house. Classes are being planned for Spring 2004

VIII. Location: The Forest History Center and site of the Woodland Stewardship Program - Public Education is located @ 2609 County Road 76, Grand Rapids, Itasca County, MN 55744. All of the program project will take place on land owned and operated by the Minnesota Historical Society. Site map attached.

IX. REPORTING REQUIREMENTS: Periodic workprogram progress reports will be submitted not later than:

- ☒ June 30, 2002
- ☒ December 31, 2002
- ☒ June 30, 2003 upon completion of project
- ☒ Final report due August 6, 2003

X. RESEARCH PROJECTS: NA