

# FINAL REPORT

## ARBORETUM LAND ACQUISITION AND WETLAND RESTORATION – CONTINUATION

13(g) \$700,000 TF/ Match

Prof. Peter J. Olin

Minnesota Landscape Arboretum, University of Minnesota

3675 Arboretum Drive, PO Box 39

Chanhassen, MN 55317

Phone: (612) 443-2882

Fax: (612) 443-2521

E-Mail: olin002@maroon.tc.umn.edu

Web Page Address: [www.arboretum.umn.edu](http://www.arboretum.umn.edu)

### Overall Project Outcome and Results

The objective of the Arboretum's land purchase is to protect its watershed from development. During this phase, the Arboretum purchased 30 acres at a total cost of \$1,253,993 (\$627,315 from the LCMR and \$626,678 private match). There are now 137 acres left to acquire.

Arboretum research and education programs are recognized internationally, and over 225,000 people visit annually. A major part of the visitor experience is the ambience of woodland, prairie, wetlands, gardens, and model landscapes, all set in prime land in the western metro area.

Control of all lands within the roadways surrounding the Arboretum core will protect water quality and native plant habitat, and preserve the visitor experience. This land includes over 90% of the Arboretum's watershed.

Project completed June 30, 2002.

# FINAL REPORT

**Date of Report:** July 1, 2002

LCMR Final Work Program Report and Amendment Request

## LCMR Work Program 1999

**I. PROJECT TITLE:** C14 Land Acquisition and Wetlands Restoration - Continuation

**Project Manager:** Prof. Peter J. Olin, Director

**Affiliation:** Minnesota Landscape Arboretum, University of Minnesota

**Mailing Address:** 3675 Arboretum Drive, PO Box 39, Chanhassen, MN 55317

**Telephone Number:** 952-443-1412

**E-Mail:** peter@arboretum.umn.edu

**Fax:** 952-443-2521

**Web Page:** <http://www.arboretum.umn.edu>

### Total Biennial Project Budget:

\$ LCMR:	\$ 700,000	\$ Match:	\$ 700,000
- \$ LCMR Amount Spent:	627,315	- \$ Match Amount Spent:	626,678
<hr/>		<hr/>	
= \$ LCMR Balance:	\$ 72,685	= \$ Match Balance:	\$ 73,322

**A. Legal Citation:** ML 99, [Chap.231], Sec.[16], Subd. 13g.

C14 Land Acquisition and Wetlands Restoration - Continuation

#### Appropriation Language

**Carryforward Language:** ML 2001, 1<sup>st</sup> Special Session, Chp 2, Sec. 14, Subd. 18, paragraph

(a) the availability of the appropriations for the following project is extended to June 30, 2002:

ML 1999, Chp 231, Sec. 16, Subd. 013 (g), Arboretum land acquisition and wetlands restoration – continuation.

(g) Arboretum Land Acquisition and Wetlands Restoration – Continuation \$350,000 the first year and \$350,000 the second year are from the trust fund to the University of Minnesota for an agreement with the University of Minnesota Landscape Arboretum Foundation for the third biennium for land acquisition. The priority is to acquire approximately 40 acres of land within the Arboretum boundary before completing the Spring Peeper Meadow wetland restoration. This appropriation must be matched by at least \$700,000 of nonstate money.

## II. and III FINAL PROJECT SUMMARY:

The objective of the Arboretum's land purchase is to protect its watershed from development. During this phase, the Arboretum purchased 20 acres from Tim and June Russell, and 10 acres from Paul and Carol Paulson, at a total cost of \$1,253,993 (\$627,315 from the LCMR and \$626,678 private match). There are now 137 acres left to acquire.

Arboretum research and education programs are recognized internationally, and over 225,000 people visit annually. A major part of the visitor experience is the ambience of woodland, prairie, wetlands, gardens, and model landscapes, all set in prime land in the western metro area.

Control of all lands within the roadways surrounding the Arboretum core will protect water quality and native plant habitat, and preserve the visitor experience. This land includes over 90% of the Arboretum's watershed.

#### IV. OUTLINE OF PROJECT RESULTS

- Result 1 – At least 40 acres of watershed land will be acquired.

LCMR Budget:	\$ <del>600,000</del> <u>627,315</u>	Match:	\$ <del>600,000</del> <u>626,678</u>
--------------	--------------------------------------	--------	--------------------------------------

Balance:	\$ 0	Match Balance:	\$ 0
----------	------	----------------	------

Completion Date:

Result 1 – The priority as noted in the appropriation language was to acquire approximately 40 acres of land within the Arboretum boundary (Result 1) before completing the Spring Peeper Meadow wetland restoration (Result 2). Land purchased totaled 30 acres for a total cost of \$1,253,993. We were unable to purchase additional lands from the Tschimperle family due to a breakdown in negotiations and inability to reach an equitable agreement in negotiations with either the Russells, Boorsmas, or Hartmans.

- Result 2 – The initial establishment phase of Spring Peeper Meadow will be completed after at least 40 acres of additional watershed land are acquired.

LCMR Budget:	\$ <del>100,000</del> 72,685	Match:	\$ <del>100,000</del> 73,322
--------------	------------------------------	--------	------------------------------

Balance:	\$ 72,685	Match Balance:	\$ 73,322
----------	-----------	----------------	-----------

Completion Date:

Result 2 –No funds were used for this result as we were unable to purchase 40 acres of land.

#### V. DISSEMINATION: NA

#### VI. CONTEXT:

Result 1 -

##### A. Significance:

The issue of buying land is most volatile. If and when a landowner decides to sell is the time we need to buy.

It is the intent to purchase the lands within the highway system surrounding the Arboretum because it will ensure that over 90% of the watershed will be under its control in the future.

Of the properties the Arboretum wishes to acquire, the most critical land purchase is the remaining 90 acres of the Tschimperle property. This property is a very attractive piece of land for development and it is critical that we acquire it now. Once developed, it will be impossible to purchase or control. The other smaller parcels of land are not as readily developed and therefore of lesser concern. We are presently looking at all avenues to acquire the land and are actively moving forward.



This property will protect over 75 acres of Arboretum watershed and it will allow internal circulation between research projects at Highway 5 and Bavaria Road and the rest of the Arboretum.

**B. Time:** We purchased 30 acres of land in three years.

Result 2 –

**A. Significance:**

Spring Peeper Meadow is the only known sedge meadow re-establishment project in the United States which has undertaken the active reintroduction of sedges, grasses, and forbs to establish a biodiverse system. It is a research and learning tool as well as a model. It is a wetland type that retains urban storm runoff and is home to a variety of insects, amphibians, birds, mammals, and native plants. Seasonally flooded wetlands provide critical food to migrating birds early in the season, engage a greater biodiversity than other wetlands, and offer flood water storage.

**B. Time:** NA

**C. Budget Context: (Results 1 and 2)**

This project is part of a long term strategy to acquire lands within the Arboretum's watershed for ecological protection. It also provides the opportunity to develop public models for restoration of native Minnesota landscapes. Matching funds will be from foundations, individuals, and the Minnesota Landscape Arboretum Foundation.

	<b><u>July 1995 - June 1997</u></b> <b>Prior expenditures on this project</b>	<b><u>July 1997 - June 1999</u></b> <b>Prior expenditures on this project</b>	<b><u>July 1999 - June 2001/02</u></b> <b>Expenditures on this project</b>
1. LCMR	\$ 680,000.	\$ 450,000.	\$ 627,315.
2. Other State	\$	\$	\$
3. Non-State Cash	\$ 680,000.	\$ 450,000.	\$ 626,678.
<b>Total</b>	<b>\$ 1,360,000.</b>	<b>\$ 900,000.</b>	<b>\$ 1,253,993.</b>
<b>Result 1 –</b>			
<b>BUDGET:</b>			
<b>Personnel</b>	\$ NA		
<b>Equipment</b>	\$ NA		
<b>Acquisition</b>	\$ 627,315		
<b>Development</b>	\$ NA		
<b>Other</b>	\$ NA		
<b>TOTAL</b>	<b>\$627,315</b>		

Result 2 –

**BUDGET:**

<b>Personnel</b>	\$ NA
<b>Equipment</b>	\$ NA
<b>Acquisition</b>	\$ NA
<b>Development</b>	\$ NA
<b>Other</b>	\$ NA

---

<b>TOTAL</b>	(\$72,685.)
--------------	-------------

**VII. COOPERATION:** Project Manager, Peter J. Olin, Professor and Director, Minnesota Landscape Arboretum. Dr. Susan Galatowitsch, Associate Professor, University of Minnesota, Department of Horticultural Science.

**VIII. LOCATION:** Map attached

# MINNESOTA LANDSCAPE ARBORETUM LAND ACQUISITION PLAN

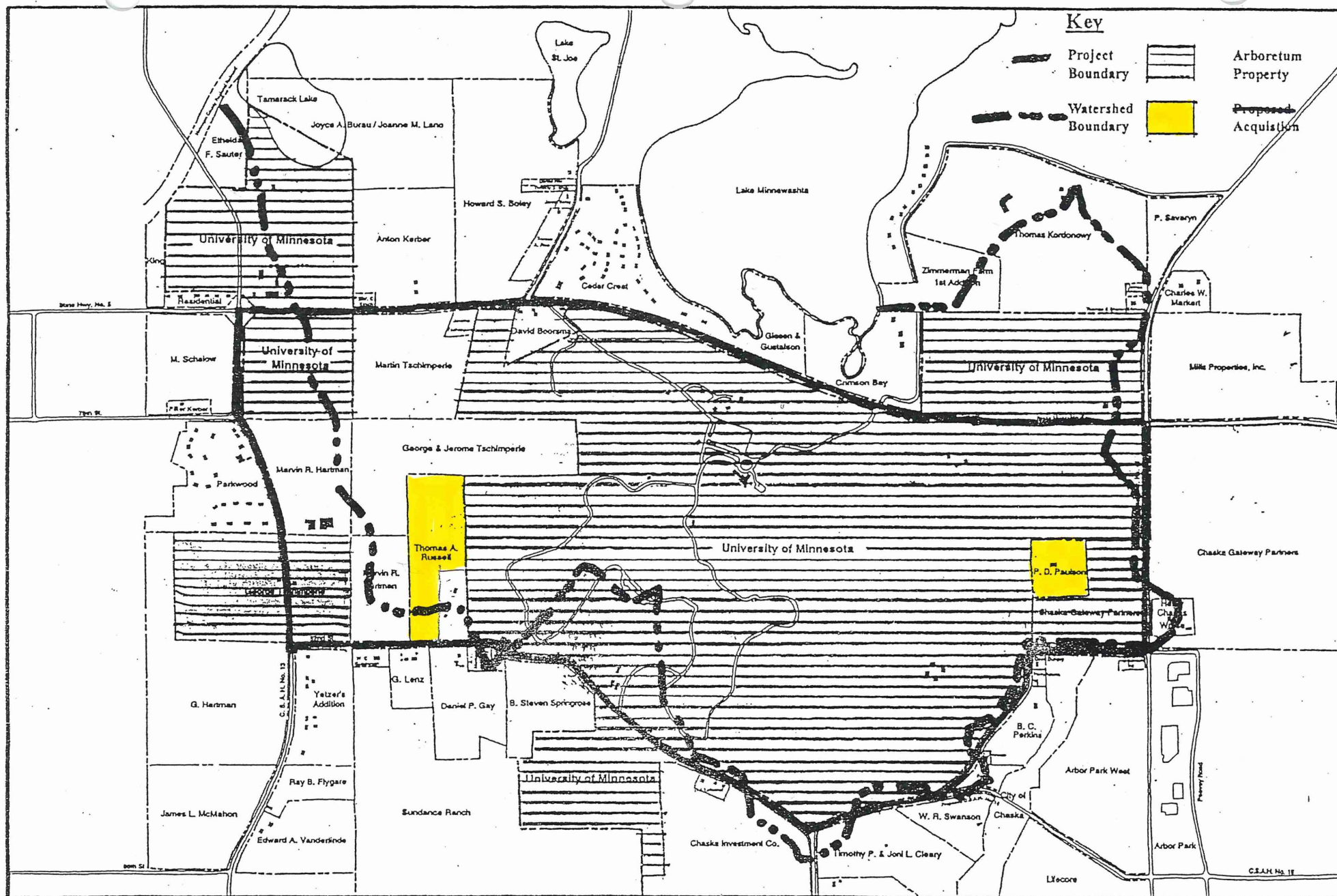

University of Minnesota  
Twin Cities Campus

# Minnesota Landscape Arboretum

## Boundary Map

