

# FINAL REPORT

1999 04d  
FEB 25 2003

## 1999 Project Abstract

For the Period Ending June 30, 2001

**TITLE:** Mesabi Trail Connection  
**PROJECT MANAGER:** Curt Anttila  
**ORGANIZATION:** East Range Joint Powers Board  
**ADDRESS:** PO Box 127  
Aurora, MN 55705

**WEB SITE ADDRESS:**

**FUND:** FRF

**LEGAL CITATION:** ML 1999, Ch. 231, Sec. 16, Subd. 4(d)

**APPROPRIATION AMOUNT:** \$80,000.00

Overall Project Outcome and Results: The Mesabi Trail Connection provided a portion of the link between the Mesabi Trail and the communities of Aurora, Hoyt Lakes, and White. The Mesabi Trail Connection also provided a portion of the link to Biwabik and the Giants Ridge Golf and Ski resort.

Originally this trail link was planned to run from Wynne Ridge Road, where it connects to the Mesabi Trail, to TH135 where it would connect to the Aurora City trail. Due to design changes made to IRRRA's proposed Quarry Golf Course, the Mesabi Trail Connection project had to be rerouted. This delayed the project by almost one year, created funding constraints and additional right-of-way/easement issues, therefore, the trail was only constructed from Wynne Ridge Road (where it connects to the Mesabi Trail) to the Embarrass Lake Public Access. This still completed an important section of the trail, and provides a segway into the next phase of the project.

The 1.98 miles of the Mesabi Trail Connection has an all-weather 10' wide bituminous surface and was constructed to conform to current state and federal accessibility standards. Low Impact Excavators constructed the project and the project engineer was Short Elliott Hendrickson.

Cost estimates and engineering plans for the construction of the remaining portion of the trail link is currently being developed by Short Elliott Hendrickson Engineering. The right-of-way issues for this portion of the trail were resolved in June 2002. Actual construction of the link to the Aurora City Trail will begin when funding for the project is obtained.

### Project Results Use and Dissemination

Almost immediately upon completion of this segment of the trail, bikers, runners, and roller-bladers were all found riding the trail and experiencing this link. Once the next section of the trail is completed, the trail use will increase significantly.

**Date of Report:** July 1, 2002  
**Date of Next Status Report:** LCMR Final Work Program Report  
**Date of Work Program Approval:**  
**Project Completion Date:** June 30, 2002

## **LCMR Work Program 1999**

**I. PROJECT TITLE:** Mesabi Trail Connection

**Project Manager:** Curt Anttila  
**Affiliation:** Economic Development Coordinator  
East Range Joint Powers Board  
**Mailing Address:** PO Box 127  
Aurora, MN 55705-0127  
**Telephone Number:** 218/229-3671  
**E-Mail:** erjpb@cpinternet.com  
**Fax:** 218/229-3561

### **Total Biennial Project Budget:**

<b>\$ LCMR:</b>	<b>\$80,000.00</b>	<b>\$Match:</b>	<b>\$107,524.00</b>
<b><u>-LCMR Amount Spent:</u></b>	<b><u>\$80,000.00</u></b>	<b><u>- \$Match Amount Spent</u></b>	<b><u>\$ 99,964.64</u></b>
<b>= \$ LCMR Balance:</b>	<b>.00</b>	<b>= \$ Match Balance</b>	<b>\$ 7,559.36</b>

### **A. Legal Citation: ML 1999, Chap.231,Sec. 16, Subd. 4(d)**

**Appropriation Language:** \$80,000 is from the future resources fund to the commissioner of natural resources for an agreement with the East Range Joint Powers Board to develop trail connections to the Mesabi Trail with the communities of Aurora, Hoyt Lakes, and White. This appropriation must be matched by at least \$80,000 of nonstate money. This appropriation is available until June 30, 2002, at which time the project must be completed and final products delivered, unless an earlier date is specified in the work program.

**B. Status of Match Requirement:** The Iron Range Resources and Rehabilitation Board, Mineland Reclamation Division, has designated \$30,000.00 for the construction of the Mesabi Trail Connection, in addition, the Town of White has designated \$69,964.64 for the project.

**II. FINAL PROJECT SUMMARY:** The Mesabi Trail Connection provided a portion of the link between the Mesabi Trail and the communities of Aurora, Hoyt Lakes, and White. The Mesabi Trail Connection also provided a portion of the link to Biwabik and the Giants Ridge Golf and Ski Resort.

Originally this trail link was planned to run from Wynne Ridge Road, where it connects to the Mesabi Trail, to TH135 where it would connect to the Aurora City trail. Due to

design changes made to IRRRA's proposed Quarry Golf Course, the Mesabi Trail Connection project had to be rerouted. Rerouting delayed the project by almost one year, increased engineering costs and created additional right-of-way/easement issues, therefore the trail was only constructed from Wynne Ridge Road (where it connects to the Mesabi Trail) to the Embarrass Lake Public Access. This still completed an important section of the trail, and provides a segway into the next phase of the project.

The 1.98 miles of the Mesabi Trail Connection has an all-weather 10' wide bituminous surface and was constructed to conform to current state and federal accessibility standards. Low impact Excavators constructed the project and the project engineer was Short Elliott Hendrickson.

Cost estimates and engineering plans for the construction of the remaining portion of the trail link is currently being developed by Short Elliott Hendrickson Engineering. The right-of-way issues for this portion of the trail were resolved in June 2002. Actual construction of the link to the Aurora City Trail will begin when funding for the project is obtained.

### **III. FINAL PROJECT SUMMARY**

### **IV. OUTLINE OF PROJECT RESULTS**

• Result 1	LCMR Budget	\$40,000.00	Match	\$49,982.32
	Balance	.00	Match Balance	.00
• Result 2	LCMR Budget	\$40,000.00	Match	\$49,982.32
	Balance	.00		.00

Completion Date:

- Result 1: May 31, 2002
- Result 2: June 30, 2002

**V. DISSEMINATION:** Almost immediately upon completion of this segment of the trail, bikers, runners, and roller-bladers were all found riding the trail and experiencing this link. Once the next section of the trail is completed, the trail use will increase significantly.

### **VI. CONTEXT**

**A. Significance:** Prior to this project there was no connection from the East Range Communities of Aurora, Hoyt Lakes, and White Township to the Mesabi Trail System. This project, which was constructed within the boundaries of the Town of White helped connect these communities to this developing regional trail system that will extend from Ely to Grand Rapids. Local officials envision a future eastward connection to Lake and Cook Counties. The trail will have an all-weather 10' wide bituminous surface and be constructed to conform to all current state and federal accessibility standards.

**B. Time:** The project will begin no earlier than July 1, 1999, and is expected to be completed by September 30, 2001.

**C. Budget Context: 1994-1998**

1. LCMR Budget History	0.00
2. Non-LCMR Budget History	
• IRRRB Mineland Reclamation	\$ 87,983.45
• City of Aurora	<u>21,925.00</u>
3. TOTAL	\$ 109,908.45

Phase I of the Project included a completed quarter mile light nature walk beginning on the western edge of the City. Phase II included .85 miles of extended trail development and preparation. Both Phases I and II were done in cooperation effort listed in VII.

**1. BUDGET**

Personnel	\$ 0.00
Equipment	0.00
Acquisition	0.00
Development	80,000.00
Other	<u>0.00</u>
TOTAL	\$ 80,000.00

2. See Attachment A for budget detail.

**VII. COOPERATION**

Ray Svatos - IRRRB Mineland Reclamation Program  
Bob Manzoline - Regional Rail Authority  
Chris Vreeland - City of Aurora Public Works Director  
Ray Nori - Town of White Public Works

**VIII. LOCATION**

The Mesabi Trail Connection will be developed entirely within St. Louis County, in the Town of White. See Attachment B for a map showing the location within the State and Attachment C for a local area map.

**IX. REPORTING REQUIREMENTS**

Periodic work program progress reports will be submitted not later than September 30, 1999; September 30, 2001; and September 30, 2002. A final work program report and associated products will be submitted by July 1, 2002, or by the date as set in the appropriation.

Attachment A Deliverable Products and Related Budget			
LCMR Project Biennial Budget		Objective/Results	
	Result 1	Result 2	
	Construct Trail	Pave Trail	ROW TOTAL
BUDGET ITEM			
Wages, Salaries & Benefits - be specific on who is paid \$			
Space Rental, Maintenance & Utility			
Printing & Advertising	684.18		684.18
Communications, Telephone, Mail, etc.			
Contracts			
Professional/Technical	43,093.01		43,093.01
Other Contracts			
Local Automobile Mileage Paid			
Other Travel Expenses In Minnesota			
Travel Outside Minnesota			
Office Supplies			
Other Supplies			
Tools & Equipment			
Office Equipment & Computers			
Other Capital Equipment			
Other Direct Operating Costs ** Permits	240.00		240.00
Land Acquisition			
Land Rights Acquisition			
Buildings or Other Land Improvements	77,427.12	57,999.71	135,426.83
Legal Fees	225.62		225.62
<b>COLUMN TOTAL</b>	<b>121,669.93</b>	<b>57,999.71</b>	<b>179,669.64</b>

# Project Location

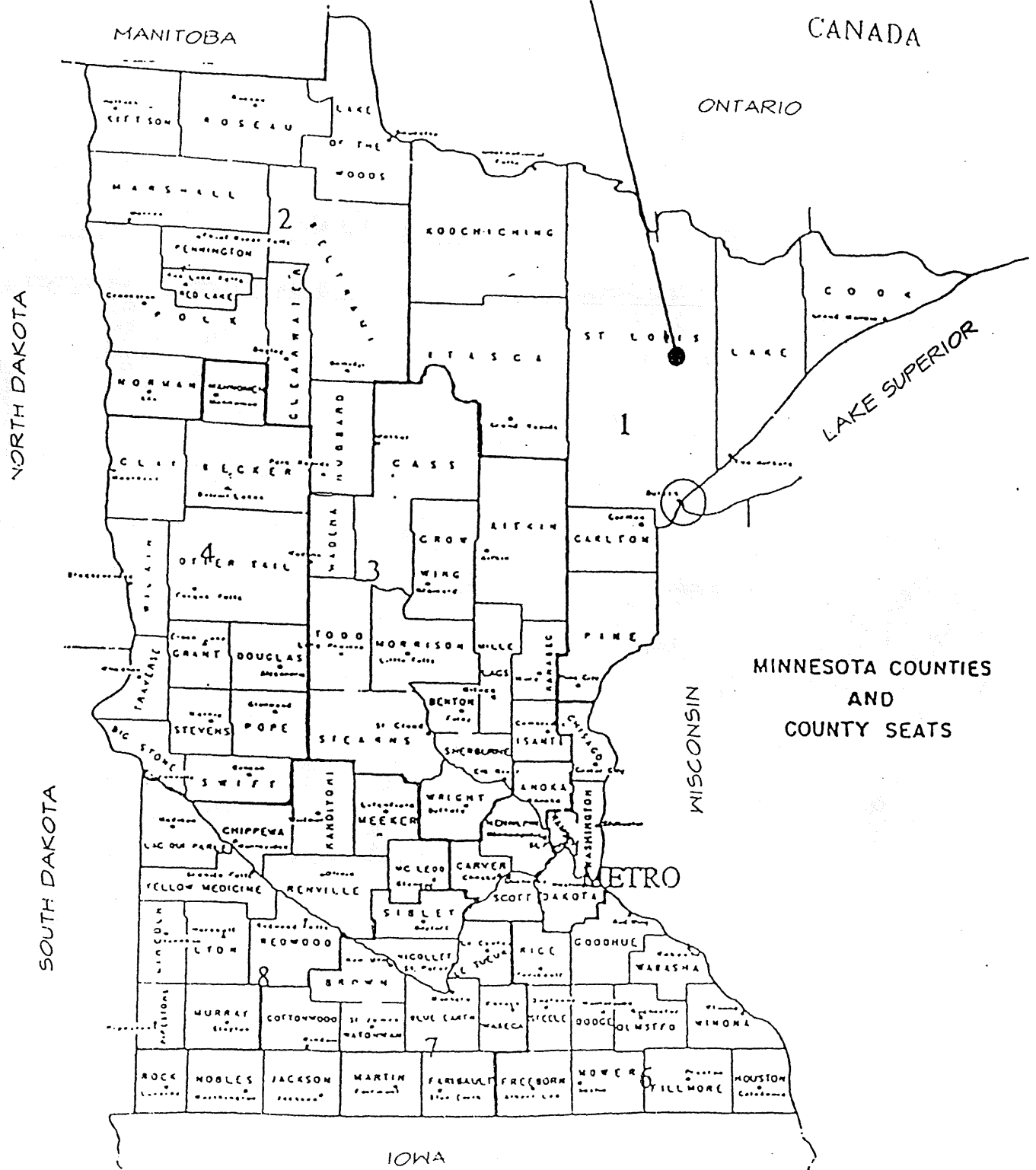

JAN-28-2003 12:47PM FROM-EAST RANGE JOINT POWERS

218-228-3581

T-574 P.012/014 F-173

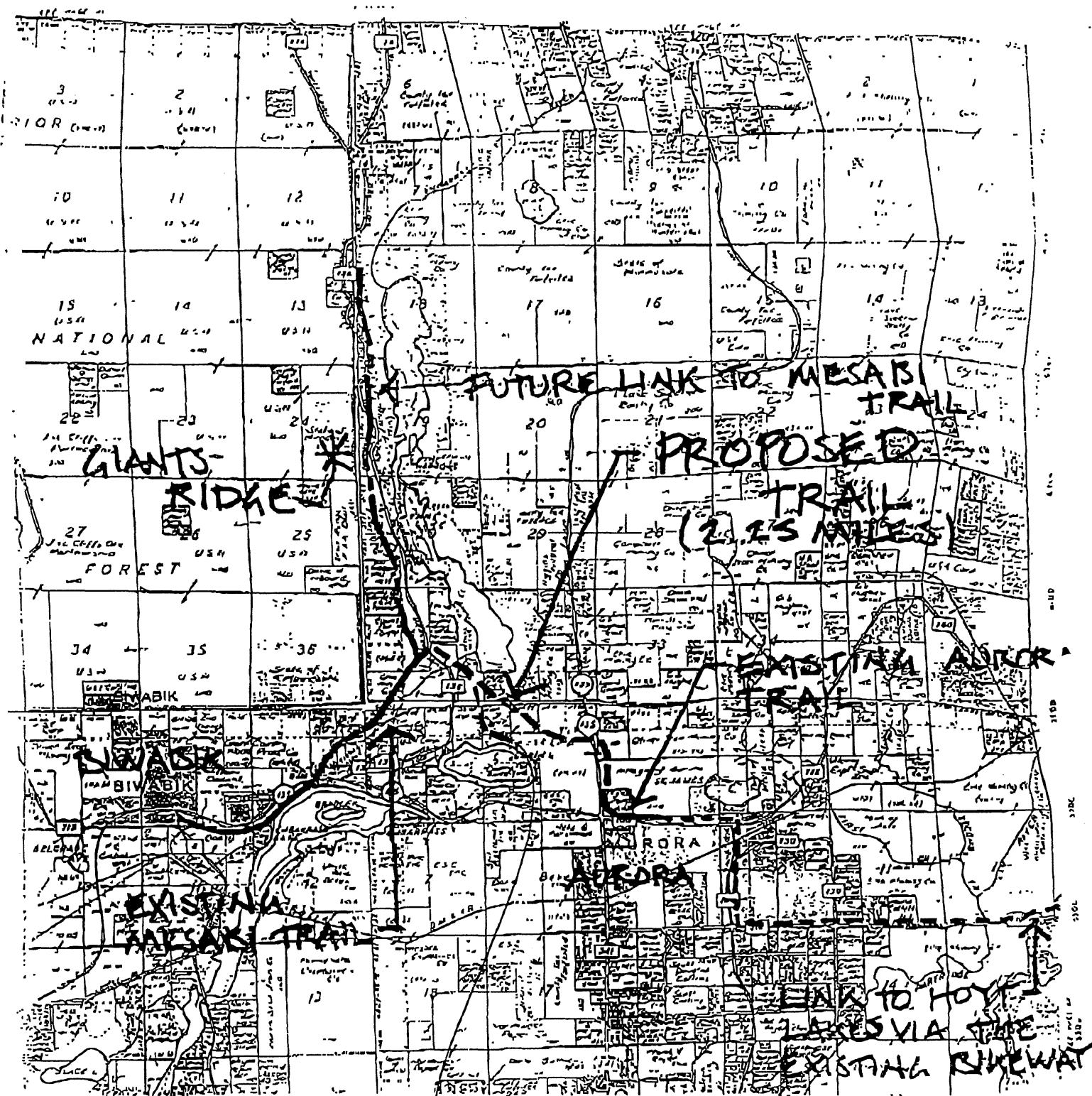

Many things  
 ① Trail ended here. ② check your email.  
 off