

1997 Project Abstract

For the Period Ending June 30, 1999

This project was supported by the Environment and Natural Resources Trust Fund – subdivision 16, paragraph (b), Arboretum Land Acquisition.

TITLE: Arboretum Land Acquisition L-10

PROJECT MANAGER: Prof. Peter J. Olin, Director

ORGANIZATION: Minnesota Landscape Arboretum, University of Minnesota

ADDRESS: 3675 Arboretum Boulevard, P.O. Box 39, Chanhassen, MN 55317

WEB SITE ADDRESS: www.arboretum.umn.edu

LEGAL CITATION: ML 1997, Ch. 216, Sec. 15, Subd. 16 (b), Arboretum Land Acquisition

APPROPRIATION AMOUNT: \$450,000.

Statement of Objectives

The University of Minnesota Landscape Arboretum and Horticultural Research Center are dedicated to serving the citizens of Minnesota through plant research, demonstration of cold-hardy plants and their care, education in plant science, and stewardship of the natural environment. In order to protect the integrity of the Arboretum watershed, collections, and native habitats, a long term plan was initiated to acquire property within the roadway system around the Arboretum core – State Highways 5 and 41, Bavaria Road and 82nd Street.

Overall Project Results

On March 2, 1999, the Arboretum purchased at auction 60 acres of the 150 acre Tschimperle property. Negotiations are in progress on the remaining 90 acres, which is the most critical piece of all the property the Arboretum must purchase to protect its environment. Over 200,000 people visit the Arboretum yearly, and research and educational programs are recognized internationally as well as state-wide. All open land surrounding the Arboretum is now owned by developers and is planned for residential, light industrial, and perhaps multi-family and commercial development. Control of the lands within the boundaries of the roadways around the Arboretum core will protect water quality, native plant habitat, keep noise and air pollution at a minimum, and preserve the ambiance of the visitor experience.

Project Results Use and Dissemination

n/a

Date of Report: April 6, 1999

Date of Next Status Report: FINAL REPORT

Date of Workprogram Approval: _____

Project Completion Date: March 2, 1999

LCMR Work Program 1997

I. PROJECT TITLE: Arboretum Land Acquisition L-10

Project Manager: Prof. Peter J. Olin, Director

Affiliation: Minnesota Landscape Arboretum, University of Minnesota

Mailing Address: 3675 Arboretum Drive, PO Box 39, Chanhassen, MN 55317

Telephone Number: 612/443-2882

E-Mail: olin002@maroon.tc.umn.edu

Fax: 612/443-2521

Total Biennial Project Budget:

| | | | |
|-----------------------|------------|------------------------|------------|
| \$ LCMR | \$450,000. | \$ Match | \$450,000. |
| -\$ LCMR Amount Spent | \$450,000. | -\$ Match Amount Spent | \$631,000. |
| <hr/> | | <hr/> | |
| = \$LCMR Balance | \$ 0 | =\$Match Balance | \$ 0 |

A. Legal Citation: ML 1997, [Chap. 216], Sec. [15], Subd. 16b Arboretum.

Appropriation Language: This appropriation is from the trust fund to the University of Minnesota for a grant to the University of Minnesota Landscape Arboretum Foundation for the second biennium for land acquisition to expand the boundary of the Minnesota Landscape Arboretum. This appropriation must be matched by at least \$450,000 of nonstate money.

B. Status of Match Requirement: The Minnesota Landscape Arboretum commits to raising \$450,000 match to acquire lands to protect the Arboretum's watershed. These funds have already been raised.

II. PROJECT SUMMARY AND RESULTS:

Acquire property as part of a long term strategy to protect the integrity of the Arboretum watershed, collections, and native habitats. The result of this project will be the acquisition of land substantially within the Arboretum's watershed and in accordance with the Arboretum Land Acquisition Plan approved by the Arboretum Foundation Trustees, March 1995. Over 200,000 people visit the Arboretum yearly. Research programs and educational programs are recognized internationally. Protecting the land base is essential to the Arboretum being a viable environmental institution in the future.

III. PROGRESS SUMMARY:

As of March 2, 1999 we have purchased at auction 60 acres of the 150 acre Tschimperle property and are negotiating on the remaining 90 acres. This piece is the most critical of all the property we need to protect our environment. We still have commitment from the Russell family to purchase their land and we will be in further negotiations with them. The Boorsma family is still interested in further discussion about their property.

IV. OUTLINE OF PROJECT RESULTS

Result 1: Acquisition of at least 50 acres of land adjacent to existing Arboretum lands and within boundaries of the MLA Land Acquisition Plan (map attached). Last year the Arboretum acquired 30 acres from Chaska Gateway Partners at the corner of Highway 41 and 82nd Street. At the present time we expect to acquire property (10 acres) before July 1, 1997. The remaining parcels include Tschimperle (150 acres), Hartman (50 acres), Russell (30 acres), and Boorsma (7 acres). The Arboretum's highest priority is the Tschimperle property, but it may not be attainable in the next two years. Part of the Hartman property is the next highest priority. The color coded map is included listing priorities.

RESULT 1 BUDGET: \$450,000 Balance \$0

MATCH: \$450,000 Balance \$0

Completion Date: March 2, 1999

V. DISSEMINATION: NA

VI. CONTEXT:

A. Significance:

As much land as possible will be purchased within the Arboretum's Land Acquisition Plan boundaries. This long term acquisition plan was initiated in response to exceptionally rapid growth in the western Twin Cities suburbs, especially Chanhassen and Victoria. All open land surrounding the Arboretum is now owned by developers and is planned for residential, light industrial, and perhaps multi-family and commercial development. The Land Acquisition Plan directs purchase of lands within the roadway system around the Arboretum core, State Highways 5 and 41, Bavaria Road and 82nd Street. When these lands are acquired, 90% of the Arboretum watershed (at the top of Minnehaha Creek) will be owned in fee simple. In order to protect water quality, native plant habitat, keep noise and air pollution at a minimum, and preserve the ambiance of the visitor experience, it is necessary to control lands within the boundaries of the roadways. The additional acres will allow Arboretum activities, overcrowded at the Snyder Building, to be distributed to other parts of the site surrounded by the roadway system which will also offer easy access. 60 acres have been purchased.

Costs: The land costs will total at least \$900,000. All costs above the \$450,000 committed by the LCMR will be raised by the Arboretum Foundation. Completed.

B. Time: The land will be purchased within two years, ending on June 30, 1999.

C. Budget Context: This project is part of a long term strategy to acquire lands within the Arboretum's watershed for ecological protection. It also provides the opportunity to develop public models for restoration of native Minnesota landscapes in the future. In 1994-95, the LCMR supported the Arboretum in providing matching funds to acquire watershed lands and develop a model restored wetland for mitigation purposes. The LCMR provided \$680,000. The Arboretum has matched this entire amount. Matching funds were from foundations, individuals, and the Minnehaha Creek Watershed District.

Total \$1,360,000.

| | July 1995 - <u>June 1997</u> Prior expenditures on this project | July 1997 - <u>June 1999</u> Proposed expenditures on this project | July 1999 - <u>June 2001</u> Anticipated future expenditures on this project |
|----------------------|--|---|---|
| 1. LCMR | \$ 680,000. | \$ 450,000. | \$ 700,000. |
| 2. Other State | \$ | \$ | \$ |
| 3. Non-State Cash | \$ 680,000. | \$ 450,000. | \$ 700,000. |
| Total | \$ 1,360,000. | \$ 900,000. | \$ 1,400,000. |

BUDGET:

| | |
|--------------------|------------------|
| Personnel | \$ NA |
| Equipment | \$ NA |
| Acquisition | \$900,000 |
| Development | \$ NA |
| Other | \$ NA |

TOTAL **\$900,000**

VII. COOPERATION: Project Manager, Peter J. Olin, Director, Minnesota Landscape Arboretum.

V. LOCATION: Map attached

IX. REPORTING REQUIREMENTS: Periodical workprogram progress reports will be submitted not later than April 1998, September 1998, and June 1999. A final workprogram report and associated products will be submitted by June 30, 1999, or by the completion date as set in the appropriation.

X. RESEARCH PROJECTS: NA

MINNESOTA LANDSCAPE ARBORETUM LAND ACQUISITION PLAN

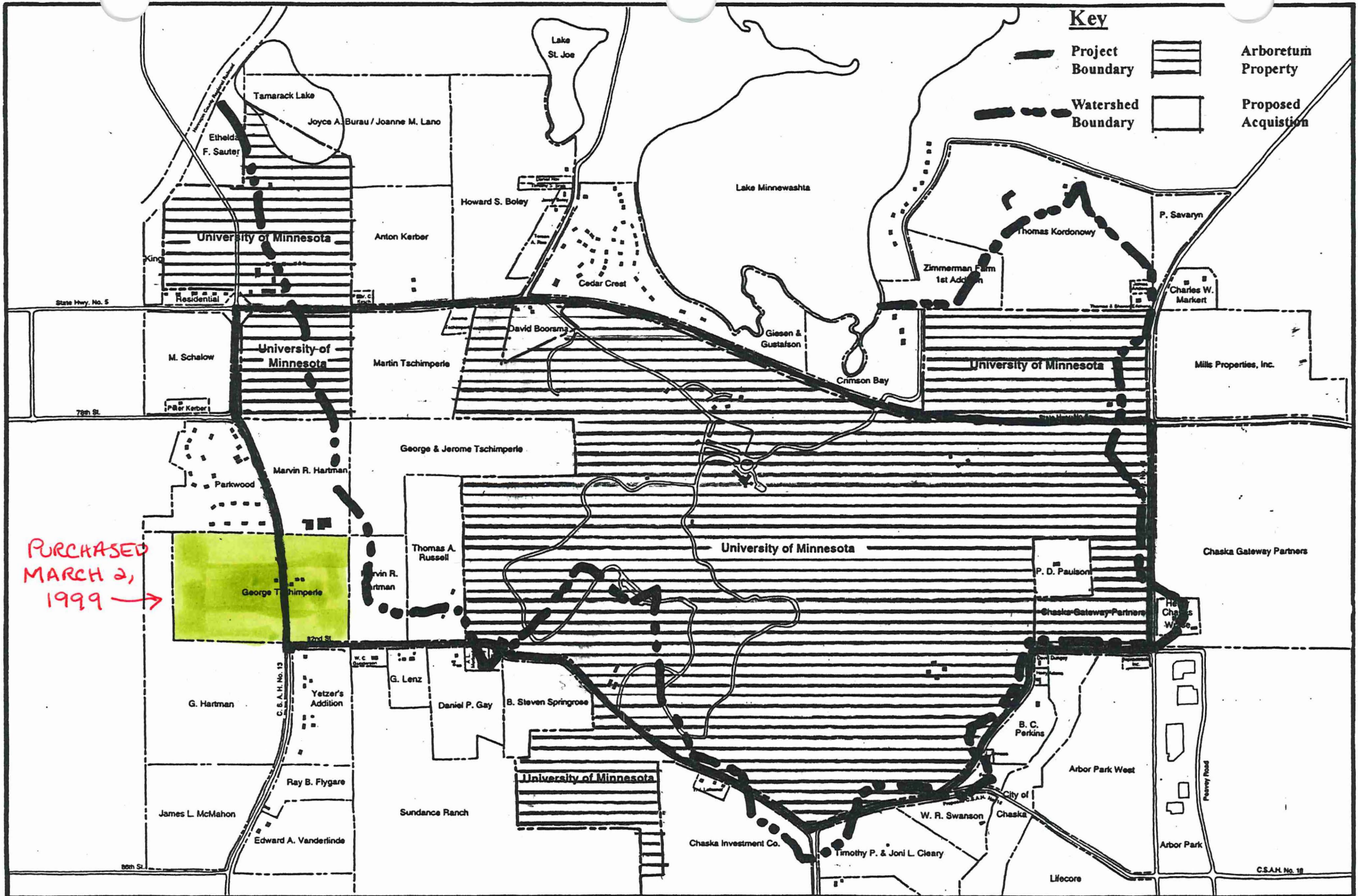

University of Minnesota
Twin Cities Campus

Minnesota Landscape Arboretum

Boundary Map

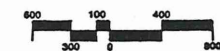

Drafted by Robert H. Day 5-20-93

