

Date of Report: January 7, 2000

Date of Next Status Report: December 1, 2000

LCMR Work Program Update Report

I. PROJECT TITLE: Lake Superior Harbors and Lake Superior Access

Project Manager: Michael T. Markell, Supervisor
Affiliation: Water Recreation Section, Trails and Waterways Division, Department of Natural Resources
Mailing Address: DNR Building - 500 Lafayette Road, Saint Paul, Minnesota 55155-4052
Telephone Number: (651) 296-6413
E-mail: mike.markell@dnr.state.mn.us
Fax: (651) 297-5475

A. Appropriation Language:

SILVER BAY HARBOR (See Appendix 1 (pgs 6-8) for details)

ML 1993, Chap. 172, Sec. 14, Subd. 10(o). \$1,000,000
Lake Superior Safe Harbors-Continuation.

To acquire a site not to exceed 25 acres and construct a Lake Superior safe harbor site at Silver Bay in cooperation with the north shore management board. This appropriation is contingent on additional funding being requested from the IRRRB, the United States Army Corps of Engineers, and other federal/local sources as described in the north shore harbors plan.

ML 1994, Chap. 643, Sec. 23, Subd. 27. Lake Superior Safe Harbors. \$2,200,000
To develop a new small craft harbor in Silver Bay or, if a suitable site is not available in Silver Bay, at another site determined by the commissioner in consultation with the North Shore Management Board. This appropriation is contingent on receipt of the federal matching grant.

ML 1994, Chap. 632, Art. 2, Sec. 6. Silver Bay Harbor. \$1,000,000
This amount is added to the appropriation contained in Laws 1993, chapter 172, section 14, subdivision 10, paragraph (o).

ML 1995, Chap. 220, Sec. 19, Subd. 19. Carry forward.
(b) The availability of the appropriations for the following projects is extended to December 31, 1996; on that date the appropriations cancel and no further payment is authorized: (1) Laws 1993, chapter 172, section 14, subdivision 3, paragraph (c); 4, paragraph (e); 10, paragraphs (d), (f), and (o); 12, paragraphs (f) and (g); in subdivision 10, paragraph (b), the Bloomington East and West Bush Lake picnic areas; and, in subdivision 109, paragraph (c) Cedar Lake trail development and the Dakota North regional trail in South Saint Paul; and (2) Laws 1994, chapter 632, article 2, section 6, local recreation grants and Silver Bay harbor.

ML 1996, Chap. 407, Sec 8, Subd. 9. Carry forward.
The availability of the appropriations for the following projects is extended to December 31, 1997, when projects must be completed and final products delivered: Laws 1995, chapter 220, section 19, subdivision 5, paragraph (g), mercury deposition and lake quality trends; Laws 1994, chapter 632, article 2, section 6, Silver Bay harbor; and Laws 1993, chapter 172, section 14, subdivision 10, paragraph (o), Lake Superior safe harbors-continuation.

ML 1997, Chap. 216, Sec 15, Subd. 26. Carry forward.
(b) The availability of the appropriation for the following projects is extended to June 30, 1999: Laws 1995, chapter 220, section 19, subdivision 4, paragraph (a), metropolitan regional park system; paragraph (g), clause (1), as amended by Laws 1996, chapter 407, section 50, local

share for ISTE federal projects and subdivision 12, paragraph (a), restore historic Mississippi river mill site; Laws 1994, chapter 632, article 2, section 6, Silver Bay harbor; and Laws 1993, chapter 172, section 14, subdivision 10, paragraph (o), Lake Superior safe harbors-continuation.

MCQUADE ROAD PUBLIC ACCESS (See appendix 2 (page 9) for details)

ML 1996, Chap. 463, Sec. 7, Subd. 24. McQuade Public Access. \$ 500,000
For acquisition and development of a public access on Lake Superior in the city of Duluth, the town of Duluth, and the town of Lakewood. This appropriation must be matched by a total of \$350,000 from the iron range resources and rehabilitation board and non-state sources and is contingent on sufficient land owned by the cities and the town, the value of which may not be applied as part of the required match, being made available to complete the project.

ML 1997, Chap. 216, Sec. 142. McQuade Public Access.

Laws 1996, chapter 463, section 7, subdivision 24, is amended to read:

Subd. 24. McQuade Public Access.

For acquisition and development of a public access on Lake Superior in the city of Duluth, the town of Duluth, and the town of Lakewood. ~~This appropriation must be matched by a total of \$350,000 from the iron range resources and rehabilitation board and~~ \$200,000 of this appropriation is available without match and the remaining \$300,000 is available to the extent matched by non-state sources and is contingent on sufficient land owned by the cities and the town, the value of which may not be applied as part of the required match, being made available to complete the project.

TACONITE HARBOR (See Appendix 3 (page 13) for details)

ML 1997, Chap. 216, Sec. 5, Subd. 6. Taconite Harbor. \$ 400,000
Taconite Harbor safe harbor project. This appropriation is available until expended. The legislature intends that future appropriations will be contingent on receipt of an equal amount of non-state matching money for the total project.

Approval is requested for M.L. 1998, Chap. 404 \$ 1,500,000
Section 7, Subd. 24. Lake Superior Safe Harbors
For acquisition, design, and development of safe harbors and public accesses on Lake Superior. \$1,500,000 is for Taconite Harbor and \$3,500,000 is for Two Harbors. This appropriation is not available until an equal amount in federal matching funds has been committed.

Two Harbors (See appendix 4 (page 15) for details)

Approval is requested for M.L. 1998, Chap. 404 \$ 3,500,000
Section 7, Subd. 24. Lake Superior Safe Harbors
For acquisition, design, and development of safe harbors and public accesses on Lake Superior. \$1,500,000 is for Taconite Harbor and \$3,500,000 is for Two Harbors. This appropriation is not available until an equal amount in federal matching funds has been committed.

- B. **Status of Match Requirement:** For Silver Bay Harbor, legislation required a federal match and it also requested a match from the Iron Range Resources and Rehabilitation Board (IRRRB). Both were obtained. Congress appropriated \$2.6 million to the U.S. Army Corps of Engineers in 1993, and the IRRRB approved \$500,000 for the city of Silver Bay in December 1996.

For McQuade Road the following matches have been received: City of Duluth \$50,000; Corps of Engineers \$150,000. A request for \$2.5 million for federal construction funds is in committee hearings in Congress. The McQuade Road Access Committee is requesting additional match from St. Louis County and IRRRB.

50
150
200-00
OK

For Taconite Harbor

Federal matching funds of \$1,500,000 have been appropriated.*

For Two Harbors

Federal matching funds of \$3,500,000 have been appropriated.*

**Energy and Water Development Appropriations Act, 1998. Public Law 105-6211 Statute 1320, October 13, 1997.*

For McQuade Road **

Federal matching funds of \$2,000,000 have been appropriated.

***House Report 106-253, Energy and Water Development Appropriations Act, 1999. Public Law 106-60.*

- II. PROJECT SUMMARY AND RESULTS:** This program will provide a system of safe harbors and protected water access sites on Lake Superior. This will allow anglers and boaters safe access and protection from storms that can arise suddenly on the lake.

Recognizing that there was a severe shortage of access and safe harbors, the LCMR recommended funding that was appropriated in 1989 to the Department of Natural Resources (DNR) to grant to the North Shore Management Board (NSMB) to plan the best locations for safe harbors and water access sites. The NSMB is a joint powers board of the counties and cities on the north shore formed to plan and review issues of common interest on the shoreline of Lake Superior. The plan was completed by the NSMB and approved by the DNR and LCMR in 1991.

In 1993, the legislation was passed (ML 1993, Chap 333, Subd 3-6), which established a system of safe harbors on Lake Superior located at Knife River, Two Harbors, Silver Bay, Grand Marais, and Grand Portage. The DNR was given the authority (cited in Minnesota Statutes 86A.20-24), to acquire land, construct harbors and parking lots, provide mooring facilities, and other amenities such as fuel and other services for boats. The statute also provides for a relationship with local governments in the operation of harbors and mooring facilities. Ideally, the DNR will acquire or lease land, construct the facilities, and enter into agreements with local governments for maintenance and operation.

The DNR, in cooperation with local governments, including the city of Duluth, is providing protected water access sites on Lake Superior. These sites are located in between the safe harbor locations to provide primarily fishing access. With the rugged shoreline of Lake Superior, there are relatively few feasible sites. These sites may be small with a single launch ramp and about 20 car/trailer parking spaces with either natural protection from wave action or a minor breakwater; or they may be quite large with over 75 parking places, a multi-lane launch ramp, and a large breakwater. No dockage, fuel, or other boating related facilities will be provided except for those found at inland lake access sites. These sites will be constructed and operated in cooperation with local governments where there is local interest in doing so.

- III. WORK PROGRAM UPDATE:**
- | | |
|----------------------------|------------------|
| Silver Bay Harbor | (see Appendix 1) |
| McQuade Road Public Access | (see Appendix 2) |
| Taconite Harbor | (see Appendix 3) |
| Two Harbors | (see Appendix 4) |
- IV. OUTLINE OF PROJECT RESULTS:**
- | | |
|----------------------------|------------------|
| Silver Bay Harbor | (see Appendix 1) |
| McQuade Road Public Access | (see Appendix 2) |
| Taconite Harbor | (see Appendix 3) |
| Two Harbors | (see Appendix 4) |

V. CONTEXT:

- A. **Significance:** A critical issue is the safety of boats and boaters. The North Shore of Lake Superior is the most dangerous coast on the Great Lakes because of its rocky shoreline, frequency of unexpected and violent storms, and extremely cold waters making hypothermia a major concern. Small craft traveling the shore or using the few existing unprotected accesses must look to the few commercial ore boat harbors or the few natural cove areas for protection when needed. Many of these emergency refuge sites, if available, are still dangerous because of the high waves within the basin during storms.

Even with the completion of Silver Bay safe harbor, Minnesota does not meet the recommended safe harbor standards of Wisconsin, Michigan, and the U.S. Army Corps of Engineers.

Wisconsin's interval distance is 10-15 miles between facilities, while the Corps' and Michigan's interval standard is 30 miles. The lack of safe harbors and protected launching and retrieval facilities is a major barrier to boating, fishing, and small craft commercial operations on the lake.

- B. **Time:** Silver Bay was completed in summer 1999. All the land is being acquired at McQuade Road. Taconite Harbor is under contract with construction scheduled for summer 2000. The City of Two Harbors is securing land rights with possible construction in 2001.
- C. **Budget:** The total amount of state funding for the four projects is \$10.1 million. In addition, IRRRB provided \$500,000 for Silver Bay.
- D. **Federal Funding:** The total amount of federal funding appropriated to the U.S. Army Corps of Engineers for safe harbors as follows:

Silver Bay	\$ 2,600,000
Taconite Harbors	\$ 1,500,000
Two Harbors	\$ 3,500,000
McQuade Road	\$ 2,350,000
Knife River	\$ 150,000
Total	\$10,100,000

The Silver Bay, Taconite, Two Harbors, and McQuade funds are for construction; Knife River was appropriated to the Corps for breakwater redesign.

- VI. **COOPERATION:** The Lake Superior Safe Harbors program has been managed as a locally-based, locally-driven project since its inception with the *North Shore Harbors Plan*. Local governments, including the city of Duluth continue to cooperate with the DNR in implementation. There are several citizen committees working on separate projects in various stages along with key implementation committees at Silver Bay, McQuade Road, Taconite Harbor and Two Harbors.
- VII. **LOCATION:** *Ecological classification location "L", North Shore (see attached map).*
- VIII. **REPORTING REQUIREMENTS:** Work program update reports will be submitted whenever a specific project approval is required. These work program report updates will also note when an appropriation for a specific harbor or access project has been liquidated and all associated project work has been completed.

Minnesota Safe Harbor Program

Current & Future Developments

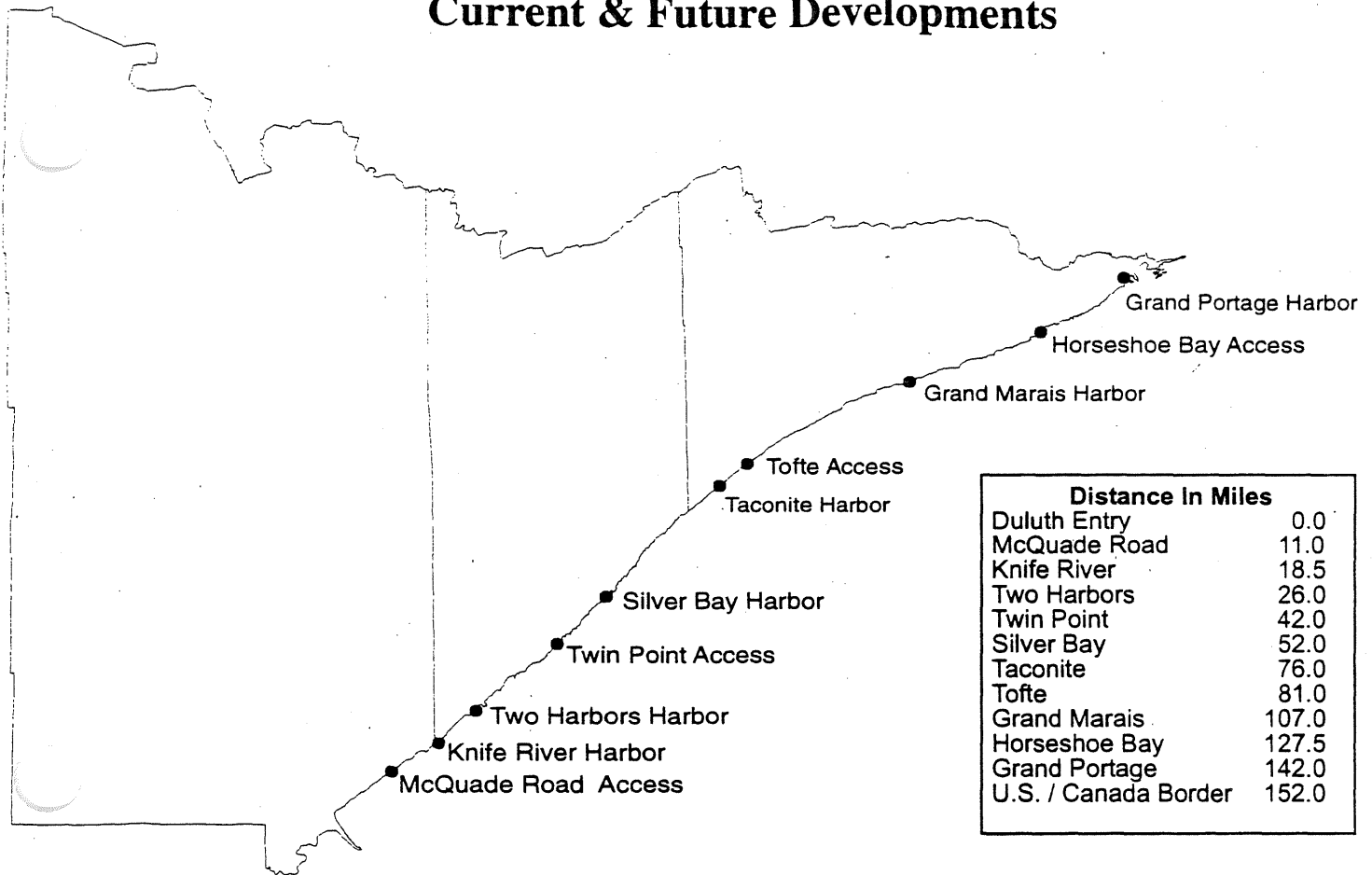

McQuade Road	Future site of protected boat launch and 3 acre safe harbor basin.
Knife River	Existing county owned marina. Breakwater is in need of redesign to provide safe harbor facility.
Two Harbors	Existing boat launch site within commercial harbor. Future site of safe harbor with marina facilities.
Twin Points	Future site of protected boat launch.
Silver Bay	Existing 7 acre safe harbor basin. Boat launch and 61 slip marina facilities. Room for future addition of 106 slips.
Taconite	Construction of safe harbor to begin during summer of 2000.
Tofte	Existing protected boat launch.
Grand Marais	Existing commercial harbor with some slips. Breakwater is in need of redesign to provide safe harbor facility.
Horseshoe Bay	Existing boat launch.
Grand Portage	Existing privately owned marina.

Date of Work Program Approval: June 1993, 1994
Project Completion Date: June 30, 1999

I. PROJECT TITLE: Silver Bay Harbor

Project Manager: Michael T. Markell, Supervisor
Affiliation: Water Recreation Section, Trails and Waterways Division, Department of Natural Resources
Mailing Address: DNR Building - 500 Lafayette Road, Saint Paul, Minnesota 55155-4052
Telephone Number: (651) 296-6413
E-mail: mike.markell@dnr.state.mn.us
Fax: (651) 297-5475

	<u>Appropriation</u>	<u>Balance</u>
Total Project Budget:	\$ 7,300,000*	\$ 0
<u>State Funds</u>		
LCMR	\$ 2,000,000	\$ 0
Bonding	\$ 2,200,000	\$ 0
<u>Match</u>		
U.S. Army Corps of Engineers	\$ 2,600,000	\$ 0
Iron Range Resources and Rehabilitation Board (IRRRB) (city of Silver Bay)	\$ 500,000	\$ 5,000 (estimate)

A. Legal Citation:

ML 1993, Chap. 172, Sec. 14, Subd. 10(o). \$1,000,000
Lake Superior Safe Harbors-Continuation.

To acquire a site not to exceed 25 acres and construct a Lake Superior safe harbor site at Silver Bay in cooperation with the north shore management board. This appropriation is contingent on additional funding being requested from the IRRRB, the United States Army Corps of Engineers, and other federal/local sources as described in the north shore harbors plan.

ML 1994, Chap. 643, Sec. 23, Subd. 27. Lake Superior Safe Harbors. \$2,200,000
 To develop a new small craft harbor in Silver Bay or, if a suitable site is not available in Silver Bay, at another site determined by the commissioner in consultation with the North Shore Management Board. This appropriation is contingent on receipt of the federal matching grant.

ML 1994, Chap. 632, Art. 2, Sec. 6. Silver Bay Harbor. \$1,000,000
 This amount is added to the appropriation contained in Laws 1993, chapter 172, section 14, subdivision 10, paragraph (o).

ML 1995, Chap. 220, Sec. 19, Subd. 19. Carry forward.
 (b) The availability of the appropriations for the following projects is extended to December 31, 1996; on that date the appropriations cancel and no further payment is authorized: (1) Laws 1993, chapter 172, section 14, subdivision 3, paragraph (c); 4, paragraph (e); 10, paragraphs (d), (f), and (o); 12, paragraphs (f) and (g); in subdivision 10, paragraph (b), the Bloomington East and West Bush Lake picnic areas; and, in subdivision 109, paragraph (c) Cedar Lake trail development and the Dakota North regional trail in South Saint Paul; and (2) Laws 1994, chapter 632, article 2, section 6, local recreation grants and Silver Bay harbor.

* Other federal and state funds totaling about \$750,000 have been spent.

ML 1996, Chap. 407, Sec 8, Subd. 9. Carry forward.

The availability of the appropriations for the following projects is extended to December 1, 1997, when projects must be completed and final products delivered: Laws 1995, chapter 220, section 19, subdivision 5, paragraph (g), mercury deposition and lake quality trends; Laws 1994, chapter 632, article 2, section 6, Silver Bay harbor; and Laws 1993, chapter 172, section 14, subdivision 10, paragraph (o), Lake Superior safe harbors-continuation.

ML 1997, Chap. 216, Sec 15, Subd. 26. Carry forward.

(b) The availability of the appropriation for the following projects is extended to June 30, 1999: Laws 1995, chapter 220, section 19, subdivision 4, paragraph (a), metropolitan regional park system; paragraph (g), clause (1), as amended by Laws 1996, chapter 407, section 50, local share for ISTE federal projects and subdivision 12, paragraph (a), restore historic Mississippi river mill site; Laws 1994, chapter 632, article 2, section 6, Silver Bay harbor; and Laws 1993, chapter 172, section 14, subdivision 10, paragraph (o), Lake Superior safe harbors-continuation.

- B. Status of Match Requirement:** Legislation required a federal match and it also requested a match from the Iron Range Resources and Rehabilitation Board (IRRRB). Both were obtained.

Match:	\$2,600,000 (U.S. Army Corps of Engineers)
	<u>\$ 500,000 (IRRRB)</u>
Total match:	\$3,100,000
Match spent to date:	\$3,095,000

- II. PROJECT SUMMARY AND RESULTS:** This project is for a safe harbor for boating activities including fishing in Silver Bay. The project includes design and construction of breakwaters to protect a basin of about 10 acres, boat launch ramps, parking, fuel for boats, dockage facilities, and other facilities that support boating. The U.S. Army Corps of Engineers constructed the breakwaters and the state constructed the land-based and dockage facilities. Now completed, the facility is being operated and maintained by the city of Silver Bay under an agreement with the DNR.
- III. SEMI-ANNUAL WORK PROGRAM UPDATE SUMMARY:** The breakwaters were constructed by the U.S. Army Corps of Engineers in 1997. The DNR constructed the land side facilities in 1998 and 1999. Construction was completed in 1999.
- IV. OUTLINE OF PROJECT RESULTS:** Construct a safe harbor and access at Silver Bay.
- | | |
|----------|-------------|
| Budget: | \$7,300,000 |
| Balance: | \$ 5,000 |
- V. CONTEXT:**
- A. Significance: Completing the safe harbor at Silver Bay is a significant milestone in providing refuge to recreational water craft along the north shore of Lake Superior. This harbor provides a long needed safe refuge between Two Harbors and Grand Marais. The project is very significant to the city of Silver Bay, providing its first waterfront recreational development that is attracting boaters, anglers, and tourists to the area.
- B. Time: Construction was completed in 1999.
- C. Budget Context: Due to the complexity of the project and the harsh Lake Superior environment for construction, it has been difficult to estimate costs, especially of the breakwater. However, the breakwater construction was on budget due to favorable bids and the availability of cheap rock from the nearby highway construction. The land side of the project was over budget due to inflation from the time funds were secured, high cost of the building, unanticipated Corps of Engineers overhead cost and amenities added at the request of the city. Funds were obtained from the U.S. Coast Guard and the state water recreation account to cover cost overruns.
- VI. COOPERATION:** The city of Silver Bay operates and maintains the facility.
- VII. LOCATION:** "L", North Shore.

Silver Bay
Safe Harbor + Marina

WAY

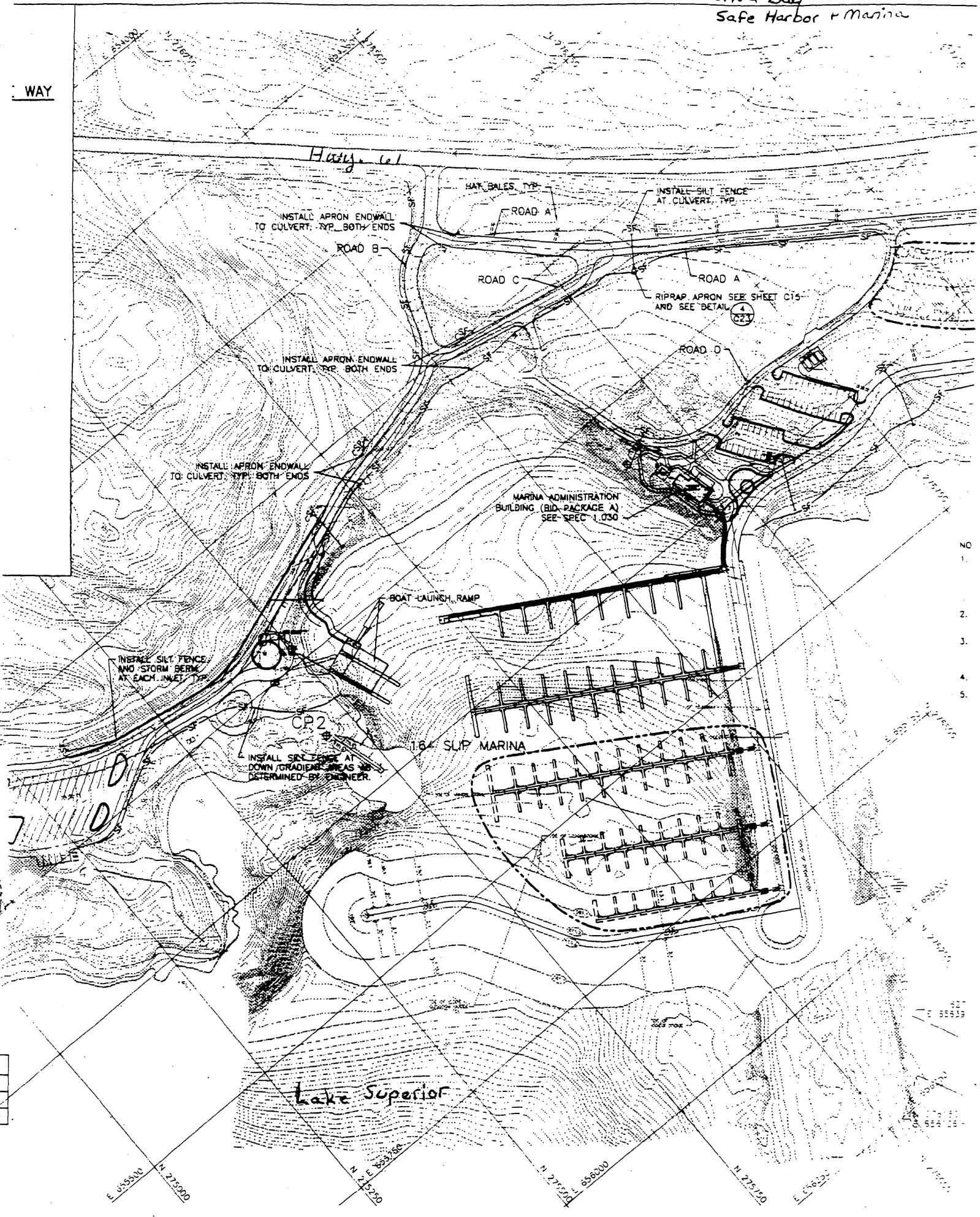

NO
1.
2.
3.
4.
5.

Date of Work Program Approval: June 5, 1996
Project Completion Date: December 31, 2002

I. PROJECT TITLE: McQuade Public Access

Project Manager: Michael T. Markell, Supervisor
Affiliation: Water Recreation Section, Trails and Waterways Division, Department of Natural Resources
Mailing Address: DNR Building - 500 Lafayette Road, Saint Paul, Minnesota 55155-4052
Telephone Number: (651) 296-6413
E-mail: mike.markell@dnr.state.mn.us
Fax: (651) 297-5475

Total Project Budget: \$900,000

	<u>Appropriation</u>	<u>Balance</u>
96 Bonding	\$ 500,000	\$ 500,000
Match required by legislation	\$ 300,000	\$ 300,000
Additional match received	\$ 100,000	\$ 100,000
Total	\$ 900,000	\$ 900,000

A. Legal Citation:

ML 1996, Chap. 463, Sec. 7, Subd. 24. McQuade Public Access \$500,000

For acquisition and development of a public access on Lake Superior in the city of Duluth, the town of Duluth, and the town of Lakewood. This appropriation must be matched by a total of \$350,000 from the iron range resources and rehabilitation board and non-state sources and is contingent on sufficient land owned by the cities and the town, the value of which may not be applied as part of the required match, being made available to complete the project.

ML 1997, Chap. 216, Sec. 142. McQuade Public Access.

Laws 1996, chapter 463, section 7, subdivision 24, is amended to read:

Subd. 24. McQuade Public Access.

For acquisition and development of a public access on Lake Superior in the city of Duluth, the town of Duluth, and the town of Lakewood. This appropriation must be matched by a total of \$350,000 from the iron range resources and rehabilitation board and \$200,000 of this appropriation is available without match and the remaining \$300,000 is available to the extent matched by non-state sources and is contingent on sufficient land owned by the cities and the town, the value of which may not be applied as part of the required match, being made available to complete the project.

- B. Status of Match Requirement:** A request has been forwarded to the Iron Range Resources and Rehabilitation Board (IRRRB) by Duluth Township for \$500,000. A request for \$50,000 was sent to St. Louis County. In discussions with the City and Township, the land necessary to complete the project has been made available. Resolutions have been drafted and forwarded to the city of Duluth and Duluth Township approving use of their public land for the McQuade access. The city of Duluth also provided a \$50,000 match. Federal funds in the amount of \$350,000 were appropriated to the Corps of Engineers in October 1997 and 1998.

Match required:	\$300,000
Amount committed to date:	\$400,000
Corps of Engineers:	\$350,000
Match spent to date:	\$350,000

- II. PROJECT SUMMARY AND RESULTS:** This project is for a protected boat access facility for a variety of boating activities, primarily fishing, in the Duluth area (at McQuade and Scenic Highway 61) on the North Shore of Lake Superior at a site acceptable to most interests in the vicinity.

The project parameters include the construction of breakwaters to form a basin of about 3.1 acres, the provision of 4 launch ramps, 3 docks, 93 parking spaces for vehicles and trails, and 37 parking spaces

for other visitors including persons with disabilities. Other project amenities include rest rooms, a fish cleaning station, telephone, and native plantings.

This project will also provide access to Lake Superior for non-boaters including fishing piers, park benches, walking paths, and public information.

The facility will be non-commercial and publicly owned, situated in a "park like setting". The facility will appeal to the broadest range of boating and non-boating interests possible.

With the state bonding funds, land was acquired from willing sellers. The remaining state funds and the match funds will be used for engineering, development (including site preparation), and the environmental and permitting review process. State engineering costs are expected to be about 6 to 7 percent of the construction cost with the major element the breakwater design.

- III. SEMI-ANNUAL WORK PROGRAM UPDATE SUMMARY:** Requests for match were made in 1999 to St. Louis County for \$50,000 and IRRRB for \$500,000. The city of Duluth has provided \$50,000 match. All the land has been purchased. The site is being cleaned up and environmental review is in process. The site is ready for development.

IV. OUTLINE OF PROJECT RESULTS:

State Appropriation:	\$500,000
Match: City of Duluth:	\$ 50,000
Match: Corps of Engineers	\$350,000
Total:	\$900,000

Estimated Expenditures:

Land Acquisition:	\$425,000
Building Removal & Site Cleanup	\$ 50,000
Site Investigation Bathymetry, preliminary	\$425,000*
Design, engineering geological investigations,	
Mode study (Professional services)	
Total:	\$900,000

* Includes Corps overhead.

Dissemination: The McQuade Access Committee will continue to meet to guide the process. The public will be informed through those meetings, mailings, news releases, and through public meetings as necessary.

V. CONTEXT:

- A. Significance: This project is the culmination of years of effort going back to the early 1980s to site a protected public access on Lake Superior by Duluth. The public access will provide access to the fishery near Duluth and will allow safe exit from the lake through a small harbor basin.
- B. Time: This project will be constructed within 2 years.
- C. Budget Context
Funds from the Water Recreation Account (\$27,500) have been provided to the City of Duluth in FY 2000 for supplies, expenses, etc., associated with the Joint Powers Board.
- D. Federal Funds: The Army Corps of Engineers was appropriated \$350,000 for McQuade Road in 1997 and 1998. In 1999, the Corps received \$2,000,000 for construction. Another \$1,000,000 will be requested from Congress in FY 2000.

- VI. COOPERATION:** McQuade Public Access Committee representing stakeholders/interests in the project. Local governments: Duluth and Lakewood townships, city of Duluth, Saint Louis County.

- VII. LOCATION:** "L", North Shore.

五

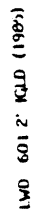
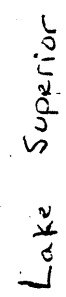

Date of Work Program Approval:
Project Completion Date:

I. PROJECT TITLE: Taconite Harbor

Project Manager: Michael T. Markell, Supervisor
Affiliation: Water Recreation Section, Trails and Waterways Division, Department of Natural Resources
Mailing Address: DNR Building - 500 Lafayette Road, Saint Paul, Minnesota 55155-4052
Telephone Number: (651) 296-6413
E-mail: mike.markell@dnr.state.mn.us
Fax: (651) 297-5475

Total Project Budget: \$3,400,000

	<u>Appropriation</u>	<u>Balance</u>
<u>State Funds</u>		
General Fund	\$ 400,000	\$ 102,777
Capital	\$1,500,000	\$ 100,000*
Federal Funds	<u>\$1,500,000</u>	<u>\$1,500,000</u>
Total:	\$3,400,000	\$1,702,777

*The state funds were transferred to the Corps since they are constructing the entire facility.

A. Legal Citation:

ML 1997, Chap. 216, Sec. 5, Subd. 6. Taconite Harbor. \$ 400,000
 Taconite Harbor safe harbor project. This appropriation is available until expended. The legislature intends that future appropriations will be contingent on receipt of an equal amount of non-state matching money for the total project.

M.L. 1998, Chap. 404

Section 7, Subd. 24. Lake Superior Safe Harbors

For acquisition, design, and development of safe harbors and public accesses on Lake Superior. \$1,500,000 is for Taconite Harbor and \$3,500,000 is for Two Harbors. This appropriation is not available until an equal amount in federal matching funds has been committed.

- B. Status of Match Requirement:** A federal match in the amount of \$1,500,000 has been appropriated to the Corps of Engineers. State funds appropriated will be used for the land side construction which is not eligible for federal funds. State funds of \$1,500,000 will be used to match federal funds for breakwater and basin construction.

II. PROJECT SUMMARY AND RESULTS:

Taconite Harbor will serve as a protected access and a harbor of refuge for fishing, recreational, and smaller commercial craft. The project includes about a 3 acre breakwater protected basin, 2 launch ramps, docks, approximately 35 car/trailer, and 15 car only parking spaces. The site will also include a walking trail, scenic lake overlook, information kiosks, and portable restrooms.

LTV Steel has leased the land to the DNR for one dollar per year for 50 years. This lease saved the state the cost of land acquisition. Development costs are: 1) breakwater \$3,000,000; 2) roads, parking lot, launch ramp, etc. \$400,000.

- III. SEMI-ANNUAL WORK PROGRAM UPDATE SUMMARY:** The project has been bid, a contract awarded by the Corps and construction will be completed in 2000.

- IV. OUTLINE OF PROJECT RESULTS:** Construct a safe harbor and access at Taconite Harbor. Budget: \$3,400,000

- V. CONTEXT:** Completing this safe harbor will provide a long needed refuge and public access point between Silver Bay and Grand Marais. There is strong local and shore-wide support.

- VI. COOPERATION:** Maintenance will be provided by DNR.

- VII. LOCATION:** "L" North Shore.

Taconite Harb

Taconite Harbor

Lake Superior

PORTABLE TOILETS

PICNIC SHELTER

PORTABLE TOILETS

BM 1
CONCRETE
MONUMENT
S. 34.3 P. 40
EXTENDING
TO 814

RELOCATE OR REMOVE
HISTORICAL
MONUMENT GLASS

RELOCATE
BUILDING

BM ELEV 694.37
STANDARD WAS BRASS DOW
STAMPED "Q 342"

BM 2 ELEV = 628.92'
603 NAIL IN TOP OF ROAD
BARRICADE POST 4TH DOWN
FROM TOP OF 1st

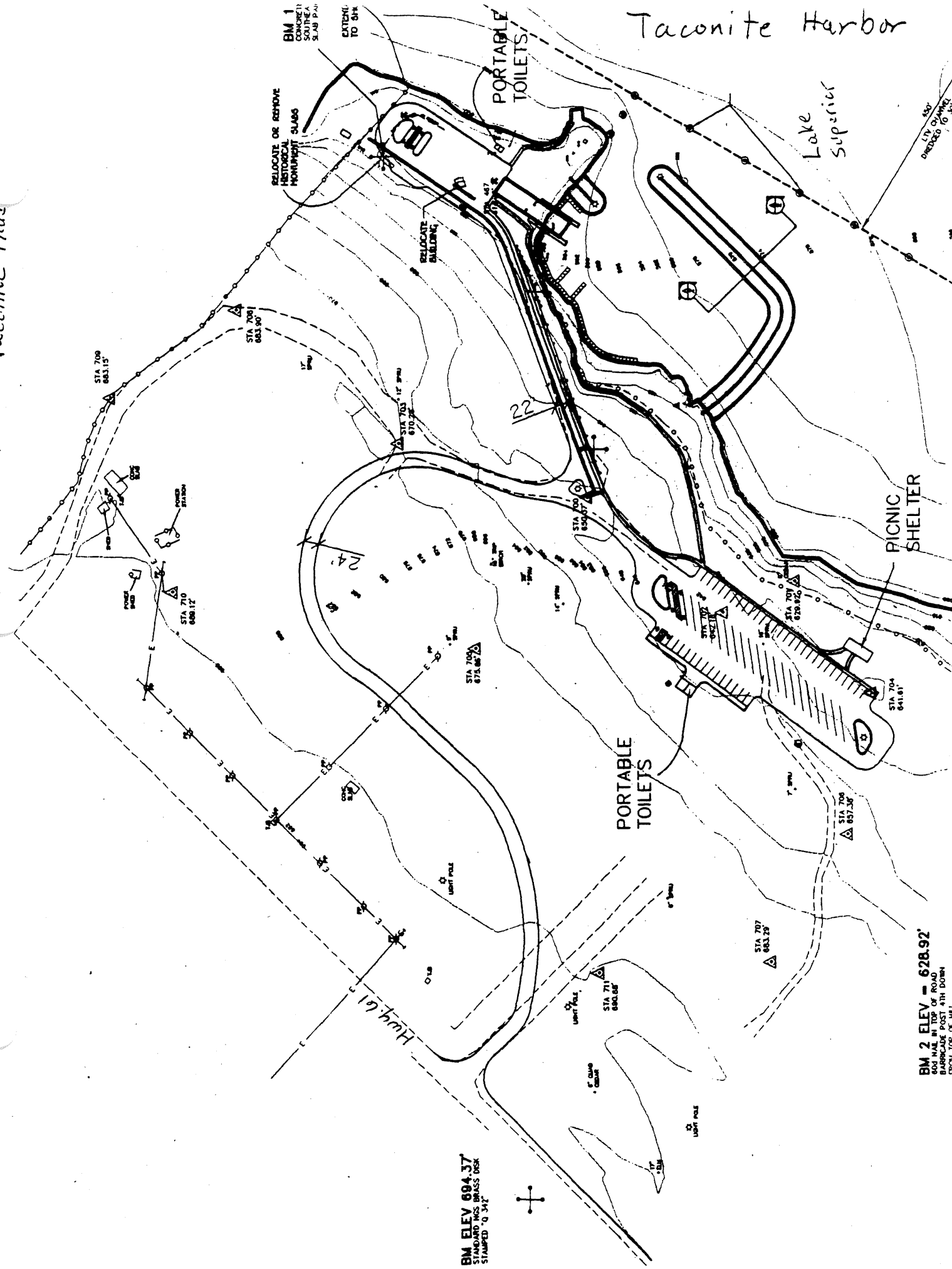

Date of Work Program Approval:
Project Completion Date:

I. PROJECT TITLE: Two Harbors

Project Manager: Michael T. Markell, Supervisor
Affiliation: Water Recreation Section, Trails and Waterways Division, Department of Natural Resources
Mailing Address: DNR Building - 500 Lafayette Road, Saint Paul, Minnesota 55155-4052
Telephone Number: (651) 296-6413
E-mail: mike.markell@dnr.state.mn.us
Fax: (651) 297-5475

Total Project Budget: \$7,000,000

	<u>Appropriation</u>	<u>Balance</u>
State Funds		
Bonding	\$3,500,000	\$3,500,000
Federal Funds		
Corps of Engineers	\$3,500,000	\$3,350,000 (estimate)

A. Legal Citation:

M.L. 1998, Chap. 404
 Section 7, Subd. 24. Lake Superior Safe Harbors
 For acquisition, design, and development of safe harbors and public accesses on Lake Superior.
 \$1,500,000 is for Taconite Harbor and \$3,500,000 is for Two Harbors. This appropriation is not available until an equal amount in federal matching funds has been committed.

B. Status of Match Requirement:

A match of \$3,500,000 was appropriated by Congress in October 1997 to the Army Corps of Engineers.

II. PROJECT SUMMARY AND RESULTS

Approval is requested for Breakwater and Basin construction of \$7,000,000.

This project is for a safe harbor in Agate Bay in the City of Two Harbors. The safe harbor will provide a protected public access and a harbor of refuge for recreational, fishing, and commercial boats. This appropriation matches federal funds and is for Phase One, breakwaters and basin construction only, to be completed in cooperation with the Corps of Engineers. Phase Two, not included in this appropriation, are the associated facilities dockage for boats, fuel dock, sewage pumpout, upgrading the public access, etc. Upon completion, the facility will be operated by the City of Two Harbors under agreement with the DNR.

III. SEMIANNUAL WORK PROGRAM UPDATE SUMMARY

Update Summary:

The City of Two Harbors is acquiring land with completion of land acquisition anticipated by fall of 2000.

The City passed a 1/2% lodging tax to be used for waterfront improvements which will pay for some of communities costs.

The refinement of the basin design is ongoing.

The Corps has done soil borings, bathymetry, preliminary breakwater design, wave climate analysis, and a preliminary coal dock reconstruction design.

The Corps has spent about \$150,000 to date.

IV: OUTLINE OF PROJECT RESULTS

Construct a safe harbor to include breakwaters and a basin at Two Harbors.

Budget:	\$7,000,000
Balance:	\$6,850,000 (estimate)

V. CONTEXT

A. Significance: Completing the safe harbor at Two Harbors is the first phase of a major full service boating facility which will serve boaters and non-boaters alike. An additional \$2,000,000 of state funds and \$900,000 of local funds will be needed to construct the boating infrastructure of dockage, lighting, gas, dock, marina, buildings, and public access improvements.

B. Time: Due to constraints of working through the federal process construction is anticipated in the summer of 2001.

C. Budget Context:

Phase 1

Breakwater Basin Construction

State Funds:	\$3,500,000
Federal Funds	\$3,500,000

Phase 2

Boating facilities including dockage, fuel station, shore fishing, parking, public access upgrade, etc.

State Funds:	\$2,000,000
Local Funds:	<u>\$ 900,000</u>

Total Project Cost:	\$9,900,000
---------------------	-------------

VI. COOPERATION

The city formed a harbor committee that has been overseeing the project for 3 years. The North Shore Management Board, Lake County, and City of Two Harbors have passed resolutions of support.

VII. LOCATION "L" NORTH SHORE

Location: "L" North Shore.

Two Harbors Proposed Safe Harbor + Marina

Connection to Downtown

Depot

Multi-use Facility

Long Term Parking

Hotel Development Site

Integrated Harbor Administration Facility

Marina Fuel Dock

Trail Connection

Boat Launch

Two Harbors Light Station

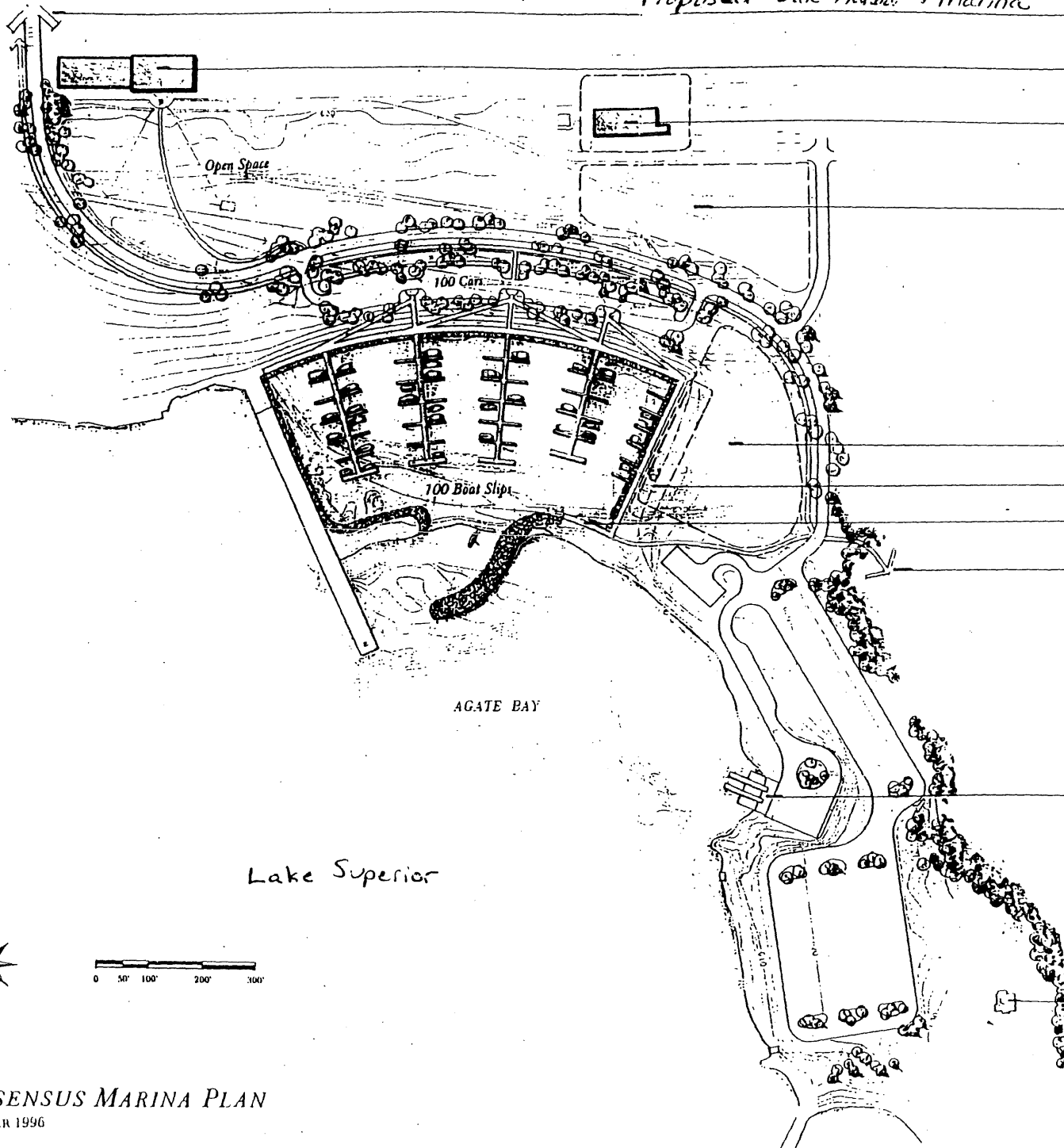

Lake Superior

AGATE BAY



0 50' 100' 200' 300'

CONSENSUS MARINA PLAN

SEPTEMBER 1996

JJR

One North Pinkney Street
Madison, Wisconsin 53703
608 251 1177