

An Equal Opportunity Employer



Phone: (612) 296-2428

STATE OF MINNESOTA
MUNICIPAL BOARD

165 Metro Square Building
121 East Seventh Place
St. Paul, Minnesota 55101-2142

AMENDED LETTER

December 11, 1989

Carole Grimm
City Clerk
224 First Avenue SW
Rochester, Minnesota 55902

Docket Number: A-4658

Ordinance Number: 2665 & 2666

City of Rochester

Dear Mr. Bailey:

The Minnesota Municipal Board has now processed and approved the above ordinance in accordance with Minnesota Statutes, Chapter 414, and the Rules of Procedure.

According to law, this annexation ordinance must be filed with the Township Clerk, County Auditor, Secretary of State, and the Municipal Board. (Since the ordinance has already been filed with the Municipal Board, no additional copies are required.) We recommend that you also file the ordinance with the County Recorder.

The annexation is final upon the date the ordinance is approved by the Board, which is the date of this letter.

Sincerely,

MUNICIPAL BOARD

Patricia D. Lundy
Patricia D. Lundy
Assistant Director

PDL:ry

cc: Olmsted County Auditor
Haverhill Township Clerk
Cascade Township Clerk
Judy Kay Scherr, Deputy City Clerk
Ron Bailey, Attorney at Law
Secretary of State

+4/0024
STATE OF MINNESOTA
DEPARTMENT OF STATE
FILED

FEB 14 1990

Frank LaRocca
Secretary of State

STATE OF MINNESOTA)
COUNTY OF OLMSTED)

I, JUDY KAY SCHERR, DEPUTY CITY CLERK OF THE CITY OF ROCHESTER,
MINNESOTA, DO HEREBY CERTIFY THAT I HAVE COMPARED THE ATTACHED
COPY OF AN ORDINANCE WITH THE ORIGINAL ORDINANCE ON FILE IN MY
OFFICE AND THAT THE FOREGOING IS A TRUE AND CORRECT COPY OF THE
SAID ORDINANCE AND OF THE WHOLE THEREOF.

WITNESS MY HAND THIS 13TH DAY OF DECEMBER, 1989.

Judy Kay Scherr
Deputy City Clerk
City of Rochester, Minnesota

(Seal of the City of
Rochester, Minnesota)

ORDINANCE NO. 2666

AN ORDINANCE ANNEXING TO THE CITY OF ROCHESTER, MINNESOTA, APPROXIMATELY 13.50 ACRES OF LAND IN THE EAST HALF OF THE NORTHEAST QUARTER OF SECTION 25, TOWNSHIP 107 NORTH, RANGE 14 WEST, IN CASCADE TOWNSHIP, OLMSTED COUNTY, MINNESOTA.

THE COMMON COUNCIL OF THE CITY OF ROCHESTER DO ORDAIN:

Section 1. A petition has been filed with the Common Council of the City of Rochester, signed by the owner of land described herein, requesting the Common Council to annex said land to the City of Rochester. The land described in said petition for annexation is located in Cascade Township, Olmsted County, Minnesota, and is described together with adjacent public road right-of-way as follows:

That part of the East Half of the Northeast Quarter of Section 25, Township 107 North, Range 14 West, Olmsted County, Minnesota, described as follows:

Commencing at the southeast corner of said Northeast Quarter; thence northerly on a Minnesota State Plane Grid Azimuth from north of 359 degrees 42 minutes 20 seconds along the east line of said Northeast Quarter 1020.55 feet to the intersection with the northwesterly line of Northern Heights East Fourth Subdivision, according to the plat thereof on file in the County Recorder's Office, Olmsted County, Minnesota and the point of beginning; thence continuing northerly 359 degrees 42 minutes 20 seconds azimuth along said east line 959.72 feet; thence southwesterly 238 degrees 00 minutes 03 seconds azimuth 225.01 feet; thence westerly 285 degrees 59 minutes 33 seconds azimuth 515.00 feet; thence southerly 195 degrees 59 minutes 33 seconds azimuth 220.00 feet; thence southeasterly 153 degrees 34 minutes 51 seconds azimuth 200.92 feet; thence southwesterly 212 degrees 29 minutes 33 seconds azimuth 205.97 feet to the northerly corner of Northern Heights East Fifth Subdivision, according to the plat thereof on file in the County Recorder's Office, Olmsted County, Minnesota; thence southeasterly 122 degrees 29 minutes 33 seconds azimuth along the northeasterly line of said Northern Heights East Fifth Subdivision 451.36 feet; thence southwesterly 212 degrees 29 minutes 33 seconds azimuth along said northeasterly line 120.00 feet; thence southeasterly 122 degrees 29 minutes 33 seconds azimuth along said northeasterly line 396.98 feet to the easterly corner of said Northern Heights East Fifth Subdivision; thence northeasterly 41 degrees 02 minutes 06 seconds azimuth along said northwesterly line of Northern Heights East Fourth Subdivision 185.24 feet to the point of beginning.

Said tract contains 13.50 acres more or less.

Said petition has also been filed with the Town Board of Cascade Township, with the County Board of the County of Olmsted, and with the Minnesota Municipal Board, and the Town Board of Cascade Township has notified the City that it has no objections to the annexation of the above-described land.

Section 2. The quantity of land included in said petition is approximately 13.50 acres in size.

Section 3. The Common Council of the City of Rochester does hereby determine that the land described in Section 1 abuts upon the present territorial limits of the City of Rochester, is so conditioned as to be properly subjected to municipal government, and the annexation of said land will be in the best interest of the City of Rochester and the land described.

Section 4. Therefore, the land described in Section 1 above is hereby annexed, added to and made a part of the City of Rochester, Minnesota, as effectually as if it had originally been a part thereof.

Section 5. Present and future owners of the lands annexed by this ordinance are hereby notified that in addition to the usual assessments, it is the intention of the Common Council to assess against benefited property all or a portion of the cost of any storm sewer, water tower, and trunk line sanitary sewer construction, heretofore or hereafter undertaken to serve the area annexed.

Section 6. Present and future owners of the lands annexed by this ordinance are hereby notified that it is the intention of the City of Rochester to provide electrical service through its Public Utility Department to any development on the lands annexed; and that said annexation by the City represents a commitment by the City to extend its electrical distribution facilities to serve said lands.

Section 7. This ordinance shall take effect and be in force from and after its official publication and from and after the filing of a certified copy hereof with the Minnesota Municipal board, the Cascade Town Clerk, the County Auditor, and the Secretary of State.

PASSED AND ADOPTED BY THE COMMON COUNCIL OF THE CITY OF
ROCHESTER, MINNESOTA, THIS 4 DAY OF December, 1989.

Nancy B. Selby
PRESIDENT OF SAID COMMON COUNCIL

ATTEST: Carole A. Grunni
CITY CLERK

APPROVED THIS 5 DAY OF December, 1989.

Nancy B. Selby
Acting MAYOR OF SAID CITY

(Seal of the City of
Rochester, Minnesota)

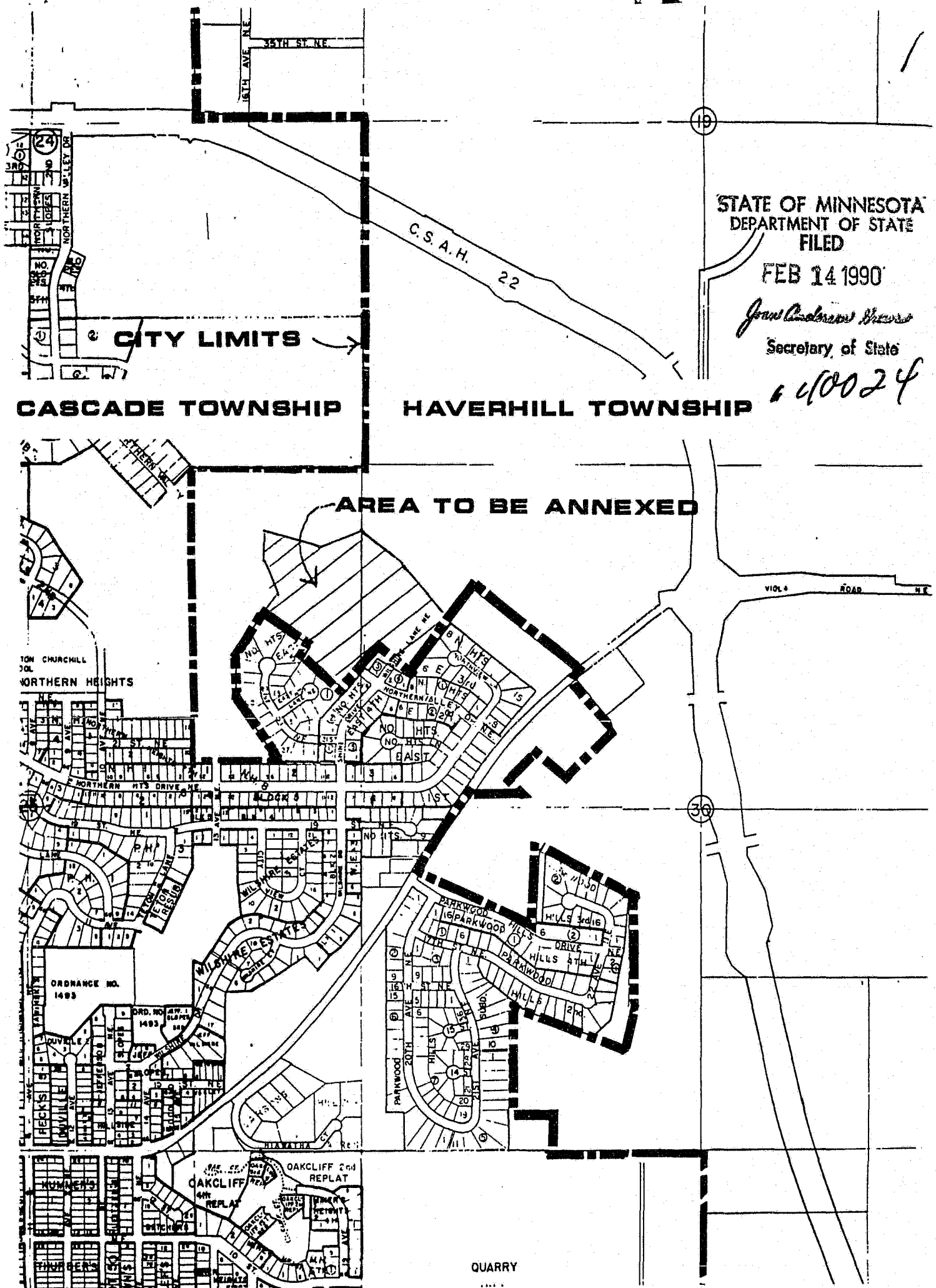

STATE OF MINNESOTA
DEPARTMENT OF STATE
FILED

FEB 14 1990

John Anderson
Secretary of State

640024

CASCADE TOWNSHIP

HAVERHILL TOWNSHIP

AREA TO BE ANNEXED

TOM CHURCHILL
JOL
NORTHERN HEIGHTS

ORDNANCE NO.
1493

OAKCLIFF 2nd
REPLAT

QUARRY