



STATE OF MINNESOTA  
MUNICIPAL BOARD

Suite 165 Metro Square  
7th & Robert Streets  
St. Paul, Minnesota 55101

July 11, 1989

Richard Hierstein  
Owatonna City Administrator  
Owatonna City Hall  
540 West Hills Circle  
Owatonna, MN 55060

Docket Number A-4624

Ordinance Dated 7-5-89

City of Owatonna

Dear Mr. Hierstein:

The Minnesota Municipal Board has now processed and approved the above ordinance in accordance with Minnesota Statutes, Chapter 414, and the Rules of Procedure.

According to law, this annexation ordinance must be filed with the Township Clerk, County Auditor, Secretary of State, and the Municipal Board. (Since the ordinance has already been filed with the Municipal Board, no additional copies are required.) We also recommend that you file the ordinance with the County Recorder.

The annexation is final upon the date the ordinance is approved by the Board, which is the date of this letter.

Sincerely,

MUNICIPAL BOARD

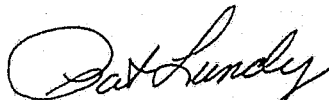
  
Patricia D. Lundy  
Assistant Director

PDL:sw

cc: Steele County Auditor  
Owatonna Township Clerk  
Secretary of State

#39426  
STATE OF MINNESOTA  
DEPARTMENT OF STATE  
FILED

AUG 1 1989

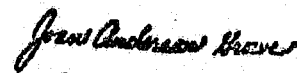
  
Secretary of State

*The City of Friendliness and Beautiful Parks*

*Owatonna*

# City of Owatonna

PLANNING AND ZONING DEPARTMENT

July 18, 1989

Secretary of State  
180 State Office Building  
St. Paul, MN. 55155

ATTN: Donna Scott

Enclosed is Owatonna Ordinance No. 974 annexing property into the city of Owatonna. The property is currently owned by the City. The property annexed is 25 acres located on the north side of Bridge St. west of the centerline of 32nd Ave. NW. Minnesota Statute 414.033, Subd. 7 requires that such ordinance be filed with the Secretary of State. If you have any questions feel free to contact me at 451-4541.

Sincerely,

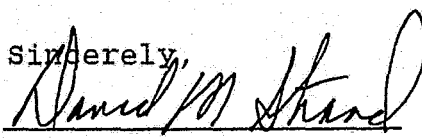
  
David Strand  
City Planner

Proposed Ordinance No. 6/89

ORDINANCE NO. 974

AN ORDINANCE ANNEXING TO THE CITY OF OWATONNA CERTAIN UNINCORPORATED, UNPLATTED LAND OWNED BY THE CITY OF OWATONNA.

THE CITY COUNCIL OF THE CITY OF OWATONNA DO ORDAIN:

SECTION 1. The City Council hereby determines:

1. The property described herein is owned by the City of Owatonna and is suitably conditioned for and needs urban government.
2. That the annexation will be to the best interest of the City of Owatonna and of the property affected.
3. That the City has authority pursuant to Minnesota Statutes 414.033, Subd. 2 (a), by ordinance to declare the property described herein annexed to the City.

SECTION 2. That the following described property, situated in the County of Steele, State of Minnesota to-wit:

All that part of Lots 5 and 6 in the West Half of Section 8, Township 107 North, Range 20 West, Steele County, Minnesota, described by:

Commencing at the Northwest corner of the Southwest Quarter of said Section 8; thence South  $0^{\circ}41'02''$  East, assumed bearing, 45.93 feet along the West line of said Southwest Quarter to a point on the South right-of-way line of the former Chicago and North Western Railroad, last said point being the True Point of Beginning; thence North  $74^{\circ}44'48''$  East 187.43 feet along said railroad right-of-way to the West corner of said Lot 5; thence North  $74^{\circ}44'48''$  East 624.75 feet along said railroad right-of-way line; thence South  $0^{\circ}41'02''$  East 153.10 feet to a point on the South line of said Lot 5, last said point being North  $88^{\circ}55'53''$  East 604.67 feet from the West corner of said Lot 5; thence South  $0^{\circ}41'02''$  East 1330.88 feet to the South line of said Lot 6; thence South  $88^{\circ}47'53''$  West 786.10 feet along the South line of said Lot 6 and along the South line of the North Half of said Southwest Quarter to the Southwest corner of said Lot 6; thence North  $0^{\circ}41'02''$  West 1286.78 feet along the West line of said Lot 6 and along the West line of said Southwest Quarter to said True Point of Beginning;

be and the same hereby is annexed to the City of Owatonna and shall, upon the effective date of this ordinance, become a part of the City of Owatonna as effectively as if it had been originally a part thereof, and the corporate limits of said City of Owatonna are hereby extended to include said unplatted land.

SECTION 3. The Zone Class I-P (Industrial Park) shall be applied to the lands herein described.

SECTION 4. This ordinance is enacted pursuant to the provisions of Minnesota Statutes, Chapter 414, Section 414.033, Subd. 2 (a).

SECTION 5. Upon its adoption, a certified copy of this ordinance shall be filed with each of the following:

Owatonna Town Clerk  
Minnesota Municipal Board  
Steele County Auditor  
Minnesota Secretary of State

as provided by law.

SECTION 6. This ordinance shall take effect upon its passage, publication and approval by the Minnesota Municipal Board.

Passed and adopted this 5<sup>th</sup> day of July, 1989, with the following vote: Aye 5; No 0; Absent 2.

Approved and signed this 5<sup>th</sup> day of July, 1989.

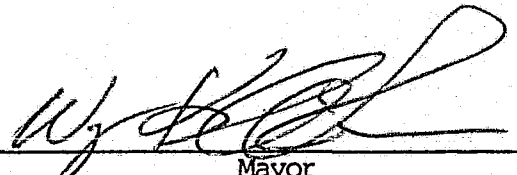
  
\_\_\_\_\_  
Mayor

ATTEST:

  
\_\_\_\_\_  
City Clerk

PROPOSED ANNEXATION

25 ACRES

STATE OF MINNESOTA  
DEPARTMENT OF STATE  
FILED

AUG 11 1989

*Jean Anderson Brown* 39426  
Secretary of State

RESIDENTIAL DISTRICTS

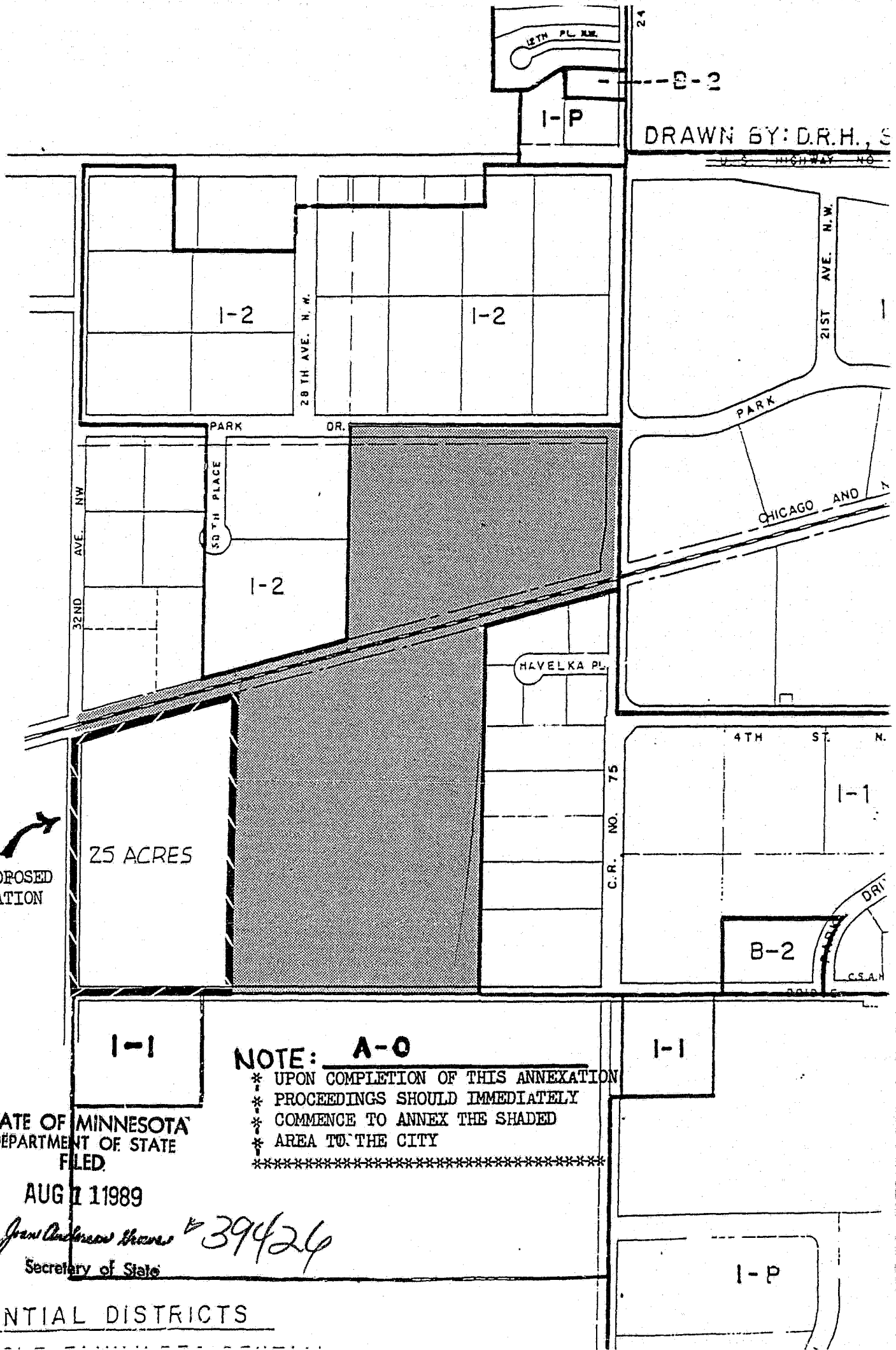

DRAWN BY: D.R.H., S.

U.S. HIGHWAY NO.

C.R. NO. 75

C.S.A.

NOTE: A-0  
\* UPON COMPLETION OF THIS ANNEXATION  
\* PROCEEDINGS SHOULD IMMEDIATELY  
\* COMMENCE TO ANNEX THE SHADED  
\* AREA TO THE CITY  
\*\*\*\*\*