



STATE OF MINNESOTA
MUNICIPAL BOARD

Suite 165 Metro Square
7th & Robert Streets
St. Paul, Minnesota 55101

May 15, 1989

Carole A. Grimm
City Clerk
Room 100, City Hall
Rochester, Minnesota 55902-3163

Docket Number A-4574

Ordinance Number 2633

City of Rochester

Dear Ms. Grimm:

The Minnesota Municipal Board has now processed and approved the above ordinance in accordance with Minnesota Statutes, Chapter 414, and the Rules of Procedure.

According to law, this annexation ordinance must be filed with the Township Clerk, County Auditor, Secretary of State, and the Municipal Board. (Since the ordinance has already been filed with the Municipal Board, no additional copies are required.) We also recommend that you file the ordinance with the County Recorder.

The annexation is final upon the date the ordinance is approved by the Board, which is the date of this letter.

Sincerely,

MUNICIPAL BOARD

Patricia D. Lundy
Assistant Director

PDL:sjh

- cc: Olmsted County Auditor
- Rochester Township Clerk
- Judy Kay Scherr, Deputy City Clerk
- Jeff Ellerbusch, Consolidated Planning Department
- Maxine A. Thompson, Petitioner
- Ron C. Bailey, Yaggy Colby Associates
- Secretary of State

139110
STATE OF MINNESOTA
DEPARTMENT OF STATE
FILED

MAY 17 1989

Secretary of State

Rochester

STATE OF MINNESOTA)
)
COUNTY OF OLMSTED)

I, JUDY KAY SCHERR, DEPUTY CITY CLERK OF THE CITY OF ROCHESTER,
MINNESOTA, DO HEREBY CERTIFY THAT I HAVE COMPARED THE ATTACHED
COPY OF AN ORDINANCE WITH THE ORIGINAL ORDINANCE ON FILE IN MY
OFFICE AND THAT THE FOREGOING IS A TRUE AND CORRECT COPY OF THE
SAID ORDINANCE AND OF THE WHOLE THEREOF.

WITNESS MY HAND THIS 3rd DAY OF May, 1989.

Judy Kay Scherr
Deputy City Clerk
City of Rochester, Minnesota

(Seal of the City of
Rochester, Minnesota)

ORDINANCE NO. 2633

AN ORDINANCE RELATING TO ANNEXATION; ANNEXING 4.0 ACRES OF LAND IN THE EAST HALF OF THE NORTHEAST QUARTER OF SECTION 9, ROCHESTER TOWNSHIP, TO THE CITY OF ROCHESTER, MINNESOTA.

THE COMMON COUNCIL OF THE CITY OF ROCHESTER DO ORDAIN:

Section 1. A petition has been filed with the Common Council of the City of Rochester, signed by the owner of land described herein, requesting the Common Council to annex said land to the City of Rochester. The land described in said petition for annexation is located in Rochester Township, Olmsted County, Minnesota, and is described together with adjacent public road right-of-way as follows:

That part of the East Half of the Northeast Quarter of Section 9, Township 106 North, Range 14 West, Olmsted County, Minnesota, described as follows:

Commencing at the northeast corner of said Northwest Quarter; thence southerly on a Minnesota State Plane Grid Azimuth from north of 178 degrees 06 minutes 04 seconds along the east line of said Northeast Quarter 1289.50 feet to the point of beginning; thence westerly 268 degrees 06 minutes 04 seconds azimuth 221.16 feet; thence southerly 165 degrees 12 minutes 11 seconds azimuth 172.35 feet; thence southerly 178 degrees 12 minutes 11 seconds azimuth 332.00 feet; thence westerly 267 degrees 52 minutes 11 seconds azimuth 66.72 feet to a line which is 250.00 feet westerly of and parallel with the east line of said Northeast Quarter; thence southerly 178 degrees 06 minutes 04 seconds azimuth along said line 318.03 feet; thence easterly 268 degrees 06 minutes 04 seconds azimuth 250.00 feet to the east line of said Northeast Quarter; thence northerly 358 degrees 06 minutes 04 seconds azimuth along said east line 818.30 feet to the point of beginning.

Said tract contains 4.00 acres more or less.

Section 2. The quantity of land included in said petition is approximately 4.0 acres in size.

Section 3. The Common Council of the City of Rochester does hereby determine that the land described in Section 1 abuts upon the present territorial limits of the City of Rochester, is so conditioned as to be properly subjected to municipal government, and the annexation of said land will be in the best interest of the City of Rochester and the land described.

Section 4. Therefore, the land described in Section 1 above is hereby annexed, added to and made a part of the City of Rochester, Minnesota, as effectually as if it had originally been a part thereof.

Section 5. Present and future owners of the lands annexed by this ordinance are hereby notified that in addition to the usual assessments, it is the intention of the Common Council to assess against benefited property all or a portion of the cost of any storm sewer, water tower, and trunk line sanitary sewer construction, heretofore or hereafter undertaken to serve the area annexed.

Section 6. This ordinance shall take effect and be in force from and after its official publication and from and after the filing of a certified copy hereof with the Minnesota Municipal board, the Rochester Town Clerk, the County Auditor, and the Secretary of State.

PASSED AND ADOPTED BY THE COMMON COUNCIL OF THE CITY OF ROCHESTER, MINNESOTA, THIS 1st DAY OF MAY, 1989.

Nancy B. Selby
PRESIDENT OF SAID COMMON COUNCIL

ATTEST:

Orville A. Gunn
CITY CLERK

APPROVED THIS 3rd DAY OF MAY, 1989.

Chas. L. Hennrich
MAYOR OF SAID CITY

(Seal of the City of
Rochester, Minnesota)

ANNEXATION MAP

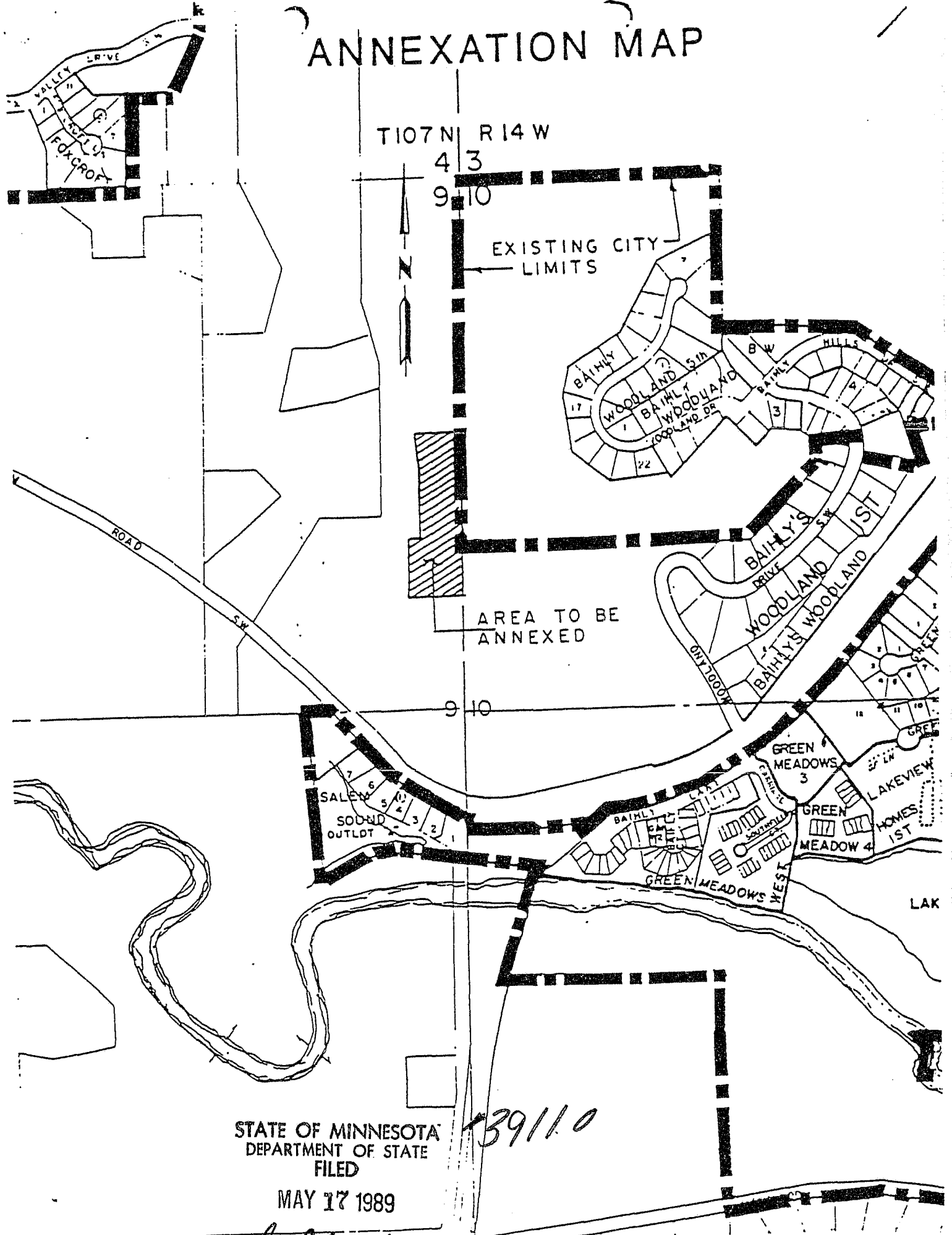

STATE OF MINNESOTA
DEPARTMENT OF STATE
FILED

MAY 17 1989

Grant Anderson

Secretary of State