



STATE OF MINNESOTA  
MUNICIPAL BOARD

Suite 165 Metro Square  
7th & Robert Streets  
St. Paul, Minnesota 55101

April 17, 1989

Carole A. Grimm  
City Clerk  
Room 100, City Hall  
Rochester, Minnesota 55902-3163

Docket Number A-4553

Ordinance Number 2621

City of Rochester

Dear Ms. Grimm:

The Minnesota Municipal Board has now processed and approved the above ordinance in accordance with Minnesota Statutes, Chapter 414, and the Rules of Procedure.

According to law, this annexation ordinance must be filed with the Township Clerk, County Auditor, Secretary of State, and the Municipal Board. (Since the ordinance has already been filed with the Municipal Board, no additional copies are required.) We also recommend that you file the ordinance with the County Recorder.

The annexation is final upon the date the ordinance is approved by the Board, which is the date of this letter.

Sincerely,

MUNICIPAL BOARD

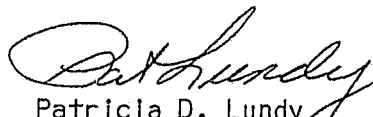
  
Patricia D. Lundy  
Assistant Director

PDL:ry

cc: Olmsted County Auditor  
Rochester Township Clerk  
Judy Kay Scherr, Deputy City Clerk  
Jeff Ellerbusch, Consolidated Planning Department  
Ron Bailey, Yaggy Colby Associates  
Secretary of State

*39024*  
STATE OF MINNESOTA  
DEPARTMENT OF STATE  
FILED

APR 24 1989

  
Secretary of State

STATE OF MINNESOTA )  
                          )  
COUNTY OF OLMSTED )

I, JUDY KAY SCHERR, DEPUTY CITY CLERK OF THE CITY OF ROCHESTER,  
MINNESOTA, DO HEREBY CERTIFY THAT I HAVE COMPARED THE ATTACHED  
COPY OF AN ORDINANCE WITH THE ORIGINAL ORDINANCE ON FILE IN MY  
OFFICE AND THAT THE FOREGOING IS A TRUE AND CORRECT COPY OF THE  
SAID ORDINANCE AND OF THE WHOLE THEREOF.

WITNESS MY HAND THIS 11 DAY OF April, 1989.

Judy Kay Scherr  
Deputy City Clerk  
City of Rochester, Minnesota

(Seal of the City of  
Rochester, Minnesota)



# ROCHESTER

— *Minnesota* —

April 17, 1989

CAROLE A. GRIMM  
City Clerk  
Room 100, City Hall  
Rochester, MN 55902-3163  
(507) 285-8086  
FAX #(507) 285-8256

MEMORANDUM

TO: Whom It May Concern

FROM: Judy Scherr

RE: Ordinance #2621

Please find enclosed a copy of Ordinance #2621 which is a replacement of the previously received copy. The original copy sent you contained typographical and mathematical errors.

If you have any questions, please do not hesitate to contact me. Thanks for your help in this matter.

STATE OF MINNESOTA  
DEPARTMENT OF STATE  
FILED

APR 24 1989

*Joan Anderson Herwe*  
Secretary of State

#39024

ORDINANCE NO. 2621

AN ORDINANCE ANNEXING TO THE CITY OF ROCHESTER, MINNESOTA, APPROXIMATELY 15.43 ACRES OF LAND IN THE SOUTHWEST QUARTER OF SECTION 3, ROCHESTER TOWNSHIP, OLMSTED COUNTY, MINNESOTA.

502116

THE COMMON COUNCIL OF THE CITY OF ROCHESTER DO ORDAIN:

Section 1. A petition has been filed with the Common Council of the City of Rochester, signed by the owner of land described herein, requesting the Common Council to annex said land to the City of Rochester. The land described in said petition for annexation is located in Rochester Township, Olmsted County, Minnesota, and is described together with adjacent public road right-of-way as follows:

PARCEL NO. 1.

That part of the Northeast Quarter of the Southwest Quarter of Section 3, Township 106 North, Range 14 West, Olmsted County, Minnesota, described as follows:

Commencing at the southwesterly corner of Lot 1, Block 3, Folwell Heights Fifth Subdivision, according to the plat thereof on file in the County Recorder's Office, Olmsted County, Minnesota; thence easterly on a Minnesota State Plane Grid Azimuth from north of 68 degrees 35 minutes 10 seconds along the southerly line of said Folwell Heights Fifth Subdivision 90.00 feet to the southwesterly corner of Lot 2, Block 3 of said Folwell Heights Fifth Subdivision and the point of beginning; thence continue easterly 68 degrees 35 minutes 10 seconds azimuth along said southerly line 576.03 feet; thence southerly 158 degrees 35 minutes 10 seconds azimuth 216.00 feet; thence westerly 248 degrees 35 minutes 10 seconds azimuth 576.03 feet to the southeast corner of Lot 6, Block 1, Baihly Heights Third Subdivision, according to the plat thereof on file in the County Recorder's Office, Olmsted County, Minnesota; thence northerly 338 degrees 35 minutes 10 seconds azimuth along the easterly line of said Block 1, a distance of 216.00 feet to the point of beginning.

Said tract contains 2.86 acres more or less.

PARCEL NO.2

That part of the East Half of the Southwest Quarter of Section 3, Township 106 North, Range 14 West, Olmsted County Minnesota, described as follows:

Commencing at the northeast corner of said Southwest Quarter; thence southerly on a Minnesota State Plane Grid Azimuth from north of 179 degrees 00 minutes 33 seconds along the east line of said Southwest Quarter 519.80 feet to the northwesterly corner of North Sunny Slopes, according to the plat thereof

on file in the County Recorder's Office, Olmsted County, Minnesota, and the point of beginning; thence continuing southerly 179 degrees 00 minutes 33 seconds azimuth along said east line, also being the westerly line of said North Sunny Slopes 667.42 feet to the northwest corner of Lot 48 of said North Sunny Slopes; thence westerly 269 degrees 00 minutes 33 seconds azimuth 20.00 feet; thence southerly 179 degrees 00 minutes 33 seconds azimuth 270 feet to the northerly line of Owen's Re-Subdivision, according to the plat thereof on file in the County Recorder's Office, Olmsted County, Minnesota; thence westerly 269 degrees 00 minutes 33 seconds azimuth along said northerly line 139.40 feet to the northwesterly corner of said Re-Subdivision; thence southerly 179 degrees 00 minutes 33 seconds azimuth along the westerly line of said Re-Subdivision 121.46 feet; thence westerly 269 degrees 00 minutes 33 seconds azimuth 309.38 feet to the easterly corner of Baihly Heights Third Subdivision, according to the plat thereof on file in the County Recorder's Office, Olmsted County, Minnesota; thence northwesterly 313 degrees 10 minutes 38 seconds azimuth along the northeasterly line of said Subdivision 409.36 feet to the southeasterly corner of Lot 20, Block 2 of said Subdivision; thence northerly 338 degrees 25 minutes 40 seconds azimuth along the easterly line of said Subdivision 242.97 feet to the southeasterly corner of Lot 6, Block 1 of said Subdivision; thence easterly 68 degrees 35 minutes 10 seconds azimuth along a line 216.00 feet southerly of and parallel with the southerly line of Folwell Heights Fifth Subdivision, according to the plat thereof on file in the County Recorder's Office, Olmsted County, Minnesota 576.03 feet; thence northerly 338 degrees 35 minutes 10 seconds azimuth 216.00 feet to the southerly line of said Folwell Heights Fifth Subdivision; thence easterly 68 degrees 35 minutes 10 seconds azimuth along said south line and the south line of Folwell Heights Fourth Subdivision, according to the plat thereof on file in the County Recorder's Office, Olmsted County, Minnesota, 409.10 feet to the point of beginning.

Said tract contains 12.57 acres more or less.

Said petition has also been filed with the Town Board of Rochester Township, with the County Board of the County of Olmsted, and with the Minnesota Municipal Board, and the Town Board of Rochester Township has notified the City that it has no objections to the annexation of the above-described land.

Section 2. The quantity of land included in said petition is approximately 15.43 acres in size.

Section 3. The Common Council of the City of Rochester does hereby determine that the land described in Section 1 abuts upon the present territorial limits of the City of Rochester, is so conditioned as to be properly subjected to municipal government, and the annexation of said land will be in the best interest of the City of Rochester and the land described.

Section 4. Therefore, the land described in Section 1 above is hereby annexed, added to and made a part of the City of Rochester, Minnesota, as effectually as if it had originally been a part thereof.

Section 5. Present and future owners of the lands annexed by this ordinance are hereby notified that in addition to the usual assessments, it is the intention of the Common Council to assess against benefited property all or a portion of the cost of any storm sewer, water tower, and trunk line sanitary sewer construction, heretofore or hereafter undertaken to serve the area annexed.

Section 6. This ordinance shall take effect and be in force from and after its official publication and from and after the filing of a certified copy hereof with the Minnesota Municipal board, the Rochester Town Clerk, the County Auditor, and the Secretary of State.

PASSED AND ADOPTED BY THE COMMON COUNCIL OF THE CITY OF ROCHESTER, MINNESOTA, THIS 20 DAY OF MARCH, 1989.

Jersey B. Selby  
PRESIDENT OF SAID COMMON COUNCIL

ATTEST: Carol A. Gunnison  
CITY CLERK

APPROVED THIS 21 DAY OF MARCH, 1989.  
Frank Timmins  
MAYOR OF SAID CITY

(Seal of the City of Rochester, Minnesota)

ABSTRACT GRANTOR GRANTEE TRACKED PAID CHG. *Planning*

562116

COUNTY RECORDER OFFICE } ss  
St. Louis County, Minn.  
I hereby certify that the within instrument  
was filed in this office for record on

APR 12 1989

at 2:14 o'clock P M

ok 5 of max on page 459

LOIS FINSTUBER County Recorder  
Luann Murray  
City Clerk

HAZEL PEARSON  
County Auditor  
St. Louis County, Minn.

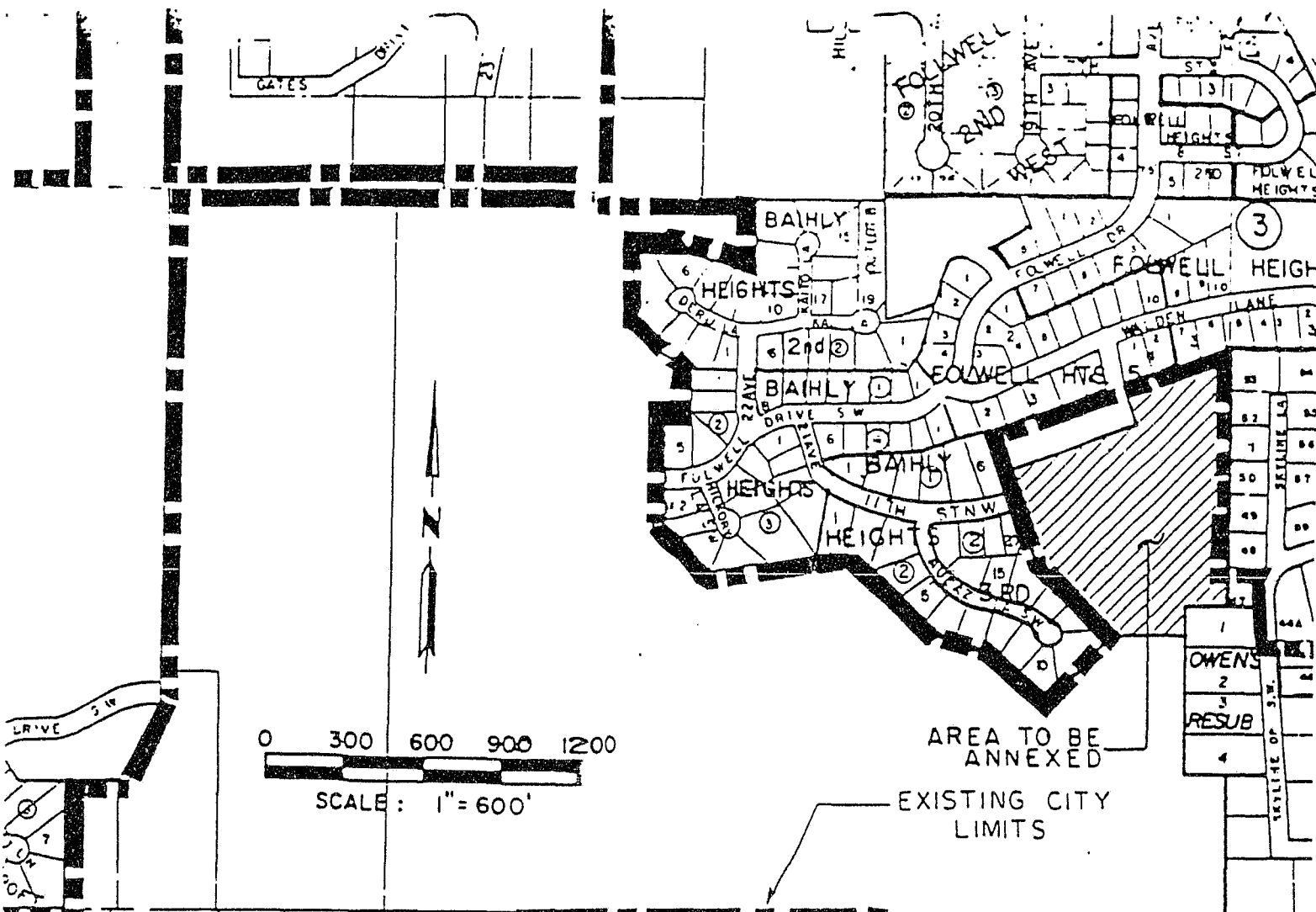

ANNEXATION MAP

STATE OF MINNESOTA  
DEPARTMENT OF STATE  
FILED

APR 2 1989

*Jean Anderson Shores*  
Secretary of State  
39024

