



STATE OF MINNESOTA
MUNICIPAL BOARD

Suite 165 Metro Square
7th & Robert Streets
St. Paul, Minnesota 55101

December 13, 1988

Dale Zaiser
Warroad City Clerk
Warroad City Hall
Warroad, Minnesota 56763

Docket Number A-4533

Ordinance Number 902.00

City of Warroad

Dear Mr. Zaiser:

The Minnesota Municipal Board has now processed and approved the above ordinance in accordance with Minnesota Statutes, Chapter 414, and the Rules of Procedure.

According to law, this annexation ordinance must be filed with the Township Clerk, County Auditor, Secretary of State, and the Municipal Board. (Since the ordinance has already been filed with the Municipal Board, no additional copies are required.) We also recommend that you file the ordinance with the County Recorder.

The annexation is final upon the date the ordinance is approved by the Board, which is the date of this letter.

Sincerely,

MUNICIPAL BOARD

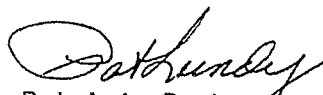

Patricia D. Lundy
Assistant Director

PDL:sg

cc: Roseau County Auditor
Lake Township Clerk
Steven A. Anderson, Attorney at Law
Secretary of State

138608
STATE OF MINNESOTA
DEPARTMENT OF STATE
FILED

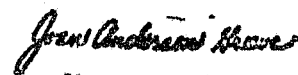
DEC 15 1988

Secretary of State

Warroad

HARDWICK & MERGENS, P. A.

ATTORNEYS AT LAW

116 NORTH MAIN STREET

WARROAD, MINNESOTA 56763

TELEPHONE (218) 386-2330

CYRIL J. MERGENS

BRIAN T. HARDWICK

STEVEN A. ANDERSON

October 18, 1988

109 SECOND AVENUE, N.E.

ROSEAU, MINNESOTA 56751

(218) 463-3434

Office of the Secretary of State
180 State Office Building
100 Constitution Avenue
St. Paul, Minnesota 55155

Re: City of Warroad - Annexation Ordinances

Dear Sir or Madam:

Enclosed herein and served upon you for filing
please find the following:

- (1) A certified copy of City of Warroad
Ordinance No. 902.00
- (2) A certified copy of City of Warroad
Ordinance 903.00

These ordinances reflect action taken by the
City Council of the City of Warroad on October 11,
1988 whereby certain land described within the
ordinances and wholly owned by the City of Warroad
were annexed into the City.

If you should have any questions concerning
this matter, please feel free to contact my office.

Sincerely,

HARDWICK & MERGENS, P.A.

By

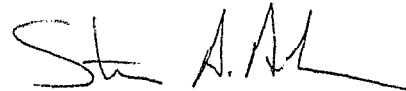

Steven A. Anderson

SAA/laj

Enclosures

ORDINANCE NO. 902.00

AN ORDINANCE EXTENDING THE CORPORATE LIMITS OF THE CITY OF WARROAD TO INCLUDE CERTAIN UNINCORPORATED PROPERTY OWNED BY AND ABUTTING UPON THE LIMITS OF THE CITY.

WHEREAS, the territory described below is not presently within the corporate limits of any incorporated city; and

WHEREAS, the territory abuts upon the corporate limits of the city at the Southern boundary thereof and is deemed to be urban or suburban in character; and

WHEREAS, this territory is owned in fee by the city;

The city council of Warroad ordains:

Section 1. Territory annexed. The corporate limits of the City of Warroad are hereby extended to include the unplatted property described as follows now owned by the city:

That part of the North East Quarter (NE $\frac{1}{4}$) of Section Thirty-two (32), Township One Hundred Sixty-three (163) North, Range Thirty-six (36) West of the Fifth Principal Meridian, Roseau County, Minnesota described as follows:

Commencing at the North East corner of the North East Quarter of said Section 32; thence on an assumed bearing of South 00 degrees 09 minutes 00 seconds East along the East line of said Section 32 a distance of 739.06 feet to the South line of Paul's Addition to the City of Warroad to the point of beginning; thence North 89 degrees 16 minutes 48 seconds West along said South line of Paul's Addition a distance of 1412.87 feet to the Easterly right-of-way

line of the Canadian National Railroad; thence along said Easterly right-of-way South 16 degrees 43 minutes 03 seconds East a distance of 773.72 feet to the point of curve of a tangential curve concave to the northeast, central angle 34 degrees 56 minutes 00 seconds, Radius 2814.93 feet; thence Southeasterly along said curve chord bearing South 30 degrees 40 minutes 07 seconds East, chord distance 1357.43 feet a distance of 1370.94 feet to the South line of said North East Quarter; thence South 89 degrees 44 minutes 47 seconds East along said South line a distance of 52.77 feet; thence North 00 degrees 09 minutes 00 seconds West a distance of 450.00 feet; thence South 89 degrees 44 minutes 47 seconds East a distance of 450.00 feet to the East line of said North East Quarter; thence North 00 degrees 09 minutes 00 seconds West along said East line a distance of 1443.07 feet to the point of beginning. Containing 41.68 acres more or less.

Section 2. Filing. The city clerk is directed to file certified copies of this ordinance with the Secretary of State, the County Auditor of the county of Roseau County, the Lake Township Clerk and the Minnesota Municipal Board.

Section 3. Effective date of annexation. This ordinance takes effect upon its passage and publication and the filing of certified copies as directed in Section 2.

Adopted by the City of Warroad, Minnesota
October 11, 1988.

Gary C. Hendrickson, Mayor

ATTEST:

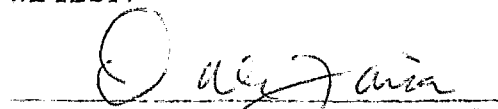
Dale Zaiser, City Clerk

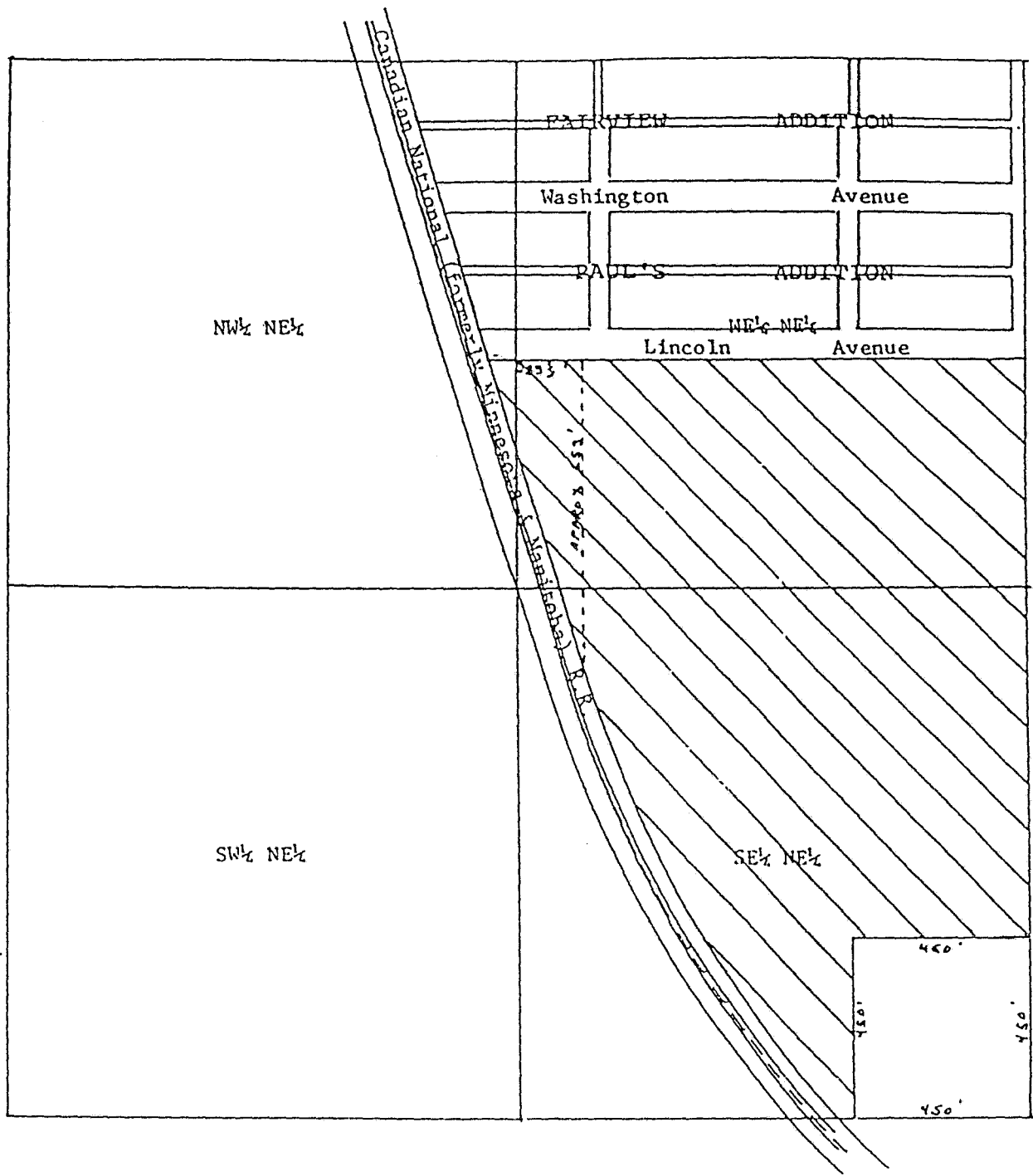

STATE OF MINNESOTA
DEPARTMENT OF STATE
FILED

DEC 15 1933

John Anderson
Secretary of State

38608