



STATE OF MINNESOTA
MUNICIPAL BOARD

Suite 165 Metro Square
7th & Robert Streets
St. Paul, Minnesota 55101

June 9, 1988

Marianne Ouverson
Luverne City Clerk
203 East Main
Luverne, Minnesota 56156

Docket Number A-4492

Ordinance Number 55, 3rd Series

City of Luverne

Dear Ms. Ouverson:

The Minnesota Municipal Board has now processed and approved the above ordinance in accordance with Minnesota Statutes, Chapter 414, and the Rules of Procedure.

According to law, this annexation ordinance must be filed with the Township Clerk, County Auditor, Secretary of State, and the Municipal Board. (Since the ordinance has already been filed with the Municipal Board, no additional copies are required.) We also recommend that you file the ordinance with the County Recorder.

The annexation is final upon the date the ordinance is approved by the Board, which is the date of this letter.

Sincerely,

MUNICIPAL BOARD

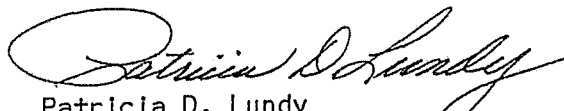

Patricia D. Lundy
Assistant Director

PDL:sg

cc: Rock County Auditor
Luverne Township Clerk
Steven Perkins, City Administrator
Secretary of State

STATE OF MINNESOTA
DEPARTMENT OF STATE
FILED

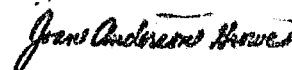
JUN 20 1988

Secretary of State

Luverne

CERTIFICATION

STATE OF MINNESOTA)
COUNTY OF ROCK) SS:
CITY OF LUVERNE)

I, the undersigned, being the duly acting and qualified City Administrator and Secretary of the City Council of Luverne, Minnesota, hereby certify that the attached is a photostatic copy of an ordinance adopted by the City Council at the regular meeting of the Council held on Monday, May 23, 1988, with the original thereof on file in my office, and the same is a full, true and complete transcript therefrom insofar as the same relates to AN ORDINANCE OF THE CITY OF LUVERNE, MINNESOTA ANNEXING CERTAIN REAL ESTATE TO THE CITY OF LUVERNE.

WITNESS my hand and seal of the City this 25th day of May, 1988.

Steven L. Perkins
Steven L. Perkins
City Administrator
City of Luverne, Minnesota

ORDINANCE NO. 55, THIRD SERIES

AN ORDINANCE OF THE CITY OF LUVERNE, MINNESOTA
ANNEXING CERTAIN REAL ESTATE TO THE CITY OF LUVERNE

THE CITY OF LUVERNE ORDAINS:

Section 1. That the City is the owner of the following described real estate situated in the County of Rock, State of Minnesota, described as follows, to-wit:

All that part of the Northeast Quarter (NE 1/4) of Section Fifteen (15), Township One Hundred Two (102) North, Range Forty Five (45) West, lying north of the right-of-way of Interstate Highway No. 90 excepting those portions thereof previously annexed into the City limits of the City of Luverne and described as follows:

The East 1385 feet thereof; and, the West 125 feet of the East 1510 feet of the North 1496 feet thereof

and that said property lies immediately adjacent to and contiguous with the boundaries of the City.

Section 2. That the above-described area has or is about to become urban in its nature and character and it is desirable that municipal services including streets, sewers, water and other utilities, fire protection, police protection and other municipal services be extended to said area.

Section 3. That the property situated in the County of Rock, State of Minnesota, described as follows, to-wit:

All that part of the Northeast Quarter (NE 1/4) of Section Fifteen (15), Township One Hundred Two (102) North, Range Forty Five (45) West, lying north of the right-of-way of Interstate Highway No. 90 excepting those portions thereof previously annexed into the City limits of the City of Luverne as described as follows:

The East 1385 feet thereof; and, the West 125 feet of the East 1510 feet of the North 1496 feet thereof

shall be and is hereby annexed to the City of Luverne in accordance with the provisions of Minnesota Statutes 414.033, Subdivision 2.

Section 4. That upon passage and adoption of this ordinance, a copy of the same shall be duly filed with the Minnesota Municipal Board, Luverne Township, Rock County Auditor, and Secretary of State.

Section 5. This ordinance shall be final following its publication, upon the date of its approval by the Minnesota Municipal Board.

/s/ Gordon P. Gits
Gordon P. Gits, Mayor

ATTEST: /s/ Steven L. Perkins
Steven L. Perkins, City Administrator

Introduced: May 9, 1988

Adopted: May 23, 1988

Published: May 26, 1988

Approved by Municipal Board: _____

MAP OF CITY OF LUVERNE ROCK COUNTY, MINNESOTA

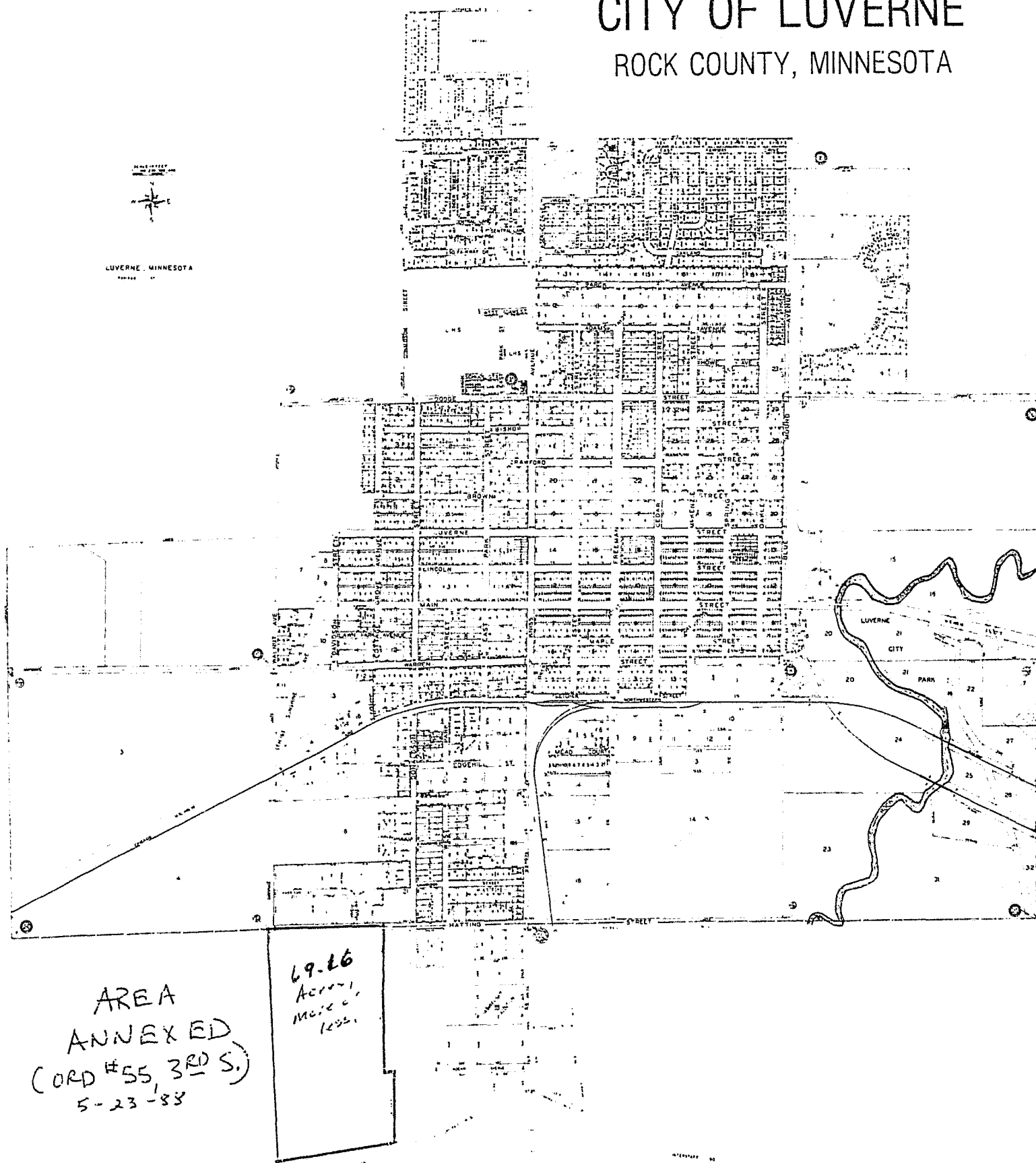

AREA
ANNEXED
(ORD #55, 3RD S.)
5-23-88

69-26
Acres
Mile 2
1992

Individual (s) to Corporation
or PartnershipNo delinquent taxes and transfer entered; Certificate
of Real Estate Value () filed () not required
Certificate of Real Estate Value No. _____

_____, 19____

County Auditor

by _____

Deputy

STATE DEED TAX DUE HEREON: \$ 594.00

Date: May 4, 19 88

(reserved for recording data)

FOR VALUABLE CONSIDERATION, Ruth I. Kirby, a widow and not remarried; Esther
Hand and Bob Hand, her husband; and Kristine M. Rodman, formerly known as
~~Kristine M. Gabrielson and Julie Terrance Rodman, her husband,~~ Grantor(s),

hereby convey (s) and warrant (s) to City of Luverne

_____, Grantee,
a municipal corporation under the laws of Minnesota
real property in Rock County, Minnesota, described as follows:

All that part of the Northeast Quarter of Section Fifteen (15), in Township
One Hundred Two (102) North, of Range Forty-five (45) West, of the 5th
P.M., lying North of the right-of-way line of Interstate 90, except the
following described tracts:

That portion of said Northeast Quarter (NE1) platted as Rock Manor
First Addition, City of Luverne, Rock County, Minnesota, as the same
is on file and of record in the office of the Rock County Recorder; and

That portion of said Northeast Quarter (NE1) platted as Gabrielson
Addition to the City of Luverne, Rock County, Minnesota, as the same
is on file and of record in the office of the Rock County Recorder; and

(If more space is needed, continue on back)

together with all hereditaments and appurtenances belonging thereto, subject to the following exceptions:

(continued on back)

Affix Deed Tax Stamp Here

Ruth I. Kirby

Esther Hand

Bob Hand

Kristine M. Rodman

Julie Terrance Rodman

STATE OF MINNESOTA

COUNTY OF ROCK

ss.

The foregoing instrument was acknowledged before me this _____ day of May, 19 88
by Ruth I. Kirby, a widow and not remarried; Esther Hand, wife of Bob Hand,
and Kristine M. Rodman, formerly known as Kristine M. Gabrielson, and Julie
Terrance Rodman, her husband

NOTARIAL STAMP OR SEAL (OR OTHER TITLE OR RANK)

SIGNATURE OF PERSON TAKING ACKNOWLEDGMENT

Tax Statements for the real property described in this instrument should
be sent to (include name and address of Grantee):

City of Luverne
Luverne, Minnesota 56156

THIS INSTRUMENT WAS DRAFTED BY (NAME AND ADDRESS):

SKEWES & KLOSTERBUER
Box 247
Luverne, Minnesota 56156

COPY

(Continued from front page)

That part of the Northeast Quarter (NE $\frac{1}{4}$) of said Section 15, Township 102 North, Range 45 West, of the 5th P. M., described as follows: Commencing at the Northwest corner of Lot 5, Gabrielson Addition, thence South along the West line of said Lot 5 and Lot 4 in said Gabrielson Addition to a point 100 feet South of the Northwest corner of said Lot 4, thence West 50 feet, thence North along a line parallel to the West line of said Lots 5 and 4 in Gabrielson Addition 417 feet to a point being on a Westerly projection of the North line of said Lot 5, thence Easterly along said Westerly projection 50 feet to the point of beginning, subject to easements of record; and

A tract of land in the Northeast Quarter (NE $\frac{1}{4}$) of Section 15, in Township 102 North, Range 45 West, of the 5th P. M., described as follows: Commencing at the East quarter corner of said Section 15, thence North 0°0' West (North 0°0' West, assumed bearing) on the East line of said Section for 1249.10 feet, thence South 89.58 feet West on the South line of Lot 1, Gabrielson Addition to the City of Luverne, Minnesota, for 550 feet to the point of beginning; thence South 89°50' West for 300 feet, thence North 0°0' West for 400 feet, thence North 89°58' East for 300 feet to the Northwest corner of said Lot 1, thence South 0°0' East on the West line of said Lot 1 for 400 feet to the true point of beginning, and containing an area of 2.75 acres, more or less; and

The East 1385 feet of the Northeast Quarter of Section 15, Township 102 North, Range 45 West, of the 5th P.M., Rock County, Minnesota, lying North of the North right-of-way line of Interstate Highway No. 90 and South of the following described line: Commencing at the East quarter corner of said Section 15, thence due North (assumed bearing) on the East line of said Section 15, 1169.10 feet, thence South 89°58' West 1385.0 feet; and

That part of the Easterly 1010 feet of the Southeast Quarter of the Northeast Quarter (SE $\frac{1}{4}$ of NE $\frac{1}{4}$) of Section 15, Township 102 North, Range 45 West, of Trunk Highway No. 75; which lies within a distance of 40 feet on each side of the following described line: Beginning at a point on the East line of said Section 15, distant 1209.1 feet North of the East quarter corner thereof; thence run Westerly at an angle of 90°02' with said East section line (measured from North to West) for 1050 feet and there terminating; containing 1.75 acres, more or less.

AND

Lot Three (3), except the South 50 feet thereof, and the South 167 feet of Lot Four (4), except the North 200 feet of the East 350 feet thereof, all in Gabrielson Addition to the City of Luverne, Minnesota.

The grantors herein have entered into the agreement for the sale of the above described property and have hereby executed and delivered this deed pursuant to the expressed intention of the grantee to acquire said property through eminent domain proceedings.



The City of Luverne Minnesota · 203 East Main · Luverne, Minnesota 56156 · Phone 507-283-2388

Office of: City Administrator

May 25, 1988

Ms. Joan Anderson Growe
Secretary of State
State Office Building, Room 180
St. Paul, Minnesota 55101

Dear Ms. Growe:

Enclosed please find a certified copy of an ordinance of the City of Luverne annexing certain real estate to the City of Luverne to be used as an industrial park. Also find enclosed a map showing the 69.16 acres proposed to be annexed. It is my understanding that your office requires no filing fee and that you will be notified by the Municipal Board of action taken at their June Board meeting.

Should you need any additional information, please feel free to give me a call.

With best wishes, I am

Sincerely,

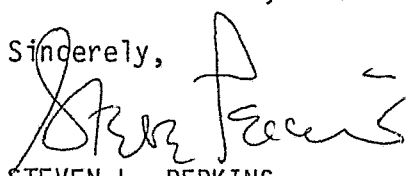

STEVEN L. PERKINS
CITY ADMINISTRATOR

SLP:mo

Enclosure

138225
STATE OF MINNESOTA
DEPARTMENT OF STATE
FILED

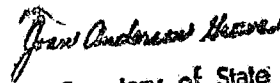
JUN 20 1988

Secretary of State