



STATE OF MINNESOTA
MUNICIPAL BOARD

Suite 165 Metro Square
7th & Robert Streets
St. Paul, Minnesota 55101

December 11, 1986

Carla Raberge
City Clerk
202 East Jackson Street
Box 3368
Mankato, Minnesota 56001

Docket Number A-4295

Ordinance Number 0-86-1124-231
(Amending Ordinance 0-86-0714-219)

City of Mankato

Dear Ms. Raberge:

The Minnesota Municipal Board has now processed and approved the above ordinance in accordance with Minnesota Statutes, Chapter 414, and the Rules of Procedure.

According to law, this annexation ordinance must be filed with the Township Clerk, County Auditor, Secretary of State, and the Municipal Board. (Since the ordinance has already been filed with the Municipal Board, no additional copies are required.) We also recommend that you file the ordinance with the County Recorder.

The annexation is final upon the date the ordinance is approved by the Board, which is the date of this letter.

Sincerely,

MUNICIPAL BOARD

A handwritten signature in cursive script, appearing to read "Pat Lundy".

Patricia D. Lundy
Assistant Director

PDL:sg

cc: Blue Earth County Auditor
Mankato Township Clerk
James Harberts, Planning Director
Arnold To. Wornson
William D. Radichel
Paul W. Radichel
Robert Pecore, MnDOT
Secretary of State

STATE OF MINNESOTA
DEPARTMENT OF STATE

FILED

DEC 16 1986

Joan Anderson Howe
Secretary of State

137048



Mankato

CITY OF MANKATO, MINNESOTA

202 East Jackson Street
Box 3368, Mankato, MN 56001
Telephone: 507-625-3161

December 2, 1986

Secretary of State
180 State Office Building
St. Paul, MN 55155

Dear Secretary Growe:

Enclosed is an ordinance adopted by the City Council amending the description of property annexed by the City in July of 1986. In the fifth line, the description should have read 330 feet instead of 300 feet. If there are any questions, please give me a call.

Sincerely,

James Harberts

James Harberts
Planning Director

JH/dbb

Enclosures

0-86-1124-231

AN ORDINANCE
AMENDING THE LEGAL DESCRIPTION OF
ORDINANCE NO. 0-86-0714-219
ADOPTED BY THE CITY OF MANKATO

WHEREAS, The Council of the City, on the 14th day of July, 1986, adopted Ordinance No. 0-86-0714-219, annexing certain described property to the City of Mankato; and

WHEREAS, the description of such property described has been found to have a typographical error; and

WHEREAS, the Council wishes to amend such description in Ordinance No. 0-86-0714-219.

NOW, THEREFORE, the Council of the City of Mankato hereby ordains that the following is the correct description of property annexed by Ordinance No. 0-86-0714-219:

That part of the Southeast Quarter of the Southeast Quarter of Section 9, Township 108 North, Range 26 West, described as:

Beginning at the Southeast corner of the Southeast Quarter of the Southeast Quarter of Section 9, Township 108 North, Range 26 West; thence North along the Section line a distance 330 feet; thence Westerly at an angle of 90 degrees 14 minutes, a distance of 483 feet; thence Southerly a distance of 330 feet to the Section line; thence Easterly along the South Section line a distance of 483 to the place of beginning being 3.66 acres.

and

The North 50 feet of the Northeast Quarter of the Northeast Quarter of Section 16, Township 108 North, Range 26 West, consisting of Minnesota Highway right-of-way (1.52 acres).

The City Clerk is hereby directed to file copies of this Ordinance with the Minnesota Municipal Board, the Secretary of State, the Blue Earth County Auditor, and the Mankato Town Board.

This Ordinance shall take effect 30 days after its passage, due publication thereof, and approval by the Minnesota Municipal Board.

Adopted this 24th day of November, 1986.

City of Mankato

Herbert Mocol, Mayor

ATTEST:

Carla S. Raberge, City Clerk

O-86-0714-219

AN ORDINANCE ANNEXING PROPERTY
TO THE CORPORATE LIMITS
OF THE CITY OF MANKATO

WHEREAS, certain property described below is not presently included in the corporate limits of any incorporated city, village, or borough; and

WHEREAS, pursuant to Minnesota Statutes 414.033, Subd. 5, a majority of the owners of said described property described below have petitioned the City of Mankato for annexation of such property; and

WHEREAS, the property is located adjacent to existing City boundaries and can be served with public utilities; and

WHEREAS, the Council of the City of Mankato finds that the property is about to become urban in character and no objections to the annexation have been received.

NOW, THEREFORE, the Council of the City of Mankato hereby ordains that the corporate limits of the City are hereby extended to include the land described as follows and the same is hereby annexed to and included within the City of Mankato as effectively as if it had originally been a part thereof:

That part of the Southeast Quarter of the Southeast Quarter of Section 9, Township 108 North, Range 26 West, described as:

Beginning at the Southeast corner of the Southeast Quarter of the Southeast Quarter of Section 9, Township 108 North, Range 26 West; thence North along the Section line a distance 330 feet; thence Westerly at an angle of 90 degrees 14 minutes, a distance of 483 feet; thence Southerly a distance of 300 feet to the Section line; thence Easterly along the South Section line a distance of 483 to the place of beginning being 3.66 acres.

error

and

The North 50 feet of the Northeast Quarter of the Northeast Quarter of Section 16, Township 108 North, Range 26 West, consisting of Minnesota Highway right-of-way (1.52 acres).

The City Clerk is hereby directed to file copies of this Ordinance with the Minnesota Municipal Board, the Secretary of State, the Blue Earth County Auditor, and the Mankato Town Board.

This Ordinance shall take effect 30 days after its passage, due publication thereof, and approval by the Minnesota Municipal Board.

Adopted this 14th day of July, 1986.

City of Mankato

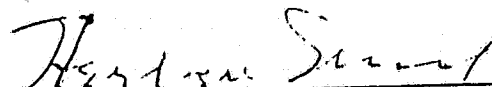
Herbert Mocol, Mayor

ATTEST:

Carla S. Raberge, City Clerk

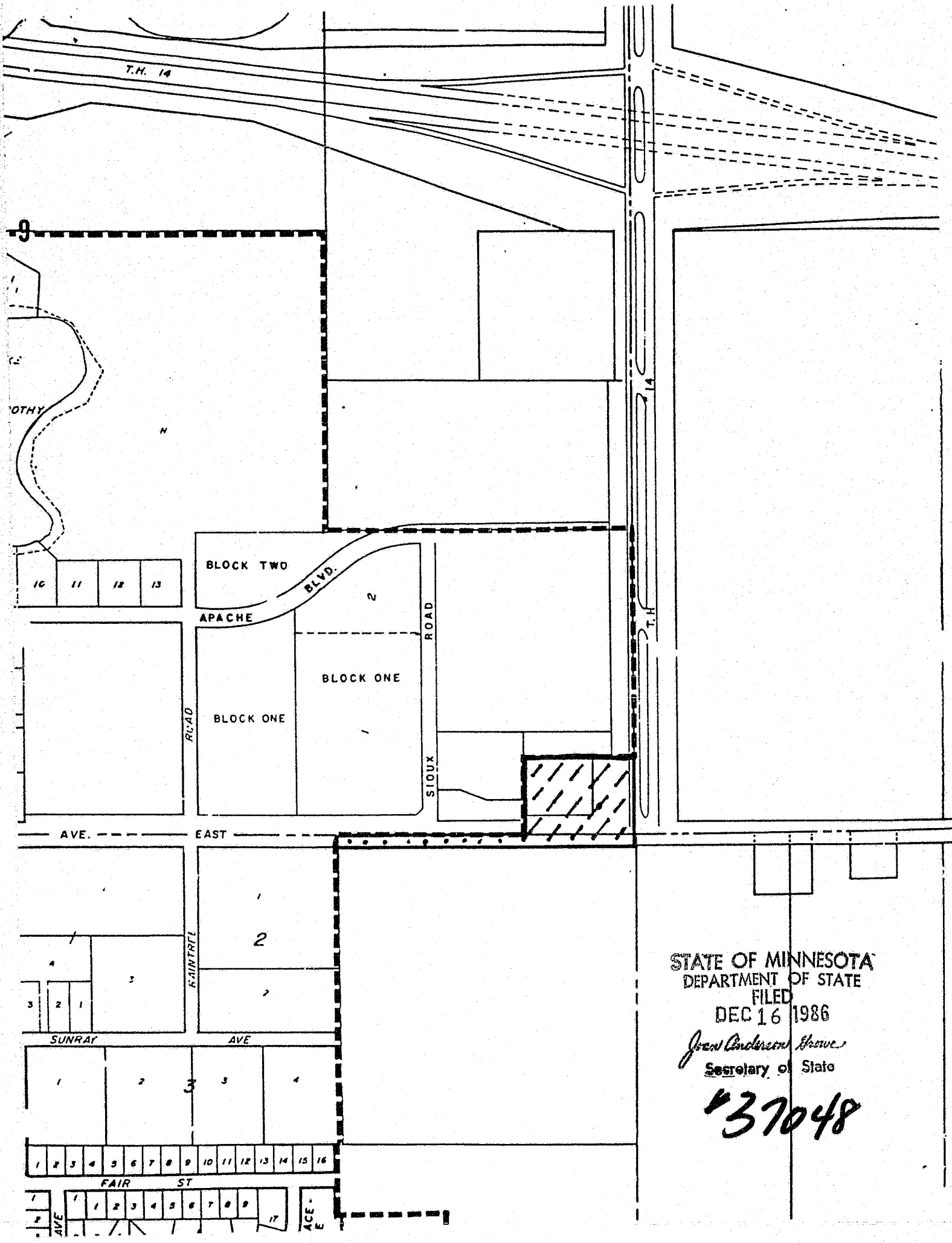

STATE OF MINNESOTA
 DEPARTMENT OF STATE
 FILED
 DEC 16 1986
Joan Anderson Howe
 Secretary of State

37048