



STATE OF MINNESOTA  
MUNICIPAL BOARD

Suite 165 Metro Square  
7th & Robert Streets  
St. Paul, Minnesota 55101

December 12, 1985

Robert Jellum  
City Clerk  
508 South State Street  
Waseca, Minnesota 56093

Docket Number A-4281

Ordinance Number 552

City of Waseca

Dear Mr. Jellum:

The Minnesota Municipal Board has now processed and approved the above ordinance in accordance with Minnesota Statutes, Chapter 414, and the Rules of Procedure.

According to law, this annexation ordinance must be filed with the Township Clerk, County Auditor, Secretary of State, and the Municipal Board. (Since the ordinance has already been filed with the Municipal Board, no additional copies are required.) We also recommend that you file the ordinance with the County Recorder.

The annexation is final upon the date the ordinance is approved by the Board, which is the date of this letter.

Sincerely,

MUNICIPAL BOARD

A handwritten signature in cursive script that reads "Patricia D. Lundy".

Patricia D. Lundy  
Assistant Director

PDL:sg

cc: Waseca County Auditor  
Woodville Township Clerk  
Timothy Madigan, City Manager  
Secretary of State

36386  
STATE OF MINNESOTA  
DEPARTMENT OF STATE  
FILED  
DEC 19 1985

Joan Anderson Howe  
Secretary of State

**City  
Of  
Waseca,  
Minnesota**



*Waseca*

December 4, 1985

Ms. Joan Growe  
Secretary of State  
Room 180 - State Office Building  
St. Paul, Minnesota 55155

Dear Ms. Growe:

The City of Waseca is submitting the attached annexation ordinance and waiver for filing with your office.

Please contact me if you have any questions.

Sincerely,

Timothy G. Madigan  
City Manager

TGM:1ms

cc: Attachments

City  
Of  
Waseca,  
Minnesota



CERTIFICATION

STATE OF MINNESOTA )  
                              ) SS  
COUNTY OF WASECA  )

I hereby certify that the attached copy of Ordinance No. 552, AN ORDINANCE ANNEXING CERTAIN LANDS, ARCHIE D. AND LOIS D. JOHNSON AND DEAN R. AND BOBBIE J. PETERSON PROPERTIES INTO THE CITY OF WASECA, MINNESOTA, AND ESTABLISHING ZONING THEREOF, is a true and correct copy of said Ordinance which was passed and adopted by the Waseca City Council at their regular meeting held on December 3, 1985, which records are on file in my office.

(CITY SEAL)

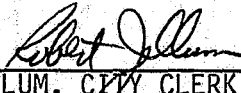
  
\_\_\_\_\_  
ROBERT JELLUM, CITY CLERK

ORDINANCE NO. 552

AN ORDINANCE ANNEXING CERTAIN LANDS, ARCHIE D. & LOIS D. JOHNSON AND DEAN R. & BOBBIE J. PETERSON PROPERTIES INTO THE CITY OF WASECA, MINNESOTA, AND ESTABLISHING ZONING THEREOF

WHEREAS, the lands described below are 100 percent bordered by the municipal limits of the City of Waseca and are fewer than 40 acres, and

WHEREAS, Minnesota Statutes 414.033 (2) (b) authorizes a municipal council to annex land that is 100 percent bordered by its municipal limits and consists of 40 or fewer acres by ordinance, and

WHEREAS, the Waseca City Council deems the lands described below to be urban or suburban in character or about to become so,

NOW, THEREFORE, THE CITY OF WASECA DOES ORDAIN:

Section 1. That the following described land is hereby annexed into the City of Waseca, Minnesota:

SEE EXHIBIT A

Section 2. That the annexed land shall be zoned within the meaning of the City of Waseca zoning ordinances and codes, as shown in Map 1, Exhibit B.

Section 3. That a certified copy of this ordinance shall be filed with the Minnesota Municipal Commission, the Secretary of the State of Minnesota, the Waseca County Auditor, the Waseca County Register of Deeds, and the Clerk of the Woodville Township Board.

Section 4. That this ordinance shall be effective upon passage and legal publication in the filing of the certified copies as described in Section 3.

Passed and adopted by the City Council of Waseca, Minnesota this 3rd day of December, 1985.

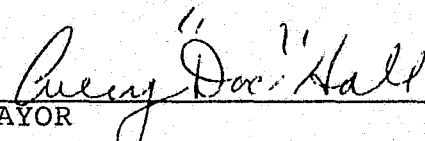
  
MAYOR

ATTEST:

  
ROBERT JELLUM  
CITY CLERK

First Reading November 19, 1985  
Second Reading December 3, 1985  
Published December 12, 1985  
Effective December 22, 1985

EXHIBIT A

JOHNSON - PETERSON ANNEXATION

ORDINANCE NO. 552

LEGAL DESCRIPTION: ARCHIE D. & LOIS D. JOHNSON PROPERTY

All that part of the NE $\frac{1}{4}$  of the NW $\frac{1}{4}$ , Section 20, Township 107 North, Range 22 West, described as follows:

Commencing at the northeast corner of the NE $\frac{1}{4}$  of the NW $\frac{1}{4}$ , Section 20, Township 107 North, Range 22 West; thence south 89° 21' 18" west 296.35 feet on an assumed bearing, on the north line of said  $\frac{1}{4}$  section;

thence south 00° 38' 42" east 161.13 feet, to a point of the north-easterly right-of-way line of State Highway No. 13;

thence southeasterly 122.86 feet, on the northerly right-of-way line of State Highway No. 13, on a non-tangential curve concave to the southwest, with a radius of 931.47 feet, a central angle of 07° 33' 26", and a chord bearing of south 47° 21' 13" east;

thence north 45° 04' 18" east 20.00 feet on a line not tangent to said curve, on the northwesterly right-of-way of Eighth Street Southeast;

thence southeasterly 33.03 feet, on the northeasterly right-of-way line of said State Highway No. 13, on a non-tangential curve concave to the southwest, with a radius of 951.47 feet, a central angle of 01° 59' 20", and a chord bearing of south 42° 36' 17" east, to a point on the centerline of said Eighth Street Southeast;

thence north 45° 04' 18" east 7.78 feet, on a line not tangent to said curve, on the centerline of said Eighth Street Southeast;

thence northeasterly 119.72 feet, on the centerline of said Eighth Street Southeast, on a tangential curve concave to the northwest, with a radius of 719.52 feet, and through a central angle of 09° 32';

thence north 35° 12' 47" east 108.00 feet, on a tangential line on the centerline of said Eighth Street Southeast;

thence northeasterly 77.43 feet, on the centerline of said Eighth Street Southeast, on a tangential curve concave to the west, with a radius of 124.96 feet, and through a central angle of 35° 30', to the point of beginning:

subject to easement for Eighth Street Southeast on each side of a line described as follows:

Beginning at the northeast corner of the NE $\frac{1}{4}$  of the NW $\frac{1}{4}$ , Section 20, Township 107 North, Range 22 West; thence southwesterly along a 45° 51' curve to the right a distance of 77.43 feet along the curve; the tangent of the above curve is an extension of the centerline of

EXHIBIT A  
JOHNSON-PETERSON ANNEXATION  
PAGE 2

Eighth Street Southeast and has a bearing of south  $00^{\circ}17'42''$  west; thence continuing south  $35^{\circ}12'17''$  west for a distance of 108 feet; thence along a  $7^{\circ}58'$  curve to the right a distance of 119.72 feet along the curve; thence continuing south  $45^{\circ}04'18''$  west a distance of 45.67 feet, and there terminating.

LEGAL DESCRIPTION: DEAN R. & BOBBI J. PETERSON PROPERTY

All that part of the  $NE\frac{1}{4}NW\frac{1}{4}$  and the  $NW\frac{1}{4}NE\frac{1}{4}$ , Section 20, Township 107 North, Range 22 West, described as follows:

Commencing at the northeast corner of the  $NE\frac{1}{4}NW\frac{1}{4}$ , Section 20, Township 107 North, Range 22 West;

thence southwesterly 77.43 feet, on the centerline of Eighth Street Southeast, on a curve concave to the west, with a radius of 124.96 feet, a central angle of  $35^{\circ}30'$  and a chord bearing of south  $17^{\circ}27'18''$  west; assuming the north line of said  $NE\frac{1}{4}NW\frac{1}{4}$  has a bearing of south  $89^{\circ}21'18''$  west;

thence south  $35^{\circ}12'17''$  west 108.00 feet, on the centerline of said Eighth Street Southeast, on a line tangent to said curve;

thence southwesterly 119.72 feet on a tangential curve concave to the northwest on the centerline of said Eighth Street Southeast, with a radius of 719.52 feet, and central angle of  $09^{\circ}32'00''$ ;

thence south  $45^{\circ}04'18''$  west 7.78 feet, on the centerline of said Eighth Street Southeast, on a line tangent to said curve, to a point on the northeasterly right-of-way of State Highway No. 13;

thence southeasterly 360.15 feet, on the northeasterly right-of-way line of State Highway No. 13 on a non-tangential curve concave to the southwest, within a radius of 951.47 feet, a central angle of  $21^{\circ}41'15''$  and a chord bearing of south  $30^{\circ}45'57''$  east, to a point on the centerline of a township road;

thence north  $28^{\circ}35'25''$  east 439.95 feet, on the centerline of said township road, on a line not tangent to said curve, to a point on the centerline of a township road;

thence north  $51^{\circ}35'43''$  west 288.36 feet, on the centerline of a township road to the point of beginning:

subject to easement for township road purposes on the northeasterly and easterly sides thereof, and subject to easement for Eighth Street Southeast, on the northwesterly side thereof, described as follows:

A strip of land 66 feet in width, 33 feet on each side of a line described as follows:

EXHIBIT A  
JOHNSON-PETERSON ANNEXATION  
PAGE 3

Beginning at the northeast corner of the NE $\frac{1}{4}$  NW $\frac{1}{4}$ , Section 20, Township 107 North, Range 22 West; thence southwesterly along a 45° 51' curve to the right a distance of 77.43 feet along the curve; the tangent of the above curve is an extension of the centerline of Eighth Street Southeast and has a bearing of south 00° 17' 42" west; thence continuing south 35° 12' 17" west for a distance of 108 feet; thence along a 7° 58' curve to the right a distance of 119.72 feet along the curve; thence continuing south 45° 04' 18" west a distance of 45.67 feet, and there terminating.

EXHIBIT B

JOHNSON-PETERSON ANNEXATION

ORDINANCE NO. \_\_\_\_\_

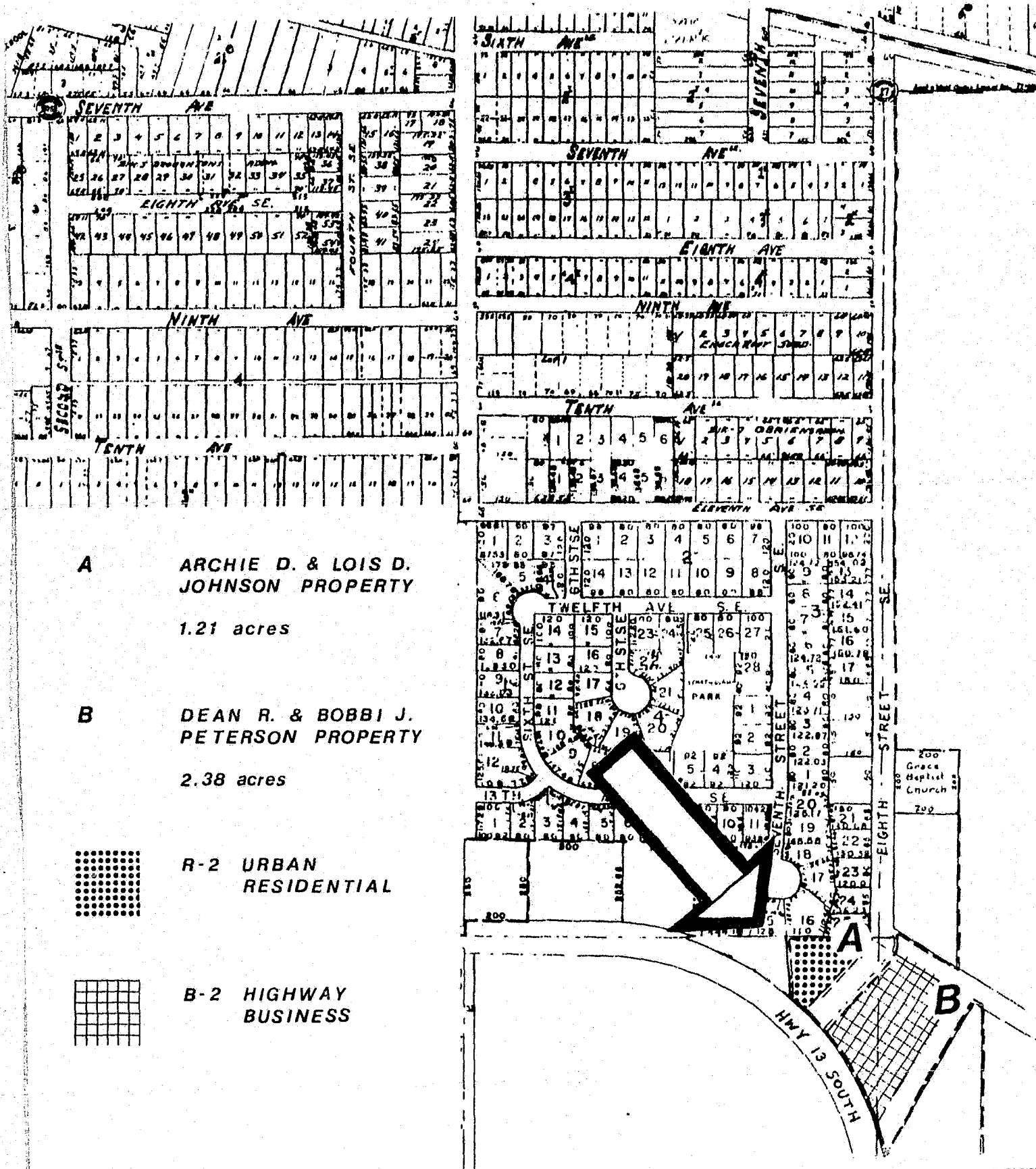

**A** ARCHIE D. & LOIS D. JOHNSON PROPERTY

1.21 acres

**B** DEAN R. & BOBBI J. PETERSON PROPERTY

2.38 acres

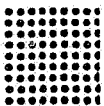

**R-2** URBAN RESIDENTIAL

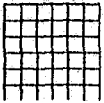

**B-2** HIGHWAY BUSINESS



WAIVER AS TO ANNEXATION

ARCHIE D. & LOIS D. JOHNSON AND DEAN R. & BOBBI J. PETERSON PROPERTIES  
WOODVILLE TOWNSHIP BOARD

WHEREAS, the City of Waseca has expressed its intention to annex properties within the Township of Woodville, adjacent to the City of Waseca, in accordance with M.S. 414.003, Subdivision 2b, and

WHEREAS, said properties (Johnson and Peterson properties) are 100 percent surrounded by land within the municipal limits of the City of Waseca,

NOW, THEREFORE, BE IT RESOLVED by the Woodville Township Board that it hereby consents to annexation and specifically waives any claim or right of appeal for the annexation by the City of Waseca of the property so described in the City's intention to annex, dated Dec 31, 1985.

WOODVILLE TOWNSHIP BOARD  
OF COMMISSIONERS

BY Harlan Minge  
CHAIRMAN

ATTEST Alvin E. Erickson  
CLERK

CERTIFICATION

The Township Clerk of the Town Board of the Township of Woodville hereby acknowledges that he has compared the foregoing Waiver as to Annexation which the original thereof is on file and of record in the records of the Township of Woodville, and certifies that the same is a full, true and correct copy of said Waiver as to Annexation, and certifies that said Waiver was duly adopted as a regular Township meeting as of the date thereof, the full quorum then being present and voting and having been approved by a vote of:

<u>Harlan Minge</u>	<u>Yes</u>
<u>Charles L. Minge</u>	<u>Yes</u>
<u>Wendell B. Smith</u>	<u>Yes</u>

Certified this 3rd day of Dec, 1985

STATE OF MINNESOTA  
DEPARTMENT OF STATE  
FILED  
DEC 19 1985

Jean Anderson Shows  
Secretary of State

Alvin E. Erickson  
CLERK

36384

#36386