



STATE OF MINNESOTA
MUNICIPAL BOARD

Suite 165 Metro Square
7th & Robert Streets
St. Paul, Minnesota 55101

May 17, 1985

Ms. Baldev Josan
City Clerk-Administrator
P.O. Box 108
205 Bridge Avenue, East
Delano, Minnesota 55328

Docket Number A-4185

Ordinance Number 0-85-01

City of Delano

Dear Ms. Josan:

The Minnesota Municipal Board has now processed and approved the above ordinance in accordance with Minnesota Statutes, Chapter 414, and the Rules of Procedure.

According to law, this annexation ordinance must be filed with the Township Clerk, County Auditor, Secretary of State, and the Municipal Board. (Since the ordinance has already been filed with the Municipal Board, no additional copies are required.) We also recommend that you file the ordinance with the County Recorder.

The annexation is final upon the date the ordinance is approved by the Board, which is the date of this letter.

Sincerely,

MUNICIPAL BOARD

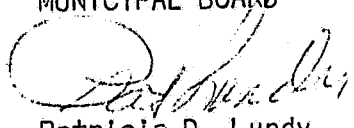

Patricia D. Lundy
Assistant Director

PDL:sg

cc: Wright County Auditor
Franklin Township Clerk
Richard Grinley, Attorney at Law
Secretary of State

36048
STATE OF MINNESOTA
DEPARTMENT OF STATE
FILED

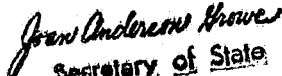
MAY 22 1985

Secretary of State

Delano

ORDINANCE NO. 0-85- 01

AN ORDINANCE EXTENDING THE CORPORATE LIMITS OF THE CITY OF DELANO TO INCLUDE CERTAIN UNINCORPORATED UNPLATTED LAND NOT EXCEEDING 200 ACRES IN AREA ABUTTING UPON THE CITY LIMITS

WHEREAS, a certain petition dated January 17, 1985, requesting annexation of the territory hereinafter described was duly presented to the Council and approved on January 21, 1985; and

WHEREAS, the petition was signed by all owners; and

WHEREAS, the petition was duly served on the Township of Franklin on January 30, 1985; and

WHEREAS, no objections to the annexation had been received from the town board of Franklin Township or the governing body of any municipality whose boundaries abutt upon the boundaries of the land to be annexed; and

WHEREAS, the town board of Franklin Township has adopted a resolution consenting to the annexation by the City of Delano of the territory hereinafter described and waiving the time to make objection; and

WHEREAS, the land described in the petition abutts upon the City limits at the southern boundary thereof;

THE COUNCIL OF THE CITY OF DELANO, MINNESOTA, ORDAINS:

SECTION 1. The City Council hereby determines (1) that the territory described herein abutts upon the City limits and is or is about to become urban or suburban in character; and (2) that none of the territory is now included within the limits of any city.

SECTION 2. Territory Annexed. The corporate limits of the city are hereby extended to include the unplatted land described

in Exhibit A attached hereto and made a part hereof and the same is hereby annexed to and included within the city as effectually as if it had originally been a part thereof.

SECTION 3. Filing. The City Administrator is hereby directed to file certified copies of this ordinance with the Minnesota Municipal Board, the Secretary of State, the Town Clerk, and the County Auditor.

SECTION 4. Effective Date. This ordinance takes effect upon its passage and publication, and the filing of the certified copies as directed in Section 3, and approval of the ordinance by the Municipal Board.

PASSED BY THE MAYOR AND CITY COUNCIL OF THE CITY OF DELANO,
MINNESOTA THIS 5th DAY OF March , 1985.

Chuck Theis
Chuck Theis, Mayor

ATTEST:

Baldev S. Josan
Baldev S. Josan, City Administrator

Motion by: Iten
Second by: Huncha
Chuck Theis: Aye
Verna Quale: Aye
David Zitzloff: Aye
Char Iten: Aye
Ambrose Huncha: Aye

I certify this to be a true and correct copy.

Baldev S. Josan
Baldev S. Josan, City Administrator

EXHIBIT A

IN WRIGHT COUNTY, MINNESOTA:

Commencing at the Northeast corner of the South one-half (S $\frac{1}{2}$) of the Northwest quarter (NW $\frac{1}{4}$) of Section 13, Township 118, Range 25 as the point of beginning of the tract of land to be described; thence south along the east line of said Northwest quarter (NW $\frac{1}{4}$) for approximately 1323.31 feet to the center of said Section 13; thence west along the south line of said Northwest quarter (NW $\frac{1}{4}$) for approximately 1961.04 feet to its intersection with the centerline of Wright County Highway Number 17; thence northerly along said centerline of Wright County Highway number 17 to the southwestern most corner of Delano Industrial Park Sell Addition according to the plat thereof filed in the office of the County Recorder of Wright County, Minnesota on October 22, 1984, as document no. 390447; thence easterly, northeasterly, southeasterly, and northeasterly along the southerly and easterly lines of said Delano Industrial Park Sell Addition to the northeastern most corner of said Delano Industrial Park Sell Addition at its point of intersection with the north line of said South one-half (S $\frac{1}{2}$) of the Northwest quarter (NW $\frac{1}{4}$); thence east along said north line of the South one-half (S $\frac{1}{2}$) of the Northwest quarter (NW $\frac{1}{4}$) for approximately 131.57 feet to the point of beginning and there terminating.

V 36048
STATE OF MINNESOTA
DEPARTMENT OF STATE

FILED
MAY 22 1985

Jan Anderson Howe
Secretary of State

SEC. 15, T. 116, R. 25

SEC. 15, T. 116, R. 25

SEC. 15, T. 116, R. 25

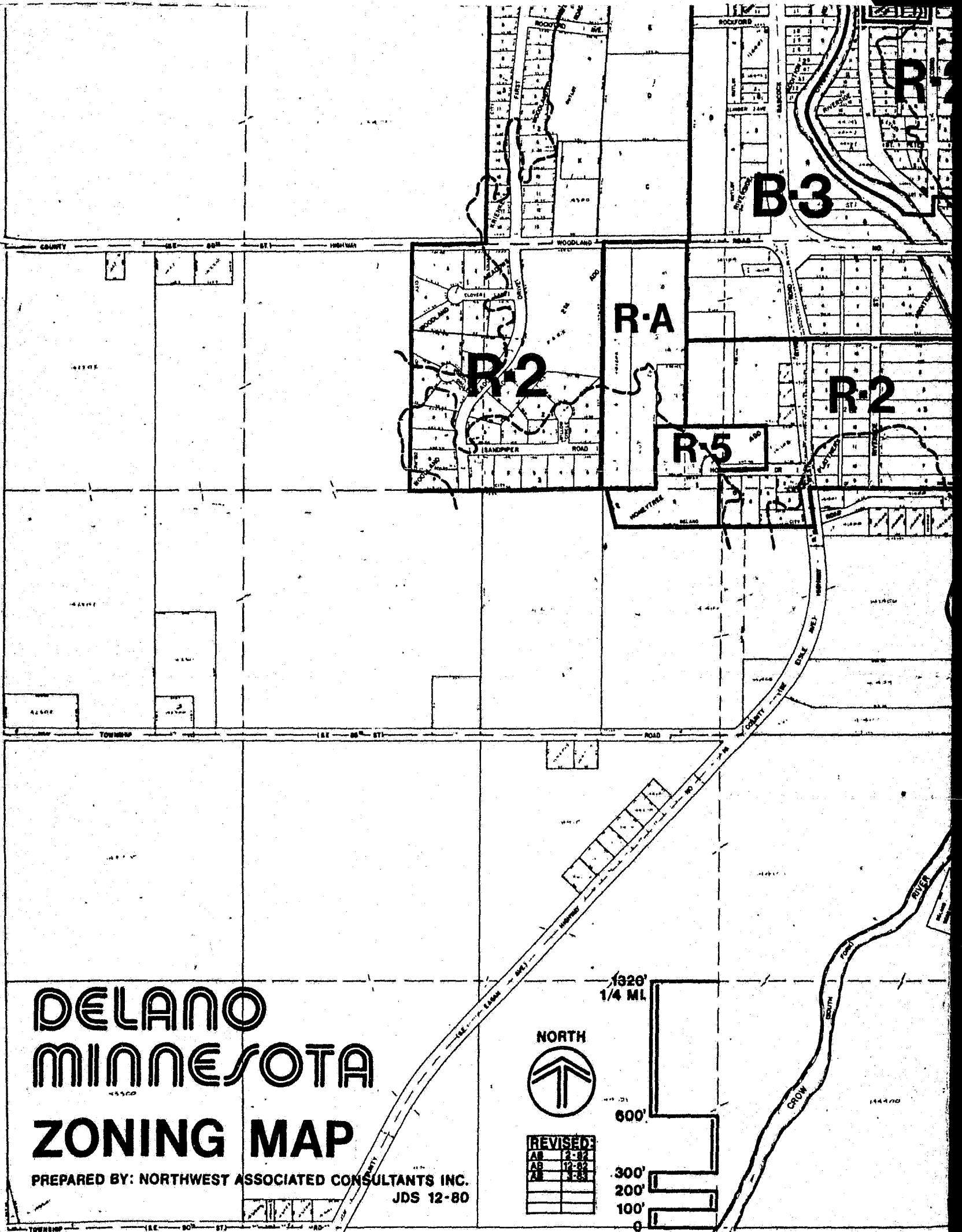

DELANO MINNESOTA ZONING MAP

PREPARED BY: NORTHWEST ASSOCIATED CONSULTANTS INC.
JDS 12-80

REVISED	
AR	2-82
AR	12-82
AR	3-83

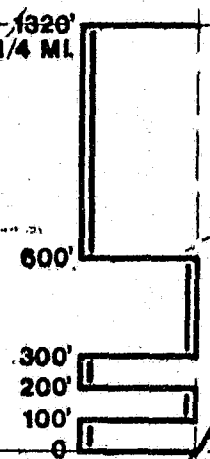

SEC. 23, T. 116, R. 25

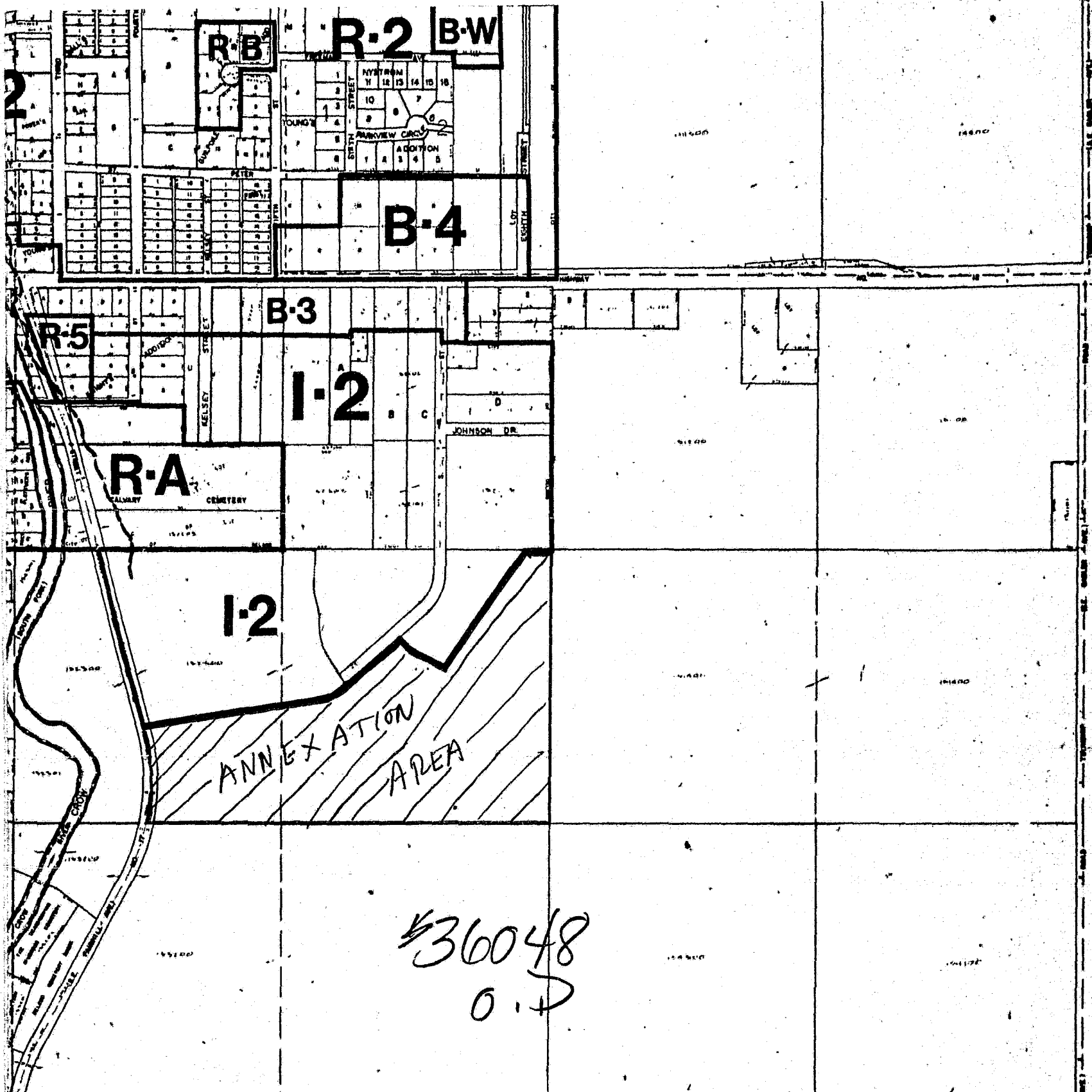

RESIDENTIAL DISTRICTS:	BUSINESS DISTRICTS:	INDUSTRIAL DISTRICTS:
R-A SINGLE FAMILY/AGRICULTURE	B-1 NEIGHBORHOOD	I-1 LIMITED
R-1 SINGLE FAMILY	B-2 LIMITED	I-2 GENERAL
R-2 SINGLE FAMILY	B-3 AUTO-ORIENTED	
R-3 SINGLE & TWO FAMILY	B-4 GENERAL	SPECIAL DISTRICTS:
R-4 MEDIUM DENSITY	B-5 CENTRAL	PUD PLANNED UNIT DEVELOPMENT
R-5 HIGH DENSITY	B-W BUSINESS/WAREHOUSE	[FP] FLOOD PLAIN
R-B RESIDENTIAL/BUSINESS		S SHORELAND
		W WETLAND SYSTEMS

NOTE: IT IS RECOMMENDED THAT IN ADDITION TO THIS ZONING MAP, CITY FILES BE CONSULTED TO VERIFY THE DISTRICT CLASSIFICATION OF PROPERTY.
 * EXACT BOUNDARY REQUIRES DETAILED CALCULATION BY THE ZONING ADMINISTRATOR.

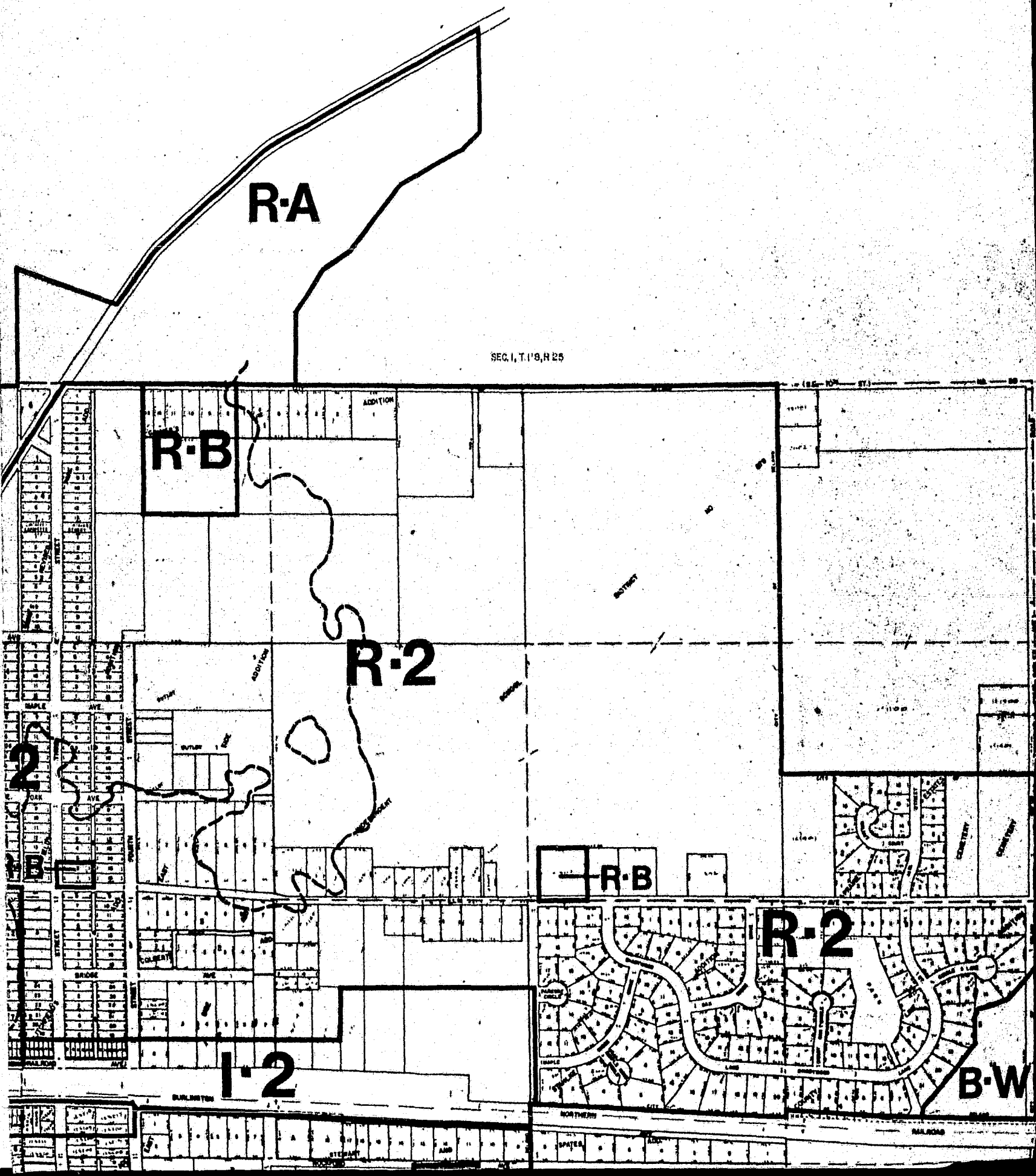

SEC. 2, T. 116, R. 25

SEC. 10, T. 116, R. 25

T. 116, R. 25

