



STATE OF MINNESOTA
MUNICIPAL BOARD

Suite 165 Metro Square
7th & Robert Streets
St. Paul, Minnesota 55101

April 19, 1985

Ms. LaVonne Sundlee
City Clerk-Treasurer
P.O. Box 676
Montevideo, Minnesota 56265

Docket Number A-4056

Ordinance Number 625

City of Montevideo

Dear Ms. Sundlee:

The Minnesota Municipal Board has now processed and approved the above ordinance in accordance with Minnesota Statutes, Chapter 414, and the Rules of Procedure.

According to law, this annexation ordinance must be filed with the Township Clerk, County Auditor, Secretary of State, and the Municipal Board. (Since the ordinance has already been filed with the Municipal Board, no additional copies are required.) We also recommend that you file the ordinance with the County Recorder.

The annexation is final upon the date the ordinance is approved by the Board, which is the date of this letter.

Sincerely,

MUNICIPAL BOARD

A handwritten signature in cursive script, appearing to read "Pat".

Patricia D. Lundy
Assistant Director

PDL:sg

cc: Chippewa County Auditor
Sparta Township Clerk
Janice M. Nelson, Attorney at Law
Secretary of State

STATE OF MINNESOTA
DEPARTMENT OF STATE
FILED
APR 25 1985
Joan Anderson Howe
Secretary of State

135996

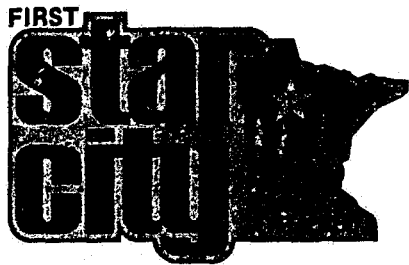

Montevideo
CITY OF
MONTEVIDEO
P.O. BOX 676
MONTEVIDEO, MINNESOTA
56265



TELEPHONE 612-269-6575

STATE OF MINNESOTA)
COUNTY OF CHIPPEWA)
CITY OF MONTEVIDEO)

I, LaVonne B. Sundlee, duly appointed, qualified and acting City Clerk in and for the City of Montevideo do hereby certify that Ordinance No. 625, annexing Land to the City of Montevideo, was filed with the Register of Deeds, County Auditor, Clerk of the Town of Sparta, the Municipal Commission and the Secretary of State on April 16, 1985.

Dated: April 16, 1985

LaVonne B. Sundlee, City Clerk

ORD. NO. 625

ORDINANCE ANNEXING LAND

THE CITY OF MONTEVIDEO DOES ORDAIN:

1. The City Council of Montevideo finds as facts:
 - 1.1. That a petition has been filed with the City of Montevideo by all the owners of the hereinafter described land requesting that the same be annexed to the City of Montevideo.
 - 1.2. That copies of said petition have been filed with the Minnesota Municipal Board, the Town Board of Sparta Township and the County Board of Chippewa County.
 - 1.3. That a waiver of objections to the annexation of the premises to the City of Montevideo executed by Sparta Township has been filed with the Minnesota Municipal Board and with the City of Montevideo.
 - 1.4. That the hereinafter described premises abut upon the city limits of the City of Montevideo and are located in Sparta Township in Chippewa County, Minnesota.
 - 1.5. That said premises are suburban in character or are about to become suburban in character, and are susceptible to municipal control by the City of Montevideo.

1.6. That the annexation of said premises to the City of Montevideo is in the best interest of the City of Montevideo and the territory to be annexed.

1.7. That said premises are less than 200 acres.

2. That pursuant to Minnesota Statute Section 414.033, Subdivision 5, that certain tract of land in the County of Chippewa and State of Minnesota described as follows:

A parcel of land in the Southwest Quarter (SW $\frac{1}{4}$), Section Eight (8), Township One Hundred Seventeen (117) North, Range Forty (40) West, Fifth Principal Meridian, described as follows: Commencing on the East line of the Southwest Quarter (SW $\frac{1}{4}$) of Section Eight (8), a distance of 500.00 feet South of the South line of Windom Avenue as now laid out and platted in Kohr's First Addition to the City of Montevideo extended easterly; thence West parallel to and 500.00 feet South of the South line of said Windom Avenue extended, a distance of 398.30 feet to the true point of beginning of the tract to be described; thence continuing West on said line a distance of 170.00 feet, more or less, to a point on the East line of Pamida Addition, according to the plat thereof on file and of record in the Office of the County Recorder, Chippewa County, Minnesota; thence North along said East line of Pamida Addition, a distance of 255.00 feet; thence East parallel to and 245.00 feet South of the South line of Windom Avenue, extended East, a distance of 170.00 feet, more or less, to a point on a line parallel to and 398.30 feet West of the East line of the Southwest Quarter (SW $\frac{1}{4}$) of Section Eight (8); thence South parallel to and 398.30 feet West of the East line of the Southwest Quarter (SW $\frac{1}{4}$), Section Eight (8), a distance of 255.00 feet to the true point of beginning of the tract described.

be and the same hereby is annexed to the City of Montevideo and incorporated into its city limits and zoned HB, Highway Business.

3. This ordinance shall take effect thirty (30) days from and after its passage and publication.

Passed and adopted this 21st day of January,
1985.

Arthur Black
President - City Council

ATTEST:
Therese D. Dismukes
City Clerk

The foregoing Ordinance is hereby approved this 23rd day
of January, 1985.

Alvin Beckler
Mayor

STATE OF MINNESOTA
DEPARTMENT OF STATE
FILED
APR 25 1985
Jean Anderson Howe
Secretary of State

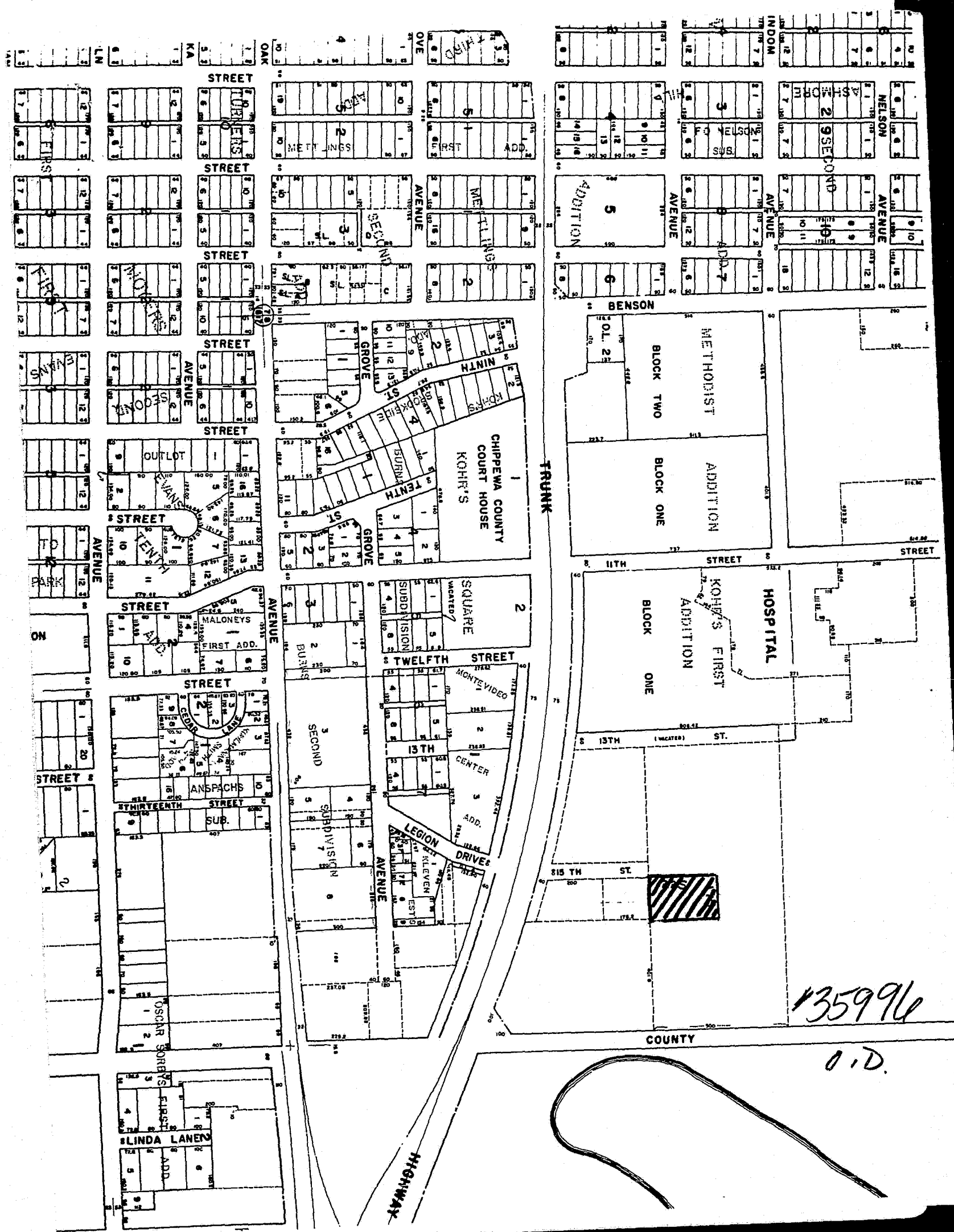

135996

O.D.

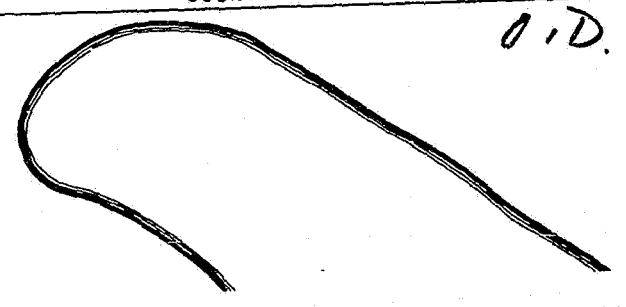

35996