



STATE OF MINNESOTA
MUNICIPAL BOARD

Suite 165 Metro Square
7th & Robert Streets
St. Paul, Minnesota 55101

October 19, 1984

Mr. Gary D. Plotz
City Administrator
37 Washington Avenue, West
Hutchinson, Minnesota 55350

Docket Number A-4114

Ordinance Number 699

City of Hutchinson

Dear Mr. Plotz:

The Minnesota Municipal Board has now processed and approved the above ordinance in accordance with Minnesota Statutes, Chapter 414, and the Rules of Procedure.

According to law, this annexation ordinance must be filed with the Township Clerk, County Auditor, Secretary of State, and the Municipal Board. (Since the ordinance has already been filed with the Municipal Board, no additional copies are required.) We also recommend that you file the ordinance with the County Recorder.

The annexation is final upon the date the ordinance is approved by the Board, which is the date of this letter.

Sincerely,

MUNICIPAL BOARD

Patricia D. Lundy
Assistant Director

PDL:sg

cc: McLeod County Auditor
Lynn Township Clerk
Marilyn Swanson, Admin. Secretary
Secretary of State

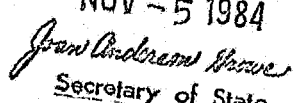
STATE OF MINNESOTA
DEPARTMENT OF STATE
FILED
NOV - 5 1984

Secretary of State

125592

Hutchinson

October 12, 1984

State of Minnesota)

County of McLeod)

City of Hutchinson)

I, the undersigned, being the duly qualified and acting
City Clerk of the City of Hutchinson, Minnesota, do hereby
certify that I have carefully compared the attached copy of

ORDINANCE NO. 699

with the original on file in the Office of the City Clerk, and
the same is a full true and complete copy thereof.

WITNESS my hand officially as such City Clerk and the
Corporate Seal of the City this 12th day of October,
1984.

Gary D. Plotz
Gary D. Plotz
City Clerk

S E A L

PUBLISHED IN THE HUTCHINSON LEADER
TUESDAY, OCTOBER 16, 1984

PUBLICATION NO. 3327

ORDINANCE NO. 699

AN ORDINANCE EXTENDING THE CORPORATE LIMITS
OF THE CITY OF HUTCHINSON TO INCLUDE CERTAIN
UNINCORPORATED TERRITORY BORDERED BY LAND WITHIN
THE CITY LIMITS AND ABUTTING THEREON.

WHEREAS, certain territory described below is not presently included within the corporate limits of any incorporated city or burrough; and

WHEREAS, sixty percent or more of the perimeter of this territory is bordered by lands already included within the corporate limits of the city and is deemed to be urban or suburban in character; and

WHEREAS, the above-described land is unplatted, does not exceed 200 acres in area, and 100% of the owners of said land have petitioned the City Council of the City of Hutchinson for annexation;

The City Council of Hutchinson does ordain:

Section 1. Territory Annexed. The corporate limits of the city of Hutchinson, Minnesota are hereby extended to include the unplatted territory described as follows, sixty percent or more of the perimeter of which territory is bordered by territory already included within the city limits: That part of the Northeast Quarter of the Southeast Quarter of Section 2, Township 116 North, Range 30 West of the 5th Principal Meridian, described as follows:

Commencing at the northeast corner of said Southeast Quarter; thence southerly, along the east line of said Southeast Quarter, a distance of 649.00 feet to the southeast corner of McDonald's Addition and the point of beginning of the land to be described; thence westerly, along the south line and along the westerly extension thereof, of McDonald Drive, as dedicated in McDonald's Addition, McDonald's Fifth Addition and in McDonald's Sixth Addition, a distance of 825.00 feet; thence southerly, parallel with said east line, a distance of 120.00 feet; thence easterly, parallel with said south line of McDonald Drive and its westerly extension, a distance of 825.00 feet to said east line; thence northerly, along said east line, a distance of 120.00 feet to the point of beginning.

Section 2. Filing. The City Clerk is directed to file certified copies of this ordinance with the Secretary of State, the County Auditor of McLeod County, the Town Clerk of the effective township and the Minnesota Municipal Board.

Section 3. Effective Date of Annexation. This ordinance takes effect upon passage and publication and the filing of certified copies as directed in Section 2 and approval by the Minnesota Municipal Board.

Adopted by the City Council this 9th day of October, 1984.

Robert H. Stearns, Mayor

ATTEST:

Gary D. Plotz, City Clerk

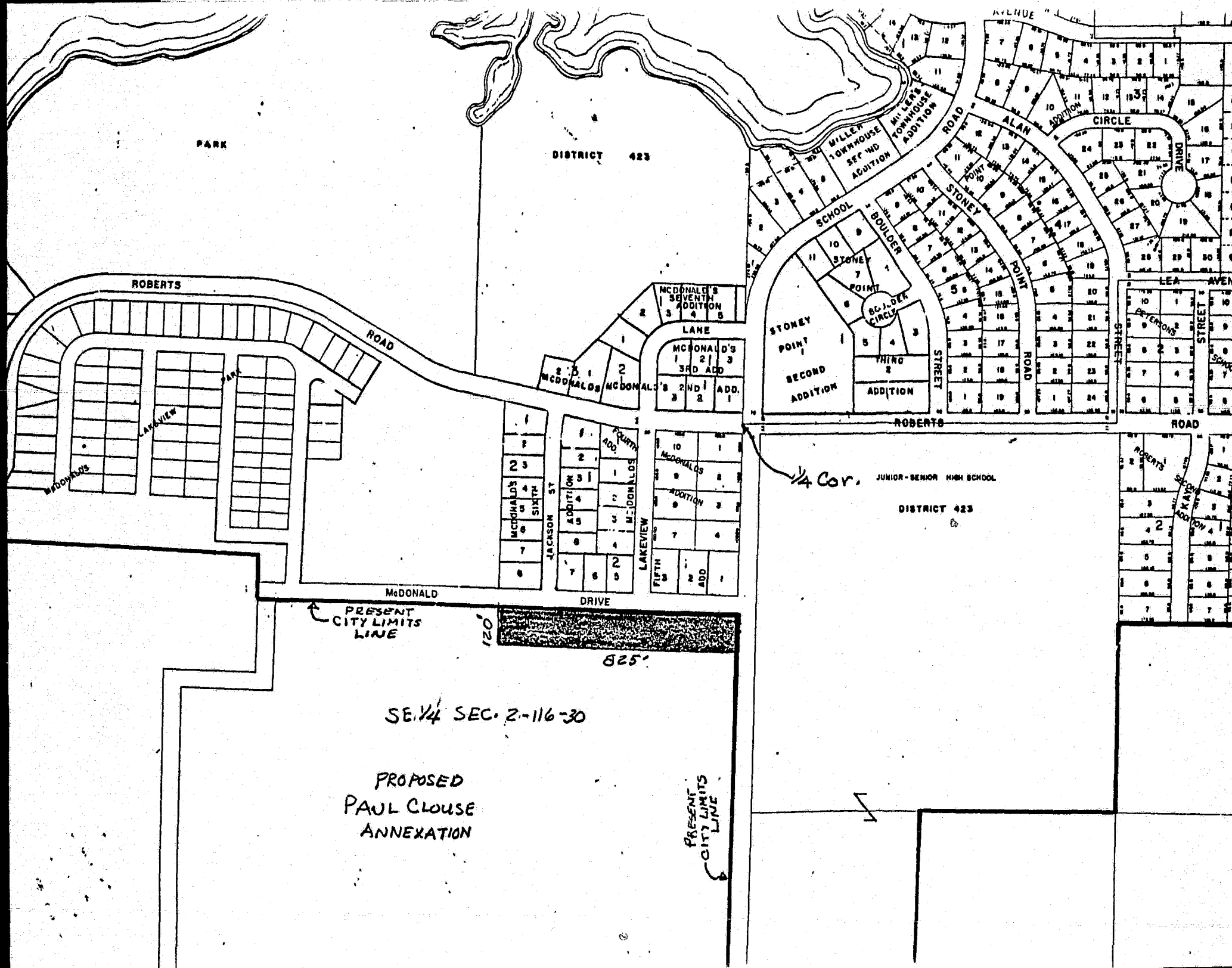



October 12, 1984

RE: MMB Docket No. A-4114
Hutchinson
Clouse Petition

Ms. Patricia D. Lundy
Assistant Director
Minnesota Municipal Board
165 Metro Square Building
St. Paul, Minnesota 55101

Dear Ms. Lundy:

The 90-day waiting period has elapsed since a notice was sent to all concerned parties regarding annexation of property into the City limits. During this time the City of Hutchinson has not received any written objections.

It was not necessary for the City to hold a public hearing since the annexation was signed by 100% of the property owner(s).

The required filing fee has already been paid to the Municipal Board. Enclosed is a copy of the adopted Ordinance No. 699 and a map of the area annexed.

I believe this fulfills all the requirements for annexation of the property.

Sincerely,

CITY OF HUTCHINSON

Marilyn Swanson
Administrative Secretary

Encl.

cc: McLeod County Commissioners
Lynn Township Board
Edwin Homan, Jr., Zng. Admin.
Secretary of State
McLeod County Auditor
Paul Clouse

#35592
O.D.