

An Equal Opportunity Employer

Phone: (612) 296-2428



**STATE OF MINNESOTA  
MUNICIPAL BOARD**

Suite 165 Metro Square  
7th & Robert Streets  
St. Paul, Minnesota 55101

September 20, 1983

Ms. Dorothy Schnell, Clerk  
City of Stillwater  
216 North Fourth St.  
Stillwater, MN 55082

Re: OA-117 Stillwater, City and Town  
A-4040 Stillwater Annexation [Ordinance Number 610]

Dear Ms. Schnell:

The Municipal Board, at its meeting on September 20, 1983, approved the Joint Resolution Amending Joint Resolution as to Orderly Annexation: The Town of Stillwater and City of Stillwater dated August 25, 1983.

Pursuant to said amendment, the Minnesota Municipal Board has now processed and approved Ordinance Number 610 of the City of Stillwater (MMB Docket A-4040) in accordance with Minnesota Statutes, Chapter 414, and the Rules of Procedure.

According to law, this annexation ordinance must be filed with the Township Clerk, County Auditor, Secretary of State and the Municipal Board. (Since the ordinance has already been filed with the Municipal Board, no additional copies are required.) We also recommend that you file the ordinance with the County Recorder.

The annexation is final upon the date the ordinance is approved by the Board, which is the date of this letter.

Sincerely,

MUNICIPAL BOARD

A handwritten signature in cursive script that reads "Patricia D. Lundy".

Patricia D. Lundy  
Assistant Director

kj

cc: Secretary of State  
Washington County Auditor  
Stillwater Town Clerk  
Stillwater Town Attorney  
Stillwater City Attorney

34803  
STATE OF MINNESOTA  
DEPARTMENT OF STATE  
FILED

SEP 29 1983

John Anderson Howe  
Secretary of State

ORDINANCE NO. 610

AN ORDINANCE EXTENDING THE CORPORATE LIMITS OF THE CITY OF STILLWATER INTO CERTAIN UNINCORPORATED TERRITORY COMPLETELY SURROUNDED BY LAND WITHIN THE CITY LIMITS AND ABUTTING THEREON.

WHEREAS, certain territory described below is not presently included within the corporate limits of any incorporated city, or borough; and

WHEREAS, this territory is completely surrounded by lands already included within the corporate limits of the city and is deemed to be urban or suburban in character;

NOW THEREFORE, the City Council of the City of Stillwater ordains:

Section 1. Territory Annexed. The corporate limits of the City of Stillwater, Minnesota, are hereby extended to include the unplatted territory described as follows, (which territory now is and has heretofore been completely surrounded by territory already included within the city limits):

The South 10 feet of the North 270 feet of that part of the Northwest Quarter of the Southwest Quarter, Section 33, Township 30, Range 20 West, described as follows:

Beginning at the Southwest corner of said tract and thence running North along the West line of said tract 822 feet to a point; running thence East at right angles 489 feet more or less to the centerline of the traveled road known as Greeley Street, running Northerly and Southerly across said tract; running thence South along the centerline of said traveled road to the South line of said quarter-quarter and running thence West along the South line of said tract to the place of beginning.

Section 2. Filing. The City Clerk is directed to file certified copies of this ordinance with the Secretary of State, the County Auditor of Washington County, Minnesota, the Town Clerk of the Township of Stillwater, and the Minnesota Municipal Board.

Section 3. Effective Date of Annexation. This ordinance takes effect upon passage and publication and the filing of certified copies as directed in Section 2 and approval by the Minnesota Municipal Board  
Adopted by the City Council of Stillwater, Minnesota, this 21st day of June, 1983.

Harry D. Peterson  
Mayor

Attest:

Dorothy R. Schnell  
City Clerk

Published in Stillwater Gazette  
on June 27, 1983.

\*\*\*\*\*

I, Dorothy R. Schnell, City Clerk of the City of Stillwater, Minnesota do hereby certify that the foregoing is a true and correct copy of an ordinance adopted by the Stillwater City Council on June 21, 1983.

Dorothy R. Schnell  
City Clerk

23 24

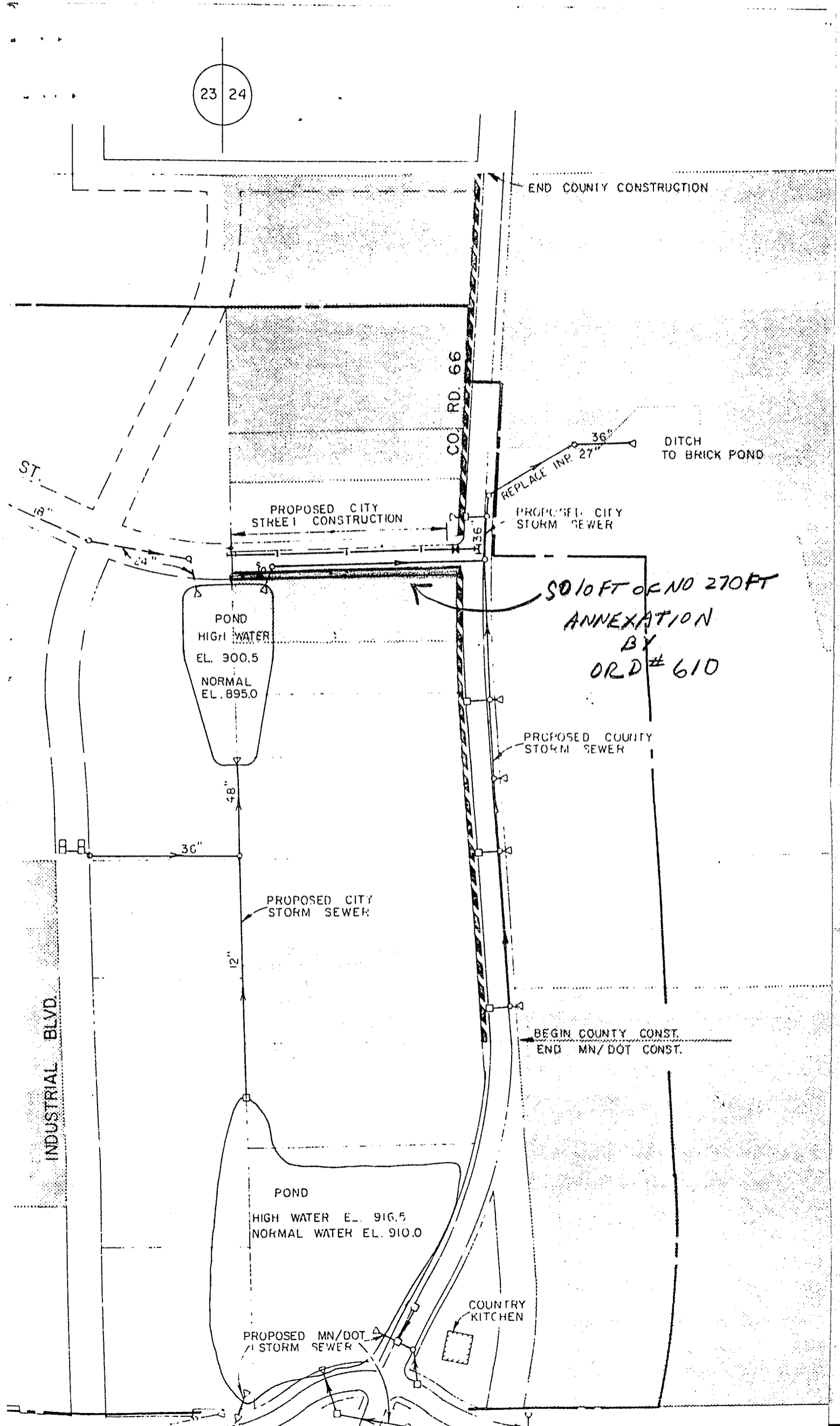

SO 10 FT OF NO 270 FT  
ANNEXATION  
BY  
ORD # 610

INDUSTRIAL BLVD.

CO. RD. 66

ST.

END COUNTY CONSTRUCTION

DITCH TO BRICK POND

PROPOSED CITY STREET CONSTRUCTION

REPLACE INP. 27" 36"

PROPOSED CITY STORM SEWER

POND  
HIGH WATER  
EL. 900.5  
NORMAL  
EL. 895.0

PROPOSED COUNTY STORM SEWER

PROPOSED CITY STORM SEWER

BEGIN COUNTY CONST.  
END MN/DOT CONST.

POND  
HIGH WATER EL. 916.5  
NORMAL WATER EL. 910.0

COUNTRY KITCHEN

PROPOSED MN/DOT STORM SEWER