

An Equal Opportunity Employer

Phone: 296-2428



STATE OF MINNESOTA  
MUNICIPAL BOARD

Suite 165 Metro Square  
7th & Robert Streets  
St. Paul, Minnesota 55101

March 18, 1983

Mr. Marv Schmidt  
Delano City Clerk  
P.O. Box 108  
Delano, Minnesota 55328

Re: Docket Number A-3992

Ordinance Number Dated 3-3-81

City of Delano

Dear City Clerk:

The Minnesota Municipal Board has now processed and approved the above ordinance in accordance with Minnesota Statutes, Chapter 414, and the Rules of Procedure.

According to law, this annexation ordinance must be filed with the Township Clerk, County Auditor, Secretary of State and the Municipal Board. (Since the ordinance has already been filed with the Municipal Board, no additional copies are required.) We also recommend that you file the ordinance with the County Recorder.

The annexation is final upon the date the ordinance is approved by the Board, which is the date of this letter.

Sincerely,

MUNICIPAL BOARD

*Patricia D. Lundy*  
Patricia D. Lundy  
Assistant Executive Director

PDL:mem

cc:  Secretary of State  
County Auditor  
Township Clerk  
Attorney  
Municipality

(REVISED 1/81)

STATE OF MINNESOTA  
DEPARTMENT OF STATE  
FILED  
MAR 24 1983

*Andrews*  
Secretary

32486

Delano

AN ORDINANCE PROVIDING FOR ANNEXATION OF CERTAIN LAND  
ABUTTING THE CITY AND OWNED BY THE CITY

The City Council of Delano, Minnesota ordains:

Section 1. That the City of Delano is the owner of certain land abutting  
the City of Delano, legally described as follows:

That part of the Southwest Quarter (SW $\frac{1}{4}$ ) of Section One (1), Township 118, Range 25, being Westerly of the following described line: Beginning at the Southeast corner of said Southwest Quarter (SW $\frac{1}{4}$ ); thence on an assumed bearing of West along the South line of said Southwest Quarter (SW $\frac{1}{4}$ ) 1190 feet to the point of beginning of the line to be described; thence North two degrees East (N2°E), 390 feet; thence North 34 degrees East (N34°E), 235 feet; thence North 56 degrees East (N56°E), 180 feet; thence North 39 degrees 30 minutes East (39°30'E) 430 feet; thence North 60 degrees East (N60°E) 360 feet; thence North 43 degrees East (N43°E) 115 feet; thence Northerly and parallel with the East line of said Southwest Quarter (SW $\frac{1}{4}$ ) to the center line of Wright County State Aid Road No. 17 and there terminating.

Section 2. That the tract hereinbefore described is, by this ordinance,  
declared to be annexed to the City of Delano, Minnesota; and

Section 3. That this ordinance shall take effect upon its passage and  
publication, and upon the filing of a copy of this ordinance with the Minnesota  
Municipal Board, Franklin Township, Wright County Auditor, and the Secretary of  
State for the State of Minnesota.

Adopted this 3rd day of March, 1981.

  
Gordon H. Wetter, Mayor

Attest:

  
Marv Schmidt, Clerk

(Published in the Delano Eagle  
on March 12, 1981)

ANNEXATION  
AREA

COUNTY ROAD NO. 30

BURLINGTON NORTH-RV RAILROAD

TRUNK HIGHWAY 12

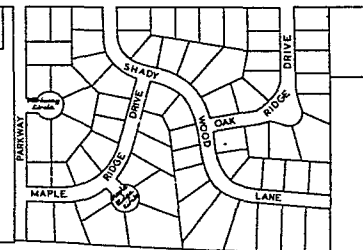
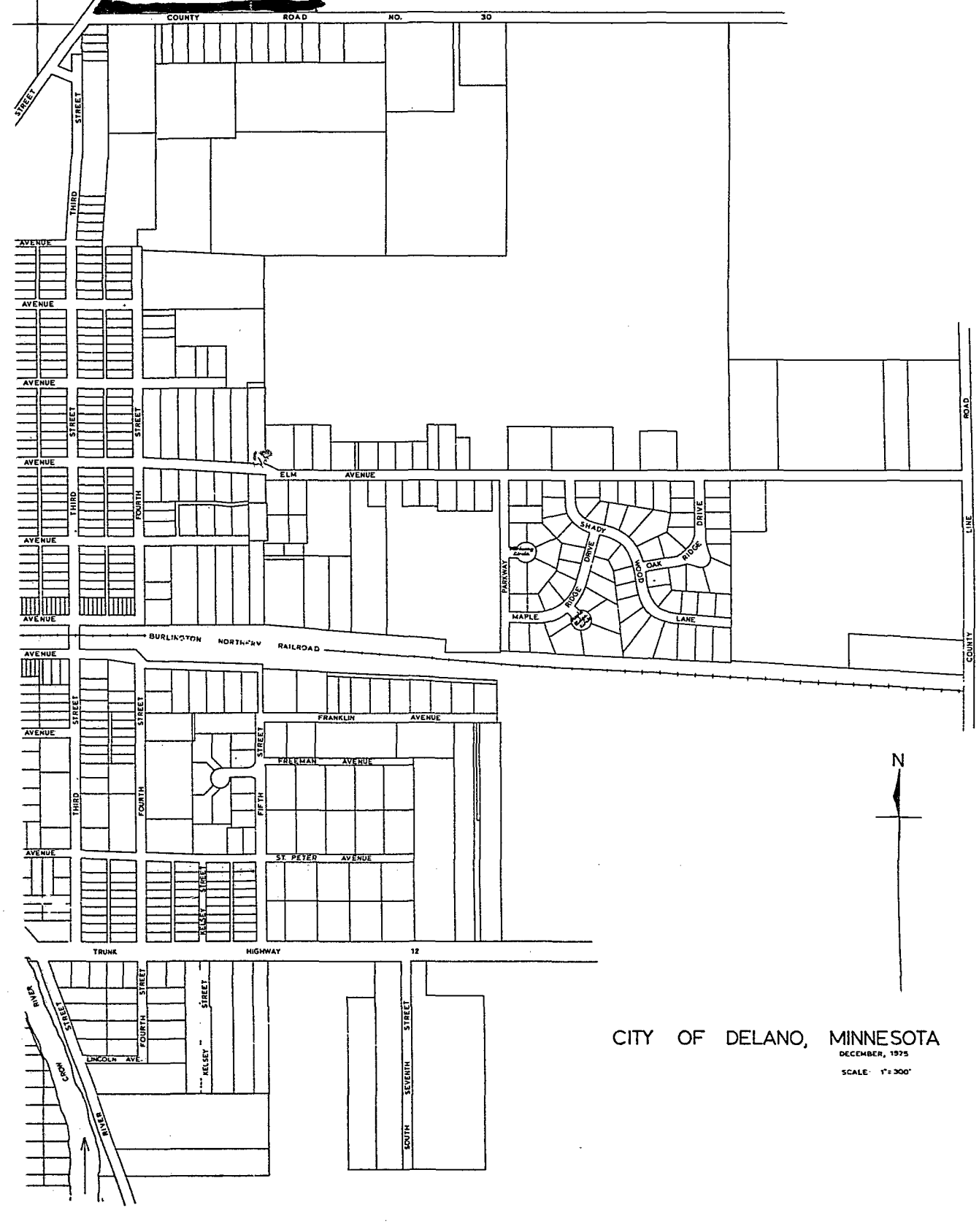
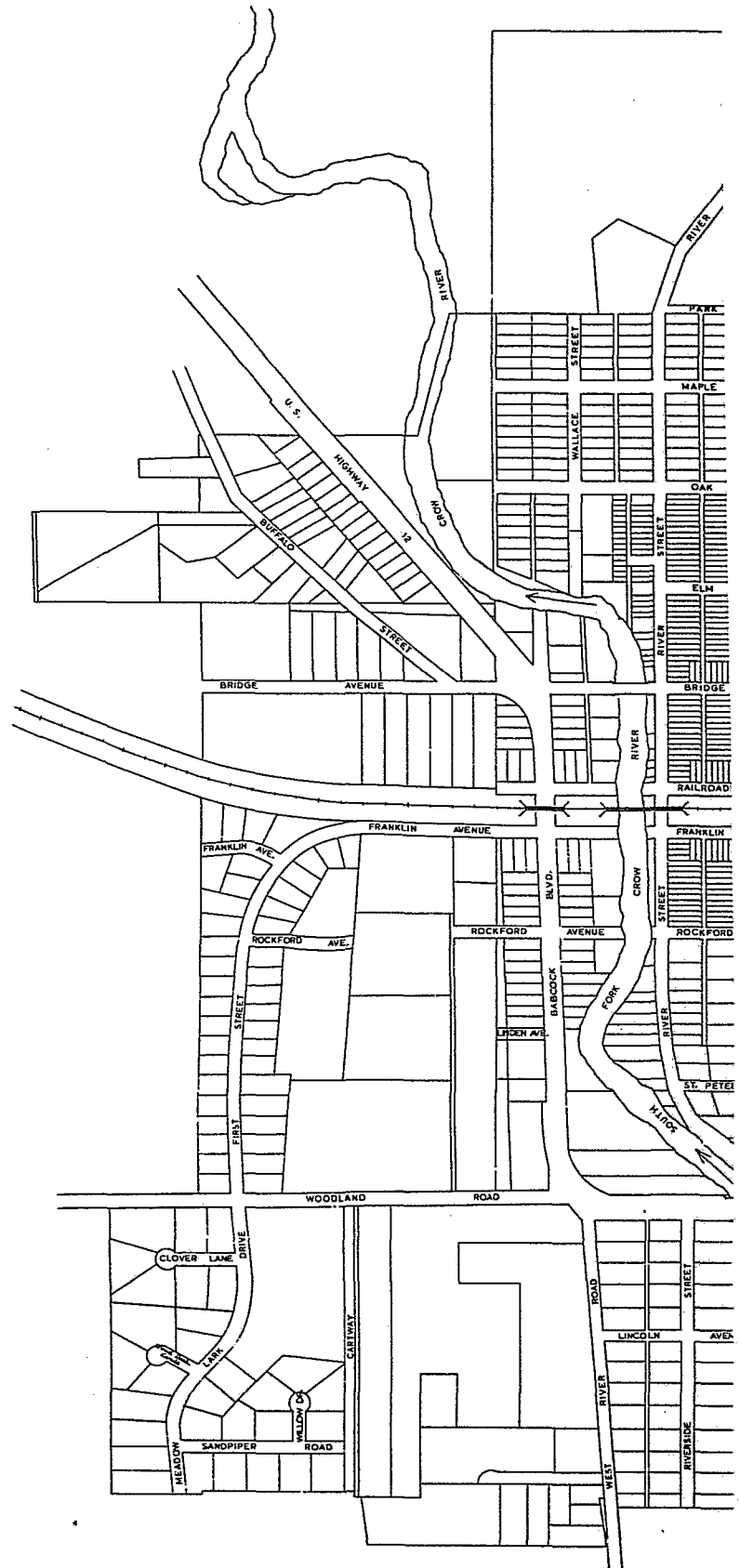

CITY OF DELANO, MINNESOTA  
 DECEMBER, 1975  
 SCALE: 1" = 300'

PHILIP R. PERKINS  
RICHARD GRINLEY

DELANO OFFICE  
(612) 972-2926  
(612) 479-2531

**PERKINS AND GRINLEY**

ATTORNEYS AT LAW  
BOX F  
DELANO, MINN. 55328

MAPLE LAKE OFFICE  
(612) 963-3135

MAPLE PLAIN OFFICE  
(612) 479-1124

MONTROSE OFFICE  
(612) 675-3175

March 3, 1983

Joan Anderson Growe  
Secretary of State  
180 State Office Bldg.  
St. Paul, MN 55155

**ATTN:** Donna Scott

Dear Ms. Growe:

Enclosed and filed with you as Secretary of State is a copy of the Ordinance of Annexation that was adopted by the city on March 3, 1981.

I am also enclosing a copy of an old city map tht shows the approximate location of the annexation site in relation to the present northern city limits.

Yours truly,



Richard Grinley

RG:jp  
enclosure