

An Equal Opportunity Employer

Phone: 296-2428



STATE OF MINNESOTA
MUNICIPAL BOARD

Suite 165 Metro Square
7th & Robert Streets
St. Paul, Minnesota 55101

August 5, 1981

Ms. Betty Anderson
City Clerk
126 Marshall Avenue No.
Litchfield, Minnesota 55355

Re: Docket Number A-3837

Ordinance Number 443

City of Litchfield

Dear City Clerk:

The Minnesota Municipal Board has now processed and approved the above ordinance and filing fee in accordance with Minnesota Statutes, Chapter 414, and the Rules of Procedure.

According to law, this annexation ordinance must be filed with the Township Clerk, County Auditor, Secretary of State and the Municipal Board. (Since the ordinance has already been filed with the Municipal Board, no additional copies are required.) We also recommend that you file the ordinance with the County Recorder.

The annexation is final upon the date the ordinance is approved by the Board, which is the date of this letter.

Sincerely,

MUNICIPAL BOARD

A handwritten signature in cursive script that reads "Patricia D. Lundy".

Patricia D. Lundy
Assistant Executive Director

PDL:men

cc: Secretary of State
County Auditor
Township Clerk
Attorney
Municipality

(REVISED 1/81)

STATE OF MINNESOTA
DEPARTMENT OF STATE
FILED
AUG 13 1981
John Anderson
Secretary of State

33542

Legy of State

Litchfield

ORDINANCE NO. 443

AN ORDINANCE extending the corporate limits of the City of Litchfield, Minnesota, to include certain unincorporated unplatted land not exceeding 200 acres in area abutting upon the City limits.

WHEREAS, the City of Litchfield is the fee owner of the following described realty which abuts and adjoins the City of Litchfield on part of its East boundary lines; and

WHEREAS, by authority of M.S.A. 414.033 the said City of Litchfield is empowered to annex said land by ordinance;

NOW THEREFORE, the Council of the City of Litchfield, Minnesota, ordains:

SECTION I.

The City Council hereby determines (1) that the annexation will be to the best interests of the City and to the land affected; (2) that the land described herein is owned entirely in fee by the City of Litchfield and is urban or suburban in character; and (3) that none of said land is now included within the limits of any city, village, or borough.

SECTION II. Land Annexed.

The corporate limits of the City are hereby extended to include the unplatted land described as follows and the same is hereby annexed to and included within the City as effectively as if it had originally been a part thereof: Land in Meeker County, Minnesota, to-wit:

A part of the Southwest Quarter (SW 1/4) of Section One (1), Township One Hundred Nineteen North (119-N), Range Thirty-one West (31-W) described as follows, to-wit: Commence at the Southwest corner of said Section One (1), thence North on the West line thereof a distance of 1118.00 feet, thence East parallel to the South line of said Section One (1) a distance of 823.4 feet to the point of beginning; thence North 481.8 feet, thence East at right angles a distance of 134.5 feet, thence South a distance of 481.8 feet, thence West 134.5 feet to the point of beginning containing 1.5 acres more or less.

SECTION III. Filing.

The City Clerk is hereby directed to file certified copies of this Ordinance with the Minnesota Municipal Commission, Litchfield Town Board, the Secretary of State and the Meeker County Auditor.

SECTION IV. Effective Date.

This Ordinance takes effect upon its passage and publication and filing of certified copies as directed in Section III.

Adopted by the Council on this 6th day of July, 1981.

Vida Hendrickson
Vida Hendrickson - Mayor

Attest:

Betty Anderson
Betty Anderson
City Clerk

CERTIFICATION

This is to certify that the foregoing is a true and exact copy of the Resolution as it appears in the minutes of the meeting of the City Council of the City of Litchfield held on July 6, 1981.

(Seal)

Betty Anderson
Betty Anderson, Clerk-Treasurer
City of Litchfield

STATE OF MINNESOTA
DEPARTMENT OF STATE
FILED
AUG 13 1981
Joan Anderson
Secretary of State

133542

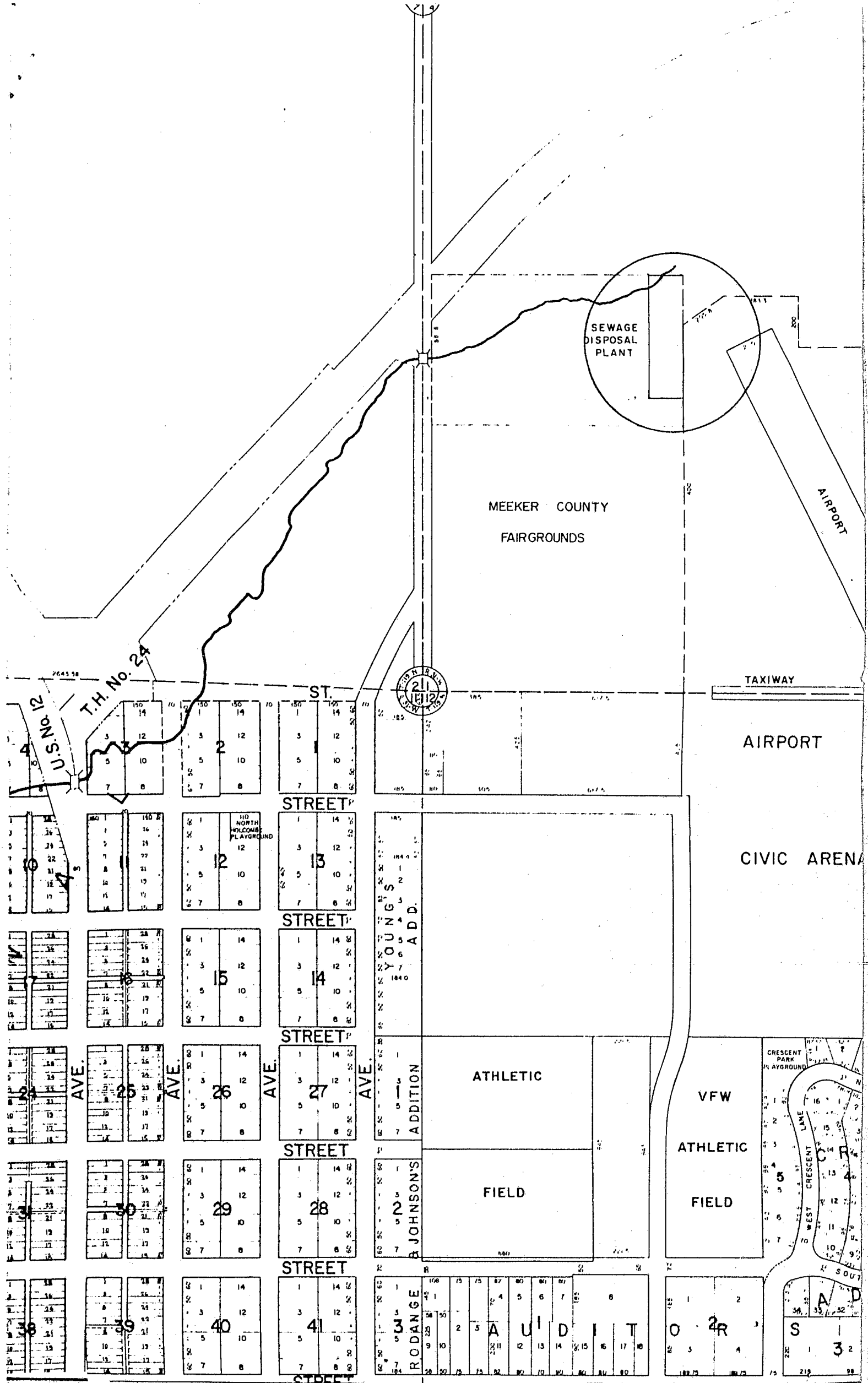

SEWAGE DISPOSAL PLANT

MEEKER COUNTY FAIRGROUNDS

AIRPORT

TAXIWAY

AIRPORT

CIVIC ARENA

ATHLETIC

VFW

ATHLETIC

FIELD

CRESCENT PARK PLAYGROUND

LANE

WEST CRESCENT

CRESCENT

AVENUE

AVENUE

AVENUE

AVENUE

AVENUE



RODANGE AUDIT

JOHNSON'S ADDITION

RODANGE

AVENUE

U.S. No. 12

T.H. No. 24

AVE.

AVE.

AVE.

AVE.

2643 58

12

13

14

15

16

17

18

19

20

21

22

23

24

25

26

27

28

29

30

31

32

33

34

35

36

37

38

39

40

41

42

43

44

45

46

47

48

49

50

51

52

53

54

55

56

57

58

59

60

61

62

63

64

65

66

67

68

69

70

71

72

73

74

75

76

77

78

79

80

81

82

83

84

85

86

87

88

89

90

91

92

93

94

95

96

97

98

99

100

101

102

103

104

105

106

107

108

109

110

111

112

113

114

115

116

117

118

119

120

121

122

123

124

125

126

127

128

129

130

131

132

133

134

135

136

137

138

139

140

141

142

143

144

145

146

147

148

149

150

151

152

153

154

155

156

157

158

159

160

161

162

163

164

165

166

167

168

169

170

171

172

173

174

175

176

177

178

179

180

181

182

183

184

185

186

187

188

189

190

191

192

193

194

195

196

197

198

199

200

201

202

203

204

205

206

207

208

209

210

211

212

213

214

215

216

217

218

219

220

221

222

223

224

225

226

227

228

229

230

231

232

233

234

235

236

237

238

239

240

241

242

243

244

245

246

247

248

249

250

251

252

253

254

255

256

257

258

259

260

261

262

263

264

265

266

267

268

269

270

271

272

273

274

275

276

277

278

279

280

281

282

283

284

285

286

287

288

289

290

291

292

293

294

295