

An Equal Opportunity Employer

Phone: 296-2428



STATE OF MINNESOTA
MUNICIPAL BOARD

Suite 165 Metro Square
7th & Robert Streets
St. Paul, Minnesota 55101

OCT 17 1980

Mr. Thomas A. Eidem
City Administrator
201 So. Third Street
Waterville, Minnesota 56096

Re: Docket Number A-3752

Ordinance Number 155

City of Waterville

Dear City Clerk:

The Minnesota Municipal Board has now processed and approved the above ordinance and filing fee in accordance with Minnesota Statutes, Chapter 414, and the Rules of Procedure.

According to law, this annexation ordinance must be filed with the Township Clerk, County Auditor, Secretary of State and the Municipal Board. (Since the ordinance has already been filed with the Municipal Board, no additional copies are required.)

The annexation is final upon the date the ordinance is approved by the Board, which is the date of this letter.

Sincerely,

MUNICIPAL BOARD

Patricia D. Lundy
Patricia D. Lundy
Assistant Executive Director

PDL:kj

cc: Secretary of State
County Auditor
Township
Attorney
Municipality

(REVISED 7/78)

STATE OF MINNESOTA
DEPARTMENT OF STATE
FILED
OCT 21 1980
Joan Anderson Hume
Secretary of State
#33076
O.D.

Waterville

ORDINANCE NO. 155

Proposed Ordinance #2/80

BEING AN ORDINANCE RELATING TO THE ANNEXATION OF THE CITY OF
WATERVILLE OF CERTAIN LANDS SITUATED IN RURAL WATERVILLE TOWNSHIP,
LE SUEUR COUNTY, MINNESOTA.

The City of Waterville does ordain:

Section 1. That pursuant to the provisions of M.S.A. 414.033,
Subd. 5 and upon a finding by the Common Council that such property
is about to become urban in character the following described lands
are hereby annexed by the City of Waterville and shall henceforth be
included within and be a part of the corporate limits of the City of
Waterville, Minnesota, to-wit:

That part of the Southwest Quarter of the Southeast Quarter
(SW 1/4 of SE 1/4), Section Twenty-six (26), Township One Hun-
dred Nine (109), Range Twenty-three (23), Le Sueur County,
Minnesota, described as follows:

Beginning at the Northwest Corner of said Southwest Quarter
of the Southeast Quarter (SW 1/4 of SE 1/4); thence on an assumed
bearing of South along the west line of said Southwest Quarter of
the Southeast Quarter (SW 1/4 of SE 1/4), a distance of 548.00
feet to the centerline of Trunk Highway No. 60; thence North 78
degrees, 30 minutes East along said centerline, a distance of
409.57 feet; thence North 70 degrees 01 minutes East along said
centerline, a distance of 344.94 feet; thence on a bearing of North
0 degrees 55 minutes East, a distance of 336.80 feet to north line
of said Southwest Quarter of the Southeast Quarter (SW 1/4 of SE 1/4);
thence North 89 degrees 05 minutes West along said North line of the
Southwest Quarter of the Southeast Quarter (SW 1/4 of SE 1/4), a
distance of 731.00 feet to the point of beginning. This tract
contains 7.63 acres of land, more or less, and is subject to any
and all easements of record.

The parties of the first part reserve unto themselves for as
long as either of them shall live an access easement for roadway
purposes over the easterly two rods of the property herein conveyed.

Section 2. All Ordinances and portions of Ordinances inconsistent
herewith are hereby repealed to the extent of such inconsistency.

Section 3. This Ordinance shall be in full force and shall take
effect from and after its passage, publication and after filing copies

hereof with the Minnesota Municipal Board, the Le Sueur County Auditor, Secretary of State of the State of Minnesota, the Town Board for Waterville Township and final approval by the Minnesota Municipal Board and after compliance with any and all other provisions of applicable law.

Passed and approved by the Common Council in and for the City of Waterville, Minnesota, this 16th day of September, 1980.

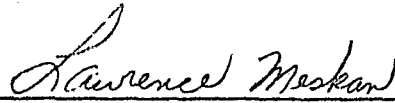

Lawrence Meskan, Mayor

ATTEST:



Thoams A. Eidem, City Administrator

CERTIFICATION

STATE OF MINNESOTA
COUNTY OF LE SUEUR^{SS}

I, Thomas A. Eidem, City Administrator of the City of Waterville, Le Sueur County, Minnesota, do hereby certify that I have compared the attached and foregoing document, with the original thereof, now remaining of record in my office, and that the same is a true and correct copy of said original Ordinance #155, and the whole thereof.

Witness my hand and seal of said City of Waterville, Minnesota, this 18th day of September, 1980.



Thomas A. Eidem
City Administrator

SEAL

A WAIVER TO A 90 DAY OBJECTION PERIOD

To Whom It May Concern:

The Township of Waterville, Minnesota desires to aid in the orderly annexation of the prosective property of First Baptist Church, Waterville, Minnesota to that city. To facilitate a speedy annexation and finding no reason to object, we hereby waive the 90 day objection period as of this date, April 9, 1980.

Signed,

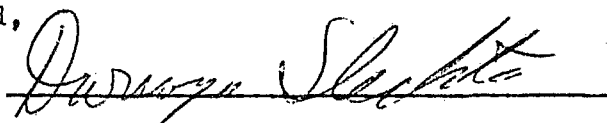
Darwyn Slechta, Chairman

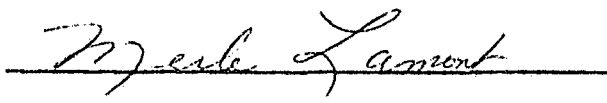
Merle Lamont, Clerk

STATE OF MINNESOTA
DEPARTMENT OF STATE
FILED
OCT 21 1980

Secretary of State

33076
O.D.

T. 109 N.-R. 23 W.

11

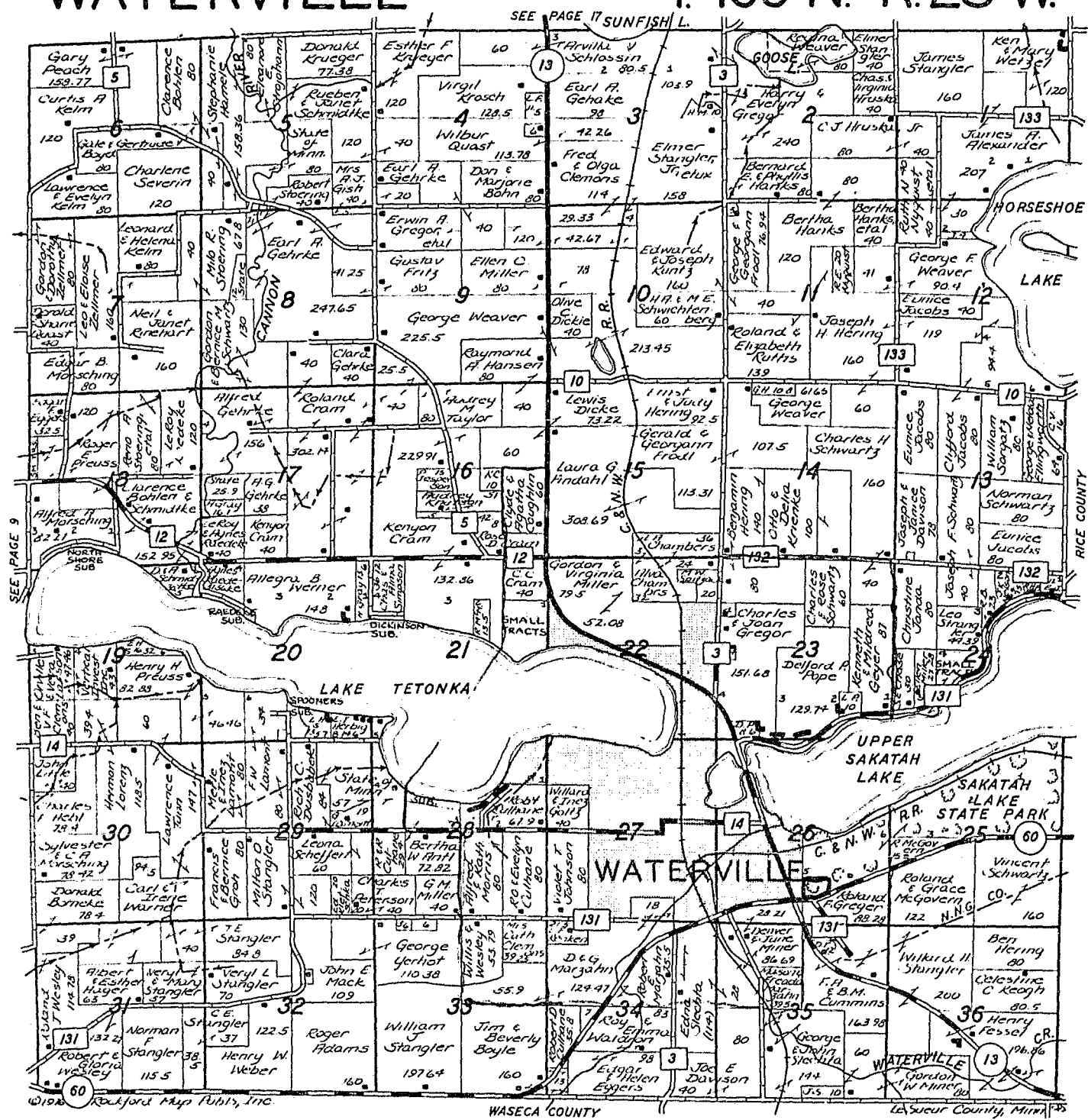

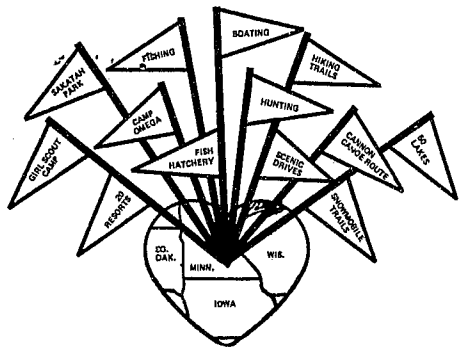

CITY OF WATERVILLE

201 SOUTH THIRD STREET • WATERVILLE, MINNESOTA 56096

18 September, 1980

Secretary of State
State of Minnesota
State Office Building
St. Paul, Mn 55101

Dear Secretary of State:

Enclosed are copies of the materials for annexation of the parcel described in the annexing ordinance. This parcel will be zoned R-2 under the City of Waterville Zoning Ordinance. The ordinance will be published in the September 24, 1980, Lake Region Life.

These materials have been mailed to the following agencies on this same day:

- a) Secretary of State, State of Minnesota
- b) LeSueur County Auditor
- c) Minnesota Municipal Commission
- d) Waterville Township Board

If additional information is required please contact me at the above address or call (507) 362-8300.

Very truly yours,

Thomas A. Eidem
City Administrator

TAE:rmg

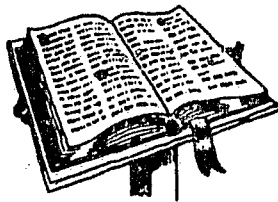

Independent
Fundamental
Premillennial
Soul-Winning
Ministry

First Baptist Church

117 East Paquin Street
Waterville, Minnesota 56096

Randy A. Sanders, Pastor

Phone 362-4314

"Repent ye, therefore and be converted, that your sins may be blotted out." Acts 3:19

PETITION FOR ANNEXATION

To the City Council of Waterville,
Honorable Sirs:

The First Baptist Church of Waterville, Minnesota desires to purchase the land fitting this legal description: The west 7 acres of the south west quarter of the south east quarter of Section 26, Township 109 north, Range 23 west, lying north of the center line of Minnesota Trunk Highway # 60, Le Sueur County, Minnesota. A purchase agreement on the said property is contingent upon proper zoning.

We, the corporate owners of First Baptist Church petition the City Council of Waterville to annex by ordinance the above said property on the closing day of the purchase agreement.

Also, we petition the City Council to annex this property as proper zoning for a church building, a church Christian school and/or a parsonage.

Also, in our petition, be it understood that this property will be maintained and used for church related activities and declared tax-exempt according to the principle of a free church in a free state as upheld by the Constitution of the United States of America.

Passed this day, April 16, 1980 by the voting body of the First Baptist Church, Waterville, Minnesota.

Signed:

Randy A. Sanders
Randy A. Sanders, Pastor

Bruce Smith
Bruce Smith, Chairman of Deacons/Trustees

Florence Peach
Florence Peach, Church Clerk

