



Ms. Joan Growe
 Secretary of State
 State of Minnesota
 St. Paul, Minnesota 55155

2-24-77

FROM Pipestone

Still pending

Harold E. Lee, City Clerk
City of Pipestone
 MUNICIPAL BUILDING
 PIPESTONE, MINNESOTA 56164

DATE 11/12/75 SUBJECT Annexation Ord # 1.42
 Cynthia Brady residence

FOLD HERE TO OPEN ENVELOPE

I am herewith submitting a certified copy of Ordinance # 1.42 AN ORDINANCE ANNEXING CONTIGUOUS TERRITORY TO THE CITY OF PIPESTONE. This is pursuant to M.S. 414.033, Subd. 4 which states "if the land is completely surrounded by land within the municipal limits, the municipal council may by ordinance declare the land annexed to the municipality, and any such land is deemed to be urban in character".

I am enclosing a map showing the location of this 75' x 150' land parcel on 4th St. N.W. This Ordinance was published in our official newspaper on 10 November 1975. As I understand it, this annexation is final upon the filing of a copy of the ordinance with the Sweet Township Clerk, the Pipestone County Auditor, the Secretary of State, in addition to the Minnesota Municipal Commission. These filings are being mailed by this office today.

SIGNED

Very truly yours
Harold E. Lee
 Harold E. Lee, City Clerk

DATE OF REPLY _____

32580

SIGNED _____

CITY OF PIPESTONE, MINNESOTA

ORDINANCE #1.42

AN ORDINANCE ANNEXING CONTIGUOUS TERRITORY TO THE CITY OF PIPESTONE

THE COUNCIL OF THE CITY OF PIPESTONE, DO ORDAIN AS FOLLOWS:

Section 1. A tract of land described by metes and bounds as follows, to-wit:

Beginning on the north line extension of the center line of Fourth Avenue Northwest and eighty (80) feet north of the north line of Blocks Six (6) and Seven (7), Original Plat to the City of Pipestone; thence north one hundred fifty (150) feet; thence west seventy five (75) feet; thence north one hundred fifty (150) feet; thence east seventy five (75) feet to the point of beginning, all in Section Twelve (12), Township One Hundred Six (106) North, Range Forty Six (46) West of the 5th P.M.,

is hereby declared to be a part of the City of Pipestone, Minnesota.

Section 2. This ordinance shall take effect and be in full force from and after its passage and publication.

Original Ordinance passed 6 November, 1975.

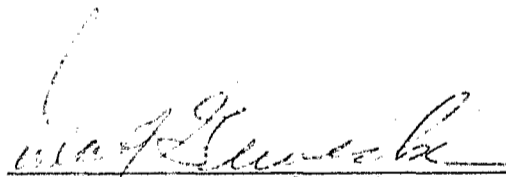
Dean Gewecke, Mayor

ATTEST:



Harold E. Lee, City Clerk

Published in Pipestone County Star on November 10, 1975

C e r t i f i c a t i o n

I, Harold E Lee, the City Clerk of the City of Pipestone, Pipestone County, Minnesota, and Custodian of its records, do hereby certify that the foregoing is a true & exact photocopy of Ordinance # 1.42-the original is on file in my office.

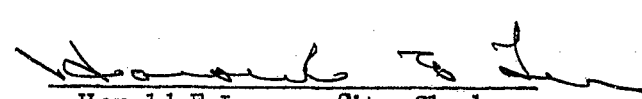
November 12, 1975

Harold E Lee, City Clerk

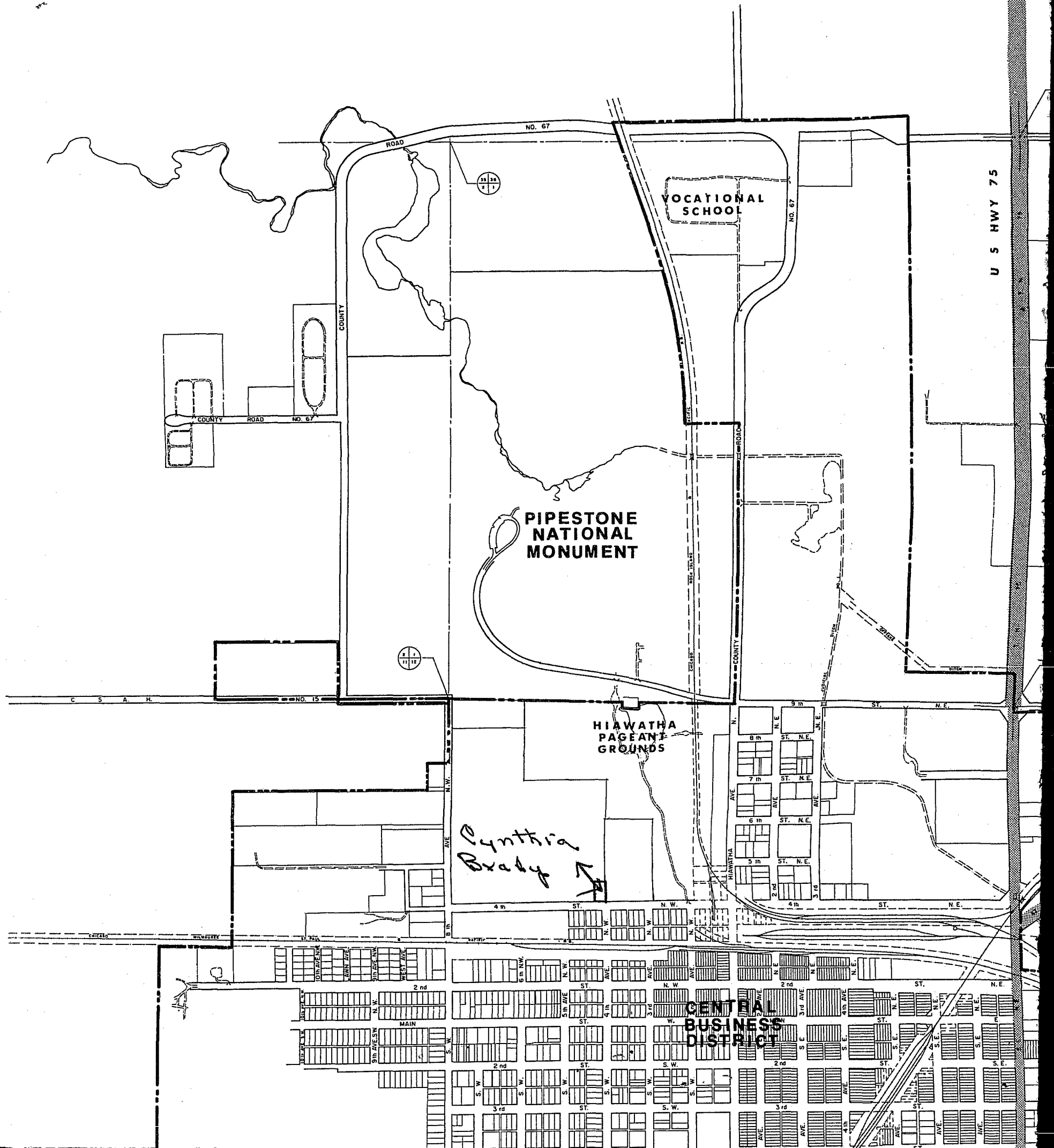

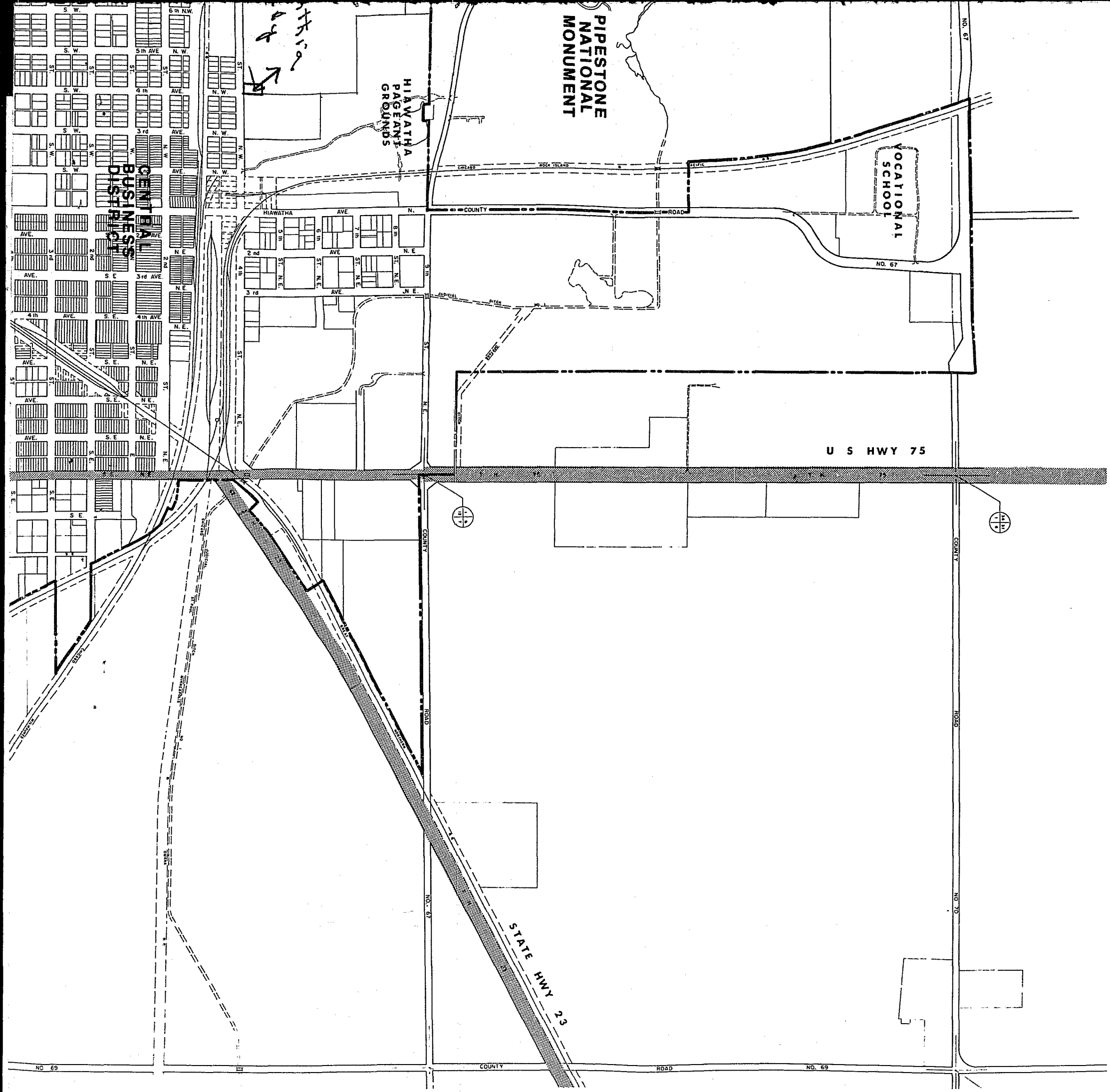

CENTRAL
BUSINESS
DISTRICT

HIAWATHA
PAGEANT
GROUNDS

PIPESTONE
NATIONAL
MONUMENT

VOCATIONAL
SCHOOL

U S HWY 75

STATE HWY 23

Hwy 23
↗

NO. 69

COUNTY

ROAD

NO. 68

NO. 67

COUNTY

ROAD

NO. 70

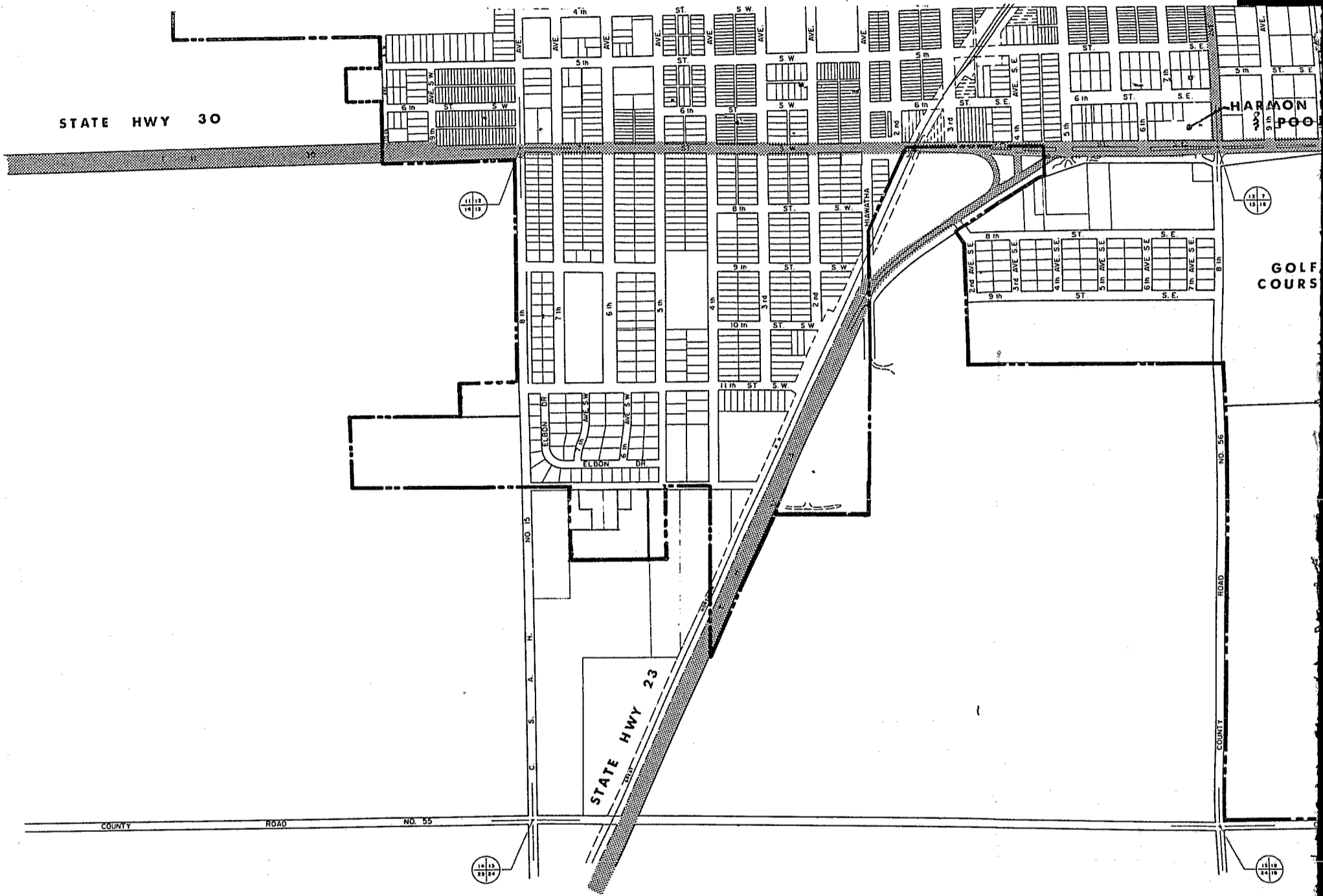

PIPESTONE , MINNESOTA

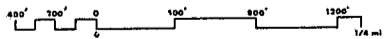

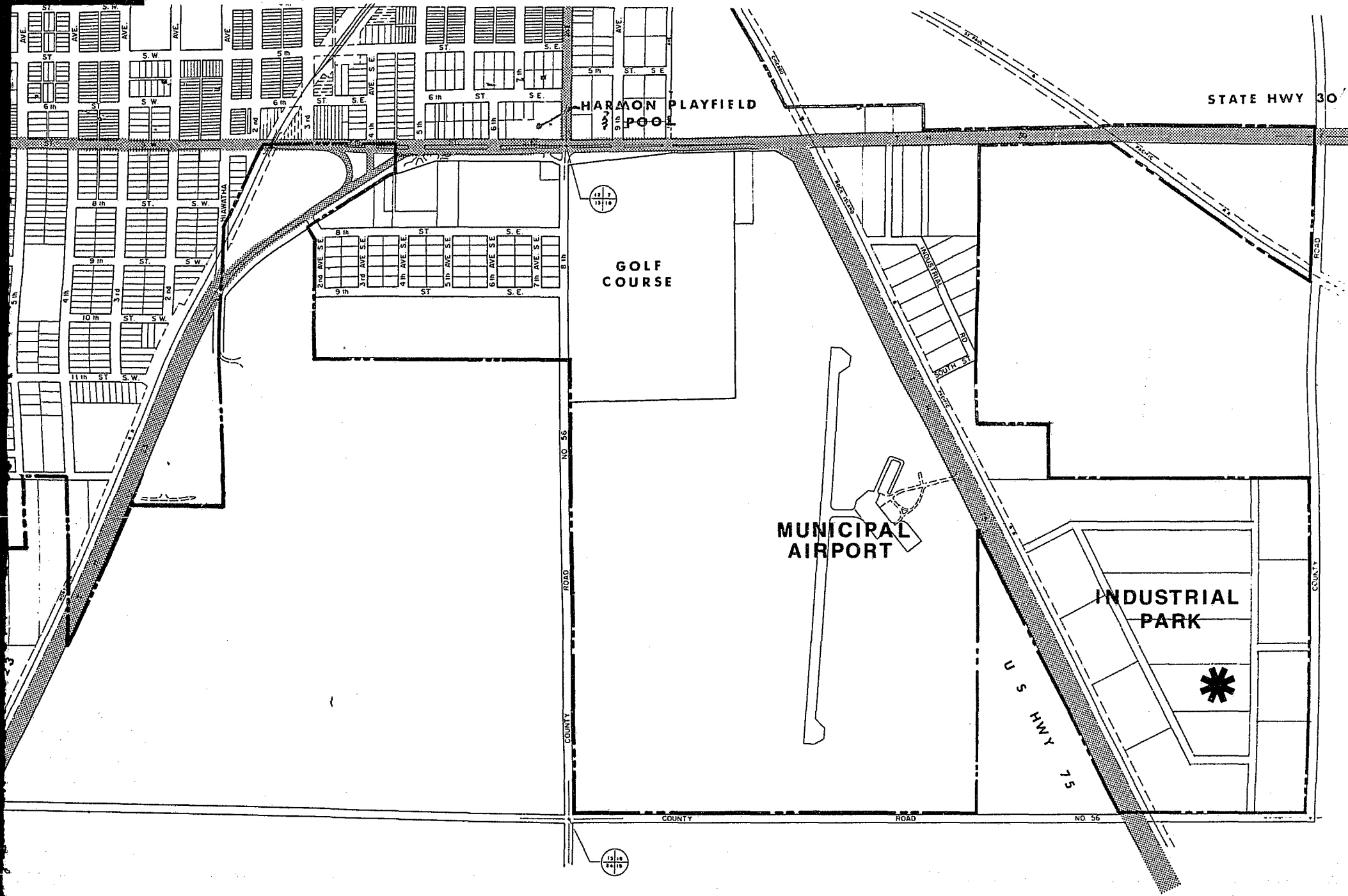

SOTA

ORDINANCE #1.42

NOV 13 1975

Q-2877

AN ORDINANCE ANNEXING CONTIGUOUS TERRITORY TO THE CITY OF PIPESTONE

THE COUNCIL OF THE CITY OF PIPESTONE, DO ORDAIN AS FOLLOWS:

Section 1. A tract of land described by metes and bounds as follows, to-wit:

Beginning on the north line extension of the center line of Fourth Avenue Northwest and eighty (80) feet north of the north line of Blocks Six (6) and Seven (7), Original Plat to the City of Pipestone; thence north one hundred fifty (150) feet; thence west seventy five (75) feet; thence north one hundred fifty (150) feet; thence east seventy five (75) feet to the point of beginning, all in Section Twelve (12), Township One Hundred Six (106) North, Range Forty Six (46) West of the 5th P.M.,

is hereby declared to be a part of the City of Pipestone, Minnesota.

Section 2. This ordinance shall take effect and be in full force from and after its passage and publication.

Original Ordinance passed 6 November, 1975.

Dean Gewecke
Dean Gewecke, Mayor

ATTEST:

Harold E. Lee
Harold E. Lee, City Clerk

Published in Pipestone County Star on November 10, 1975

Certification

I, Harold E Lee, the City Clerk of the City of Pipestone, Pipestone County, Minnesota, and Custodian of its records, do hereby certify that the foregoing is a true & exact photocopy of Ordinance # 1.42-the original is on file in my office.

November 12, 1975

Harold E. Lee
Harold E Lee, City Clerk

32550

TRANSMITTAL - MESSAGE SLIP

TO <i>Donna Scott</i>		LOCATION
DATE <i>10/12/79.</i>		
FROM <i>Jerry Brown</i>		LOCATION <i>6-1685</i>
TRANSMITTAL ACTION		CALL OR VISIT
<input type="checkbox"/> Review and see me		NAME
<input type="checkbox"/> Review and return		FROM
<input type="checkbox"/> Prepare reply for my sig.		PHONE NO.
<input type="checkbox"/> Reply and send me copy		<input type="checkbox"/> Called
<input type="checkbox"/> For your approval		<input type="checkbox"/> Was here to see you
<input type="checkbox"/> For your information		<input type="checkbox"/> Please call
<input type="checkbox"/> For signature		<input type="checkbox"/> Will call again
<input type="checkbox"/> As we discussed		<input type="checkbox"/> Returned your call
<input type="checkbox"/> As you requested		
<input type="checkbox"/> Take appropriate action		
<input type="checkbox"/> Notify staff		

MESSAGE

enclosed is the original ordinance for filing

NOV 13 1975
Q-3877

AN ORDINANCE ANNEXING CONTIGUOUS TERRITORY TO THE CITY OF PIPESTONE

THE COUNCIL OF THE CITY OF PIPESTONE, DO ORDAIN AS FOLLOWS:

Section 1. A tract of land described by metes and bounds as follows, to-wit:

Beginning on the north line extension of the center line of Fourth Avenue Northwest and eighty (80) feet north of the north line of Blocks Six (6) and Seven (7), Original Plat to the City of Pipestone; thence north one hundred fifty (150) feet; thence west seventy five (75) feet; thence north one hundred fifty (150) feet; thence east seventy five (75) feet to the point of beginning, all in Section Twelve (12), Township One Hundred Six (106) North, Range Forty Six (46) West of the 5th P.M.,

is hereby declared to be a part of the City of Pipestone, Minnesota.

Section 2. This ordinance shall take effect and be in full force from and after its passage and publication.

Original Ordinance passed 6 November, 1975.

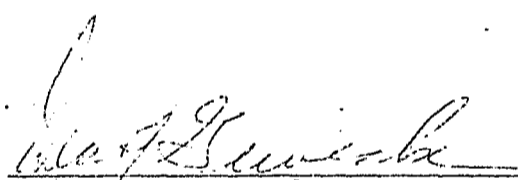
Dean Gewecke, Mayor

ATTEST:



Harold E. Lee, City Clerk

Published in Pipestone County Star on November 10, 1975

C e r t i f i c a t i o n

I, Harold E Lee, the City Clerk of the City of Pipestone, Pipestone County, Minnesota, and Custodian of its records, do hereby certify that the foregoing is a true & exact photocopy of Ordinance # 1.42-the original is on file in my office.

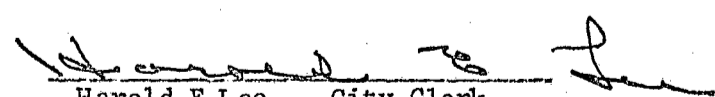
November 12, 1975

Harold E Lee, City Clerk

STATE OF MINNESOTA
DEPARTMENT OF STATE
FILED
DEC 19 1975
Jan Anderson Brower
Secretary of State
432559
O.A.