

An Equal Opportunity Employer

Phone: 296-2428



STATE OF MINNESOTA
MUNICIPAL BOARD

Suite 165 Metro Square
7th & Robert Streets
St. Paul, Minnesota 55101
October 12, 1979

Ms. Julie Leibfried
City Clerk
City Hall
Ivanhoe, Minnesota 56142

Re: Docket Number A-3603

Ordinance Number 115

City of Ivanhoe

Dear City Clerk:

The Minnesota Municipal Board has now processed and approved the above ordinance and filing fee in accordance with Minnesota Statutes, Chapter 414, and the Rules of Procedure.

According to law, this annexation ordinance must be filed with the Township Clerk, County Auditor, Secretary of State and the Municipal Board. (Since the ordinance has already been filed with the Municipal Board, no additional copies are required.)

The annexation is final upon the date the ordinance is approved by the Board, which is the date of this letter.

Sincerely,

MUNICIPAL BOARD

A handwritten signature in cursive script, appearing to read "Pat Lundy".

Patricia D. Lundy
Assistant Executive Director

PDL:kj

cc: Secretary of State
County Auditor
Township
Attorney
Municipality

STATE OF MINNESOTA
DEPARTMENT OF STATE
FILED
OCT 17 1979

John Andrew Howe
Secretary of State

(REVISED 7/78)

#32453
O.D.

PROPOSED 1979 ANNEXATION OF CITY PROPERTY

City of IVANHOE
Lincoln County
Minnesota

Compiled from County Records & Plans
Prepared by the Lincoln County Planning Office
August 1975

EXISTING CITY
LIMITS

PROPOSED ANNEXATION

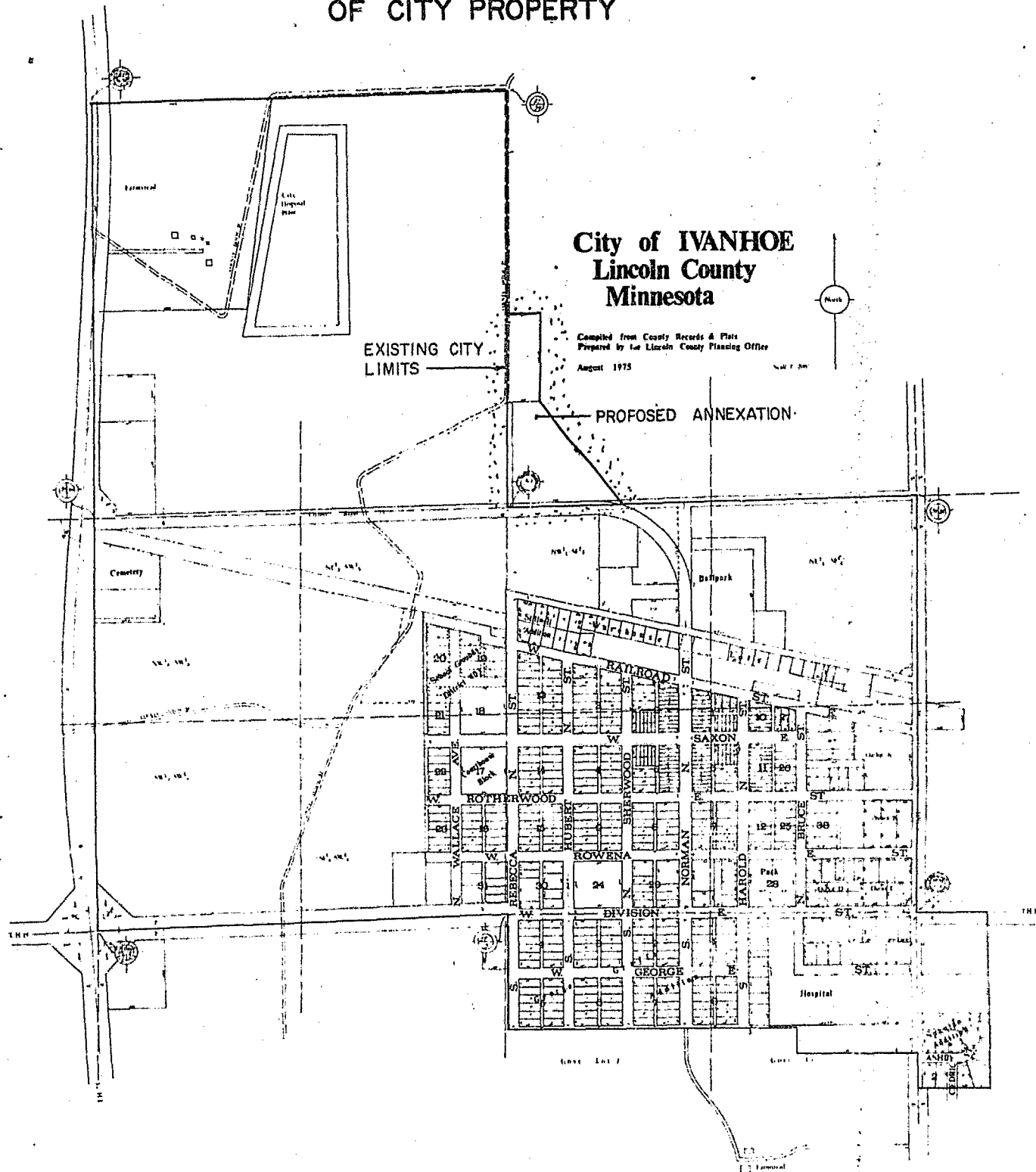

LEGAL DESCRIPTION FOR THE PROPOSED
1979 ANNEXATION OF CITY PROPERTY
TO AND FOR THE CITY OF IVANHOE, MINN.

A tract of land located in the Northeast Quarter of Section 34, Township 112 North, Range 45 West, County of Lincoln, State of Minnesota, being more particularly described as follows;

Beginning at the Southwest Corner of said Northeast Quarter thence North $00^{\circ}05'03''$ East along the West line of said Northeast Quarter 1112.65 feet; thence South $89^{\circ}54'57''$ East 200.00 feet; thence South $00^{\circ}05'03''$ West 561.95 feet; thence South $44^{\circ}52'57''$ East 756.41 feet more or less to a point on the South line of said Northeast Quarter; thence South $88^{\circ}52'25''$ West along said South line 734.71 feet to the Point of Beginning.

Said tract of land contains 8.45 Acres more or less.

I hereby certify that this survey, plan, or report was prepared by me or under my direct supervision and that I am a duly Registered Land Surveyor under the laws of the State of Minnesota.

Lyle E. Moseng
Reg. No. 11943

LYLE E. MOSENG — Registered Land Surveyor

501 E. College Drive Marshall, Minn. 56258

DATE: *Aug 13, 1979*

SCALE:

PROJECT NUMBER *79-406*

LAW OFFICES
QUARNSTROM, DOERING, PEDERSON, LEARY & MURPHY
P. C. A. BUILDING
IVANHOE, MINNESOTA 56142
507 694-1763

W. P. QUARNSTROM
LEE E. DOERING
DURWARD L. PEDERSON
PATRICK J. LEARY
BRIAN J. MURPHY
MICHAEL W. CABLE

MARSHALL OFFICES
509 WEST MAIN STREET
MARSHALL, MINNESOTA 56258
507 532-5766

September 12, 1979

Secretary of State
Room 180
State Office Building
St. Paul, MN 55155

Re: Annexation of City of Ivanhoe Property
to City of Ivanhoe

Dear Madam:

There is herewith enclosed for filing in compliance with
M.S.A. Sec. 414.033 certified copy of Ordinance No. 115
extending the corporate limits of the City of Ivanhoe to
include certain unincorporated, unplatted land not exceeding
200 acres in area abutting upon the city limits.

Yours very truly,

QUARNSTROM, DOERING,
PEDERSON, LEARY & MURPHY

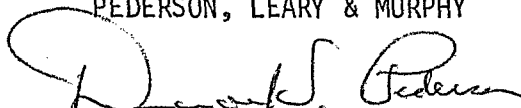
Durward L. Pederson

DLP:ds
Enc.