

**ORDINANCE NO. 1001
AN ORDINANCE ANNEXING
TO THE CITY OF ROCHESTER,
MINNESOTA, CERTAIN
UNPLATTED LAND NOT EX-
CEEDING 700 ACRES IN AREA
SITUATED IN SECTION 11,
TOWNSHIP 106 NORTH,
RANGE 14 WEST, OLMSTED
COUNTY, MINNESOTA.**

**THE COMMON COUNCIL OF THE
CITY OF ROCHESTER DO OR-
DAIN:**

Section 1. A petition has been filed with the Common Council of the City of Rochester, signed by a majority of the owners of land described herein, requesting the Common Council to annex said land to the City of Rochester. The land described in said petition for annexation is located in Rochester Township, Olmsted County, Minnesota, and is described as follows:

A tract of land described by metes and bounds as follows: Beginning at the Northwest corner of the Southwest Quarter, Section 11, Township 106 North, Range 14 West, thence East on the North line of said Southwest Quarter, 450 feet, thence South parallel with the West line of Southwest Quarter 739.8 feet, thence Southwest along center of County Aid Road "D" to the west line of the Southwest Quarter, thence North on the West line of the Southwest Quarter 892.1 feet to the place of beginning. Subject to valid easements, restrictions and covenants of record.

Said petition has also been filed with the Town Board of Rochester Township, with the County Board of the County of Olmsted, and with the Minnesota Municipal Commission, and more than 60 days have elapsed since said petition was filed with the Town Board and no objections to annexation of the above described land have been filed by said Town Board with the Minnesota Municipal Commission.

Section 2. The quantity of unplatted land included in said petition is approximately 9.237 acres.

Section 3. The Common Council of the City of Rochester does hereby determine that the land in Section 1 abuts upon the present territorial limits of the City of Rochester, is so conditioned as to be properly subjected to municipal government, and the annexation of said land will be in the best interest of the City of Rochester and the land affected.

Section 4. Therefore, the land described in Section 1 above is hereby annexed, added to and made a part of the City of Rochester, Minnesota, as effectually as if it had originally been a part thereof.

Section 5. Present and future owners of the area annexed by this ordinance are hereby notified that in addition to the usual assessments, it is the intention of the Common Council to assess against benefited property all or a portion of the cost of any storm sewer, water tower and trunk line sanitary sewer construction heretofore or hereafter, undertaken to serve the area annexed.

Section 6. This ordinance shall take effect and be in force from and

after its official publication and from and after the filing of a certified copy hereof with the Minnesota Municipal Commission, the Rochester Town Clerk, the County Auditor and the Secretary of State.

Passed and adopted by the Common Council of the City of Rochester, Minnesota, this 23rd day of February, 1977.

/s/R. J. Postier
President of said
Common Council

Attest: /s/Carole A. Grimm
City Clerk

Approved this 24th day
of February, 1977.
/s/Alex P. Smehta
Mayor of said City

(Seal of the City of
Rochester, Minnesota)
(3/3, 3/10

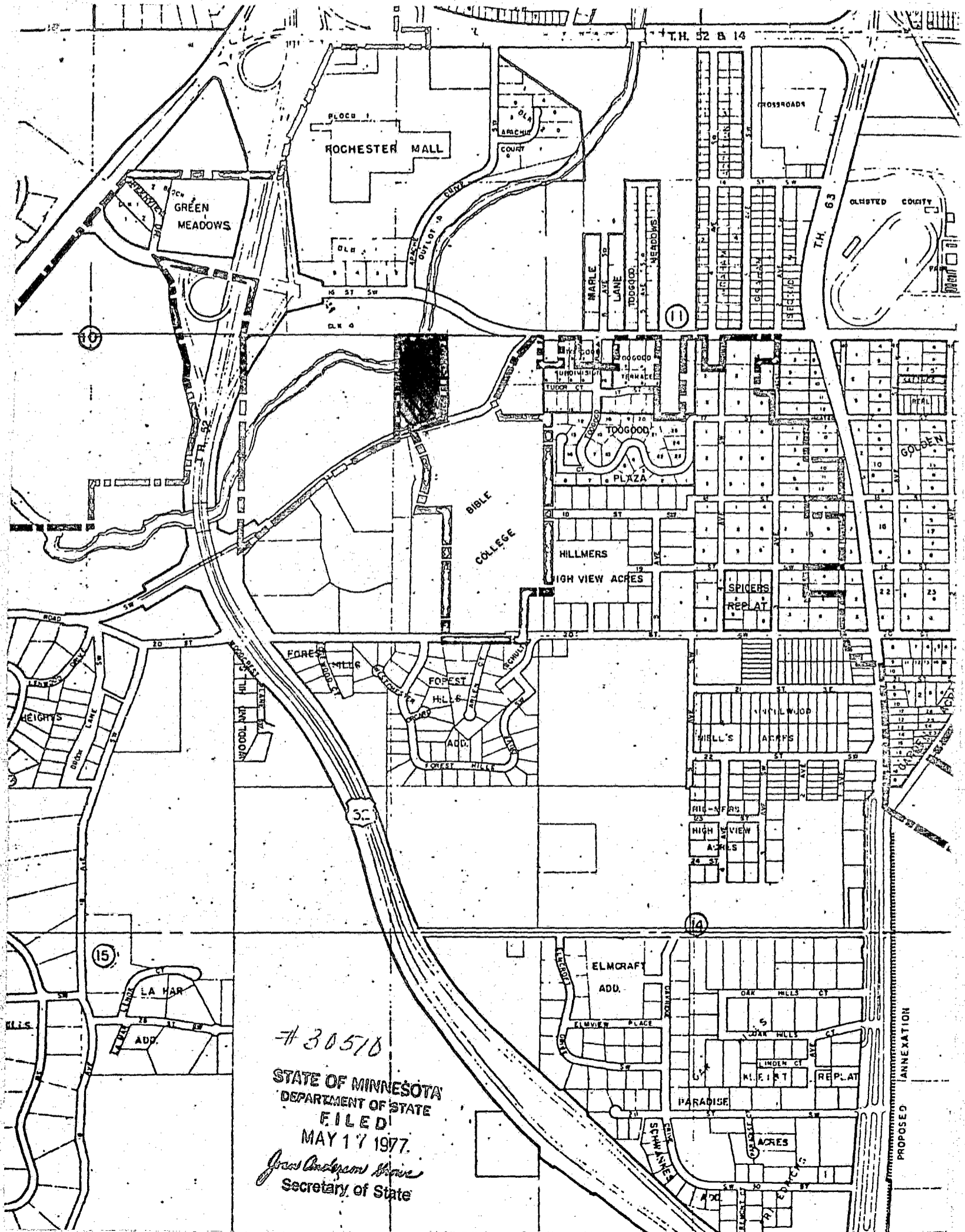

#30510
 STATE OF MINNESOTA
 DEPARTMENT OF STATE
 FILED
 MAY 17 1977
James Anderson
 Secretary of State

PROPOSED ANNEXATION

#1881

STATE OF MINNESOTA)
)
COUNTY OF OLMSTED) SS
)
CITY OF ROCHESTER)

I, Evalyn M. Langworthy, Deputy City Clerk of the City of Rochester, Minnesota, do hereby certify that I have compared the attached copy of an ordinance with the original ordinance on file in my office and that the foregoing is a true and correct copy of the said ordinance and of the whole thereof.

Witness my hand this 2 day of May, 1977.

Evalyn M. Langworthy
Deputy City Clerk of the
City of Rochester, Minnesota

(Seal of the City of
Rochester, Minnesota)

#30510
STATE OF MINNESOTA
DEPARTMENT OF STATE
FILED
MAY 17 1977
Joan Anderson Howe
Secretary of State

An Equal Opportunity Employer

Phone: 296-2428



STATE OF MINNESOTA

MUNICIPAL BOARD

Suite 165 Metro Square
7th & Robert Streets
St. Paul, Minnesota 55101

May 13, 1977

Ms. Evalyn M. Langworthy
Deputy City Clerk
City Hall
Room 100
Rochester, Minnesota 55901

Re: Docket Number A-3065 Ordinance Number #1881
Rochester - Maywood Rd. Group Home for Girls

Ladies and Gentlemen:

The Minnesota Municipal Board acknowledges receipt and filing of the above Ordinance and filing fee in accordance with Minnesota Statutes, Chapter 414, and the Rules of Procedure.

According to law, this annexation is final upon filing a copy of the ordinance with the Town Clerk, County Auditor, Secretary of State and the Municipal Board. (Since the ordinance has already been filed with the Municipal Board, no additional copies are required.)

Please refer to the above docket and ordinance numbers in any future reference to this annexation.

Sincerely yours,

MUNICIPAL BOARD

Patricia D. Lundy
Patricia D. Lundy
Assistant Executive Secretary

PDL:es

c.c. Secretary of State
County Auditor
Township
Attorney
Municipality