



STATE OF MINNESOTA
MUNICIPAL BOARD

Suite 165 Metro Square
7th & Robert Streets
St. Paul, Minnesota 55101

August 13, 1976

Mr. Bruce L. Brown
City Clerk-Treasurer
City of Wadena
P.O. Box 30
Wadena, Minnesota 56482

Re: Docket Number A-2838 Ordinance Number #160
Wadena

Dear Sir:

The Minnesota Municipal Board acknowledges receipt and filing of the above Ordinance and filing fee in accordance with Minnesota Statutes, Chapter 414 and the Rules of Procedure.

According to law, this annexation is final upon filing a copy of the ordinance with the Town Clerk, County Auditor and Secretary of State in addition to the Municipal Board.

Please refer to the above docket and ordinance numbers in any future reference to this annexation.

Sincerely yours,

MUNICIPAL BOARD

A handwritten signature in cursive script that reads "Patricia D. Lundy".

Patricia D. Lundy
Assistant Executive Secretary

PDL/eas

c.c. Secretary of State
County Auditor
Township
Attorney
Municipality

29859

STATE OF MINNESOTA)
COUNTY OF WADENA) SS
CITY OF WADENA)

CERTIFICATION

I Bruce L. Brown, the duly appointed, qualified and acting city clerk treasurer of the City of Wadena, Minnesota, Wadena county, minnesota, do hereby certify that the attached

ORDINANCE No. 160

AN ORDINANCE EXTENDING THE CORPORATE LIMITS OF THE CITY OF WADENA TO INCLUDE CERTAIN UNINCORPORATED PLATTED LAND ABUTTING UPON THE CITY LIMITS.

is a true and correct copy of said Ordinance as adopted by the city council, city of Wadena, Minnesota, on June 14th, 1976, duly published in the Wadena Pioneer Journal, the official newspaper for publications of the City Council, City of Wadena, Minnesota on June 24th, 1976, kept on file in my office pursuant to Minnesota Statutes.

WITNESS my hand and seal of my office this 25th day of June, 1976.

(seal)

Bruce L. Brown
City Clerk-Treasurer
City of Wadena, Minnesota

STATE OF MINNESOTA
DEPARTMENT OF STATE
FILED
AUG 19 1976
Gene Andrew Stone
Secretary of State

Ordinance No. 160

AN ORDINANCE EXTENDING THE CORPORATE LIMITS OF THE CITY OF WADENA TO INCLUDE CERTAIN UNINCORPORATED PLATTED LAND ABUTTING UPON THE CITY LIMITS.

WHEREAS, a certain petition dated March 31, 1975, requesting annexation of the territory hereinafter described was duly presented to the council on the 9th day of April, 1975; and

WHEREAS, the quantity of land embraced within the area described in the petition and bounded as described in approximately 10 acres of platted land, no part of which is included within the limits of an incorporated city, or borough; and

WHEREAS, the petition was signed by owners (by 8 owners, constituting a majority but not all of a total number of 14 owners); and

WHEREAS, no objections to the annexation have been received from the town board, or the governing body of any municipality whose boundaries abut upon the boundaries of the land to be annexed; and

WHEREAS, a hearing was duly held by the governing body of the City of Wadena, Minnesota, on the proposed annexation after at least 30 days mailed notice; and

WHEREAS, the land described in the petition abuts upon the city limits at the South boundary thereof;

The council of the City of Wadena, Minnesota, ordains:

Section 1. The city council hereby determines

- (1) that the annexation will be to the best interests of the city and of the territory affected;
- (2) that the territory described herein abuts upon the city limits and is urban or suburban in character; and
- (3) that none of said territory is now included within the limits of any city, or borough.

Section 2. Territory Annexed. The corporate limits of the city are hereby extended to include the platted land described as follows and the same is hereby annexed to and included within the city as effectually as if it had originally been a part thereof:

Lots Seven through Sixteen inclusive of Block Three;
Lots One through Eight inclusive of Block Four;
All of Block Five; all of Block Six and including all adjacent streets and roadways; all in Southbrook Addition to the Township of Wadena, Wadena County, Minnesota.

Section 3. Filing. The city clerk-treasurer is hereby directed to file certified copies of this ordinance with the Minnesota Municipal Commission, the Secretary of State, the Town Clerk, and the County Auditor.

Section 4. Effective Date. This ordinance takes effect upon its passage and publication and the filing of the certified copies as directed in Section 3.

Adopted by the council this 14th day of June, 1976.



Mayor

ATTEST:

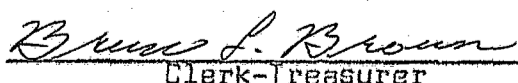

Clerk-Treasurer

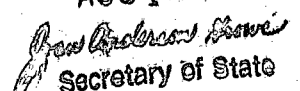
#29859
STATE OF MINNESOTA
DEPARTMENT OF STATE
FILED
AUG 19 1976

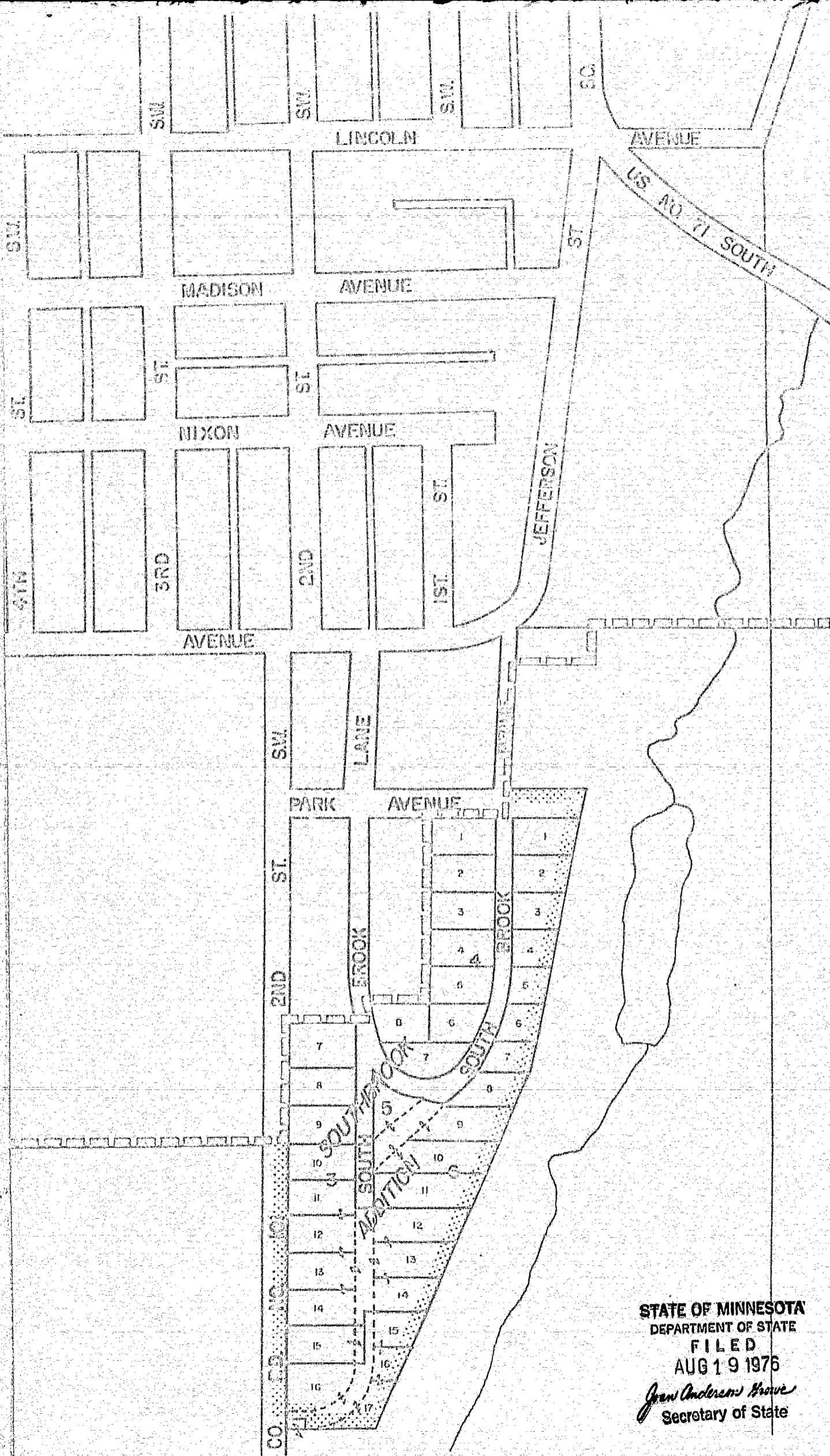
Secretary of State



STATE OF MINNESOTA
 DEPARTMENT OF STATE
 FILED
 AUG 19 1976
John Anderson Hoove
 Secretary of State

Annexed Land 

Docket A-2838 Ordinance No. 160