

STATE OF MINNESOTA
MUNICIPAL BOARD

Suite 165 Metro Square
7th & Robert Streets
St. Paul, Minnesota 55101
June 7, 1976

Mr. Clyde Weivoda
City Clerk-Treasurer
Albany, Minnesota 56307

Re: Docket Number A-2834. Ordinance Number #1975 - 1
Hall-Muellner Annexation

Dear Sir:

The Minnesota Municipal Board acknowledges receipt and filing of the above Ordinance and filing fee in accordance with Minnesota Statutes, Chapter 414 and the Rules of Procedure.

According to law, this annexation is final upon filing a copy of the ordinance with the Town Clerk, County Auditor and Secretary of State in addition to the Municipal Board.

Please refer to the above docket and ordinance numbers in any future reference to this annexation.

Sincerely yours,

MUNICIPAL BOARD

Patricia D. Lundy
Patricia D. Lundy
Assistant Executive Secretary

PDL/eas

c.c. Secretary of State
County Auditor
Township
Attorney
Municipality

29589

Township of Albany
County of Stearns
State of Minnesota

September 27, 1975

Minnesota Municipal Commission
304 Capitol Square Building
St. Paul, Minnesota 55101

Re: Albany
Docket Number A-2834
Hall-Muellner Annexation

We, the undersigned, being the chairman and the clerk, respectively, of the Board of Supervisors in and for the Township of Albany, Stearns County, Minnesota, do hereby certify that the said board at a REGULAR meeting held at 8:30 p.m. on the 27th day of September, 1975, in the meeting room of the Stearns County National Bank in the City of Albany did by unanimous vote determine not to file a protest to the Hall-Muellner Annexation to the City of Albany.

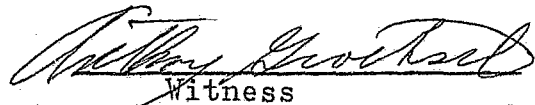

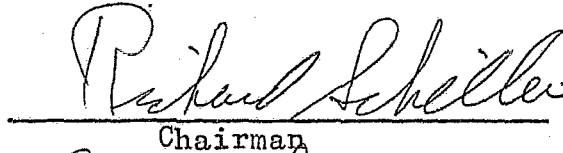
Witness

Chairman

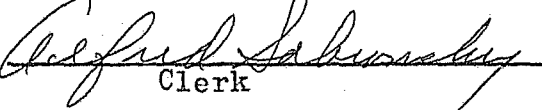
Witness

Clerk

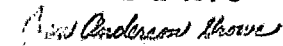
(S-E-A-L)

#29589
STATE OF MINNESOTA
DEPARTMENT OF STATE
FILED
JUN 1 1976

Secretary of State

Albany

CERTIFICATION OF MINUTES RELATING TO:

Hall-Muellner Annexation

Issuer: City of Albany, Stearns County, Minnesota 56307

Governing body: City Council

Kind, date, time and place of meeting: a SPECIAL meeting, held September 29, 1975 at 7:40 o'clock P.M. in the City Councilroom.

Members present: Howard Kittleson, Ralph Gorecki, Robley Evans, Robert Hanauer and Ervin Kuper.

Members absent: None.

Documents attached:

City Ordinance Number 1975-1

I, the undersigned, being the duly qualified and acting recording officer of the public corporation named above, certify that the documents attached hereto, as described above, are exact photo copies of the original records on file in my office; and that the said meeting was duly held by the governing body at the time and place and was attended throughout by the members as indicated above, pursuant to call and notice of such meeting have been given as required by law.

WITNESS my hand officially as such recording officer this 1st day of October, 1975

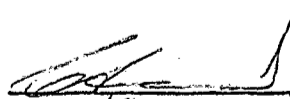

(Signature)

C. A. Weivoda - City Clerk/Treasurer
(Name & Title)

(S E A L)

ORDINANCE NUMBER 1975-1

AN ORDINANCE EXTENDING THE CORPORATE LIMITS OF THE CITY OF ALBANY, STEARNS COUNTY, MINNESOTA TO INCLUDE CERTAIN UNINCORPORATED UNPLATTED LAND NOT EXCEEDING 200 ACRES IN AREA AND ADJUTING UPON THE PRESENT CITY LIMITS

WHEREAS: the quantity of land embraced within the area described in the petition and bounded as described is ten (10) acres (more or less) of unplatted land, no part of which is included within the limits of an incorporated city; and

WHEREAS: the petition for annexation was signed by all of the owners; and

WHEREAS: no objections to the annexation have been received from the town board, the county board or other governing body or any municipality whose abut upon the boundaries of the land to be annexed; and

WHEREAS: the land described in the petition abuts upon the city limits on its westerly boundaries thereof; The City Council of the City of Albany, Stearns County, Minnesota ordains:

Section 1. The city council hereby determines (1) that the annexation will be to the best interests of the city and the territory affected; (2) that the territory herein described abuts upon the city limits and is about to become urban or suburban in character; and (3) that none of the said territory is now included within the limits of any city.

Section 2. Territory Annexed. The corporate limits of the city are hereby extended to include the unplatted described as follows and the same is hereby annexed to and included within the city as effectively as if it had been originally part thereof:

19.00 A SW $\frac{1}{4}$ SE $\frac{1}{4}$ N of Ry. less E 237' Sec 16
T 125 E 31 and less the W 330'.

Section 3. Filing. The city clerk is hereby directed to file certified copies of this ordinance with the Minnesota Municipal Commission, the Secretary of State and the County Auditor.

Section 4. Effective Date. This ordinance take effect upon its passage and publication and the filing of the certified copies as directed in Section 3.

Adopted by the council this 29th day of September, 1975

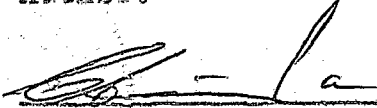

Howard B. Kittleson - Mayor

ATTEST:

CA Wcivoda - City Clerk

29589
STATE OF MINNESOTA
DEPARTMENT OF STATE

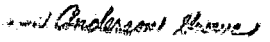
FILED
JUN 1 1976

Secretary of State

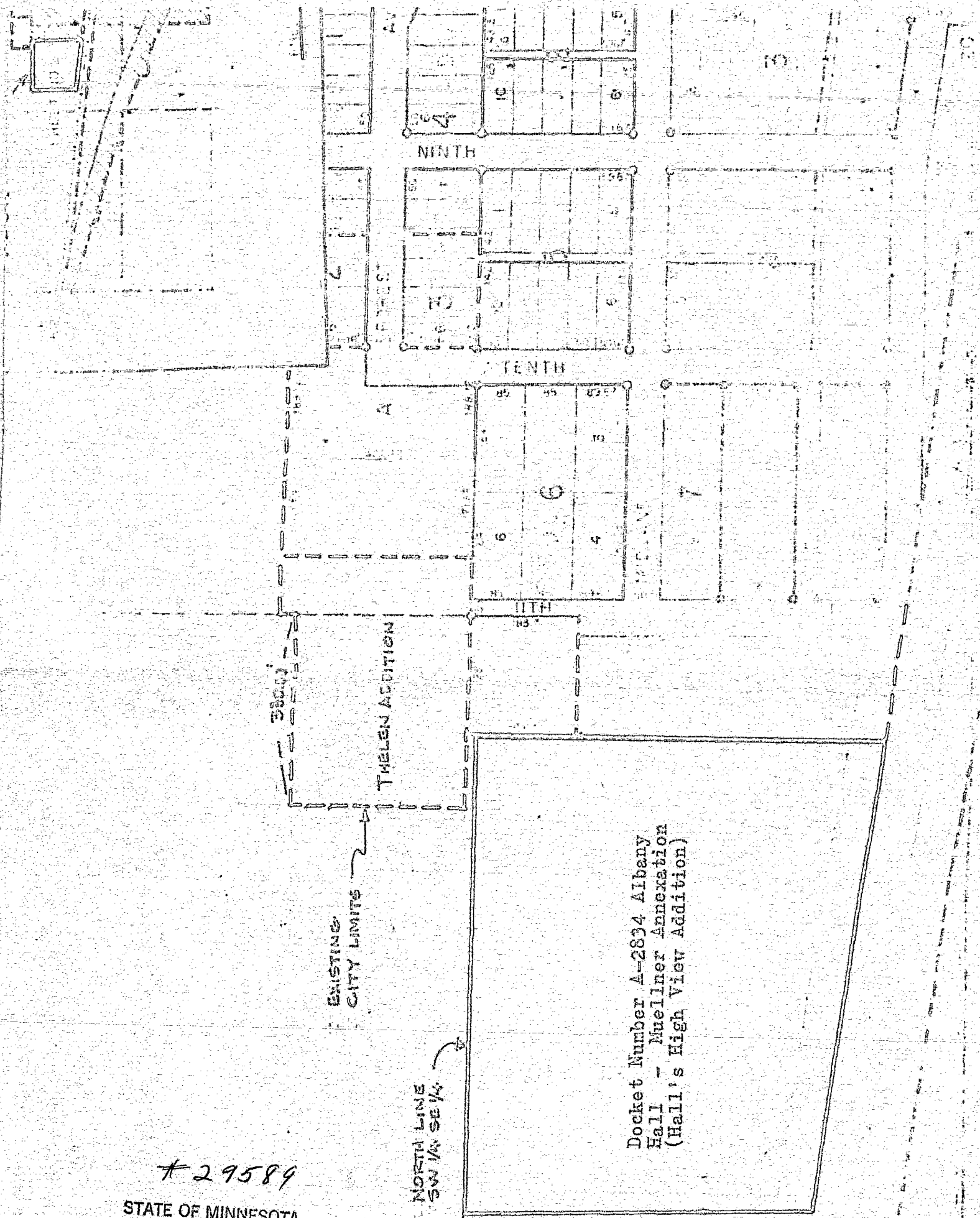

29589
 STATE OF MINNESOTA
 DEPARTMENT OF STATE
 FILED
 JUN 1 1 1976
Carl Anderson Reeves
 Secretary of State

Docket Number A-2824 Albany
 Hall - Mueller Annexation
 (Hall's High View Addition)

SCALE 1" = 200'

#29589

OD.