

An Equal Opportunity Employer

Phone: 296-2428



STATE OF MINNESOTA
MUNICIPAL COMMISSION

304 Capitol Square Building
10th & Cedar Streets
St. Paul, Minnesota 55101
April 14, 1975

Mrs. Carole Grimm, Clerk
City Hall
Rochester, Minn. 55901

Re: Docket Number A-2739 Ordinance Number 1787

Dear Sir:

The Minnesota Municipal Commission acknowledges receipt and filing of the above Ordinance and filing fee in accordance with Minnesota Statutes, Chapter 414 and the Rules of Procedure.

According to law, this annexation is final upon filing a copy of the ordinance with the Town Clerk, County Auditor and Secretary of State in addition to the Municipal Commission.

Please refer to the above docket and ordinance numbers in any future reference to this annexation.

Sincerely yours,

MUNICIPAL COMMISSION

Patricia D. Lundy
Asst. Executive Secretary

PDL/mg

c.c. Secretary of State
County Auditor
Township
Attorney
Municipality

27982

State of Minnesota,

County of Olmsted,

City of Rochester, SS

I, Sharon K. Ayers, Deputy City Clerk of the City of Rochester,

Minnesota do hereby certify that I have compared the attached

copy of an ordinance with the original ordinance on file in

my office and that the foregoing is a true and correct copy

of the said ordinance and of the whole thereof.

Witness my hand this 18th day of December, 1974.

Sharon K. Ayers
Deputy City Clerk of Rochester, MN

(Seal of the City of
Rochester, Minnesota)

2798B
STATE OF MINNESOTA
DEPARTMENT OF STATE
FILED
APR 17 1975

Greg Anderson
Secretary of State

ORDINANCE NO. 7487 1787
AN ORDINANCE ANNEXING TO THE
CITY OF ROCHESTER, MINNE-
SOTA, CERTAIN UNPLATTED
LAND IN SECTION 10, TOWNSHIP
106 NORTH, RANGE 14 WEST,
OLMSTED COUNTY, MINNESOTA.
THE COMMON COUNCIL OF THE
CITY OF ROCHESTER DO ORDAIN:
Section 1. The City of Rochester,
Minnesota, is owner of the land herein-
after described located in Rochester
Township, Olmsted County, Minne-
sota, and which abuts the present
territorial limits of the City of
Rochester:
That portion of the East half of the
Southeast Quarter of Section 10,
Township 106 North, Range 14
West, which lies north of the cen-
terline of Maywood Road
Southwest.
Section 2. The quantity of land de-
scribed in Section 1 is approximately
41.9 acres in area.
Section 3. The Common Council of
the City of Rochester hereby de-
termines that the land described in
Section 1 abuts the present territorial
limits of the City of Rochester and is
hereby annexed, added to, and made a
part of the City of Rochester, Minne-
sota, as effectually as if it had
originally been a part thereof.
Section 4. This ordinance shall take
effect and be in force from and after
its official publication and from and
after the filing of a certified copy
hereof with the Minnesota Municipal
Commission, the Clerk of the Town of
Rochester, the Olmsted County
Auditor, and the Secretary of State.
Passed and adopted by the Common
Council of the City of Rochester, Min-
nesota, this 21st day of October, 1974.
R J Postler
President of said
Common Council
Attest: Carole A Grimm
City Clerk
Approved this 22nd day
of October, 1974
Alex P Smekta
Mayor of said City
(Seal of the City of
Rochester, Minnesota)
(10/26, 11/2)

1787

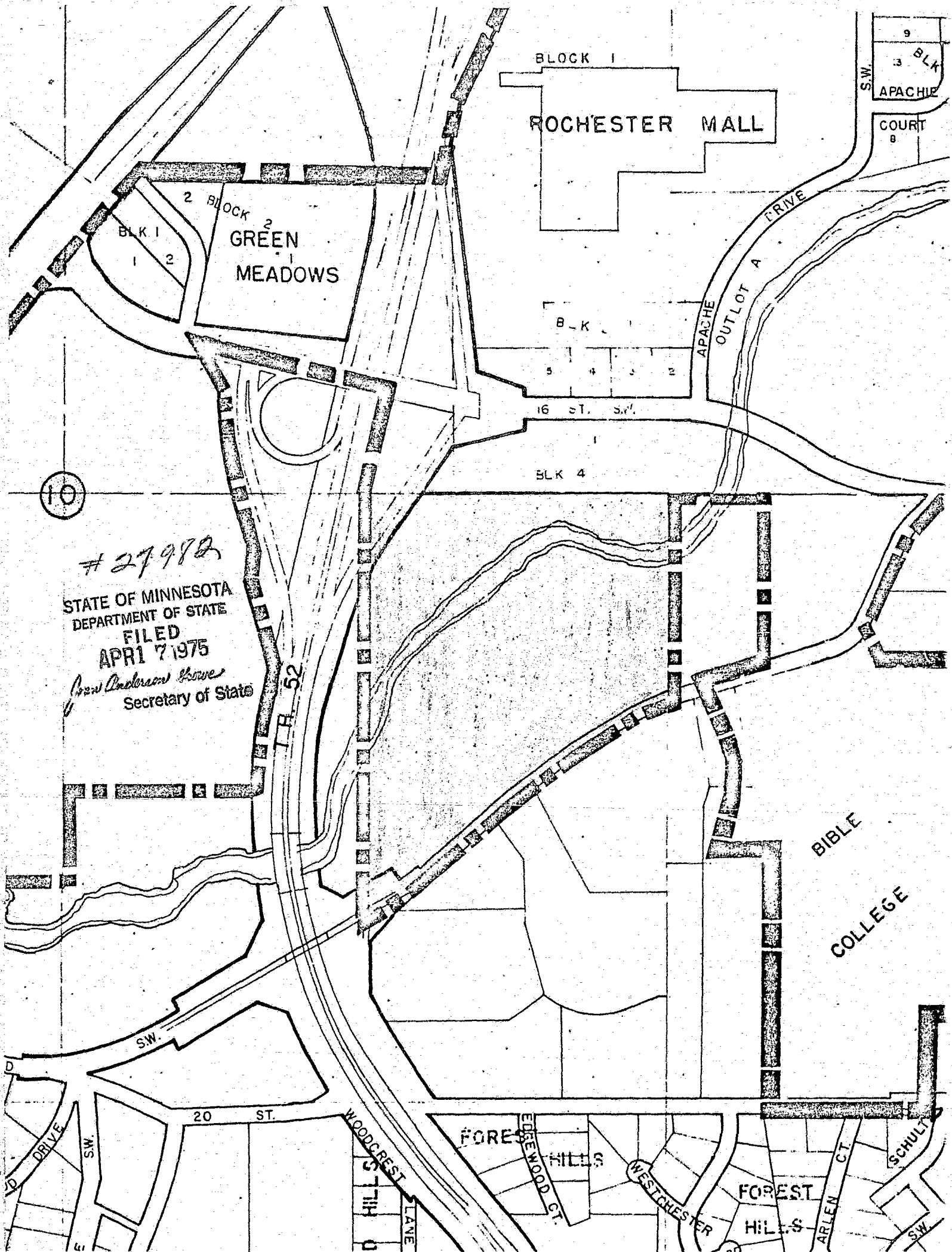

27982
STATE OF MINNESOTA
DEPARTMENT OF STATE
FILED
APR 17 1975
Carol Anderson Howe
Secretary of State