

Are Equal Opportunity Employer

Phone: 296-2428

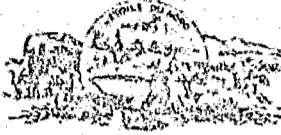

STATE OF MINNESOTA  
MUNICIPAL COMMISSION

304 Capitol Square Building  
10th & Cedar Streets  
St. Paul, Minnesota 55101

April 14, 1975

Mrs. Frances Rosevold, Clerk  
City Hall 202 E. Jackson  
Mankato, Minn. 56001

Re: Docket Number A-2733 Ordinance Number A-75-116

Dear Sir:

The Minnesota Municipal Commission acknowledges receipt and filing of the above Ordinance and filing fee in accordance with Minnesota Statutes, Chapter 414 and the Rules of Procedure.

According to law, this annexation is final upon filing a copy of the ordinance with the Town Clerk, County Auditor and Secretary of State in addition to the Municipal Commission.

Please refer to the above docket and ordinance numbers in any future reference to this annexation.

Sincerely yours,

MUNICIPAL COMMISSION

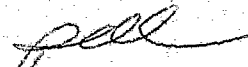
  
Patricia D. Lundy  
Asst. Executive Secretary

PDL/mg

c.c. Secretary of State  
County Auditor  
Township  
Attorney  
Municipality

27979

ATO

a-75-116

RANGE: 27 W.

TOWNSHIP: 108 N.

A

LIME TOWNSHIP LIME

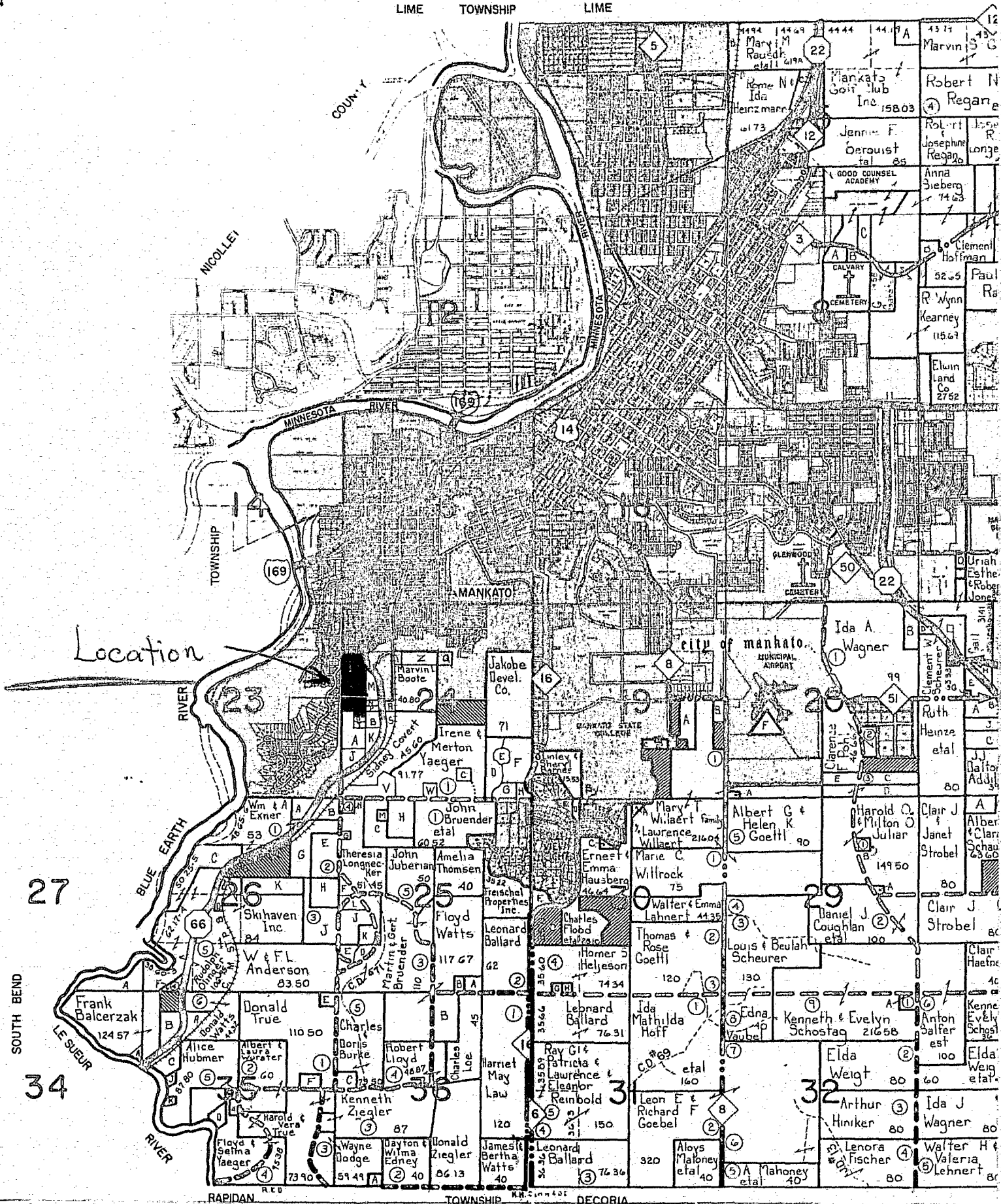

16

# MANKATO

TOWNSHIP: 108 N.

CODE: MB

#27979  
OD

RANGE: 26 W

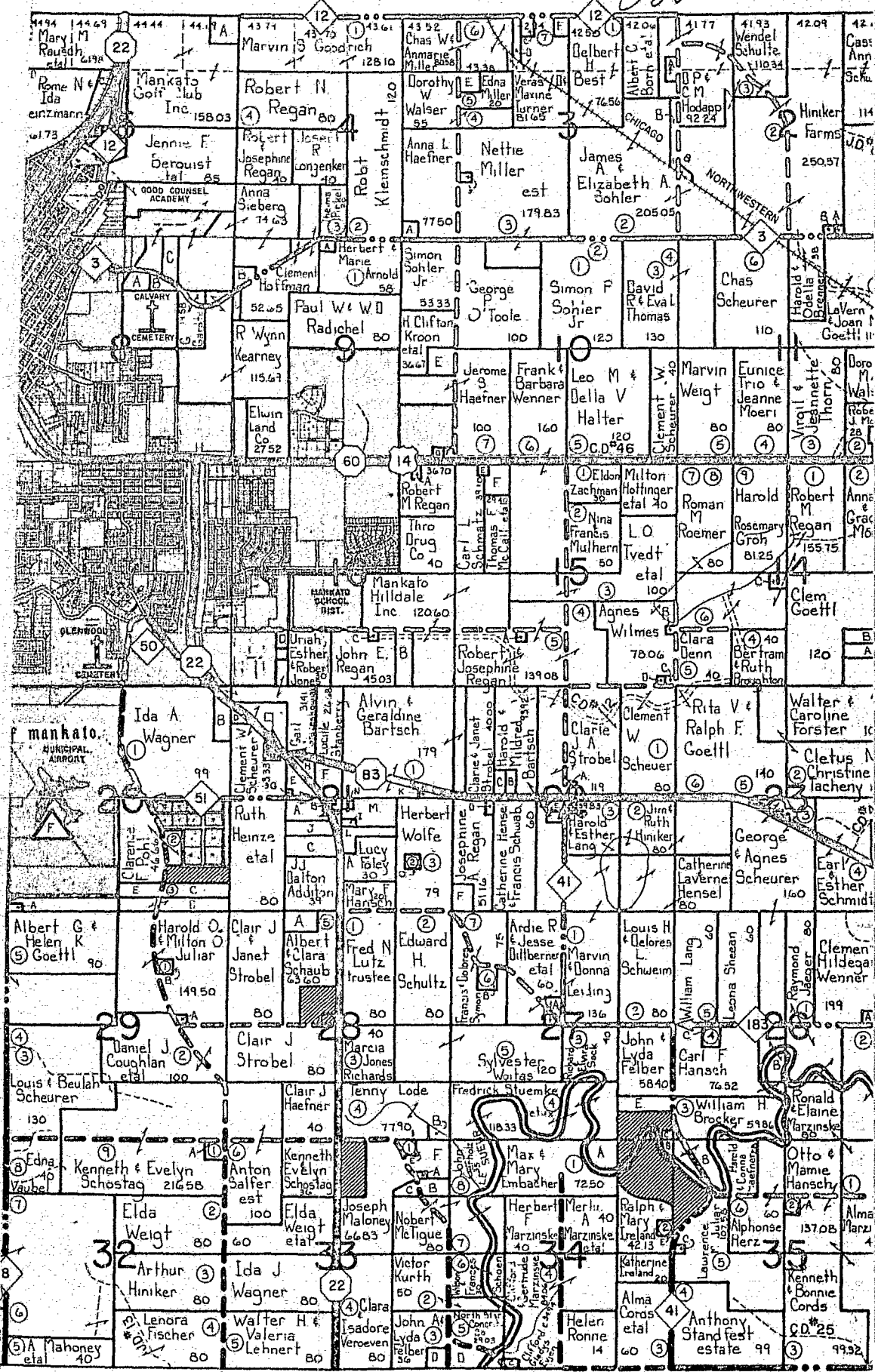

*Mankato*

#27979

December 10, 1974

Howard Kaibel, Director  
Minnesota Municipal Commission  
304 Capital Square Building  
St. Paul, MN 55101

Dear Mr. Kaibel:

This is to inform you of the City of Mankato's intent to annex the following property:

Twenty (20) acres in the SW $\frac{1}{4}$  of the NW $\frac{1}{4}$  of Section 24, T108N, R27W and the north 135 feet of the west half of the SW $\frac{1}{4}$  of the NW $\frac{1}{4}$  of Section 24, T108N, R27W except the south 35 feet of the east 180 feet. This property is owned by Grandview Memorial Garden.

The property consists of approximately 21 acres of unplatted land which abuts the present City Limits and is at least 60% surrounded by the City. A map is attached.

Sincerely,

Donald J. Steger  
Associate City Planner

DJS/pjs

Enclosure

cc: Secretary of State  
Blue Earth County Auditor  
Clerk of Mankato Township

*Mankato*

February 24, 1975

TO:

The Secretary  
Municipal Commission  
304 Capitol Square Bldg.  
St. Paul, Minnesota 55101

The Secretary of State  
Room 180 - State Office Bldg.  
St. Paul, Minnesota 55101

Milton Owens, County Auditor  
Blue Earth County Court House  
Mankato, Minnesota 56001

Re: Ordinance No. A-75-116 - Annexation by City of Mankato of 21 acre  
tract owned by Grandview Memorial Garden.

Please place on file the attached ordinance which I hereby declare to be a true and exact copy of the original duly adopted by the Council of the City of Mankato at a regular meeting held on February 10, 1975 and which is on file in the office of the City Clerk of Mankato, Blue Earth County, Minnesota.

*Frances Rosevold*

Frances Rosevold, City Clerk  
Mankato, Minnesota 56001

(SEAL)

AFFIDAVIT

STATE OF MINNESOTA )  
                                  ) SS.  
COUNTY OF BLUE EARTH )

CITY OF MANKATO

I, Frances Rosevold, City Clerk in and for the City of Mankato, Minnesota, say and depose that on the 24th day of February, 1975, I mailed a copy of the attached Ordinance Number A-75-116 to annex land by the City of Mankato to the following:

The Secretary  
State Municipal Commission  
304 Capitol Square Bldg.  
St. Paul, Minnesota 55101

The Secretary of State  
Room 180 - State Office Bldg.  
St. Paul, Minnesota 55101

Milton Owens, County Auditor  
Blue Earth County Court House  
Mankato, Minnesota 56001

I further certify that a copy of the Affidavit of Publication of said ordinance was mailed to the Secretary of the Municipal Commission.

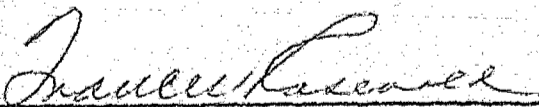
  
Frances Rosevold, City Clerk  
Mankato, Minnesota 56001

Dated this 24th day of February, 1975.

(SEAL)

GRANDVIEW

ORDINANCE NUMBER A-75-116

AN ORDINANCE TO AMEND AN ORDINANCE KNOWN AS CHAPTER 13, UNCODED ORDINANCES IN EFFECT OF THE CITY CODE OF THE CITY OF MANKATO, MINNESOTA

WHEREAS, certain territory described below is not presently included within the corporate limits of any incorporated city, village, or borough; and

WHEREAS, this territory, 60% or more of which is bordered by lands already included within the corporate limits of the City, does not exceed 200 acres; and

WHEREAS, no objections to the annexation have been received from the Town Board, the County Board, or the governing body of any municipality whose boundaries abut upon the boundaries of the land to be annexed:

THE CITY OF MANKATO, MINNESOTA, DOES ORDAIN:

1. That the annexation will be to the best interests of the City and of the land affected;
2. That the land described herein abuts upon the City Limits and is urban in character; and
3. That none of said land is now included within the limits of any city, village, or borough.

The corporate limits of the City are hereby extended to include the unplatted land described as follows and the same is hereby annexed to and included within the City as effectually as if it had originally been part thereof.

The West half of the SW $\frac{1}{4}$  of the NW $\frac{1}{4}$  of Section 24, T108N, R27W containing approximately 20 acres.

The City Clerk is hereby directed to file certified copies of the Ordinance with the Minnesota Municipal Commission, the Secretary of State, the Blue Earth County Auditor, and the Clerk of the Mankato Town Board. This Ordinance shall take effect thirty days (30) after the date of its passage and publication.

*Harold J. ...*  
Mayor

Passed this 10th day of February, 1975.

Attest: *James ...*  
Secretary of the Council

# 27979  
STATE OF MINNESOTA  
DEPARTMENT OF STATE  
FILED  
APR 24 1975  
*Grant Anderson Thore*  
Secretary of State