

Sec. 6

Owned by
Dr. Boyer
7219 2nd Ave East
Duluth Minn

LAKE

Boulder Elm Tree

95076

1240 Rb

Cedar Island

CEDAR

Sec. 7

T. 46. N. R. 27 W.

2759

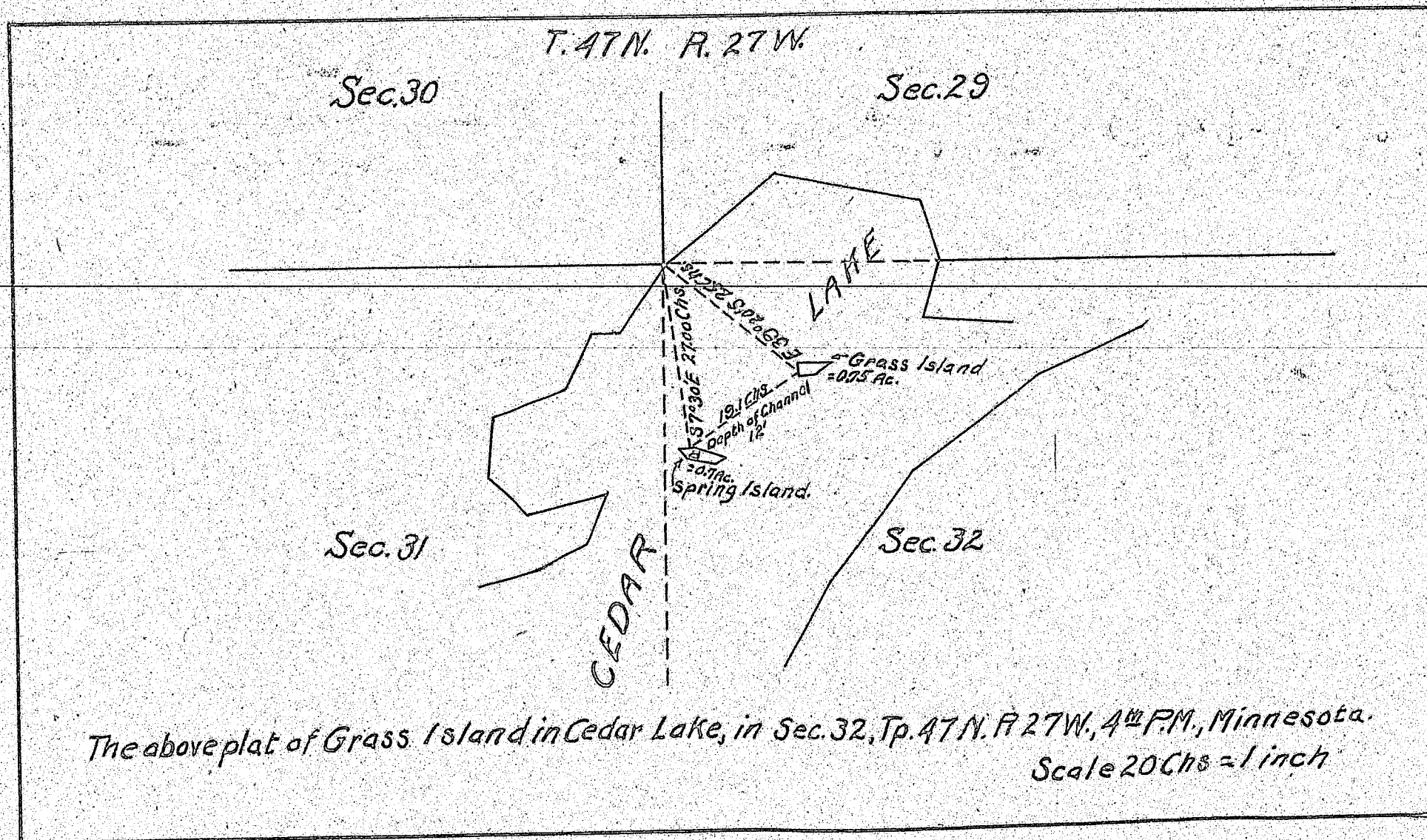

The above plat of Grass Island in Cedar Lake, in Sec. 32, Tp. 47N. R. 27W., 4th P.M., Minnesota.
 Scale 20 Chs = 1 inch

#201, 5, State St.,
Waverly Iowa
Jan., 26 1922

Secretary of State,
Saint Paul Minnesota,
Dear Sir: -

I hereby wish to serve notice that I intend to apply for the survey of Grass Island located in Cedar Lake, Arthur County in Section 32-T47N-R27W; also for the survey of Cedar Island located in Cedar Lake in Section 7-T46N-R27W-4th PM.

I am enclosing blueprints of said islands showing their relative positions. As the General Land Office at Washington desires that I procure an acknowledgment of this notice will you please send me a letter to that effect.

Yours very truly
Arthur P. Beyers.

2759

2759

STATE OF MINNESOTA
DEPARTMENT OF STATE

FILED

JAN 23 1922

W. H. Johnson

Secretary of State