

An Equal Opportunity Employer

Phone: 296-2428



STATE OF MINNESOTA
MUNICIPAL COMMISSION

304 Capitol Square Building
10th & Cedar Streets
St. Paul, Minnesota 55101
Sept. 13, 1974

Miss Carole Grimm, Clerk
City Hall
Rochester, Minnesota 55901

Re: Docket Number A-2582 Ordinance Number 1749

Dear Sir:

The Minnesota Municipal Commission acknowledges receipt and filing of the above Ordinance and filing fee in accordance with Minnesota Statutes, Chapter 414 and the Rules of Procedure.

According to law, this annexation is final upon filing a copy of the ordinance with the Town Clerk, County Auditor and Secretary of State in addition to the Municipal Commission.

Please refer to the above docket and ordinance numbers in any future reference to this annexation.

Sincerely yours,

MUNICIPAL COMMISSION

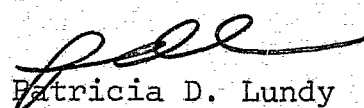
Patricia D. Lundy
Asst. Executive Secretary

PDL/mg

c.c. Secretary of State
County Auditor
Township
Attorney
Municipality

~~27237~~
27237

#1749

State of Minnesota,

County of Olmsted

City of Rochester, SS

I, Carole A. Grimm, City Clerk of the City of Rochester, Minnesota
do hereby certify that I have compared the attached copy of an
ordinance with the original ordinance on file in my office and
that the foregoing is a true and correct copy of the said ordinance
and of the whole thereof.

Witness my hand this 14th day of March, 1974.

City Clerk of Rochester, Minnesota

(Seal of the City of
Rochester, Minnesota)

ORDINANCE NO. 1749
AN ORDINANCE ANNEXING to the City of Rochester, Minnesota, Certain Platted Land Situated in North Sunny Slopes, Olmsted County, Minnesota.

THE COMMON COUNCIL OF THE CITY OF ROCHESTER DO ORDAIN:

Section 1. The City of Rochester, Minnesota, is owner of the land hereinafter described located in Rochester Township, Olmsted County, Minnesota, and which abuts upon the present territorial limits of the City of Rochester:

Lot 44A, North Sunny Slopes, including the easterly half of the road adjacent thereto, according to the plat thereof on file and of record in the office of the Register of Deeds in and for said County.

Section 2. The quantity of land described in Section 1 is approximately 1.09 acres in area.

Section 3. The Common Council of the City of Rochester hereby determined that the land described in Section 1 abuts the present territorial limits of the City of Rochester and is hereby annexed, added to and made a part of the City of Rochester, Minnesota, as effectually as if it had originally been a part hereof.

Section 4. This ordinance shall take effect and be in force from and after its official publication and from and after the filing of a certified copy hereof with the Minnesota Municipal Commission, the Clerk of the Town of Rochester, the Olmsted County Auditor, and the Secretary of State.

Passed and adopted by the Common Council of the City of Rochester, Minnesota, this 21st day of January, 1974.

R. J. POSTIER
President of said
Common Council

Attest:
CAROLE A. GRIMM
City Clerk

Approved this 22nd day of January, 1974.

ALEX P. SMEKTA
Mayor of said City

(Seal of the City of
Rochester, Minnesota)

(2/23 3/2)

#27237

STATE OF MINNESOTA
DEPARTMENT OF STATE
FILED

SEP 19 1974

Allen D. E. Stahl
Secretary of State

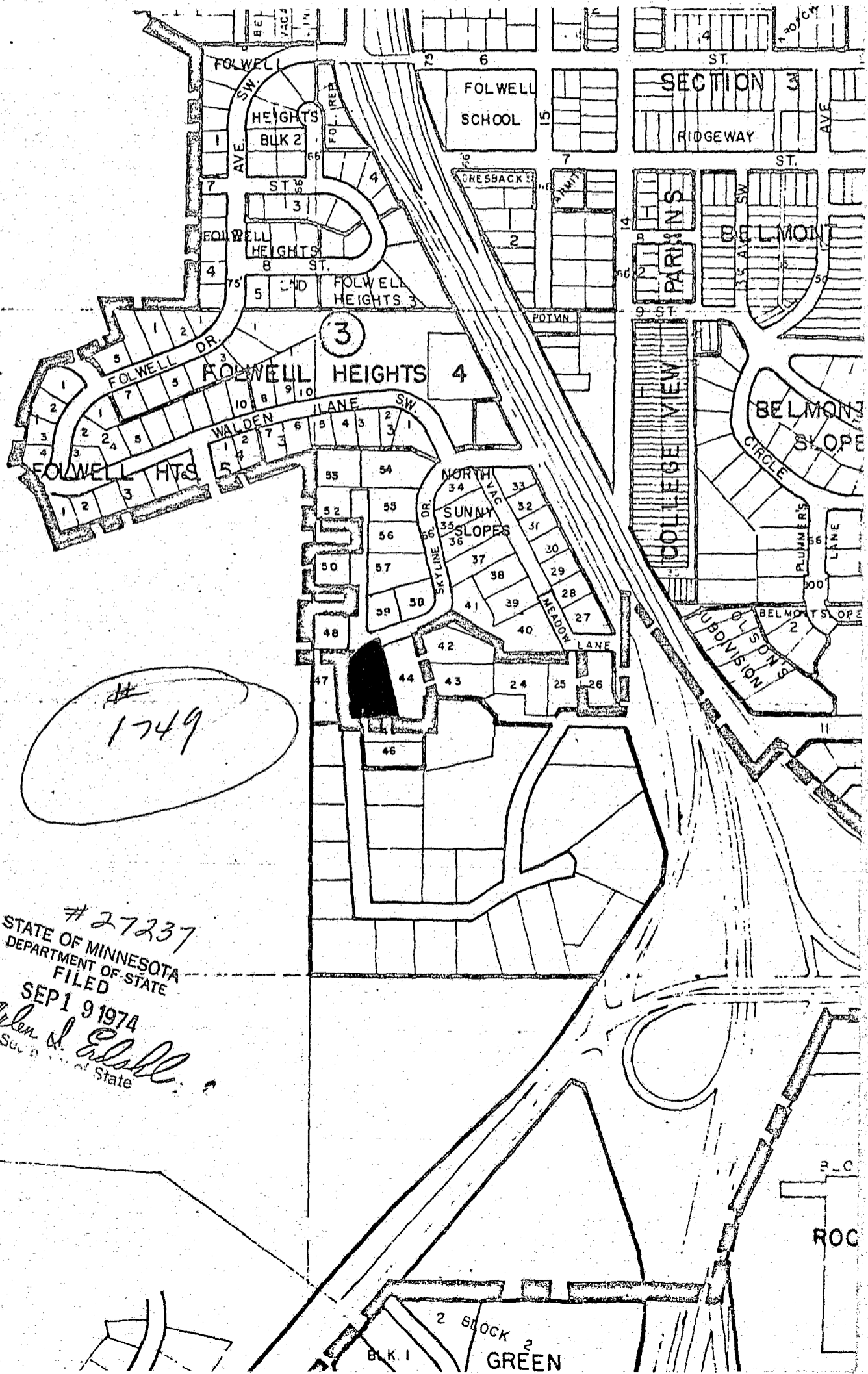

1749

27237
STATE OF MINNESOTA
DEPARTMENT OF STATE
FILED
SEP 19 1974
Allen W. Edsall
Sec. of State

R.C.
ROC

BLK. 1
2 BLOCK 2
GREEN