

An Equal Opportunity Employer

Phone: 296-2428



STATE OF MINNESOTA
MUNICIPAL COMMISSION

304 Capitol Square Building
10th & Cedar Streets
St. Paul, Minnesota 55101
Aug. 12, 1974

Mr. Ronald Klaphake, City Manager
City Hall
Morris, Minn. 56267

Re: Docket Number A-1930 Ordinance Number 332

Dear Sir:

The Minnesota Municipal Commission acknowledges receipt and filing of the above Ordinance and filing fee in accordance with Minnesota Statutes, Chapter 414 and the Rules of Procedure.

According to law, this annexation is final upon filing a copy of the ordinance with the Town Clerk, County Auditor and Secretary of State in addition to the Municipal Commission.

Please refer to the above docket and ordinance numbers in any future reference to this annexation.

Sincerely yours,

MUNICIPAL COMMISSION

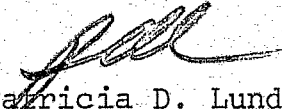
Patricia D. Lundy
Asst. Executive Secretary

PDL/mg

c.c. Secretary of State
County Auditor
Township
Attorney
Municipality

27/31

Morris

A-1930

MAY 16 1974

RESOLUTION CLARIFYING PROPERTY DESCRIPTION IN ORDINANCE NO. 332

WHEREAS, the City of Morris did cause on December 3, 1970, an ordinance to be passed thereby annexing certain properties to said City, and

WHEREAS, the Municipal Commission of the State of Minnesota has requested a clarification of the property described in said ordinance, and

WHEREAS, said Ordinance Number 332 of said City is and remains a true and legal document, and

WHEREAS, the revised property description attached hereto and made a part hereof in no way alters the meaning or intent of said ordinance, nor does it make a change thereto that is of substantive nature, and

WHEREAS, it has been judged by the City's legal counsel to be proper and fitting to use interchangeably the attached clarifying property description for the description in said ordinance;

NOW, THEREFORE BE IT RESOLVED by the Council of the City of Morris that the attached property description be filed with and attached to Ordinance Number 332 to "clarify" the legal description in said ordinance.

BE IT FURTHER RESOLVED that the new property description be submitted to the Municipal Commission as a true and correct description of the property annexed by Ordinance Number 332 and caused to be incorporated as part of the City of Morris in the County of Stevens, State of Minnesota.

Dated this 14th day of May, 1974.

CITY OF MORRIS

ATTEST:

/s/
Chestér Birch, Mayor

/s/
Ronald L. Klaphake, City Manager

Motion to adopt the foregoing was made by Councilman Waddell, seconded by Councilman Klein, with the following voting in favor:

unanimous

opposed:

Certified to be a true copy

/s/
Ronald L. Klaphake, City Manager

#27131
STATE OF MINNESOTA
DEPARTMENT OF STATE
FILED
AUG 20 1974
Allen & ...
Secretary of State

Encl 1

Clarification of Property Description for
Ordinance 332 of the City of Morris, Minnesota

MAY 16 1974

That part of the Southeast Quarter (SE 1/4) of Section 2, Township 124 North, Range 42 West, described as follows:

Beginning at a point 1543.5 feet South of the center of said Section 2, Township 124 N, Range 42 W, which point is the Southwest corner of the Elles Addition to the City of Morris. Thence East along the South boundary of said Elles Addition a distance of 180 feet. Thence South along the East right-of-way line of University Avenue a distance of 316 feet to a point; said point being a point of curvature on the said East right-of-way of University Avenue. Thence continuing on the East right-of-way of said University Avenue along a curve having a radius of 130 feet an arc distance of 126.38 feet, more or less. Thence continuing Southwesterly along the East right-of-way line of said University Avenue a distance of 12 feet to a point; said right-of-way line being tangent to a forementioned curve and perpendicular to the Northeasterly right-of-way line of State Highway No. 9; said point on the Northeasterly right-of-way line of State Highway No. 9. Thence proceeding Northwesterly along the Northeasterly right-of-way line of State Highway No. 9 a distance of 200 feet to the quarter line of said Section 2. Thence North and along the quarter line of said Section 2 a distance of 265.5 feet to the point of beginning, containing 2.82 acres, more or less.

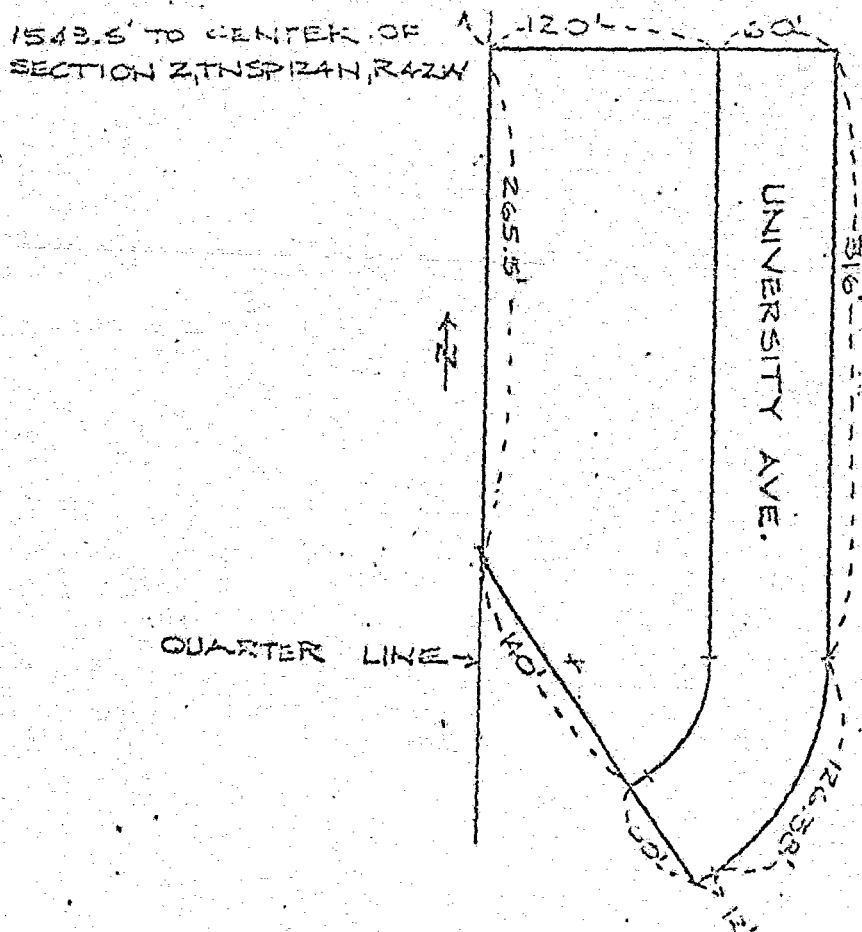

27131
STATE OF MINNESOTA
DEPARTMENT OF STATE
FILED
AUG 20 1974
Allen J. Edsall
Secretary of State