

An Equal Opportunity Employer

Phone: 276-2420



STATE OF MINNESOTA
MUNICIPAL COMMISSION

304 Capitol Square Building
10th & Cedar Streets
St. Paul, Minnesota 55101

April 5, 1974.

Miss Carole Grimm, Clerk
City Hall
Rochester, Minnesota 55901

Re: Docket Number A-2358 Ordinance Number 1746

Dear Sir:

The Minnesota Municipal Commission acknowledges receipt and filing of the above Ordinance and filing fee in accordance with Minnesota Statutes, Chapter 414 and the Rules of Procedure.

According to law, this annexation is final upon filing a copy of the ordinance with the Town Clerk, County Auditor and Secretary of State in addition to the Municipal Commission.

Please refer to the above docket and ordinance numbers in any future reference to this annexation.

Sincerely yours,

MUNICIPAL COMMISSION

Patricia D. Lundy
Asst. Executive Secretary

PDL/mg

c.c. Secretary of State ✓
County Auditor
Township
Attorney
Municipality

26643

ORDINANCE NO. 1745

AN ORDINANCE ANNEXING to the City of Rochester, Minnesota, Certain Unplatted Land Not Exceeding 200 Acres in Area, and Certain Platted Land Situated in Section 12, Township 106 North, Range 14 West, and Section 7, Township 106 North, Range 13 West, Olmsted County, Minnesota, and Establishing the Zoning of Certain Parcels Thereof.

THE COMMON COUNCIL OF THE CITY OF ROCHESTER DO ORDAIN:

Section 1. A petition has been filed with the Common Council of the City of Rochester, signed by a majority of the owners of the land described herein, requesting the Common Council to annex said land to the City of Rochester. The land described in said petition for annexation is located in Rochester Township and Marlon Township, Olmsted County, Minnesota, and is described as follows:

Commencing at the northeast corner of Section 12, Township 106 North, Range 14 West; thence west along the north line of said section a distance of 469.30 feet to its intersection with the centerline of Trunk Highway No. 20 (now U.S. 52); thence southeasterly along the centerline of said Trunk Highway No. 20 (now U.S. 52), a distance of 251.25 feet to the point of beginning; thence southeasterly along the centerline of said Trunk Highway No. 20 (now U.S. 52) to its intersection with the south line of the northwest quarter of the northwest quarter of Section 7, Township 106 North, Range 13 West; thence east along the south line of the northwest quarter of the northwest quarter of Section 7 a distance of 1110.19 feet to the southeast corner of the northwest quarter of the northwest quarter of Section 7; thence north along the east line of the northwest quarter of the northwest quarter of Section 7 to the northeast corner of said northwest quarter of the northwest quarter of Section 7 which is the centerline of Eastwood Road S.E.; thence west along the centerline of Eastwood Road S.E. a distance of 181.4 feet; thence south a distance of 329.4 feet; thence west a distance of 1057.92 feet to its intersection with the west line of Section 7, Township 106 North, Range 13 West; thence north along the west line of said Section 7 a distance of 95.0 feet to a point that is 234.4 feet south of the north line of said Section 7; thence west 378.4 feet to the place of beginning.

Said petition has also been filed with the Town Board of Rochester and Marion Townships, with the County Board of the County of Olmsted, and with the Minnesota Municipal Commission and more than 60 days have elapsed since said petition was filed with the Town Board and no objections to annexation of the above described land have been filed by said Town Boards with the Minnesota Municipal Commission.

Section 2. The quantity of platted land included in said petition is approximately 3.25 acres and the quantity of unplatted land is approximately 31.82 acres.

Section 3. The Common Council of the City of Rochester does hereby determine that the land described in Section 1 abuts upon the present territorial limits of the City of Rochester, is so conditioned as to be properly subject to municipal government, and the annexation of said land will be in the best interest of the City of Rochester and the land affected.

Section 4. Therefore, the land described in Section 1 above is hereby annexed, added to and made a part of the City of Rochester, Minnesota, as effectually as if it had originally been a part thereof.

Section 5. Present and future owners of the area annexed by this ordinance are hereby notified that in addition to the usual assessments, it is the intention of the Common Council to assess against benefited property all or a portion of the cost of any storm sewer, water tower and trunk line sanitary sewer construction heretofore or hereafter undertaken to serve the area annexed.

Section 6. Pursuant to Rochester Code of Ordinances, No. 60,506, as enacted by Ordinance No. 1659, known as the Zoning Ordinance of the City of Rochester, the land annexed to the City of Rochester as hereinafter described is zoned as B-1b Neighborhood Business District:

Commencing at the northeast corner of Section 12, Township 106 North, Range 14 West; thence west along the north line of said section a distance of 469.30 feet to its intersection with the centerline of Trunk Highway No. 20 (now U.S. 52); thence southeasterly along the centerline of said Trunk Highway No. 20 (now U.S. 52) a distance of 251.25 feet to the place of beginning; thence southeasterly along the centerline of said Trunk Highway No. 20 (now U.S. 52) a distance of 319.0 feet; thence northeasterly a distance of 329.4 feet; thence northwesterly a distance of 177.32 feet to the east line of Section 12, Township 106 North, Range 14 West; thence north along the east line of said Section 12 a distance of 121.2 feet; thence west a distance of 378.4 feet to the place of beginning.

Section 7. This ordinance shall take effect and be in force from and after its official publication and from and after the filing of a certified copy hereof with the Minnesota Municipal Commission, the Rochester and Marion Township Clerks, the County Auditor and the Secretary of State.

Passed and adopted by the Common Council of the City of Rochester, Minnesota, this 21st day of January 1973.

R. J. POSTIER
President of said Common Council

ATTEST: Carole A. Grimm
City Clerk

Approved this 22nd day of January, 1973.

ALEX P. SMEKTA
Mayor of said City
City of Rochester, Minnesota

#1746

State of Minnesota,

County of Olmsted

City of Rochester, SS

I, Carole A. Grimm, City Clerk of the City of Rochester, Minnesota
do hereby certify that I have compared the attached copy of an
ordinance with the original ordinance on file in my office and
that the foregoing is a true and correct copy of the said ordinance
and of the whole thereof.

Witness my hand this 14th day of March, 1974.

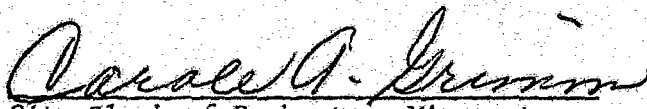
City Clerk of Rochester, Minnesota

(Seal of the City of
Rochester, Minnesota)

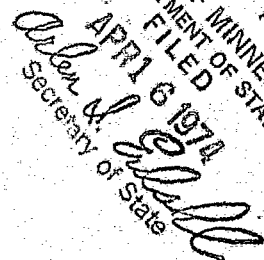
26643
STATE OF MINNESOTA
DEPARTMENT OF STATE
FILED
APR 16 1974

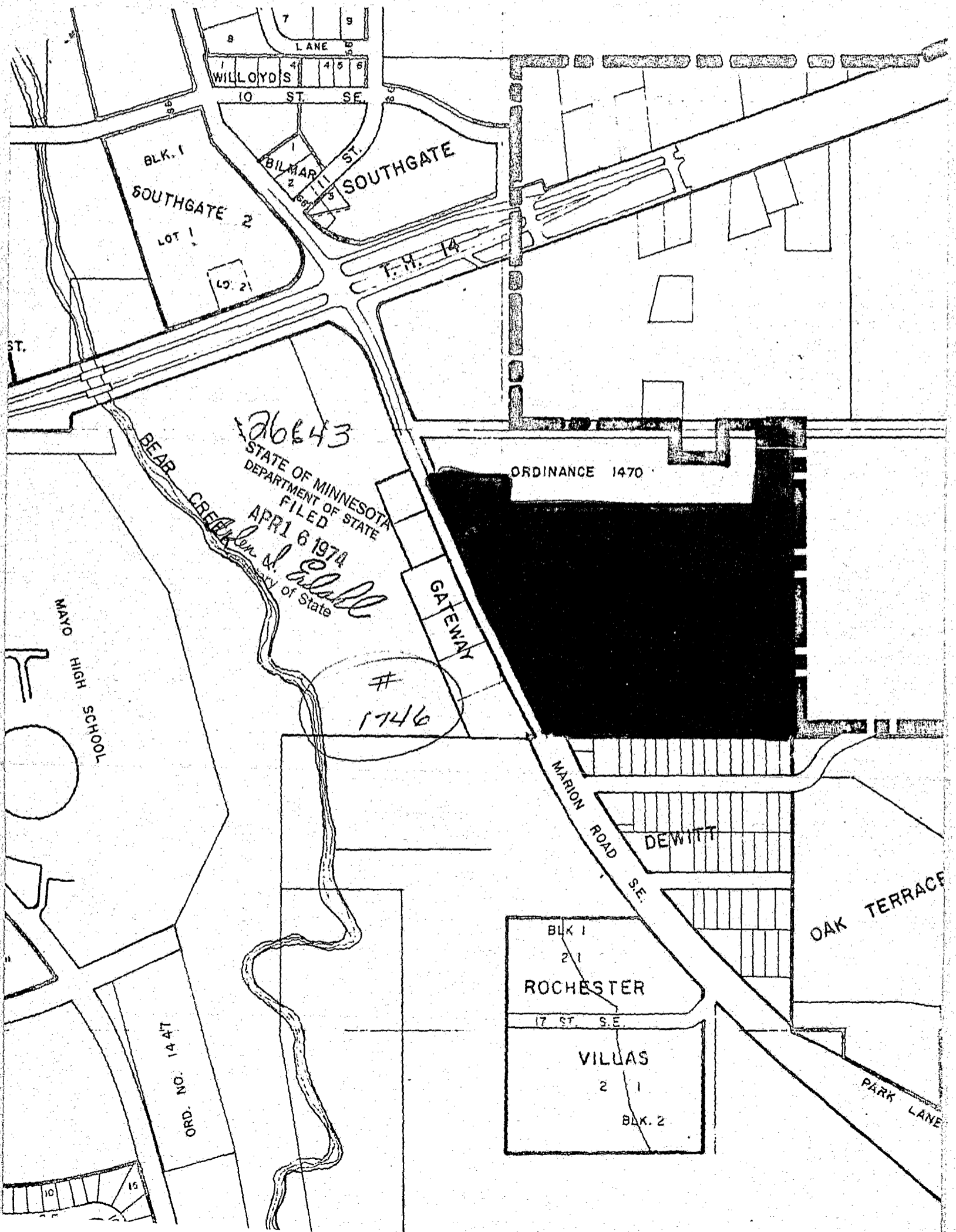
Secretary of State



26643
STATE OF MINNESOTA
DEPARTMENT OF STATE
FILED
APR 6 1974
Charles S. Hall
Secretary of State

ORDINANCE 1470

1746

WAYNE O
HIGH SCHOOL

ORD. NO. 147

BLK 1
21
ROCHESTER

17 ST. S.E.

VILLAS
2 1
BLK. 2

OAK TERRACE

PARK LANE

BLK. 1
SOUTHGATE 2
LOT 1

BILMAR ST.
SOUTHGATE

T.H. 14

GATEWAY

MARION ROAD SE

DEWITT

WILLOYD'S

LANE

10 ST. S.E.

ST.