



396
Phone: 629-2420

STATE OF MINNESOTA
MUNICIPAL COMMISSION

304 Capitol Square Building
10th & Cedar Streets
St. Paul, Minnesota 55101
Dec. 19, 1973

Ms. Carole A. Grimm, Clerk
City Hall
Rochester, Minnesota 55901

Re: Docket Number A-2460 Ordinance Number 1734

Dear Sir:

The Minnesota Municipal Commission acknowledges receipt and filing of the above Ordinance and filing fee in accordance with Minn. Statutes, Chapter 414 and the Rules of Procedure.

According to law, this annexation is final upon filing a copy of the ordinance with the Town Clerk, County Auditor and Secretary of State in addition to the Municipal Commission.

Please refer to the above docket and ordinance numbers in any future reference to this annexation.

Sincerely yours,

MUNICIPAL COMMISSION

A handwritten signature in cursive script, reading "Patricia D. Lundy".

Patricia D. Lundy
Asst. Executive Secretary

PDL/mg

c.c. Secretary of State
County Auditor
Township
Attorney
Municipality

26130
RECEIVED

DEC 27 1973

SECRETARY OF STATE
CORPORATION DIVISION

ORDINANCE NO. 1734
AN ORDINANCE ANNEXING to the City of Rochester, Minnesota, Certain Unplatted Land Not Exceeding 200 Acres in Area Situated in Section 15, Township 107 North, Range 14 West, Olmsted County, Minnesota.

THE COMMON COUNCIL OF THE CITY OF ROCHESTER DO ORDAIN:

Section 1. A petition has been filed with the Common Council of the City of Rochester, signed by a majority of the owners of the land described herein, requesting the Common Council to annex said land to the City of Rochester. The land described in said petition for annexation is located in Cascade Township, Olmsted County, Minnesota, and is described as follows:

That part of the southwest quarter of the southeast quarter of Section 15, Township 107 North, Range 14 West of the Fifth Principal Meridian Olmsted County, Minnesota, described as follows:

Commencing at the southwest corner of the southeast quarter of said Section 15; thence northerly along the west line of said southeast quarter 533.00 feet to the point of beginning; thence easterly, parallel with the south line of said southeast quarter 1016.00 feet; thence southerly, parallel with said west line of southeast quarter 533.00 feet to a point in said south line of southeast quarter; thence easterly along said line a distance of 93.00 feet; thence northerly, parallel with said west line of southeast quarter 533.00 feet; thence westerly parallel with the south line of said southeast quarter 1114.00 feet; thence southerly along the west line of said southeast quarter 50.00 feet to the point of beginning; subject to 18th Avenue N.W. over the westerly side thereof and subject to 41st Street N.W. over the southerly side thereof. Said petition has also been filed with the Town Board of Cascade Township, with the County Board of the County of Olmsted, and with the Minnesota Municipal Commission, and more than 60 days have elapsed since said petition was filed with the Town Board and no objections to annexation of the above described land have been filed by said Town Board with the Minnesota Municipal Commission.

Section 2. The quantity of unplatted land included in said petition is approximately 2.48 acres.

Section 3. The Common Council of the City of Rochester does hereby determine that the land described in Section 1 abuts upon the present territorial limits of the City of Rochester, is so conditioned as to be properly subjected to municipal government, and the annexation of said land will be in the best interest of the City of Rochester and the land affected.

Section 4. Therefore, the land described in Section 1 above is hereby annexed, added to and made a part of the City of Rochester, Minnesota, as effectually as if it had originally been a part thereof.

Section 5. Present and future owners of the area annexed by this ordinance are hereby notified that in addition to the usual assessments, it is the intention of the Common Council to assess against benefited property all or a portion of the cost of any storm sewer, water tower and trunk line sanitary sewer construction heretofore or hereafter, undertaken to serve the area annexed.

Section 6. This ordinance shall take effect and be in force from and after its official publication and from and after the filing of a certified copy hereof with the Minnesota Municipal Commission, the Cascade Township Clerk, the County Auditor and the Secretary of State.

Passed and adopted by the Common Council of the City of Rochester, Minnesota, this 5th day of November, 1973.

R. J. POSTIER
President of said
Common Council

Attest:
Carle A. Grimm
City Clerk

Approved this 6th day of November,
1973.

ALEX P. SIMEKTA
Mayor of said City
(Seal of the City of
Rochester, Minnesota)
(11/10 11/17)

#1734

State of Minnesota,
County of Olmsted,
City of Rochester, SS

I, Carole A. Grimm, City Clerk of the City of Rochester,
Minnesota do hereby certify that I have compared the attached
copy of an ordinance with the original ordinance on file in
my office and that the foregoing is a true and correct copy
of the said ordinance and of the whole thereof.

Witness my hand this 15th day of November, 1973.

Carole A. Grimm
City Clerk of Rochester, Minnesota

(Seal of the City of
Rochester, Minnesota)

#26130
STATE OF MINNESOTA
DEPARTMENT OF STATE
FILED
DEC 27 1973
Arlen J. Edsall
Secretary of State

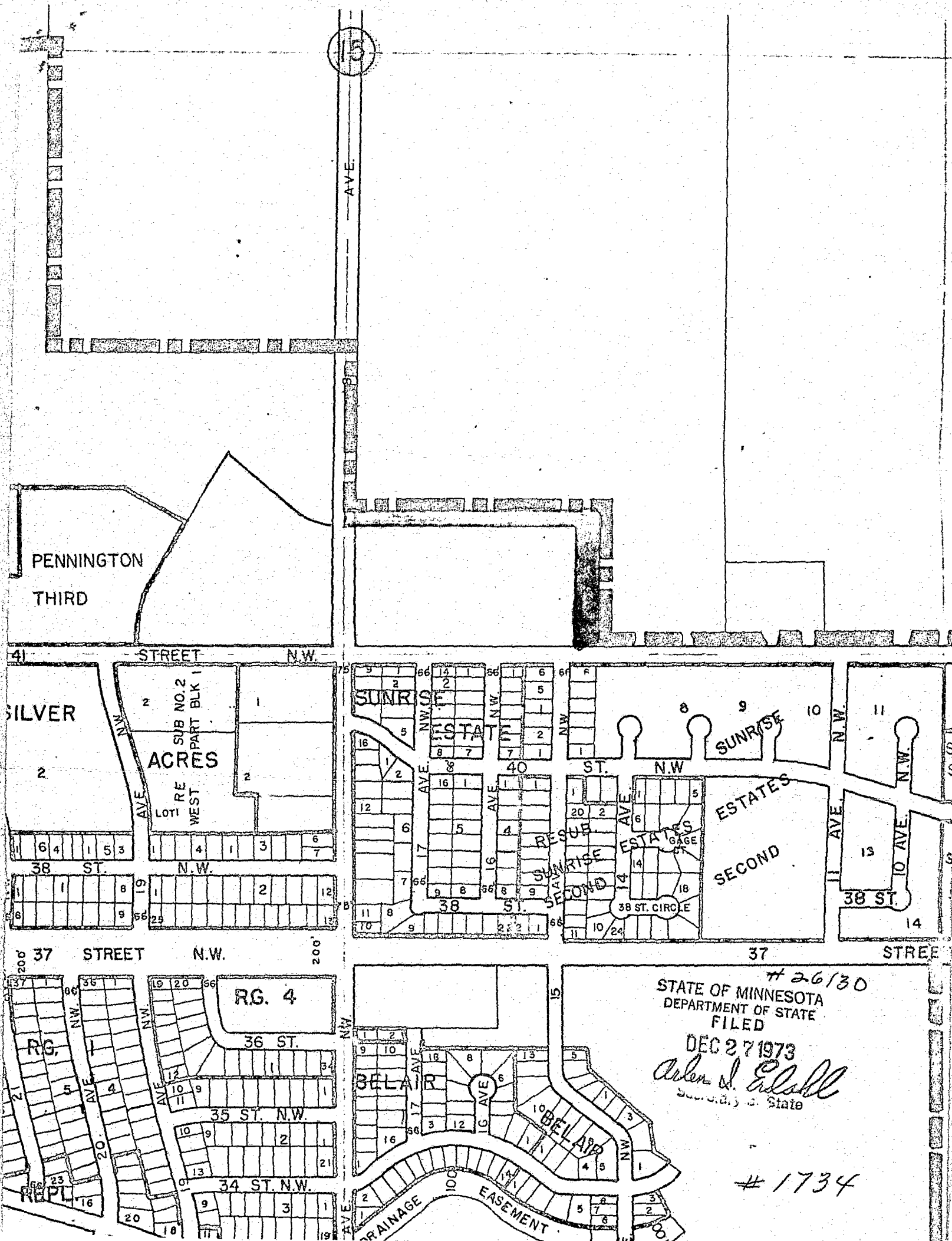

26130
STATE OF MINNESOTA
DEPARTMENT OF STATE
FILED
DEC 27 1973
Arden J. Edsall
Secretary of State

1734