



Phone: 221-2428

STATE OF MINNESOTA  
MUNICIPAL COMMISSION

304 Capitol Square Building  
10th & Cedar Streets  
St. Paul, Minnesota 55101

April 13, 1973

Mr. John S. Carter, Clerk  
City Hall 207 Lafayette St.  
Winona, Minnesota 55987

Re: Docket Number A-2295 Ordinance Number 2246

Dear Sir:

The Minnesota Municipal Commission acknowledges receipt and filing of the above Ordinance and filing fee in accordance with Minn. Statutes, Chapter 414 and the Rules of Procedure.

According to law, this annexation is final upon filing a copy of the ordinance with the Town Clerk, County Auditor and Secretary of State in addition to the Municipal Commission.

Please refer to the above docket and ordinance numbers in any future reference to this annexation.

Sincerely yours,

MUNICIPAL COMMISSION

  
Howard L. Kaibel, Jr.  
Executive Secretary

HLK/mg

c.c. Secretary of State  
County Auditor  
Township  
Attorney  
Municipality

25174



# City of Winona

MINNESOTA 55987

CITY BUILDING • 207 LAFAYETTE STREET

April 5, 1973

Hon. Arlen I. Erdahl  
Secretary of State  
St. Paul, Minnesota 55101

Dear Sir:

Enclosed find a certified copy of ordinance number 2246 adopted by the City Council of Winona extending the corporate limits of the City of Winona to include certain unincorporated land, pursuant to a petition by the Winona Warehouse Corp. A map is also enclosed showing the parcel in relationship to the City. A copy of each will also be filed with the Municipal Commission, the County Auditor, the Township Clerk and the Village of Goodview, as required by law.

Sincerely yours,

*John S. Carter*  
John S. Carter  
City Clerk

JSC:me

Enclosures

#25174  
STATE OF MINNESOTA  
DEPARTMENT OF STATE  
FILED  
APR 19 1973  
*Arlen I. Erdahl*  
Secretary of State

GATEWAY TO THE TEN THOUSAND LAKES THROUGH THE BEAUTIFUL HIAWATHA VALLEY

UNLIMITED RECREATION AREA — THREE COLLEGES — LIGHT AND HEAVY INDUSTRY — AIR TRANSPORTATION — FIVE RAILROADS — SEVEN TRUCKING COMPANIES — INLAND WATERWAYS TRANSPORTATION ON THE MIGHTY MISSISSIPPI

STATE OF MINNESOTA )  
County of Winona ) ss

I, John S. Carter, City Clerk in and for the City of Winona, county and state aforesaid, do hereby certify that I have the care and custody of the ordinances adopted by the City Council of said City; that the annexed and foregoing ordinance is a true, correct and compared copy of the original thereof as adopted by said City Council on the 2nd day of April, 1973, numbered 2246 and published in the official news paper of the City on April 4, 1973, and now in full force and effect.

IN WITNESS WHEREOF, I have hereunto set my hand and the seal of said City of Winona, Minnesota, this 5th day of April, 1973.

John S. Carter  
City Clerk

# 25174  
STATE OF MINNESOTA  
DEPARTMENT OF STATE  
FILED  
APR 19 1973  
Arlen J. Ershel  
Secretary of State

(Pub. Wednesday, April 4, 1973)

Ordinance No. 2246

**AN ORDINANCE EXTENDING THE CORPORATE LIMITS OF THE CITY OF WINONA, MINNESOTA, TO INCLUDE CERTAIN UNINCORPORATED, UNPLATTED LAND ABUTTING UPON THE CITY LIMITS**

WHEREAS, Winona Warehouse Corporation, a Minnesota corporation, sole owner of the real estate described herein, petitioned the Municipal Commission of the State of Minnesota for Annexation of certain land to the City of Winona; and

WHEREAS, the City Council of the City of Winona, Minnesota, did on October 16, 1972, pass a resolution approving the said Annexation, and

WHEREAS, it has been made to appear to the satisfaction of the City Council that the Village of Goodview, the Township of Winona, the County of Winona and the said Municipal Commission have approved said Annexation, and

WHEREAS, said real estate is described as follows:

A parcel of land located in Lots Seven (7), Eight (8) and Eleven (11), Subdivision of Section Twenty (20), Township One Hundred Seven (107) North, of Range Seven (7), West being in the East one-half of the Southwest Quarter (E½ of SW¼) of Section Twenty (20), Township One Hundred Seven (107) North, Range Seven (7), West of the Fifth Principal Meridian, more particularly described as follows to-wit: Commencing at the Southeast corner of the Northeast Quarter of the Southwest Quarter (NE¼ of SW¼) of Section Twenty (20), Township One Hundred Seven (107) North, of Range Seven (7), West; thence West along the South line of the Northeast Quarter of the Southwest Quarter (NE¼ of SW¼) of said Section 20 a distance of 379.80 feet to the Westerly right of way line of Trunk Highway No. 14 for a point of beginning; thence Southwesterly along the Westerly right of way line of Trunk Highway No. 14 a distance of 690 feet more or less to its intersection with the Easterly right of way line of Gilmore Valley Creek said point being on a curve having a radius of 688.51 feet and a central angle of 37°00'; thence northerly along the easterly right of way line of Gilmore Valley Creek and along said curve an arc length of 116.60 feet to the point of tangency of said curve; thence along the tangent of above mentioned curve on a bearing of North 1°26' East and along the easterly right of way line of Gilmore Valley Creek, a distance of 540.70 feet to the point of tangential curve to the West said curve having a radius of 768.51 feet and a central angle of 45°00'; thence northwesterly along the easterly right of way line of Gilmore Valley Creek and along the above mentioned curve an arc length of 742.24 feet; thence North 2°55' East a distance of 405.84 feet to the Southerly right of way line of Gilmore Valley Creek; thence South 55°19' East along the southerly right of way line of Gilmore Valley Creek a distance of 886.80 feet to a point of tangential curve to the north having a radius of 433.10 feet and a central angle of 47°43'; thence northeasterly along the southeasterly right of way line of Gilmore Valley Creek and along the above mentioned curve an arc length of 295 feet to the westerly right of way line of Proposed Trunk Highway No. 14; thence South 34°02' West and along the westerly right of way of Trunk Highway No. 14 a distance of 704.90 feet to the point of beginning, containing 14.35 acres, more or less, and

WHEREAS, the petition was signed by the owner and no objections to the Annexation have been received from any source and said real estate abuts upon the City of Winona limits at the Westerly boundary thereof, and

WHEREAS, the desirability of Annexing said land has been carefully considered,

NOW THEREFORE, the City of Winona, Minnesota, does ordain:

Section 1. The City Council hereby determines (1) that the Annexation will be to the best interests of the City and the territory affected; (2) that the territory described herein abuts upon the city limits and is urban or suburban in character; and (3) none of said territory is now included within the limits of any city, village or borough.

Section 2. The corporate limits of the City are hereby extended to include the unplatted land described above, and the same is hereby annexed to and included within the city as effectually as if it had originally been a part thereof.

Section 3. The City Clerk is hereby directed to file certified copies of this ordinance with the Minnesota Municipal Commission, the Secretary of State, the County Auditor and Town Board of Winona Township.

Section 4. This ordinance shall take effect upon its publication.

Dated at Winona, Minnesota, this 2nd day of April, 1973.

NORMAN E. INDALL  
Mayor

Attested by:  
JOHN S. CARTER  
City Clerk

# 25174  
STATE OF MINNESOTA  
DEPARTMENT OF STATE  
FILED  
APR 19 1973  
Arden J. Erdahl  
Secretary of State

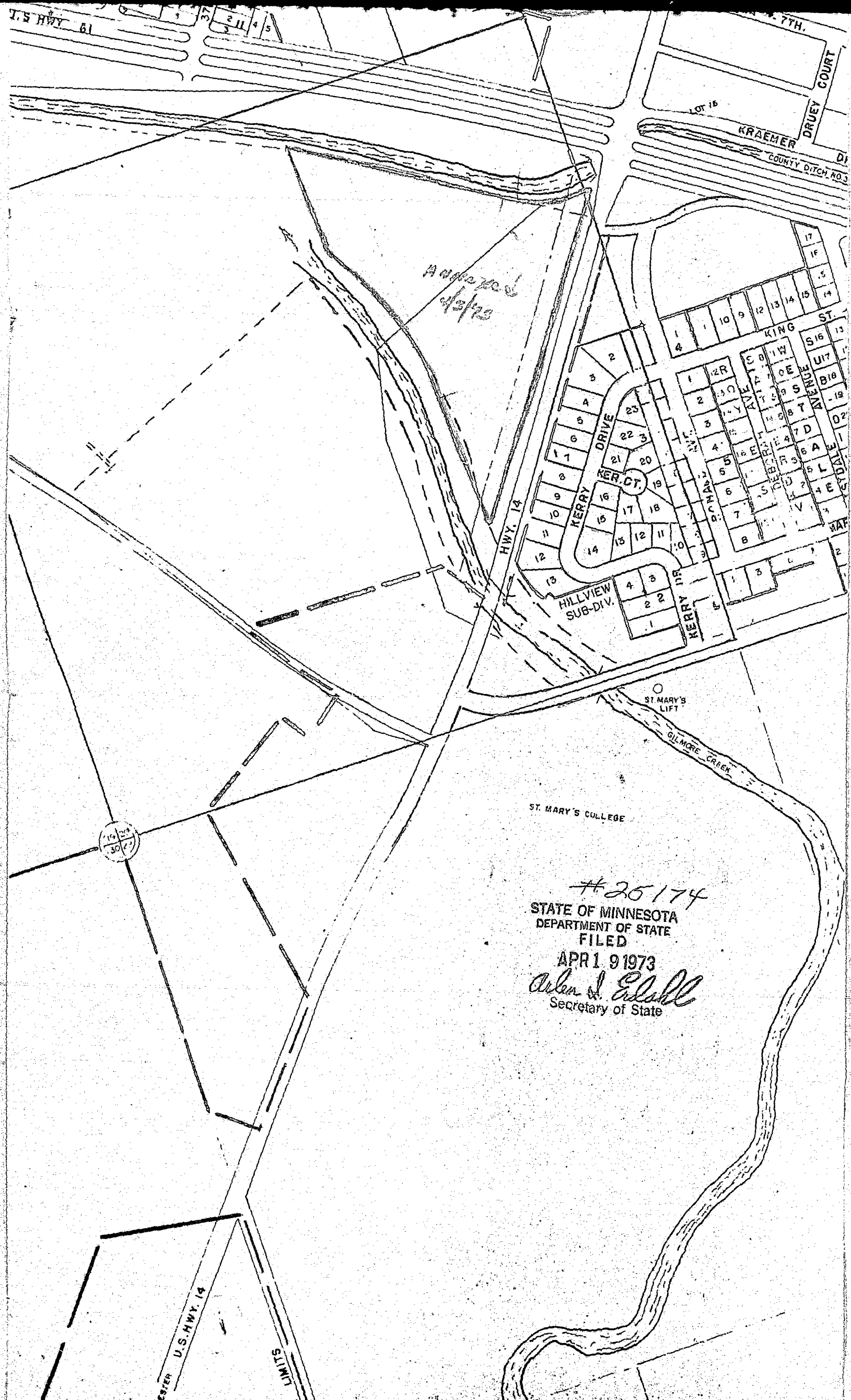

*Approved  
4/3/73*

19

ST. MARY'S COLLEGE

ST. MARY'S LIFT

GILMORE CREEK

#25174  
STATE OF MINNESOTA  
DEPARTMENT OF STATE  
FILED  
APR 19 1973  
*Allen J. Erdahl*  
Secretary of State

NESTER U.S. HWY. 14

E LIMITS

T.S. HWY. 61

7TH.

KRAEMER

DRUEY COURT

COUNTY DITCH NO. 3

KING ST.

KERRY CT.

HILLVIEW SUB-DIV.

HWY. 14

KERRY DRIVE

W. AVENUE

DOE

W. AVENUE

W. AVENUE

W. AVENUE

W. AVENUE

W. AVENUE

W. AVENUE

W. AVENUE

W. AVENUE

W. AVENUE

W. AVENUE

W. AVENUE

W. AVENUE

W. AVENUE

W. AVENUE

W. AVENUE

W. AVENUE

W. AVENUE

W. AVENUE

W. AVENUE

W. AVENUE

W. AVENUE

W. AVENUE

W. AVENUE

W. AVENUE

W. AVENUE

W. AVENUE

W. AVENUE

W. AVENUE

W. AVENUE

W. AVENUE

W. AVENUE

W. AVENUE

W. AVENUE