



296
Phone: 221-2420

STATE OF MINNESOTA
MUNICIPAL COMMISSION

304 Capitol Square Building
10th & Cedar Streets
St. Paul, Minnesota 55101

April 13, 1973

Francis B. Duben, Clerk
Village Hall
Lonsdale, Minnesota 55046

Re: Docket Number A-2304 Ordinance Number 56
amending Ordinance No. 56

Dear Sir:

The Minnesota Municipal Commission acknowledges receipt and filing of the above Ordinance and filing fee in accordance with Minn. Statutes, Chapter 414 and the Rules of Procedure.

According to law, this annexation is final upon filing a copy of the ordinance with the Town Clerk, County Auditor and Secretary of State in addition to the Municipal Commission.

Please refer to the above docket and ordinance numbers in any future reference to this annexation.

Sincerely yours,

MUNICIPAL COMMISSION

Howard L. Kaibel, Jr.
Executive Secretary

HLK/mg

c.c. Secretary of State
County Auditor
Township
Attorney
Municipality

25172

EUGENE A. SMITH
EUGENE J. CROSBY

Lonsdale
PHONE 224-6481

SMITH & CROSBY
ATTORNEYS AT LAW
212 CENTRAL AVENUE
FARIBAULT, MINNESOTA 55021

March 12, 1973

State of Minnesota
Municipal Commission
304 Capitol Square Building
10th & Cedar Streets
St. Paul, Minnesota 55101

Re: Docket Number 2304
Ordinance Number 56

ATTENTION: Mr. Howard L. Kaibel, Jr.
Executive Secretary

Dear Mr. Kaibel:

In accordance with your letter of February 8, 1973, I herewith enclose original Amended Ordinance No. 56. This Amended Ordinance contains the corrected description as to the area annexed to the Village of Lonsdale. Filing fees have previously been paid.

Very truly yours,

Eugene J. Crosby

EJC:amr
encl.

cc: Secretary of State
State Capitol Building
St. Paul, Minnesota 55101

Mr. Ervin Boelke
County Auditor
Rice County Courthouse
Faribault, Minnesota 55021

AMENDED
ORDINANCE NO. 56

An ordinance extending the corporate limits of the Village of Lonsdale to include certain unincorporated territory 60 per cent or more surrounded (boardered) by land within the Village limits and abutting thereon.

WHEREAS, certain territory described below is not presently included within the corporate limits of any incorporated city, village or bourough; and

WHEREAS, 60 per cent or more of the perimeter of this territory is bordered by lands already included within the corporate limits of the Village of Lonsdale and is deemed to be urban in character;

The Village Council of Lonsdale, Minnesota, ordains:

Section 1. Territory Annexed. The corporate limits of the Village of Lonsdale, are hereby extended to include the unplatted territory described as follows, with 60 per cent or more of the perimeter of which territory is boardered, by territory already included within the village limits:

All that part of the SW 1/4 of the NW 1/4 of Sec. 25, Township 112, North, Range 22 West of the 5th Principle Meridian described as follows, to-wit: Beginning at a point where the S 1/4 Section Line of the SW 1/4 of the NW 1/4 of said Section 25 intersects the South Line of Minnesota Trunk Hwy. No. 19; thence West along the South Line of the said SW 1/4 of the NW 1/4 of said Section 25 to the West Line of Section 25; thence Northerly along the West Line of Section 25 to the South Edge of Minnesota State Trunk Highway No. 19; thence Southeasterly along the South Edge of Trunk Highway No. 19 to the point of beginning.

Section 2. Filing. The Village Clerk is directed to file certified copies of this Ordinance with the Secretary of State, the County Auditor of Rice County, Minnesota and the Minnesota Municipal Commission.

Section 3. Effective Date of Annexation. This ordinance takes effect upon passage and publication and the filing of certified copies as directed in Section 2, and upon passage and publication.

Adopted by the Village Council of Lonsdale, Minnesota, this 1th day of February, 1973.

Attest:

Francis Duban, Clerk
Village of Lonsdale, Minn.

Robert J. Novak, Mayor
Village of Lonsdale, Minn.

25172
STATE OF MINNESOTA
DEPARTMENT OF STATE
FILED
APR 19 1973
Arlen J. Edsell
Secretary of State

ORDINANCE NO. 56

An ordinance extending the corporate limits of the Village of Lonsdale to include certain unincorporated territory 60% or more surrounded (boardered) by land within the Village limits and abutting thereon.

WHEREAS, certain territory described below is not presently included within the corporate limits of any incorporated city, village or bourough; and

WHEREAS, 60 per cent or more of the perimeter of this territory is bordered by lands already included within the corporate limits of the Village of Lonsdale and is deemed to be urban in character;

The Village Council of Lonsdale, Minnesota, ordains:

Section 1. Territory Annexed. The corporate limits of the Village of Lonsdale, are hereby extended to include the unplatted territory described as follows, with 60 per cent or more of the perimeter of which territory is boardered, by territory already included within the village limits:

(SEE EXHIBIT "A" ATTACHED HERETO AND MADE A PART HEREOF)

Section 2. Filing. The Village Clerk is directed to file certified copies of this Ordinance with the Secretary of State, the County Auditor of Rice County, Minnesota and the Minnesota Municipal Commission.

Section 3. Effective Date of Annexation. This ordinance takes effect upon passage and publication and the filing of certified copies as directed in Section 2., and upon passage and publication.

Adopted by the Village Council of Lonsdale, Minnesota, this 28th day of September, 1972.

Attest:

Francis Duban
Francis Duban, Clerk
Village of Lonsdale, Minn.

Robert J. Novak
Robert J. Novak, Mayor
Village of Lonsdale, Minn.

#25172
STATE OF MINNESOTA
DEPARTMENT OF STATE
FILED
APR 19 1973
Allen J. Edlund
Secretary of State

Abstract of Title

*The following described Real Estate situated in
the County of Rice, State of Minnesota*

ALL THAT PART OF THE SOUTHWEST QUARTER (SW $\frac{1}{4}$) OF THE NORTHWEST QUARTER (NW $\frac{1}{4}$) OF SECTION 25, AND ALL THAT PART OF THE SOUTHEAST QUARTER (SE $\frac{1}{4}$) OF THE NORTHEAST QUARTER (NE $\frac{1}{4}$) OF SECTION 26 IN THE LIMITS OF THE VILLAGE OF LONSDALE, RICE COUNTY, MINNESOTA, ALL IN TOWNSHIP 112 NORTH, RANGE 22 WEST OF THE FIFTH PRINCIPAL MERIDIAN, DESCRIBED AS FOLLOWS, TO-WIT: BEGINNING AT A POINT WHERE THE SOUTH QUARTER SECTION LINE OF THE SOUTHWEST QUARTER (SW $\frac{1}{4}$) OF THE NORTHWEST QUARTER (NW $\frac{1}{4}$) OF SAID SECTION 25 INTERSECTS THE SOUTH LINE OF MINNESOTA STATE TRUNK HIGHWAY NO. 19; THENCE WEST, ALONG THE SOUTH LINE OF THE SAID SOUTHWEST QUARTER (SW $\frac{1}{4}$) OF THE NORTHWEST QUARTER (NW $\frac{1}{4}$) OF SAID SECTION 25 AND ALONG THE SOUTH LINE OF THE SOUTHEAST QUARTER (SE $\frac{1}{4}$) OF THE NORTHEAST QUARTER (NE $\frac{1}{4}$) OF SAID SECTION 26 TO A POINT 200 FEET EAST OF THE EAST LINE OF THIRD AVENUE EAST IN PATRICK J. WILBY'S ADDITION TO LONSDALE, RICE COUNTY, MINNESOTA; THENCE NORTH, PARALLEL WITH THE SAID EAST LINE OF SAID THIRD AVENUE EAST A DISTANCE OF 108 FEET; THENCE WEST, PARALLEL WITH THE SOUTH LINE OF THE SAID SOUTHEAST QUARTER (SE $\frac{1}{4}$) OF THE NORTHEAST QUARTER (NE $\frac{1}{4}$) OF SAID SECTION 26 A DISTANCE OF 200 FEET TO THE EAST LINE OF SAID THIRD AVENUE EAST; THENCE NORTH, ALONG THE EAST LINE OF SAID THIRD AVENUE EAST A DISTANCE OF ^{ABOUT} 113 FEET TO A POINT 66 FEET EAST OF THE SOUTHEAST (SE) CORNER (COR) OF LOT 7 IN BLOCK 4 IN PATRICK J. WILBY'S ADDITION TO LONSDALE, RICE COUNTY, MINNESOTA; THENCE EAST 140 FEET; THENCE NORTH 100 FEET; THENCE EAST TO THE SOUTHWESTERLY LINE OF SAID MINNESOTA STATE



STATE OF MINNESOTA)
COUNTY OF RICE)SS
VILLAGE OF LONSDALE)

I, the undersigned Village Clerk of the Village of Lonsdale, Rice County, Minnesota, hereby certify that I have carefully compared the attached Ordinance with the original thereof and the same is a full, true and complete transcript therefrom as it relates to annexation by the Village of Lonsdale, Minnesota.

WITNESS MY HAND and the Village Seal this 5th day of OCTOBER, 1972.

Francis Duban

Francis Duban
Village Clerk
Lonsdale, Minnesota

(S E A L)

#25172
STATE OF MINNESOTA
DEPARTMENT OF STATE
FILED
APR 19 1973
Allen J. Edall
Secretary of State

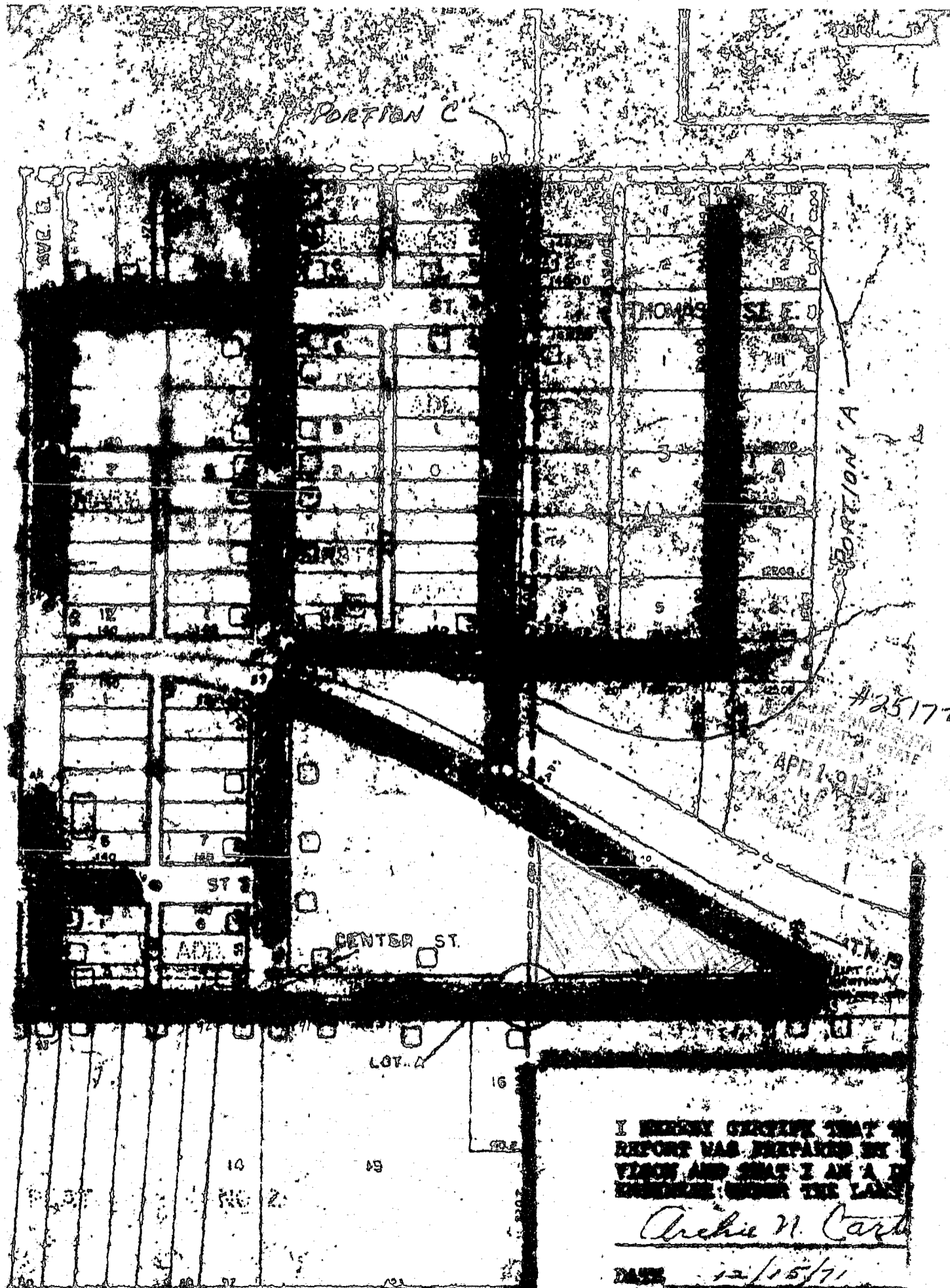

I HEREBY CERTIFY THAT THE REPORT WAS PREPARED BY ME AND THAT I AM A LICENSED SURVEYOR UNDER THE LAWS OF THE STATE OF ILLINOIS

Archie N. Cart

DATE 12/15/71

Raymond C. ...

DATE 12/15/71

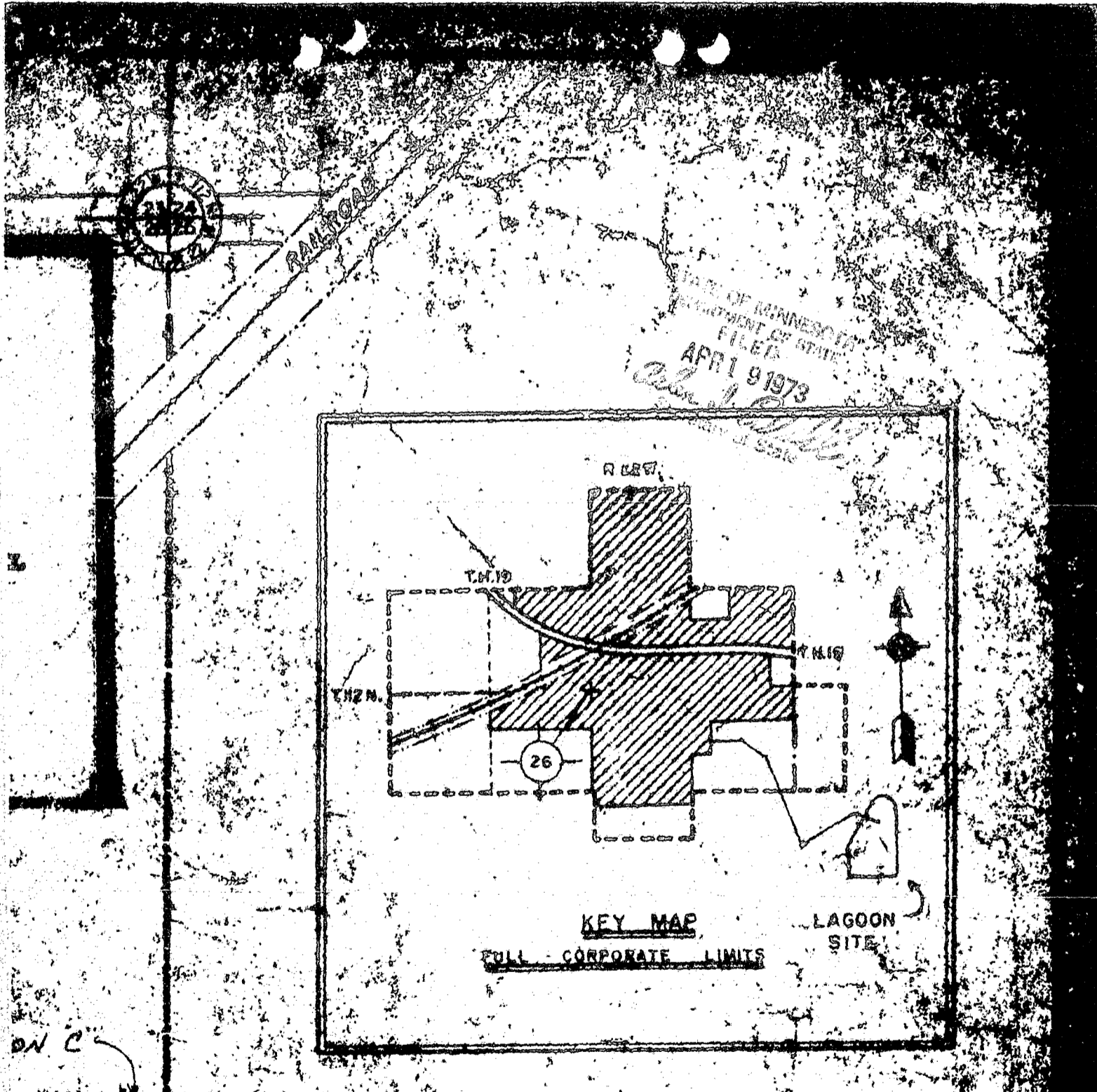

ON C

1	2	3	4
ST. [unclear]	THOMAS ST E. S.	ST. E. S.	[unclear]
[unclear]	[unclear]	[unclear]	[unclear]
[unclear]	[unclear]	[unclear]	[unclear]
[unclear]	[unclear]	[unclear]	[unclear]
[unclear]	[unclear]	[unclear]	[unclear]
[unclear]	[unclear]	[unclear]	[unclear]
[unclear]	[unclear]	[unclear]	[unclear]

ON A

