



896  
Phone: 221-2420

STATE OF MINNESOTA  
MUNICIPAL COMMISSION

304 Capitol Square Building  
10th & Cedar Streets  
St. Paul, Minnesota 55101

Feb. 1, 1973

Mr. J. M. Ehlen, Clerk  
Box 30  
Wadena, Minnesota

Re: Docket Number A-2277 Ordinance Number 136

Dear Sir:

The Minnesota Municipal Commission acknowledges receipt and filing of the above Ordinance and filing fee in accordance with Minn. Statutes, Chapter 414 and the Rules of Procedure.

According to law, this annexation is final upon filing a copy of the ordinance with the Town Clerk, County Auditor and Secretary of State in addition to the Municipal Commission.

Please refer to the above docket and ordinance numbers in any future reference to this annexation.

Sincerely yours,

MUNICIPAL COMMISSION

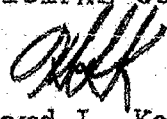
  
Howard L. Kaibel, Jr.  
Executive Secretary

HLK/mg

c.c. Secretary of State  
County Auditor  
Township  
Attorney  
Municipality

24927

A-2277 Wadena

ORDINANCE NO. 136

JAN 12 1973

AN ORDINANCE EXTENDING THE CORPORATE LIMITS OF THE VILLAGE OF WADENA TO INCLUDE CERTAIN UNINCORPORATED PLATTED ~~XXXXXXXXXXXXXX~~ LAND ABUTTING UPON THE VILLAGE LIMITS

WHEREAS, said petition was served upon the Municipal Commission of the State of Minnesota, the County of Wadena, and the Township of Wadena in addition to the village; and

WHEREAS, the quantity of land embraced within the area described is four and fifty-two hundredths (4.52) acres, more or less of platted land, no part of which is included within the limits of an incorporated city, village, or borough; and

WHEREAS, the petition was signed by all owners constituting a majority; and

WHEREAS, no objections to the annexation have been received from the town board, the county board, or the governing body of any municipality whose boundaries abut upon the boundaries of the land to be annexed; and

WHEREAS, said petition was served upon the Municipal Commission of the State of Minnesota, the County of Wadena, and the Township of Wadena in addition to the village; and

WHEREAS, no objections were filed with the Municipal Commission of the State of Minnesota to said annexation; and

WHEREAS, the land described in the petition abuts upon the village limits at the southern boundary thereof;

The council of the Village of Wadena, Minnesota, ordains:

Section 1. The Village Council hereby determines (1) that the annexation will be to the best interests of the village and of the territory affected; (2) that the territory described herein abuts upon the village limits and is or is about to become urban or suburban in character; and (3) that none of said territory is now included within the limits of any city, village, or borough.

Section 2. Territory Annexed. The corporate limits of the village are hereby extended to include the platted land described as follows:

Lots One (1), Two (2), Three (3), Four (4), Five (5) and Six (6) of Block Three (3) and Lots Nine (9), Ten (10), Eleven (11), Twelve (12) and Thirteen (13) of Block Four (4) of Southbrook, and all roads, streets and alleys adjacent thereto,

and the same is hereby annexed to and included within the village as effectually as if it had originally been a part thereof.

Section 3. Filing. The village clerk is hereby directed to file certified copies of this ordinance with the Minnesota Municipal Commission, the Secretary of State, and the County Auditor.

Section 4. Effective Date. This ordinance takes effect upon its passage and publication and the filing of the certified copies as directed in Section 3.

Adopted by the council this 10th day of January, 1973.

M. W. Gaslin

Mayor

Attest:

John M. Ehlen  
Village Clerk  
(Village Clerk's Seal)

# 24927  
STATE OF MINNESOTA  
DEPARTMENT OF STATE  
FILED

FEB 12 1973

Arlen J. Erdahl  
Secretary of State

ORDINANCE NO. 136

AN ORDINANCE EXTENDING THE CORPORATE LIMITS OF THE VILLAGE OF WADENA TO INCLUDE CERTAIN UNINCORPORATED PLATTED ~~AND UNINCORPORATED~~ LAND ABUTTING UPON THE VILLAGE LIMITS

WHEREAS, said petition was served upon the Municipal Commission of the State of Minnesota, the County of Wadena, and the Township of Wadena in addition to the village; and

WHEREAS, the quantity of land embraced within the area described is four and fifty-two hundredths (4.52) acres, more or less of platted land, no part of which is included within the limits of an incorporated city, village, or borough; and

WHEREAS, the petition was signed by all owners constituting a majority; and

WHEREAS, no objections to the annexation have been received from the town board, the county board, or the governing body of any municipality whose boundaries abut upon the boundaries of the land to be annexed; and

WHEREAS, said petition was served upon the Municipal Commission of the State of Minnesota, the County of Wadena, and the Township of Wadena in addition to the village; and

WHEREAS, no objections were filed with the Municipal Commission of the State of Minnesota to said annexation; and

WHEREAS, the land described in the petition abuts upon the village limits at the southern boundary thereof;

The council of the Village of Wadena, Minnesota, ordains:

Section 1. The Village Council hereby determines (1) that the annexation will be to the best interests of the village and of the territory affected; (2) that the territory described herein abuts upon the village limits and is or is about to become urban or suburban in character; and (3) that none of said territory is now included within the limits of any city, village, or borough.

Section 2. Territory Annexed. The corporate limits of the village are hereby extended to include the platted land described as follows:

Lots One (1), Two (2), Three (3), Four (4), Five (5) and Six (6) of Block Three (3) and Lots Nine (9), Ten (10), Eleven (11), Twelve (12) and Thirteen (13) of Block Four (4) of Southbrook, and all roads, streets and alleys adjacent thereto,

and the same is hereby annexed to and included within the village as effectually as if it had originally been a part thereof.

Section 3. Filing. The village clerk is hereby directed to file certified copies of this ordinance with the Minnesota Municipal Commission, the Secretary of State, and the County Auditor.

Section 4. Effective Date. This ordinance takes effect upon its passage and publication and the filing of the certified copies as directed in Section 3.

Adopted by the council this 10th day of January, 1973.

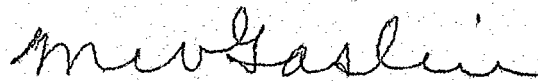

Mayor

Attest:

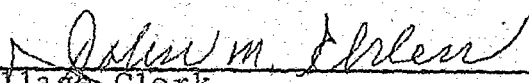
  
Village Clerk

(Seal)

AFFIDAVIT OF PUBLICATION

ORDINANCE NO. 136  
AN ORDINANCE EXTENDING THE CORPORATE LIMITS OF THE VILLAGE OF WADENA TO INCLUDE CERTAIN UNINCORPORATED PLATTED LAND ABUTTING UPON THE VILLAGE LIMITS

... WHEREAS, said petition was served upon the Municipal Commission of the State of Minnesota, the County of Wadena the Township of Wadena in addition to the village; and  
... WHEREAS, the quantity of land embraced within the area described is four and fifty-two hundredths (4.52) acres, more or less of platted land, no part of which is included within the limits of an incorporated city, village, or borough; and  
... WHEREAS, the petition was signed by all owners constituting a majority; and  
... WHEREAS, no objections to the annexation have been received from the town board, the county board, or the governing body of any municipality whose boundaries abut upon the boundaries of the land to be annexed; and  
... WHEREAS, said petition was served upon the Municipal Commission of the State of Minnesota, the County of Wadena, and the Township of Wadena in addition to the village; and  
... WHEREAS, no objections were filed with the Municipal Commission of the State of Minnesota to said annexation; and  
... WHEREAS, the land described in the petition abuts upon the village limits at the southern boundary thereof;

... The council of the Village of Wadena, Minnesota, ordains:  
... Section 1. The Village Council hereby determines (1) that the annexation will be to the best interests of the village and of the territory affected, (2) that the territory described herein abuts upon the village limits and is or is about to become urban or suburban in character; and (3) that none of said territory is now included within the limits of any city, village, or borough.  
... Section 2. Territory Annexed. The corporate limits of the village are hereby extended to include the platted land described as follows:  
... Lots One (1), Two (2), Three (3), Four (4), Five (5) and Six (6) of Block Three (3) and Lots Nine (9), Ten (10), Eleven (11), Twelve (12) and Thirteen (13) of Block Four (4) of Southbrook, and all roads, streets and alleys adjacent thereto, and the same is hereby annexed to and included within the village as effectually as if it had originally been a part thereof.  
... Section 3. Filing. The village clerk is hereby directed to file certified copies of this ordinance with the Minnesota Municipal Commission, the Secretary of State, and the County Auditor.  
... Section 4. Effective Date. This ordinance takes effect upon its passage and publication and the filing of the certified copies as directed in Section 3.  
... Adopted by the council this 10th day of January 1973.

M.W. Gaslin  
Mayor

Attest:

John M. Ehlen  
Village Clerk  
(Village Clerk's Seal)

State of Minnesota } ss.  
County of Wadena

Alvina Woessner, being duly sworn, on oath

says he is and during all the times herein stated has been the Secretary

of the newspaper known as THE WADENA PIONEER JOURNAL CO., INC., and has full knowledge of the facts herein stated as follows: (1) Said newspaper is printed in the English language in newspaper format and in column and sheet form equivalent in printed space to at least 900 square inches. (2) Said newspaper is a weekly and is distributed at least once each week. (3) Said newspaper has 50% of its news columns devoted to news of local interest to the community which it purports to serve and does not wholly duplicate any other publication and is not made up entirely of patents, plate matter and advertisements. (4) Said newspaper is circulated in and near the municipality which it purports to serve, has at least 500 copies regularly delivered to paying subscribers, has an average of at least 75% of its total circulation currently paid or no more than three months in arrears and has entry as second-class matter in its local post-office. (5) Said newspaper purports to serve the Village of Wadena in the County of Wadena and it has its known office of issue in the Village of Wadena in said county, established and open during its regular business hours for the gathering of news, sale of advertisements and sale of subscriptions and maintained by the managing officer of said newspaper or persons in his employ and subject to his direction and control during all such regular business hours and devoted exclusively during such regular business hours to the business the newspaper and business related thereto. (6) Said newspaper files a copy of each issue immediately with the State Historical Society. (7) Said newspaper has complied with all the foregoing conditions for at least two years preceding the day or dates of publication mentioned below. (8) Said newspaper has filed with the Secretary of State of Minnesota prior to January 1, 1966 and each January 1 thereafter an affidavit in the form prescribed by the Secretary of State and signed by the managing officer of said newspaper and sworn to before a notary public stating that the newspaper is a legal newspaper.

He further states on oath that the printed Ordinance No. 136

hereto attached as a part hereof was cut from the columns of said newspaper, and was printed and published therein

in the English language, once each week, for one successive weeks;

that it was first so published on 15th day of February 1973, and was thereafter printed and published on every Thursday of each week to and

including the day of 19 and that the following is a printed copy of the lower case alphabet from A to Z, both inclusive, and is hereby acknowledged as being the size and kind of type used in the composition and publication of said notice, to wit:

ABCDEFGHIJKLMN OPQRSTU VWXYZ  
abcdefghijklmnopqrstuvwxyz

Alvina Woessner

Subscribed and sworn to before me this 15th day of February 1973

Sterling Sweetson  
Notary Public  
My Commission Expires Jan. 10, 1975  
STERLING SWEETSON  
NOTARY PUBLIC - MINNESOTA  
WADENA COUNTY

STATE OF MINNESOTA )  
COUNTY OF WADENA ) SS  
VILLAGE OF WADENA )

CERTIFICATION

I, John M. Ehlen, the duly appointed, qualified and acting Village Clerk of the Village of Wadena, Wadena County, Minnesota, do hereby certify that the attached

ORDINANCE NO. 136

AN ORDINANCE EXTENDING THE CORPORATE LIMITS OF THE VILLAGE OF WADENA TO INCLUDE CERTAIN UNINCORPORATED PLATTED LAND ABUTTING UPON THE VILLAGE LIMITS

is a true and correct copy of said Ordinance as adopted by the Village Council, Village of Wadena, Minnesota, on January 10th, 1973, duly published in the Wadena Pioneer Journal, the official newspaper for publications of the Village Council, Village of Wadena, Minnesota, on February 15th, 1973, kept on file in my office pursuant to Minnesota Statutes.

WITNESS my hand and seal of my office this 16th day of February 1973.

(Seal)

  
Village Clerk

Village of Wadena, Minnesota.

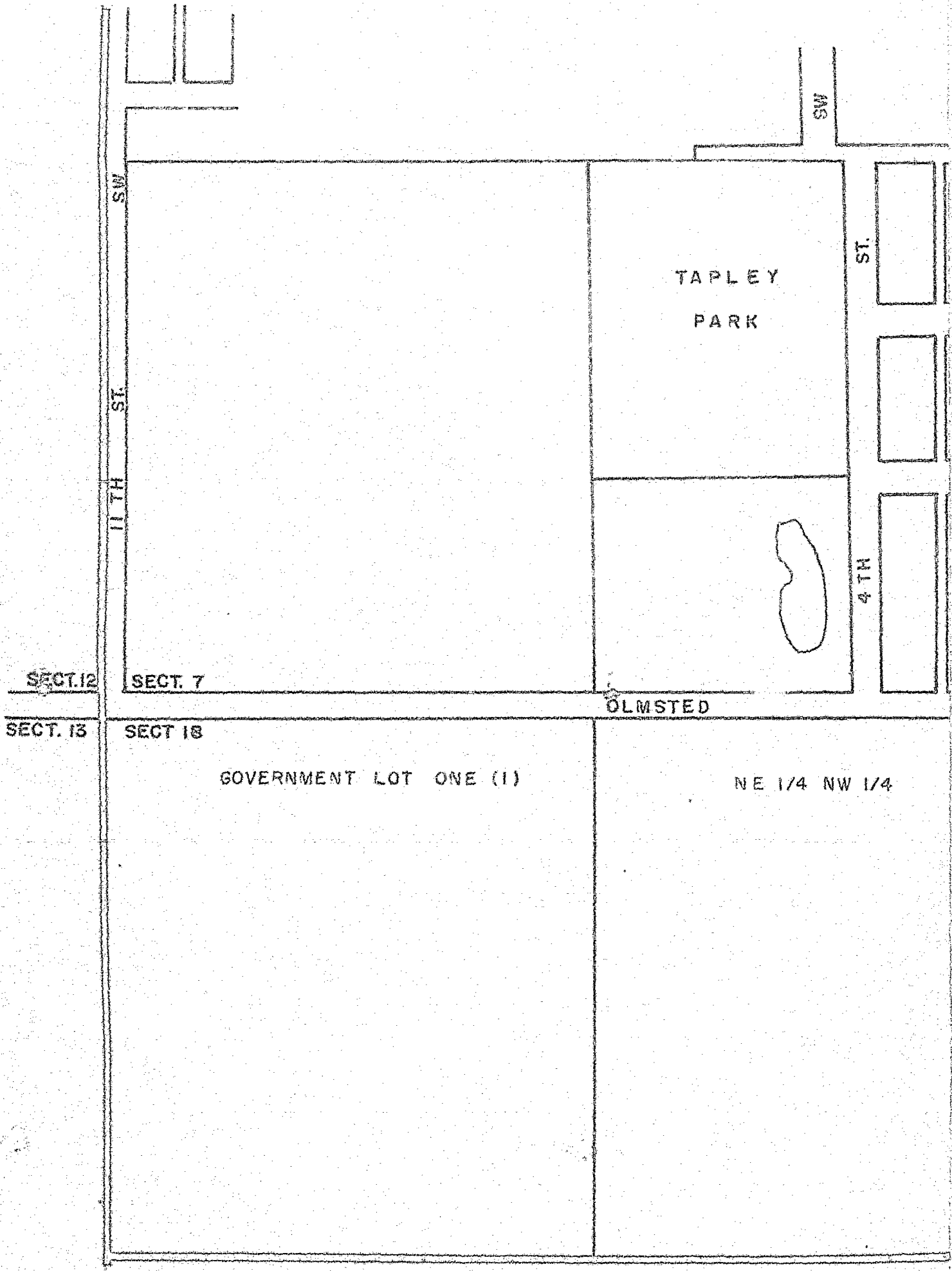



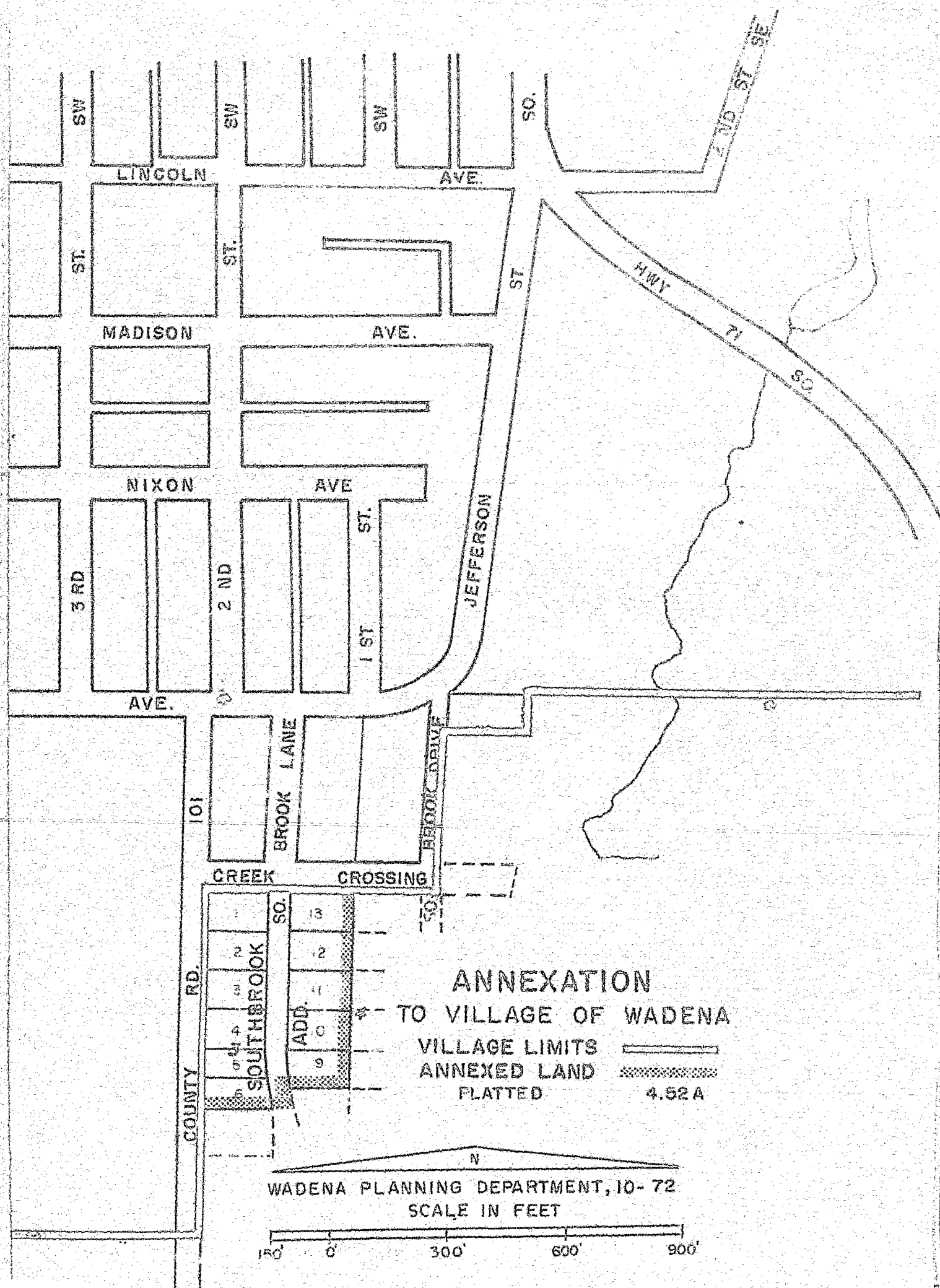

Waco, Texas, Reg. No. 2-17-13  
after 11/1/13

24927