



Phone: 221-2420

STATE OF MINNESOTA
MUNICIPAL COMMISSION

304 Capitol Square Building
10th & Cedar Streets
St. Paul, Minnesota 55101

Dec. 10, 1971

Mr. William H. Aanerud, Clk.-Treas.
City Hall - 221 E. Clark St.
Albert Lea, Minnesota

Re: Docket Number A-2026 Ordinance Number 2019

Dear Sir:

The Minnesota Municipal Commission acknowledges receipt and filing of the above Ordinance and filing fee in accordance with Minn. Session Laws 1969, Chapter 1146, Section 12 and the Rules of Procedure.

According to law, this annexation is final upon filing a copy of the ordinance with the Town Clerk, County Auditor and Secretary of State in addition to the Municipal Commission.

Please refer to the above docket and ordinance numbers in any future reference to this annexation.

Very truly yours,

MUNICIPAL COMMISSION

Bruce Rasmussen
Executive Secretary

BR/mg

c.c. Secretary of State
County Auditor
Township
Attorney
Municipality

23384

I hereby certify that I have compared the original with the copy and find them to be correct.

ORDINANCE NO 2019

Oct 13, 1971
William A. Samuel
City Clerk

Introduced by Councilman Robert Quackenbush

An Ordinance Extending the Corporate Limits of the City of Albert Lea to Include Unincorporated Territory Bordered by Lands Within the City Limits of Albert Lea and Abutting Thereon.

WHEREAS, certain territory described below is not presently included within the corporate limits of any incorporated City, Village or Borough, and,

WHEREAS, 60% or more of the perimeter of this territory is bordered by lands already included within the corporate limits of the City, and is deemed to be urban in character, and,

WHEREAS, a notice of intent to annex the following property was served upon the Township of Albert Lea as required by law and a period of more than 60 days has elapsed since such service without the filing of written objections by the town with Minnesota Municipal Commission and the City of Albert Lea.

THE CITY OF ALBERT LEA DOES ORDAIN:

Sec. 1. The Corporate limits of the City of Albert Lea are hereby extended to include the platted and unplatted territory as provided under M.S. 414.033 Sub 3, described as follows, 60% of or more of the perimeter of which territory is bordered by territory already included within the city limits:

Beginning at the Northwest Corner of Lot 1, Block 1 Lutheran Subdivision to the City of Albert Lea, thence East along the North line of said Lot 1 to the Southwest corner of Lot 2 Block 1, Lutheran Sub., thence north along the West line of said Lot 2 to the center line of Sunset St, thence Northwesterly along the center line of Sunset to the West line of Neel's Subdivision to the City of Albert Lea thence Northeasterly along the west line of Neel's Sub to the center line of Massee St, thence Southeasterly along the center line of Massee St to the East line of Sec. 6, Township 102, Range 21 West, thence north along said section line to a point 750' north of the S.E. corner of Sec. 6 thence Northwesterly at a deflection angle of 45°00' a distance of 565.6' to a point which is 400' west of the East line of Section 6, thence north along a line parallel to and 400' west of the East line of Section 6 to a point 440' North of south line of the NE $\frac{1}{4}$ of SE $\frac{1}{4}$ of Section 6, thence west 460' on a line parallel to the South line of the NE $\frac{1}{4}$ of SE $\frac{1}{4}$ of Section 6, thence North 880' \pm to the North line of the SE $\frac{1}{4}$ of Sec 6, thence west 460' to the NW Corner of the NE $\frac{1}{4}$ of SE $\frac{1}{4}$ of Sec 6, thence north 820' along the west line of the SE $\frac{1}{4}$ of NE $\frac{1}{4}$ of Section 6, thence west 1320' on a line parallel to and 820' north of the north line of the SE $\frac{1}{4}$ of Section 6 to the west line of the NE $\frac{1}{4}$ of Sec. 6, thence south along said west line to the East right of way line of TH 13, thence southeasterly along the East right of way of TH 13 to the point of beginning, all lying in Sections 6 and 7-102-21. -- (containing 99.65 acres, of which 40.56 acres is land and 59.09 acres is water).

Sec. 2. That the above property is hereby zoned as R-1 Residential District.

Sec. 3. The City Clerk is directed to file certified copies of this ordinance with the Secretary of State, The County Auditor of the County in which the property is located, and the Minnesota Municipal Commission.

Sec. 4. This ordinance shall take effect upon passage and publication and the filing of certified copies as directed above.

Introduced and read the first time September 13, 1971

Read the second time and passed September 27, 1971

Robert Quackenbush
Mayor

STATE OF MINNESOTA
#23374
DEPARTMENT OF STATE
FILED
DEC 1 5 1971
William A. Samuel
Secretary of State

Filed and attested September 28, 1971

William A. Samuel
Secretary of the Council

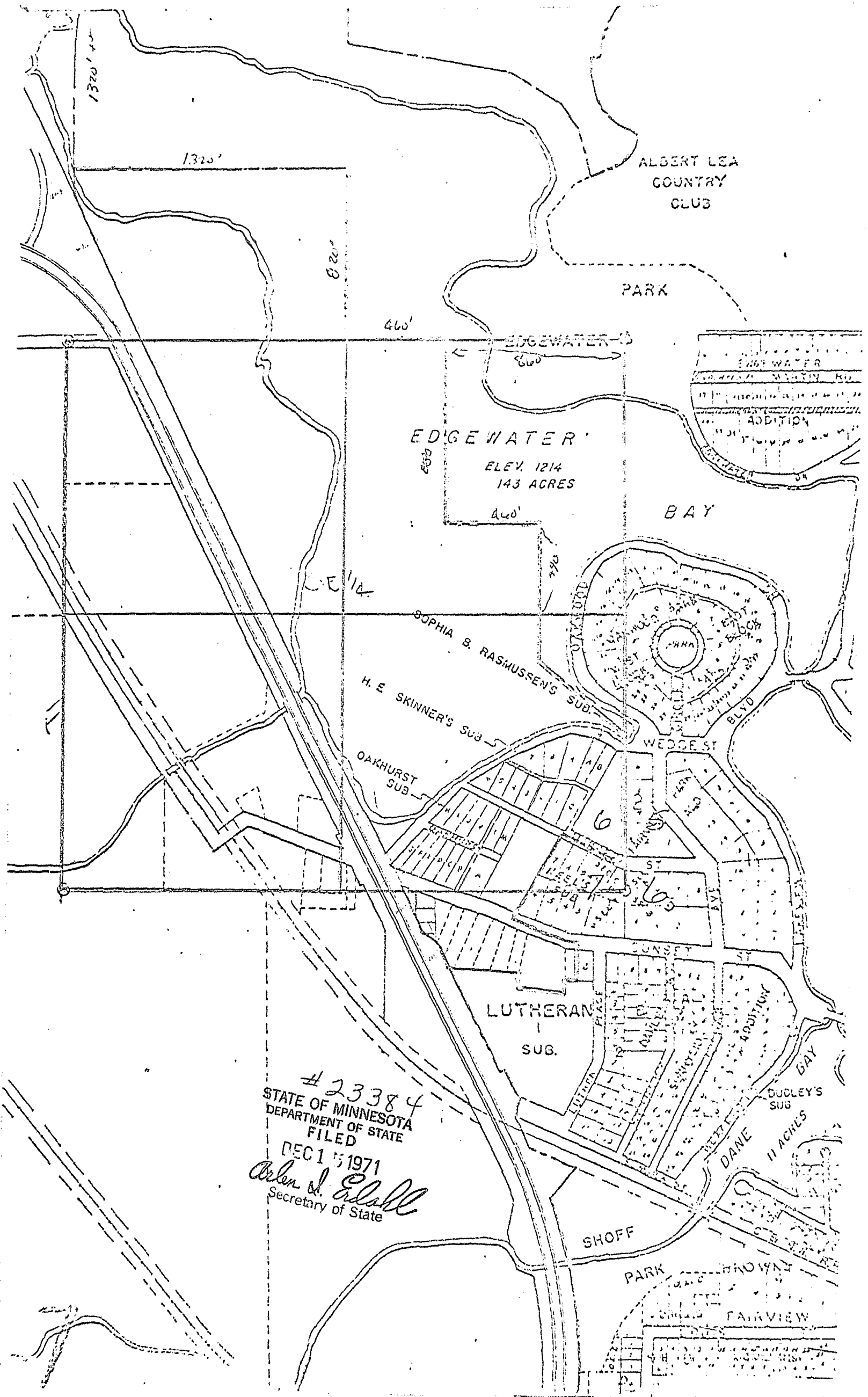

#23384
STATE OF MINNESOTA
DEPARTMENT OF STATE
FILED
DEC 15 1971
Arden J. Edsall
Secretary of State