



Phone: 221-2428

STATE OF MINNESOTA
MUNICIPAL COMMISSION

610 Capitol Square Building
10th & Cedar Streets
St. Paul, Minnesota 55101

Feb. 12, 1971

Mr. Wallace I. Peterson, Clk.-Treas.
Municipal Bldg. 212 Central Ave.
Buffalo, Minnesota 55313

Re: Docket Number A-1908 Ordinance Number 19.10

Dear Sir:

The Minnesota Municipal Commission acknowledges receipt and filing of the above Ordinance and filing fee in accordance with Minn. Session Laws 1969, Chapter 1146, Section 12 and the Rules of Procedure.

According to law, this annexation is final upon filing a copy of the ordinance with the Town Clerk, County Auditor and Secretary of State in addition to the Municipal Commission.

Please refer to the above docket and ordinance numbers in any future reference to this annexation.

Very truly yours,

MUNICIPAL COMMISSION

A handwritten signature in cursive script that reads "Bruce Rasmussen".

Bruce Rasmussen
Executive Secretary

BR/pdl

c.c. Secretary of State
County Auditor
Township
Attorney
Municipality

22222

ORDINANCE NO. 19.10

AN ORDINANCE EXTENDING THE CORPORATE LIMITS OF THE VILLAGE OF BUFFALO TO INCLUDE CERTAIN UNINCORPORATED PLATTED LAND ABUTTING UPON THE VILLAGE LIMITS,

WHEREAS, a certain petition dated September 2, 1970, requesting annexation of the territory hereinafter described was duly presented to the council on the 5th day of October, 1970; and

WHEREAS, the quantity of land embraced within the area described in the petition and bounded as described is one-half acre of platted land, no part of which is included within the limits of an incorporated city, village, or borough; and

WHEREAS, the petition was signed by all owners; and

WHEREAS, no objections to the annexation have been received from the town board, the county board, or the governing body of any municipality whose boundaries abut upon the boundaries of the land to be annexed; and

WHEREAS, the land described in the petition abuts upon the village limits at the northern boundary thereof; The council of the Village of Buffalo, Minnesota, ordains:

Section 1 The Village council hereby determines (1) that the annexation will be to the best interests of the village and of the territory affected; (2) that the territory described herein abuts upon the village limits and is urban or suburban in character; and (3) that none of said territory is now included within the limits of any city, village, or borough.

Section 2 Territory Annexed. The corporate limits of the village are hereby extended to include the platted land described as follows and the same is hereby annexed to and included within the village as effectually as if it had originally been a part thereof;

The South Two Hundred and Fifteen feet of Lot One in Lot "D" of the West Half ($W\frac{1}{2}$) of the Southwest Quarter ($SW\frac{1}{4}$) of Section Twenty, in Township One Hundred Twenty, of Range Twenty-five, containing One-half acre, more or less, according to the plat on file and of record in the Office of the Register of Deeds in and for said Wright County, Minnesota, also that portion of public road abutting on the South side thereof.

Section 3 Filing. The village clerk is hereby directed to file certified copies of this ordinance with the Minnesota Municipal Commission, the Secretary

1 of State, and the County Auditor.

2 Section 4, Effective Date. This ordinance takes effect upon its passage
3 and publication and the filing of the certified copies as directed in Section 3,

4 Adopted by the council this 14th day of January, 1971,

5
6 W. L. Stuberstad
7 Mayor

8 ATTEST:

9 Wallace J. Peterson
10 Clerk-Treasurer

11 Published in the Wright County Journal Press on January 21, 1971.

12
13
14
15
16
17 STATE OF MINNESOTA }
18 COUNTY OF WRIGHT } SS
19 VILLAGE OF BUFFALO }

21 I, the undersigned, being the duly qualified and acting Clerk-
22 Treasurer of the Village of Buffalo, Minnesota, hereby certify that I have
23 carefully compared the attached and foregoing copy of Ordinance No. 19,10
24 passed by the village council of said village at a regular meeting held
25 January 4, 1971, with the original thereof on file in my office and the same
26 is a full, true and correct copy of the original thereof.

27 WITNESS My hand officially as such Clerk-Treasurer and the seal
28 of the village this 19th day of January, 1971.

29 Wallace J. Peterson
30 Village Clerk-Treasurer
31 Village of Buffalo, Minnesota

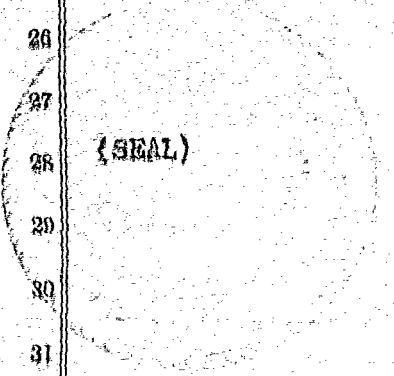

32 (SEAL)

33 # 22222
34 STATE OF MINNESOTA
35 DEPARTMENT OF STATE
36 FILED
37 FEB 17 1971
38 Arden J. Edsall
39 Secretary of State



#22222

STATE OF MINNESOTA
DEPARTMENT OF STATE
FILED

FEB 17 1971

Arlen J. Edsall
Secretary of State

CORPORATE LIMITS

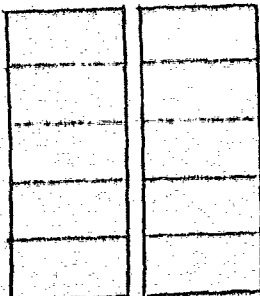
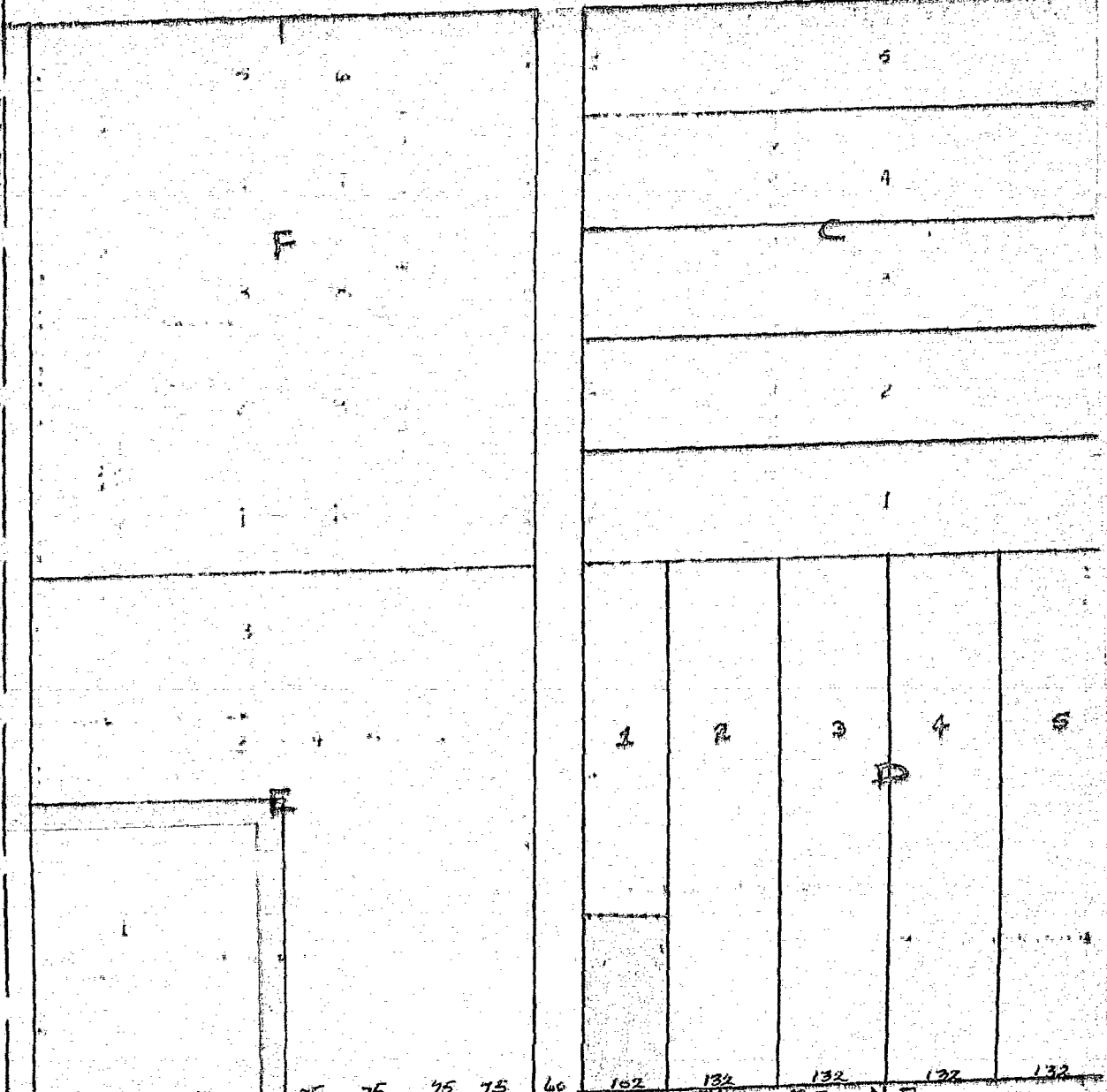

COUNTY

ROAD

No. 35

8TH ST. N.E.
CORPORATE LIMITS

1961

SOUTHWEST CORNER OF SEC 20

VILLAGE OF BUFFALO
22222