

(PUBLISHED IN THE HUTCHINSON LEADER ON FRIDAY, MAY 29, 1970)
(Publication No. 1275)

ORDINANCE NO. 364

AN ORDINANCE INCORPORATING CERTAIN LANDS SURROUNDED BY
THE CITY OF HUTCHINSON, MINNESOTA AND FORMERLY LOCATED
IN THE TOWNSHIP OF LYNN

THE CITY OF HUTCHINSON DOES ORDAIN:

Section I. The following described property owned by Donald McKimm, Earl McDonald and Jim Waldron is completely surrounded by the City of Hutchinson, Minnesota:

Lots 1 through 5 of McDonald's Addition

Section II. MSA, Section 414.033, Subdivision 4 provides that "If the land is completely surrounded by land within the municipal limits, the municipal council may by ordinance declare the land annexed to the municipality, and any such land is deemed to be urban in character."

Section III. Therefore, the City of Hutchinson, Minnesota hereby ordains and declares that the property hereinbefore described be and the same is hereby annexed to, and included in the City of Hutchinson, Minnesota as effectually as if it had originally been a part thereof.

Section IV. This ordinance shall be final and shall take effect and be in force after filing certified copy thereof with the Minnesota Municipal Commission, the County Auditor and the Secretary of State, and from and after its passage and publication.

Adopted by the City Council of Hutchinson, Minnesota this 25th day of May, 1970.

Don O. Kost, Mayor

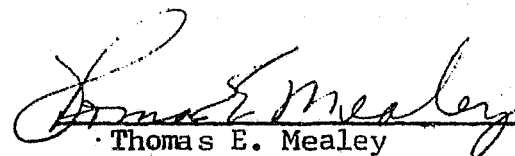
Thomas E. Mealey

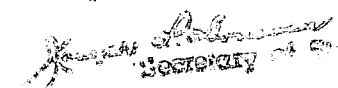
#21740
STATE OF MINNESOTA
DEPARTMENT OF STATE
FILED
SEP 3 - 1970

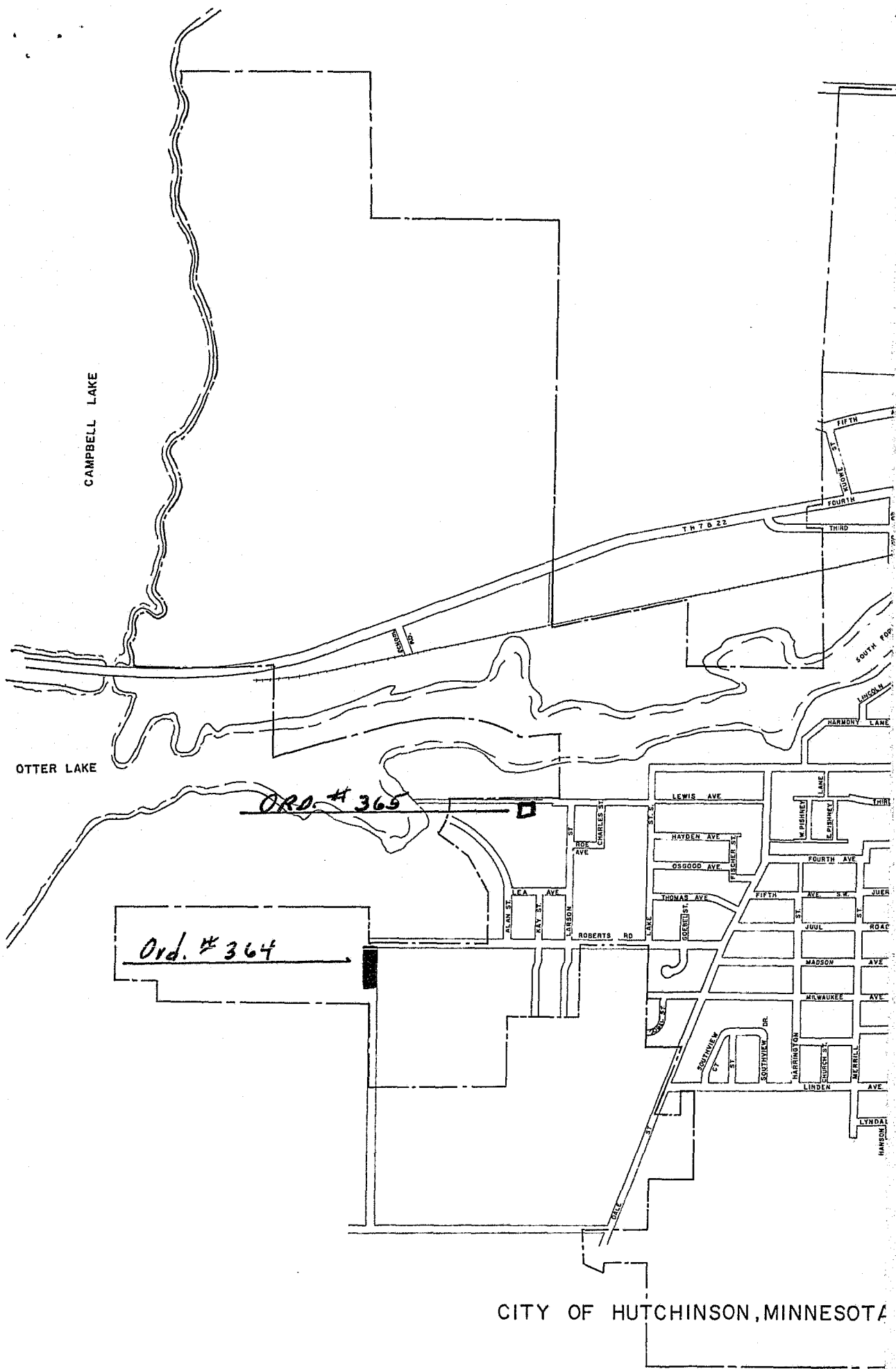
SOCIETY OF S.

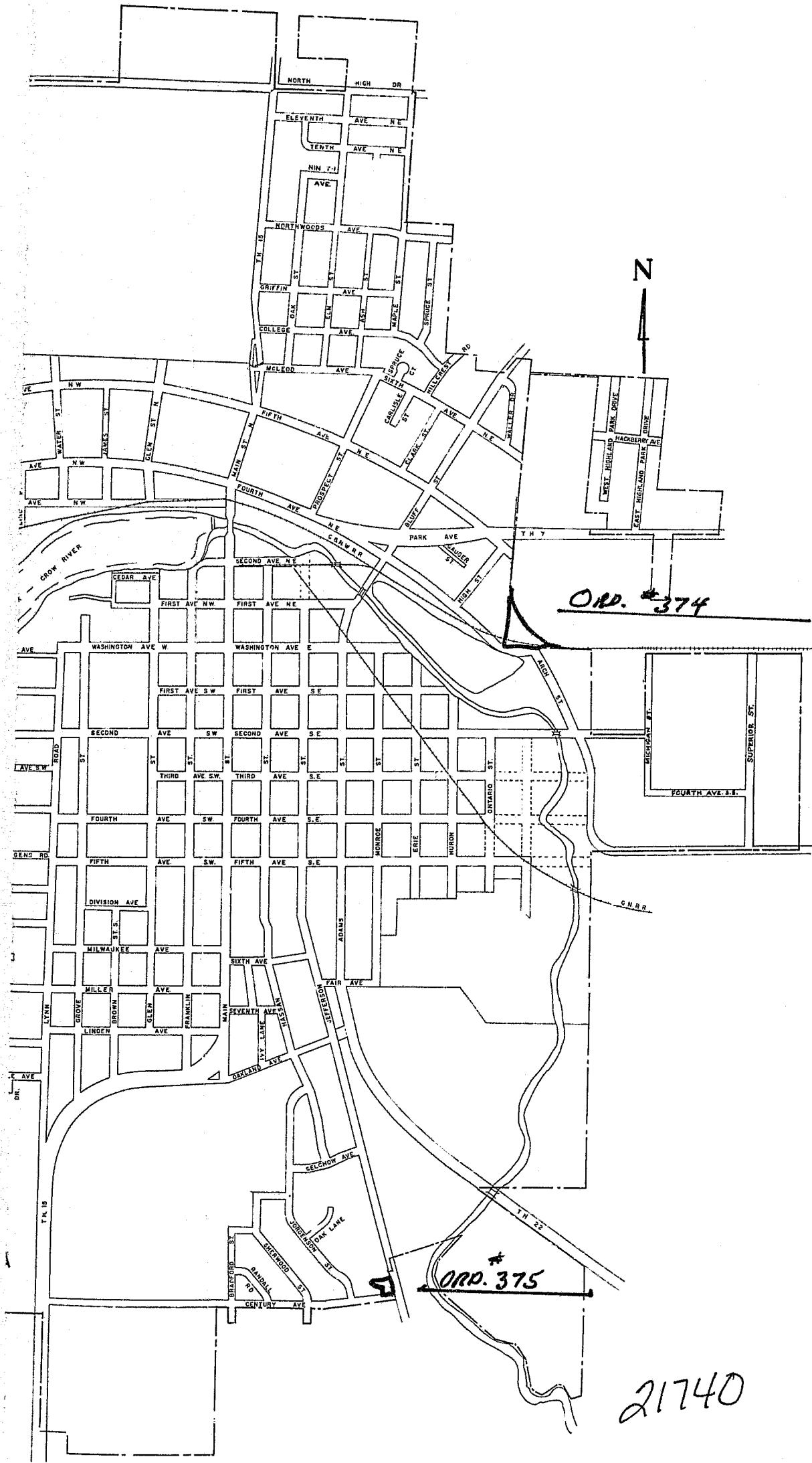

CITY OF HUTCHINSON, MINNESOTA



UTL 18 T

ORD. #374

ORD. #375

21740