



Phone: 221-2428

STATE OF MINNESOTA
MUNICIPAL COMMISSION

610 Capitol Square Building
10th & Cedar Streets
St. Paul, Minnesota 55101
August 8, 1969

Mrs. Meredith Hogenson, Clk-Treas.
Village Hall
Lake Park, Minnesota

Re: Docket Number A-1473 Ordinance Number Amended 66

Dear Sir:

The Minnesota Municipal Commission acknowledges receipt and filing of the above Ordinance and filing fee in accordance with Minn. Stat. 414.03, Subd. 2 as amended, and the Rules of Procedure.

Please refer to the above docket and ordinance numbers in any future reference to this annexation.

Very truly yours,

MUNICIPAL COMMISSION

Bruce Rasmussen
Bruce Rasmussen
Secretary

BR/pdl
c.c. Secretary of State
County Auditor
Township
Attorney
Municipality

#20878

AMENDED ORDINANCE NO. 66

AN ORDINANCE AMENDING THE CORPORATE LIMITS OF THE VILLAGE OF LAKE PARK TO INCLUDE CERTAIN UNINCORPORATED PROPERTY OWNED BY AND ABUTTING UPON THE LIMITS OF THE VILLAGE OF LAKE PARK

WHEREAS, the territory described below is not presently within the corporate limits of any incorporated city, village or borough; and

WHEREAS, this territory abuts upon the corporate limits of the village at the north boundary thereof and is deemed to be urban in character; and

WHEREAS, this territory is owned in fee by the village; The village council of Lake Park ordains:

SECTION 1. Territory Annexed. The corporate limits of the Village of Lake Park are hereby extended to include the unplatted property described as follows now owned by the Village of Lake Park:

That part of the Northeast Quarter of the Northeast Quarter (NE $\frac{1}{4}$ NE $\frac{1}{4}$) of Section Ten (10), Township One Hundred Thirty-Nine (139), North of Range Forty-Three (43) West of the Fifth Principal Meridian in Becker County, Minnesota, described as follows, to-wit:

Beginning at a point that is 891.3 feet West of the Northeast corner of said Sec. 10 in said Twp. 139 and N. of Range 43 West, thence from said point of beginning running South 275 feet, thence at right angles and running West and parallel with the South line of State Highway No. 10, a distance of 400 feet, thence at right angles and running North a distance of 275 feet, thence at right angles and running East and along the North line of said State Highway No. 10, a distance of 400 feet to the place of beginning.

SECTION 2. Filing. The Village Clerk is directed to file certified copies of this ordinance with the Secretary of State, the County Auditor of the County in which the property is located and the Minnesota Municipal Commission.

SECTION 3. Effective Date of Annexation. This ordinance takes effect upon its passage and publication and the filing of certified copies as directed in Section 2.

Adopted by the Village Council of Lake Park, Minnesota, this 21 day of April, 1969.

Richard Bowers

RICHARD BOWERS,
Mayor

Attest:

Meredith Hogenson
Clerk

28878

STATE OF MINNESOTA
DEPARTMENT OF STATE
FILED
AUG 19 1969

Joseph L. Johnson
Secretary of State

Lake Park

BENSHOOF, HUMMEL & SINCLAIR

ATTORNEYS AT LAW

FIRST NATIONAL BANK BUILDING

DETROIT LAKES, MINN. 56501

LOWELL W. BENSHOOF
LYNN J. HUMMEL
JAMES D. SINCLAIR

TELEPHONE: 847-4477

November 29, 1968

Hon. Joseph L. Donovan
Secretary of State
State Capitol Building
St. Paul, Minnesota 55101

Re: Annexation - Village of Lake Park

Dear Mr. Donovan:

I am enclosing a certified copy of Ordinance No. 66, with attached survey showing property covered by ordinance, for annexation by ordinance of certain lands into the Village of Lake Park.

This ordinance is filed pursuant to the requirements of M.S.A. 414.03 Subd. 6.

Respectfully yours,

BENSHOOF, HUMMEL & SINCLAIR

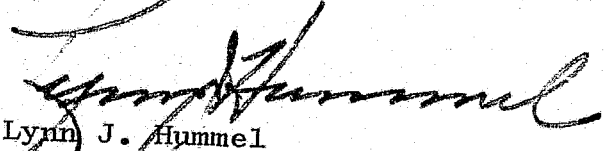

Lynn J. Hummel

LJH:lc
enc.

ORDINANCE NO. 66

AN ORDINANCE EXTENDING THE CORPORATE LIMITS OF THE VILLAGE OF LAKE PARK TO INCLUDE CERTAIN UNINCORPORATED PROPERTY OWNED BY AND ABUTTING UPON THE LIMITS OF THE VILLAGE OF LAKE PARK

WHEREAS, the territory described below is not presently within the corporate limits of any incorporated city, village, or borough; and

WHEREAS, this territory abuts upon the corporate limits of the village at the north boundary thereof and is deemed to be urban in character; and

WHEREAS, this territory is owned in fee by the village;

The village council of Lake Park ordains:

Section 1. Territory Annexed. The corporate limits of the Village of Lake Park are hereby extended to include the unplatted property described as follows now owned by the Village of Lake Park:

That part of the Northeast Quarter of the Northeast Quarter (NE $\frac{1}{4}$ NE $\frac{1}{4}$), of Section Ten (10), Township One Hundred Thirty-Nine (139) North of Range Forty-Three (43) West of the Fifth Principal Meridian in Becker County, Minnesota, described as follows, to-wit:

Beginning at a point that is 891.3 feet West of the Northeast corner of said Sec. 10 in said Twp. 139 and N. of Rge. 43 West, thence at right angles and running South a distance of 150 feet, which is the place of beginning, thence from said point of beginning, running South 125 feet, thence at right angles and running West and parallel with the South line of State Highway #10 a distance of 400 feet, thence at right angles and running North a distance of 110 feet, thence at right angles and running East and parallel to the South line of said State Highway #10 a distance of 264 feet, thence at right angles and running North a distance of 15 feet to the South line of said State Highway #10, thence at right angles and running East and parallel to and on the South line of State Highway #10 a distance of 136 feet to the place of beginning.

Section 2. Filing. The Village Clerk is directed to file certified copies of this ordinance with the Secretary of State, the County Auditor of the County in which the property is located, and the Minnesota Municipal Commission.

Section 3. Effective Date of Annexation. This ordinance takes effect upon its passage and publication and the filing

LOWELL W. BENSHOOF
LYNN J. HUMMEL

BENSHOOF & HUMMEL
LAWYERS
FIRST NATIONAL BANK BUILDING
DETROIT LAKES, MINNESOTA

Lake Park
TELEPHONE: VICTOR 7-4477

May 22, 1969

Hon. Joseph L. Donovan
Secretary of State
State Capitol Building
St. Paul, Minnesota

Re: Lake Park Annexation

Dear Mr. Donovan:

I am enclosing one copy of the amended Ordinance of Annexation of certain land to the Village of Lake Park for filing in your office.

The Ordinance was amended at the request of the Minnesota Municipal Commission.

Very truly yours,

BENSHOOF, HUMMEL & SINCLAIR

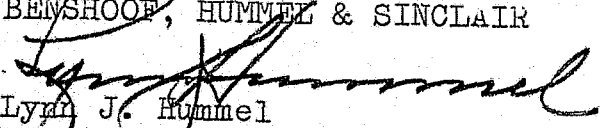
Lynn J. Hummel
LJH:dc
Enc.

STATE OF MINNESOTA
DEPARTMENT OF STATE

FILED

AUG 19 1969

Joseph L. Donovan
Secretary of State

of certified copies as directed in Section 2.

Adopted by the Village Council of Lake Park, Minnesota,
this 6th day of November, 1968.

(Approved)

Attest:

Evelyn Johnson
Clerk

Alley L. Erickson
Mayor

Published in Lake Park Journal
November 14, 1968.

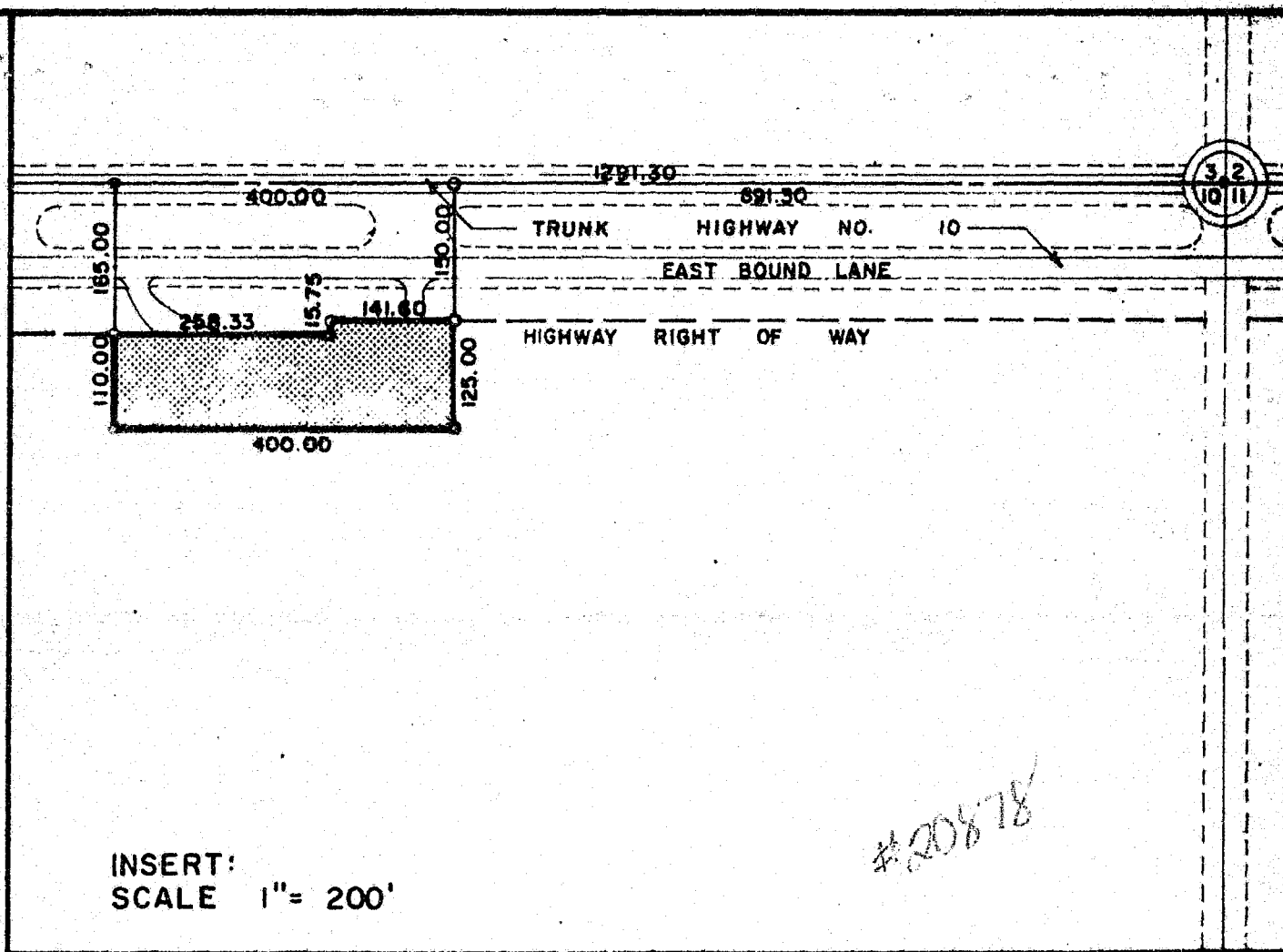

INSERT:
SCALE 1" = 200'

SURVEYOR'S CERTIFICATE

I, Robert J. Roberts, Registered Land Surveyor under the laws of the State of Minnesota, do hereby certify: that I have surveyed a certain tract of land located within the Northeast One-Quarter of Section 10, Township 139 North, Range 43 West of the Fifth Principal Meridian; that the adjacent plat is a true and accurate representation of said survey; that iron pin markers for the guidance of future surveys of said tract of land have been placed in the ground at the corners of said tract of land as indicated on the adjacent plat; that at the time of the said survey there were no encroachments from within nor from without; and that the exterior boundary of said tract of land is more particularly described as follows:

From the Northeast corner of Section 10, Township 139 North, Range 43 West of the Fifth Principal Meridian bear Westerly along the North line of said Section 10 a distance of 891.30 feet; thence bear South perpendicular to the North line of said Section 10 a distance of 150.00 feet, more or less, to a Point of Intersection with the South Right-of-Way line of Trunk Highway Ten, said Point of Intersection being the Point of Beginning of the tract of land herein described:

thence South 89°29' West along the said South Right-of-Way line a distance of 141.60 feet; thence South 00°19'39" West along the South Right-of-Way line of said Trunk Highway Ten a distance of 15.75 feet; thence North 89°33' West along the said South Right-of-Way line a distance of 258.33 feet; thence South 00°00' West a distance of 110.00 feet; thence North 90°00' East a distance of 400.00 feet; thence North 00°00' East a distance of 125.00 feet, more or less, to the Point of Beginning. Said tract of land contains 1.058 acres, more or less.