



STATE OF MINNESOTA
MUNICIPAL COMMISSION

610 Capitol Square Building
10th & Cedar Streets
St. Paul, Minnesota 55101

Feb. 14, 1969

Mr. Richard Hoglund
Clerk-Treasurer
City Hall
Willmar, Minnesota

Re: Docket Number A-1441 Ordinance Number 496

Dear Sir:

The Minnesota Municipal Commission acknowledges receipt and filing of the above Ordinance and filing fee in accordance with Minn. Stat. 414.03, Subd. 2 as amended, and the Rules of Procedure.

Please refer to the above docket and ordinance numbers in any future reference to this annexation.

Very truly yours,

MUNICIPAL COMMISSION

Bruce Rasmussen
Secretary

BR/pdl

c.c. Secretary of State —
County Auditor
Township
Attorney
Municipality

20603

496

Willmar

STATE OF MINNESOTA)
) SS
COUNTY OF KANDIYOHI)

I, Richard C. Hoglund, do hereby certify and return that I am now the City Clerk-Treasurer of the City of Willmar, Minnesota, and that I have under my possession and control all of the original records, copies of which are hereto attached; that the attached are identical, true and correct copies of all thereof on file and of record in my office, either as Minutes of Council Proceedings, or as to instruments filed in my said office; that I have compared the attached with the said original, and certify that the same is true and correct.

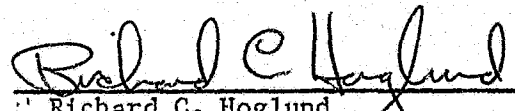
Richard C. Hoglund
City Clerk-Treasurer of the
City of Willmar, Minnesota

(S E A L)

STATE OF MINNESOTA
DEPARTMENT OF STATE
FILED
APR 9 - 1969

Secretary of State

(I-7)

Publish Dec. 4, 1968

Ordinance No. 496

An Ordinance Extending the Corporate Limits of the City of Willmar, a Municipal Corporation of the State of Minnesota, to Include Certain Land Not Exceeding 200 Acres.

WHEREAS, A Petition has been filed with the governing body of the City of Willmar, a Municipal Corporation in the State of Minnesota by the sole owners and all persons having any interest therein, to have certain real property, hereinafter described, included within the limits of the City of Willmar, Minnesota, and

WHEREAS, It is proposed to annex by virtue hereof to the said City of Willmar, said property, all of which said property is in Kandiyohi County in the State of Minnesota, and

WHEREAS, The said property to be annexed consists of 160 acres described as the Northwest Quarter of Section 12, Township 119 North, Range 35 West.

NOW THEREFORE, The City Council of the City of Willmar hereby determines, ordains and declares as follows:

Section 1. Best Interests of City of Willmar. That the annexation will be to the best interests of the City of Willmar, Minnesota, and of the territory affected.

Section 2. Abuts on City Limits. That the property above described abuts on the city limits, and is so conditioned as property to be subject to city government.

Section 3. Annexation. That the said property is hereby annexed to, and included within, the City of Willmar, Minnesota, as effectually as if it had originally been a part hereof.

Section 4. Zoning. The area above described shall be zoned as follows:

- A. The North 300 feet and the North 2,000 feet of the West 300 feet of the said Northwest Quarter of Section 12, Township 119 North, Range 35 West, shall be zoned R2, Residential.
- B. All the rest and remainder of said property to be annexed shall be zoned FR, Farm Residence.

20603
STATE OF MINNESOTA
DEPARTMENT OF STATE
FILED
APR 9 1969

James Johnson
Secretary of State

Section 5. Effective Date. This ordinance shall be final and shall take effect and be at full force from and after filing a certificate hereof with the Minnesota Municipal Commission, the County of Kandiyohi, Minnesota, and the Secretary of the State of Minnesota, and from and after its passage and publication.

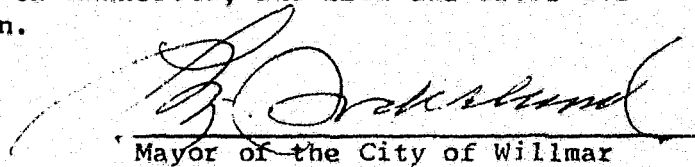
Mayor of the City of Willmar

This ordinance given its first reading on Oct 16, 1968
This ordinance given its second reading on November 6, 1968
This ordinance given its third reading on Nov 20, 1968
This ordinance published on December 4, 1968

#2060-3

STATE OF MINNESOTA
DEPARTMENT OF STATE
FILED
APR 9 1969

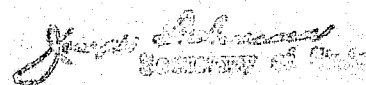
Secretary of State

State of Minnesota

County of Kandiyohi

File No. _____

City of Willmar

Area No. 12

TO THE HONORABLE COUNCIL OF THE CITY OF WILLMAR, MINNESOTA:

The undersigned, being a majority of the owners of property in Area No. 12, which is described as follows:

The NW 1/4 of Sec. 12, T 119 N, R 35 W, Kandiyohi County. (160 acres)

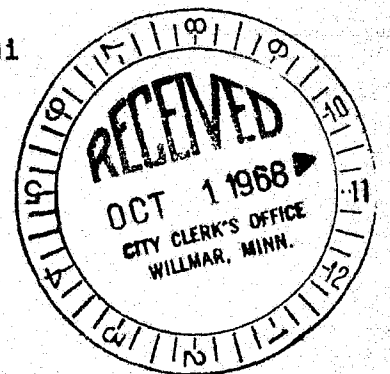

do hereby respectfully petition that the said area be annexed to the City of Willmar, Minnesota.

We request that the said area be zoned R-2 & ER (*) and that any existing or future development of said area be served with City facilities, including sanitary sewer, water, electricity and any other utility required by the area and within the capability of the City to so provide.

(*) See attached exhibit

We hereby certify and state that the said area is contiguous to the City of Willmar and is suitable and proper for annexation under the laws of the State of Minnesota and the ordinances of the City of Willmar.

We also certify and state that we have read carefully the contents of the petition herein and understand the same and covenant and agree that by signing the same it is irrevocable as to us and is binding upon our heirs, representatives and assigns.

Dated this 30 day of Sept, 19 68.

Signature

Description of Property Owned

x [Signature]
Betty L. Stutsong

The NW 1/4 of Sec. 12, T 119 N,

R 35 W

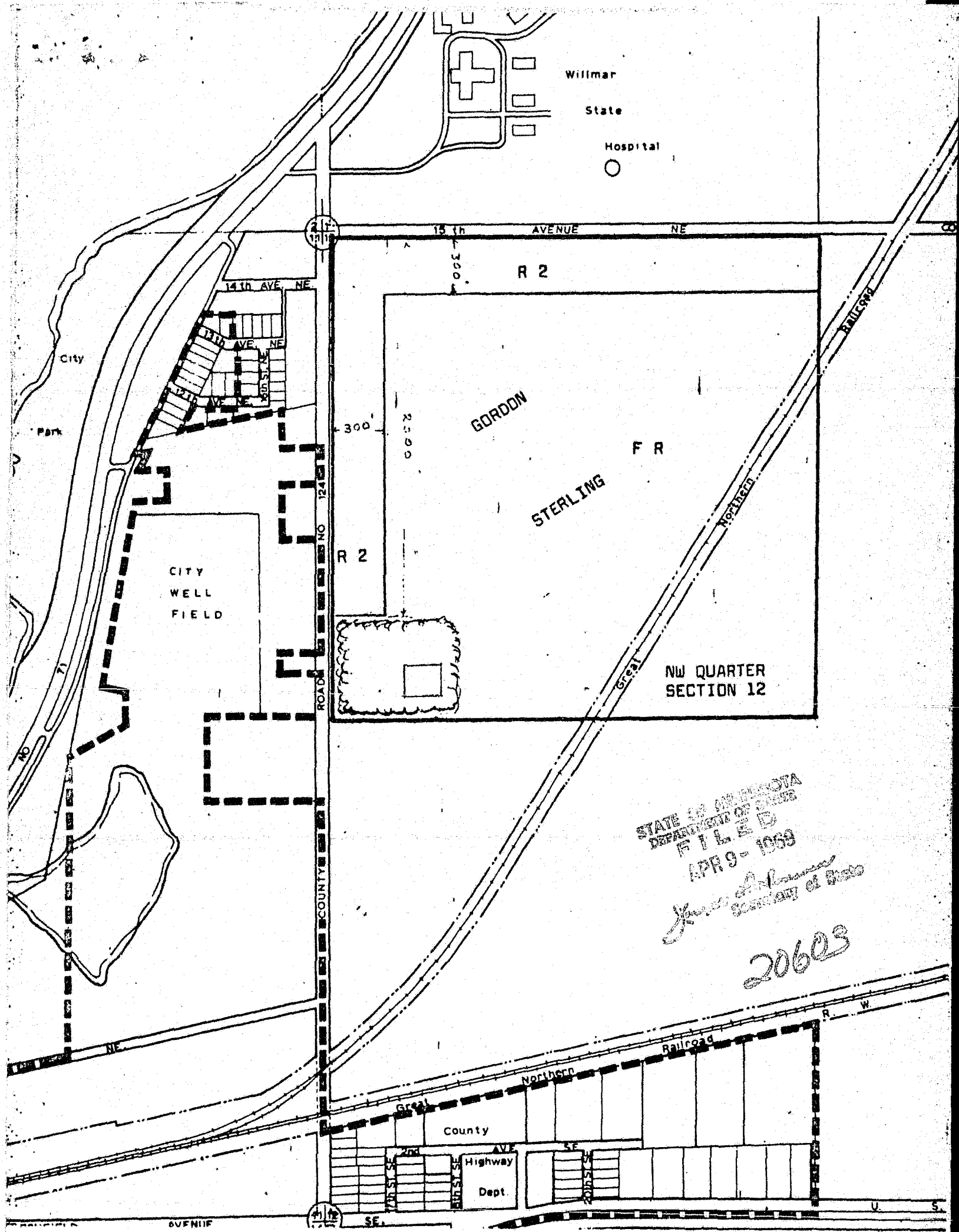

STATE OF MINNESOTA
 DEPARTMENT OF REVENUE
 FILED
 APR 9 - 1969
James A. Johnson
 Secretary of State

20603