

#289

CITY OF HUTCHINSON

Minnesota 55350

OFFICES AT 37 WASHINGTON AVENUE WEST

February 14, 1969

State of Minnesota )  
County of McLeod )  
City of Hutchinson )

I, the undersigned, being the duly qualified and acting City Clerk of the City of Hutchinson, Minnesota, do hereby certify that I have carefully compared the attached copy of Ordinance No. 289, adopted by the City Council on July 24, 1967, with the original on file in my office, and the same is a full true and complete copy thereof.

WITNESS my hand officially as such Clerk and the Corporate Seal of the City this 14th day of February, 1969.

*Agnes I. Monge*

(Mrs.) Agnes I. Monge, City Clerk

SEAL

#20545

STATE OF MINNESOTA  
DEPARTMENT OF STATE  
FILED

MAR 13 1969

*Joseph P. Anderson*  
Secretary of State

(Published in The Hutchinson Leader on Friday, July 28, 1967)

PUBLICATION NO. 1056  
ORDINANCE NO. 289

AN ORDINANCE ANNEXING CERTAIN LANDS TO THE CITY OF HUTCHINSON.  
MCLEOD COUNTY, MINNESOTA.

The City Council of the City of Hutchinson ordains:

SECTION I.

WHEREAS, the City of Hutchinson is the owner of the following described lands lying and being in the County of McLeod and State of Minnesota and described as follows, to-wit:

TRACT I

West 60.0<sup>±</sup> of Tract M of Registered Land Survey No. One (1), McLeod County, Minnesota

West 39.48<sup>±</sup> of Tract E and the East 20.52<sup>±</sup> of Tract D of Registered Land Survey No. One (1), McLeod County, Minnesota

TRACT II

Commencing at the Northeast corner of Lot 92, Lynn Addition to Hutchinson; thence Southerly along the East line of said Lot 92 a distance of 225 feet; thence Westerly on a line parallel with the North line of Lot 92 to a point on the West line of said Lot 92; thence Northeasterly along the West line of said Lot 92 to the Northwest corner of said Lot 92 and thence Easterly along the North line of said Lot 92 to the point of beginning.

TRACT III

That part of the NE $\frac{1}{4}$  of the NW $\frac{1}{4}$  of Section 1, Township 116, Range 30, McLeod County, Minnesota Northeast of the Crow River and West of the Southerly projection of the East line of the SE $\frac{1}{4}$  of the SW $\frac{1}{4}$  of Section 36, Township 117, Range 30, and that part of the SE $\frac{1}{4}$  of the SW $\frac{1}{4}$  of Section 36, Township 117, Range 30, McLeod County, Minnesota described as follows: Beginning at the Southeast corner of said SE $\frac{1}{4}$  of SW $\frac{1}{4}$ , thence North, along the East line of the SE $\frac{1}{4}$  of the SW $\frac{1}{4}$ , a distance of 384.73 feet to the Southerly right-of-way line of the Minnesota Western Railway; thence deflect 102°15' left, along said right-of-way line, a distance of 200 feet; thence deflect 77°45' left a distance of 20 feet more or less to the shore line of the Crow River; thence Southeasterly and Southwesterly, along said shore line, to the South line of said SE $\frac{1}{4}$  of SW $\frac{1}{4}$ ; thence East, along said South line, to said point of beginning, all containing 2.1 acres more or less.

SECTION II.

AND WHEREAS, the City Council of the City of Hutchinson deems it desirable and in the best interest of the City of Hutchinson to annex the above described lands to the City of Hutchinson.

SECTION III.

NOW, THEREFORE, BE IT RESOLVED by the City Council of the City of Hutchinson that the lands described above be and they hereby are annexed to the City of Hutchinson and from and after the date of passage of this Ordinance, said lands shall become a part and portion of the City of Hutchinson with the same force and effect as though originally a part of the City.

SECTION IV.

This Ordinance shall take effect and be in force from and after its publication.

Adopted by the City Council this 24th day of July, 1967.

*Agnes I. Monge*  
\_\_\_\_\_  
(Mrs.) Agnes I. Monge  
City Clerk

#20545  
STATE OF MINNESOTA  
DEPARTMENT OF STATE  
FILED  
MAR 19 1968

*James Robinson*  
Secretary of State

# 20545

STATE OF MINNESOTA  
DEPARTMENT OF STATE  
**FILED**  
MAR 13 1969

*Joseph Selman*  
Secretary of State

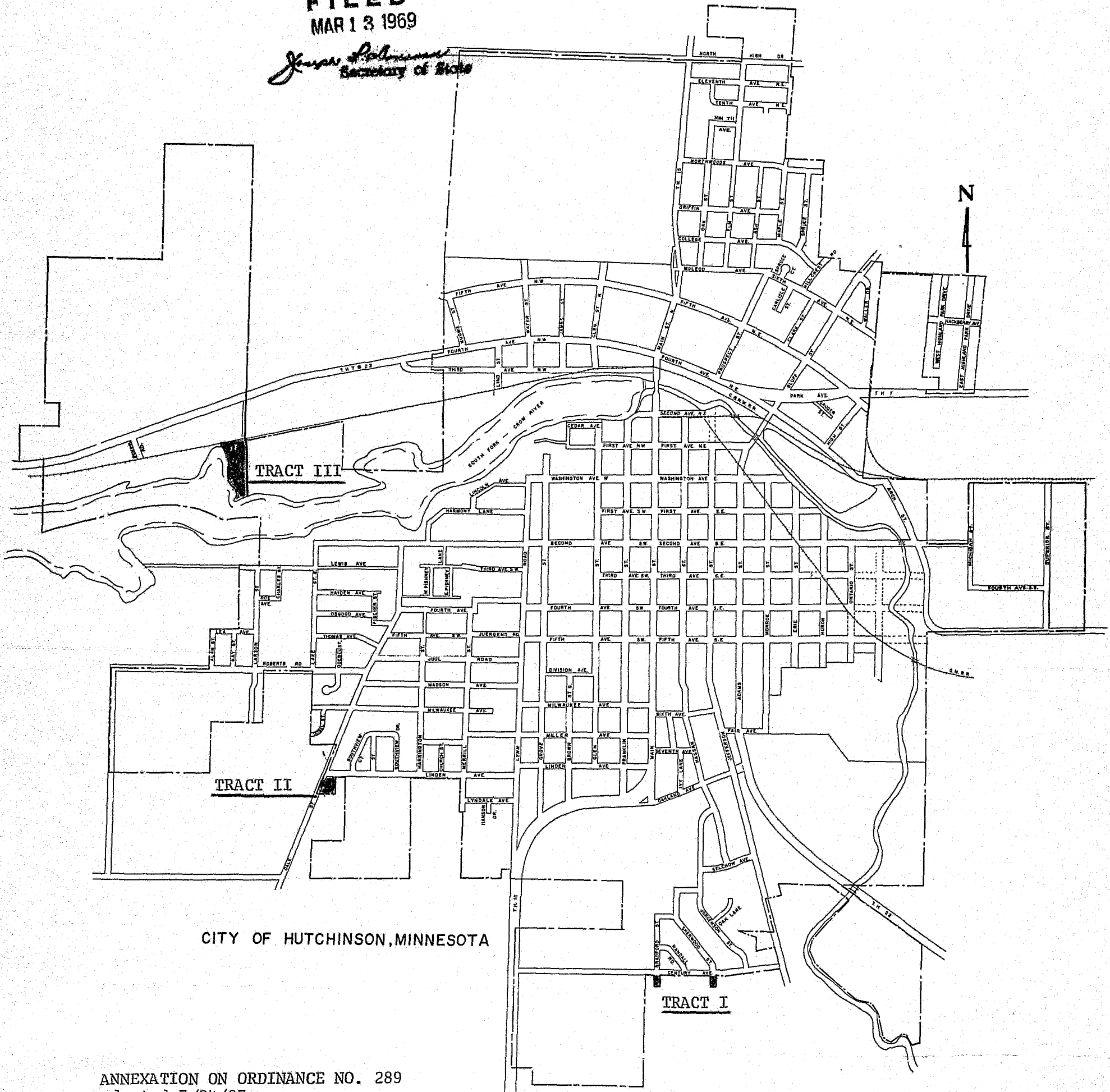

CITY OF HUTCHINSON, MINNESOTA

ANNEXATION ON ORDINANCE NO. 289  
adopted 7/24/67