

FILED
MAR 7 - 1967

James L. Schuman
Secretary of State

BEFORE THE MUNICIPAL COMMISSION
OF THE STATE OF MINNESOTA

Robert W. Johnson
Edward L. Henry
Idor A. Pederson
Peter E. Tibbetts

Chairman
Vice-Chairman
Ex-Officio Member
Ex-Officio Member

IN THE MATTER OF THE PETITION FOR THE INCORPORATION
OF THE VILLAGE OF WOODBURY

ORDER OF INCORPORATION

The Minnesota Municipal Commission met on March 6, 1967, at 9:00 A.M. at 459 Rice Street, St. Paul, Minnesota, to canvas the results of the Woodbury election held February 14, 1967, as a result of an Order of the Commission dated January 10, 1967. The canvas showed that all statutory requirements had been met and that the incorporation had been favorably passed on by the electors, by a vote of 543 For Incorporation and 164 Against Incorporation. The canvas also showed 531 Votes for Optional Plan A as the form of government for the new village and 144 Votes Against Optional Plan A Government.

IT IS HEREBY ORDERED: That Woodbury be incorporated as a village as of March 7, 1967.

IT IS FURTHER ORDERED: That Optional Plan A be adopted as the form of government for the Village of Woodbury.

IT IS ORDERED: That the boundaries and wards of the proposed village shall be the same as stated in the order of the Commission dated January 10, 1967, ordering the election.

IT IS ORDERED: That the new village immediately proceed under 412.021 of Minnesota Statutes to set an election for first officers of the village on April 4, 1967, between the hours of 7:00 o'clock A.M. and 8:00 o'clock P.M. at the following places for the following terms:

Mayor	Term to expire the first business day of January, 1968
One constable	Term to expire the first business day of January, 1968
One Justice of Peace	Term to expire the first business day of January, 1968
One Justice of Peace	Term to expire the first business day of January, 1969
One constable	Term to expire the first business day of January, 1969
Ward 1	One (1) trustee, with the term to expire on the first business day of January, 1970
Ward 2	One (1) trustee, with the term to expire on the first business day of January, 1968
Ward 3	One (1) trustee, with the term to expire on the first business day of January, 1969
A fourth trustee	To be elected at large - Term to expire on the first business day of January, 1969

Voting Places:

Ward 1	Woodbury Volunteer Fire Department 3060 Upper Afton Road
Wards 2 and 3	Woodbury Community Hall Intersection of Lower Afton Road and Valley Creek Road

IT IS FURTHER ORDERED: That a copy of this Order be filed with the Secretary of State and the Washington County Auditor, according to Minnesota Statutes 414.02.

Dated this 6th day of March, 1967
MINNESOTA MUNICIPAL COMMISSION
459 Rice Street
St. Paul, Minnesota 55103

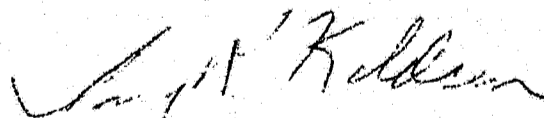

Irving R. Keldsen
S e c r e t a r y



STATE OF MINNESOTA
MUNICIPAL COMMISSION

459 Rice Street
St. Paul, Minnesota 55103

221-2428

ROBERT W. JOHNSON
Anoka
Chairman

THOMAS R. BYRNE
St. Paul
Vice Chairman

EDWARD L. HENRY
St. Cloud
Member

IRVING R. KELDEN
Richfield
Secretary

March 8, 1967

*(Order of Incorporation
rec'd without listed
papers 3-7-67)*

Secretary of State
State Capitol
Washington County Auditor
Stillwater, Minnesota

Gentlemen:

Enclosed please find the Certificate to the
to the original petition, the original order
affirming the petition as submitted, and the
original proofs of posting of the election
notice and incorporation order re the Incor-
poration of the Village of Woodbury.

These papers are filed with you according to
Minnesota Statutes 414.02, Subd. 4.

Cordially,

MUNICIPAL COMMISSION

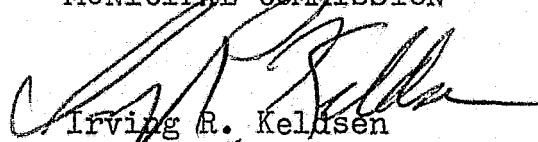
Irving R. Kelden
Secretary

IRK/pdl

Enclosures

BEFORE THE MUNICIPAL COMMISSION
OF THE STATE OF MINNESOTA

Robert W. Johnson	Chairman
Edward L. Henry	Vice-Chairman
Thomas R. Byrne	Member
Idor A. Pederson	Ex-Officio Member
Peter Tibbetts	Ex-Officio Member

IN THE MATTER OF THE PETITION FOR THE INCORPORATION OF THE
VILLAGE OF WOODBURY

The above entitled matter came on for hearing before the Minnesota Municipal Commission, following the receipt of a petition for the incorporation of the Town of Woodbury. Hearings on said petition before the Commission were held in the Woodbury Community Club on July 12, 1966, September 20, 1966, and October 27, 1966.

There was a quorum of the Municipal Commission present at all hearings. The Commission, having duly considered the testimony of the witnesses, the exhibits received in evidence, files and records, arguments of counsel, makes and enters the following:

FINDINGS OF FACT

1. That adequate legal notice of the several hearings and adjourned hearings was given and petitioners were represented at all said hearings.
2. That the land petitioned to be incorporated as the Village of Woodbury is described as follows, to-wit:

All those parts of Sections One (1) through Thirty-six (36), Township Twenty-eight (28) North of Range Twenty-one (21) West, which constitutes the present Town of Woodbury, Washington County, Minnesota
3. That the population of the area within the boundaries of the proposed incorporation as evidenced by the census taken prior to the time that the petition for incorporation was filed in January, 1966, is 4,396.
4. That the acreage contained in the platted area is 800 acres and that the unplatted area is 22,080 acres.

5. That the northwesterly area of the Town, Sections Six (6), Seven (7), Eight (8) and Seventeen (17), is largely platted, and consists of residential homes; there is also located in Section Seven (7) an industrial park now in the process of being developed; commercial development exists along the Lower and Upper Afton Roads and along Minnesota Trunk Highway No. 12 and will continue to expand.

6. That the population of the Town has grown considerably is indicated by the fact that the federal census in 1950 indicated a population of 1,056; the federal census in 1960 indicated a population of 3,013; the incorporation census taken in January of 1966 indicated a population of 4,396.

7. That the population growth and building development have largely taken place in the last eight years; that the future growth of the area will continue at a rapid rate because of its location within the metropolitan area and the location of the freeway system, which will border a portion of the Town on the North and also intersect the Town; that the area at the present time contains both urban and rural development; that it appears that the urban development will continue at a greater rate in the future.

8. That the assessed value of the platted land within the area is \$377,346.00; that the assessed value of the unplatted land is \$1,122,245.00.

9. That the sanitary sewer system is connected with the City of St. Paul treatment plant through the Village of Maplewood; that the Town has limited additional sanitary sewer capacity to serve additional parts of the Town; that the water system which has been installed has additional capacity for expansion and growth in the Town; that said water system was designed so that it can be integrated with further urban growth in the Town.

10. That the Town has adopted a comprehensive land use plan and zoning ordinances which are in full force and effect; that a street plan has been adopted by the Town.

11. That the area is served by the Woodbury Volunteer Fire Department and that the fire station is located at 3060 Upper Afton Road and that plans have been developed for the location of another fire station at the intersection of Woodbury Drive and Upper Afton Road; that the department contains 42 men, all volunteers, and is organized into four companies; that it appears that adequate facilities are available to service that area; that the department has mutual aid agreements with all of the contiguous fire departments.

12. That the police protection of the area includes two constables on call as required, and that these constables also do a certain amount of patrolling each day; the Town is also served by the Washington County Sheriff's Office, which is available in any emergency on very short notice, from either the City of Stillwater or the Village of Cottage Grove.

13. That it is apparent that the Town will grow considerably in the next few years and will become more urban in character and that the Township form of government is inadequate to cope with the problems that have arisen and that will arise with the continued urbanization of the area proposed for incorporation.

14. That the center of the North lane of Minnesota Trunk Highway #12, serves as the North boundary line of the area proposed to be incorporated; that the East boundary line of the area proposed to be incorporated is the center line of County Road 15 and Minnesota Trunk Highway #95; that because of extension of these boundaries, it appears that the enforcement of traffic law on the highways that form the North and East boundaries of the area to be incorporated will become a problem in the future.

15. That it appears that because of the uneven distribution of population in the Town that to award proper representation to the urban and rural areas of the area proposed to be incorporated that three wards of equal population distribution should be created.

CONCLUSIONS OF LAW

1. That the petition to incorporate the Town of Woodbury as the Village of Woodbury is required so that the area can properly be provided with governmental service because of the population growth in said area and rapid urbanization; that the Village form of government can more adequately protect the public health, safety and welfare of the residents of the area.

2. That the north boundary line of the area to be incorporated should be extended to the North right-of-way line of Minnesota Trunk Highway #12, as it is now located; that the East boundary line of the area should be extended to the East right-of-way line of County Road 15, and Minnesota Trunk Highway #95, so as to provide more efficient traffic law enforcement in these areas.

3. It is for the best interest of the area, because of the uneven population distribution, that three wards be created within the proposed village as follows:

WARD 1 - Shall consist of Section Six (6) and area North of said section to the North right-of-way of Minnesota Trunk Highway #12.

WARD 2 - Shall consist of Section Five (5) and the area North of said section to the North Right-of-way line of Minnesota Trunk Highway #12, and also Sections Seven (7), Eight (8), Seventeen (17) and Eighteen (18).

WARD 3 - Shall consist of all of remainder of the area to be incorporated.

That the Mayor and one trustee shall be elected at large.

The above three wards each contain approximately 1500 persons.

O R D E R

IT IS HEREBY ORDERED:

1. That the petition for the Incorporation of the Village of Woodbury is hereby granted.

2. That an election shall be held pursuant to Minnesota Statutes 414.02, to vote on the proposal whether the area shall be incorporated and that said ballots shall bear the words "For Incorporation" and "Against Incorporation", with a square before each of the phrases, in one of which the voters shall make a cross to express his opinion. That the ballot shall also contain the question as to whether or not Optional Plan A shall be adopted as the form of government and that the ballot shall bear the words, "If the incorporation is successful, should Optional Plan A (modifying the standard plan by providing for the appointment by the Council of the Clerk and Treasurer) be adopted as the form of government for the new village? Yes _____ No _____."

Such election shall be held on the 14th day of February, 1967, at the following designated polling places which shall be open from 7:00 o'clock A.M. to 8:00 o'clock P.M.

Precinct 1

Place: Woodbury Community Hall, located at the intersection of Lower Afton Road and Valley Creek Road.

Judges: Bernice Gausman, Newport, Minnesota
Emily Hartung, Newport, Minnesota
Carole Heinbeck, Newport, Minnesota
Marjorie Schultz, 3229 Foxboro Lane, St. Paul
Genevieve Longseth, 3225 Windgate Road, St. Paul

Alternate Judges: Jean Moore, 3255 Foxboro Lane, St. Paul
Jeanette Schilling, Newport, Minnesota

Clerks: Louise Schilling, Newport, Minnesota
Evelyn Lindemann, Lake Elmo, Minnesota

Precinct 2

Place: Woodbury Volunteer Fire Department Building
3060 Upper Afton Road

Judges: Clarie Forsberg, 3177 Edgewood Ave., St. Paul
Elaine Chambers, 172 Meadow Lane, St. Paul
Jeannine Schurrer, 116 Dell Lane, St. Paul
Philomene Filbin, 401 Woodhill Drive, St. Paul
Delores Mickelsen, 398 Pinewood Dr., St. Paul
Patricia Jelk, 350 Pinewood Court, St. Paul

Alternate
Judges: Gwen Labbs, 192 Hattie Lane, St. Paul
Audrey Humphreys, 3006 Cedarwood, St. Paul

Clerks: Sandra Vick, 3144 Ridge Drive, St. Paul
Jerral Fostrud, 371 Pinewood Drive, St. Paul

IT IS FURTHER ORDERED: That said election be conducted insofar as practicable in accordance with election of Town officers. The ballots and necessary supplies shall be provided by the Town of Woodbury.

IT IS FURTHER ORDERED: That the Town of Woodbury shall cause a copy of this Order to be posted not later than 20 days before the election in the area proposed to be incorporated and to be published in a medium of official and legal publication of general circulation in the area proposed for incorporation two successive weeks before the 14th day of February, 1967.

IT IS FURTHER ORDERED: That all proper expenses incurred in the election shall be borne by the Town of Woodbury.

Dated this 10th day of January, 1967

MINNESOTA MUNICIPAL COMMISSION
459 Rice Street
St. Paul, Minnesota 55103

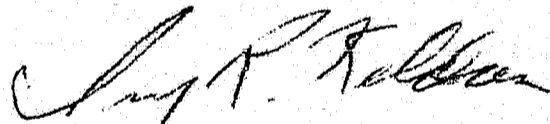

Irving R. Keldsen
Secretary

TOWN OF WOODBURY

Washington County, Minnesota

FEB 14 1967

Office of Clerk

STATE OF MINNESOTA
COUNTY OF WASHINGTON
TOWN OF WOODBURY

)
) ss
)

AFFIDAVIT OF POSTING

NOTICE OF ELECTION

WILLIAM R. KRUEGER, being first duly sworn on oath deposes and says that on the 25 day of January, 1967, he posted the order for the Incorporation of the Village of Woodbury, a true and correct copy of which is hereto attached, at the polling places designated, to-wit: Woodbury Community Hall, 3433 Upper Afton Road and Woodbury Volunteer Fire Department Building, 3060 Upper Afton Road, and at each of the following public and conspicuous places within said Town:

One at Woodbury Town Office

One at Upper Afton Rd. & Century Ave.

One at Bailey Rd. & Woodbury Dr.

W. R. Krueger
Deputy Clerk

Subscribed and sworn to before me

this 7 day of February, 1967

Notary Public, Washington County, Minnesota

My commission expires March, 1968

Rufus Brown

O R D E R

IT IS HEREBY ORDERED:

1. That the petition for the Incorporation of the Village of Woodbury is hereby granted.

2. That an election shall be held pursuant to Minnesota Statutes 414.02, to vote on the proposal whether the area shall be incorporated and that said ballots shall bear the words "For Incorporation" and "Against Incorporation", with a square before each of the phrases, in one of which the voters shall make a cross to express his opinion. That the ballot shall also contain the question as to whether or not Optional Plan A shall be adopted as the form of government and that the ballot shall bear the words, "If the incorporation is successful, should Optional Plan A (modifying the standard plan by providing for the appointment by the Council of the Clerk and Treasurer) be adopted as the form of government for the new village? Yes _____ No _____."

Such election shall be held on the 14th day of February, 1967, at the following designated polling places which shall be open from 7:00 o'clock A.M. to 8:00 o'clock P.M.

Precinct 1

Place: Woodbury Community Hall, located at the intersection of Lower Afton Road and Valley Creek Road.

Judges: Bernice Gausman, Newport, Minnesota
Emily Hartung, Newport, Minnesota
Carole Heinbeck, Newport, Minnesota
Marjorie Schultz, 3229 Foxboro Lane, St. Paul
Genevieve Longseth, 3225 Windgate Road, St. Paul

Alternate Judges: Jean Moore, 3255 Foxboro Lane, St. Paul
Jeanette Schilling, Newport, Minnesota

Clerks: Louise Schilling, Newport, Minnesota
Evelyn Lindemann, Lake Elmo, Minnesota

Precinct 2

Place: Woodbury Volunteer Fire Department Building
3060 Upper Afton Road

Judges: Clarie Forsberg, 3177 Edgewood Ave., St. Paul
Elaine Chambers, 172 Meadow Lane, St. Paul
Jeannine Schurrer, 116 Dell Lane, St. Paul
Philomene Filbin, 401 Woodhill Drive, St. Paul
Delores Mickelsen, 398 Pinewood Dr., St. Paul
Patricia Jelk, 350 Pinewood Court, St. Paul

Alternate
Judges: Gwen Labbs, 192 Hattie Lane, St. Paul
Audrey Humphreys, 3006 Cedarwood, St. Paul

Clerks: Sandra Vick, 3144 Ridge Drive, St. Paul
Jerral Fostrud, 371 Pinewood Drive, St. Paul

IT IS FURTHER ORDERED: That said election be conducted insofar as practicable in accordance with election of Town officers. The ballots and necessary supplies shall be provided by the Town of Woodbury.

IT IS FURTHER ORDERED: That the Town of Woodbury shall cause a copy of this Order to be posted not later than 20 days before the election in the area proposed to be incorporated and to be published in a medium of official and legal publication of general circulation in the area proposed for incorporation two successive weeks before the 14th day of February, 1967.

IT IS FURTHER ORDERED: That all proper expenses incurred in the election shall be borne by the Town of Woodbury.

Dated this 10th day of January, 1967

MINNESOTA MUNICIPAL COMMISSION
459 Rice Street
St. Paul, Minnesota 55103

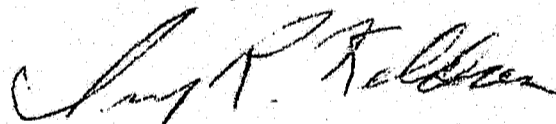

Irving R. Keldsen
Secretary

AFFIDAVIT OF PUBLICATION

FEB 14 1967

The Reporter

Oakdale Road & Highway 110, South St. Paul, Minnesota

State of Minnesota }
County of Dakota } SS.

GERALD SEXTON, being duly sworn, on oath says he is and during all the times herein stated has been the General Manager of the newspaper known as the South St. Paul Reporter and has full knowledge of the facts herein stated as follows: (1) Said newspaper is printed in the English language in newspaper format and in column and sheet form equivalent in printed space to at least 900 square inches. (2) Said newspaper is a weekly and is distributed at least once each week. (3) Said newspaper has 50% of its news columns devoted to news of local interest to the community which it purports to serve and does not wholly duplicate any other publication and is not made up entirely of patents, plate matter and advertisements. (4) Said newspaper is circulated in and near the municipality which it purports to serve, has at least 500 copies regularly delivered to paying subscribers, has an average of at least 75% of its total circulation currently paid or no more than three months in arrears and has entry as second-class matter in its local post-office. (5) Said newspaper purports to serve the City of South St. Paul in the County of Dakota and it has its known office of issue in the Village of Inver Grove Heights in said county, established and open during its regular business hours for the gathering of news, sale of advertisements and sale of subscriptions and maintained by the managing officer of said newspaper or persons in its employ and subject to his direction and control during all such regular business hours and devoted exclusively during such regular business hours to the business of the newspaper and business related thereto. (6) Said newspaper files a copy of each issue immediately with the State Historical Society. (7) Said Newspaper has complied with all the foregoing conditions for at least two years preceding the day or dates of publication mentioned below. (8) Said newspaper has filed with the Secretary of State of Minnesota prior to January 1, 1966 and each January 1 thereafter an affidavit in the form prescribed by the Secretary of State and signed by the managing officer of said newspaper and sworn to before a notary public stating that the newspaper is a legal newspaper.

He further states on oath that the printed SAID NOTICE

hereto attached as a part hereof was cut from the columns of said newspaper, and was printed and published therein in the English language,

once each week, for 2 successive weeks; that it was first so published on Wednesday

the 1 day of Feb. 67 and was thereafter printed and published

on every Wednesday to and including the 8 day of Feb. 67 and

that the following is a printed copy of the lower case alphabet from A to Z, both inclusive, and is here acknowledged as being the size and kind of type used in the composition and publication of said notice, to wit:

Order for the Incorporation of the Village of Woodbury.
abcdefghijklmnopqrstuvwxyz

Gerald Sexton
Gerald Sexton General Manager

Subscribed and sworn to before me this 10 day of Feb. 1967.

(Notarial Seal)

Barbara Samuelson

Notary public, County, Minnesota

My Commission Expires 19

BARBARA SAMUELSON,
Notary Public, County of Dakota, Minn.
My Commission Expires Nov. 3, 1971

(Official Publication)
ORDER
IT IS HEREBY ORDERED:
1. That the petition for the Incorporation of the Village of Woodbury is hereby granted.
2. That an election shall be held pursuant to Minnesota Statutes 414.02, to vote on the proposal whether the area shall be incorporated and that said ballots shall bear the words "For Incorporation" and "Against Incorporation", with a square before each of the phrases, in one of which the voters shall make a cross to express his opinion. That the ballot shall also contain the question as to whether or not Optional Plan A shall be adopted as the form of government and that the ballot shall bear the words, "If the incorporation is successful, should Optional Plan A (modifying the standard plan by providing for the appointment by the Council of the Clerk and Treasurer) be adopted as the form of government for the new village? Yes/No."
Such election shall be held on the 14th day of February, 1967, at the following designated polling places which shall be open from 7:00 o'clock a.m. to 8:00 o'clock p.m.
Precinct 1
Place: Woodbury Community Hall, located at the intersection of Lower Afton Road and Valley Creek Road.
Judges: Bernice Gausman, Newport, Minnesota; Emily Hartung, Newport, Minnesota; Carole Heinbech, Newport, Minnesota; Marjorie Schiltz, 3229 Foxboro Lane, St. Paul; Genevieve Longest, 3225 Windgate Road, St. Paul.
Alternate Judges: Jean Moore, 3255 Foxboro Lane, St. Paul; Jeanette Schilling, Newport, Minnesota.
Clerks: Louise Schilling, Newport, Minnesota; Evelyn Lindemann, Lake Elmo, Minnesota.
Precinct 2
Place: Woodbury Volunteer Fire Department Building 3060 Upper Afton Road.
Judges: Claris Forsberg, 3177 Edgewood Ave., St. Paul; Elaine Chambers, 172 Meadow Lane, St. Paul; Jeannine Schurrer, 118 Dell Lane, St. Paul; Philomena Elliott, 401 Woodhill Drive, St. Paul; Dolores Mickelsen, 398 Pinewood Dr., St. Paul; Patricia Galt, 350 Pinewood Court, St. Paul.
Alternate Judges: Gwen Labbs, 192 Hattie Lane, St. Paul; Audrey Humphreys, 3006 Cedarwood, St. Paul.
Clerks: Sandra Vick, 3144 Ridge Drive, St. Paul; Jerral Foster, 371 Pinewood Drive, St. Paul.
IT IS FURTHER ORDERED: That said election be conducted insofar as practicable in accordance with election of Town officers. The ballots and necessary supplies shall be provided by the Town of Woodbury.
IT IS FURTHER ORDERED: That the Town of Woodbury shall cause a copy of this Order to be posted not later than 20 days before the election in the area proposed to be incorporated and to be published in a medium of official and legal publication of general circulation in the area proposed for incorporation two successive weeks before the 14th day of February, 1967.
IT IS FURTHER ORDERED: That all proper expenses incurred in the election shall be borne by the Town of Woodbury.
Dated this 10th day of January, 1967.
MINNESOTA MUNICIPAL COMMISSION
459 Rice Street
St. Paul, Minnesota 55103
IRVING R. KELDSEN
Secretary
(Feb. 1, 8, 1967) - SSP-4A

PETITION FOR INCORPORATION

IN THE MATTER OF THE PETITION OF CERTAIN FREEHOLDERS TO
INCORPORATE THE VILLAGE OF WOODBURY IN THE COUNTY OF
WASHINGTON AND STATE OF MINNESOTA.

TO THE MUNICIPAL COMMISSION OF THE STATE OF MINNESOTA:

We, the undersigned resident freeholders of the territory hereinafter described, hereby petition your Commission to hold a public hearing on the question of incorporating the same as a Village in accordance with Minnesota Statutes Annotated, Section 414.02 and that more than One hundred (100) freeholders have affixed their signatures hereto as required by law, and for that purpose respectfully state:

1. All your petitioners are qualified freeholders and residents within the territory hereinafter described.
2. None of the territory hereinafter described is now a part of any incorporated city or village.
3. The territory which it is proposed to incorporate consists partly of lands which have been platted into lots and blocks, which plats have been duly and legally made and certified according to the laws of this State and filed in the office of the Register of Deeds of the County of Washington, State of Minnesota; and partly of unplatted lands which adjoin the platted areas; and all of said land is about to become urban or suburban in character. All of said lands, platted and unplatted, lies entirely within the County of Washington and State of Minnesota; and the description of said lands, platted and unplatted, is as follows:

All those parts of Sections One (1) through Thirty-six (36), Township Twenty-eight (28) North of Range Twenty-one (21) West which constitute the Town of Woodbury, Washington County, Minnesota.
4. Attached hereto and made a part hereof is a map setting forth the boundaries of the foregoing lands.
5. The quantity of land, both platted and unplatted, embraced within the foregoing description as shown on the attached map, is 22,880 acres. Said town consists of approximately 800 acres of platted land and the balance of said land is unplatted.

6. The foregoing lands, both platted and unplatted, embraced within the foregoing description and bounded as shown on the attached map, contain a resident population of 4396 persons, as ascertained by a census to which this petition is attached.

7. The assessed valuation of the foregoing lands, both platted and unplatted, is \$ 1,499,591.⁸⁰ The assessed valuation of the platted lands is \$ 377,346.⁰⁰ and the assessed valuation of unplatted lands is \$ 1,122,245.¹⁰

8. That the Town of Woodbury has a municipal water system that serves the northwest portion of the Town and is designed so that it can be readily expanded to serve additional areas. The Town of Woodbury also has a sanitary sewer system that serves the northwesterly portion of said Town and serves approximately the same area that is served by the water system.

9. Police protection consists of two (2) constables who operate on a part-time basis and the Sheriff's office of Washington County, Minnesota also police the area and furnish police protection whenever it is required.

10. The Town of Woodbury obtains its fire protection from the Woodbury Volunteer Fire Department, which serves the entire Township.

11. The name of the Village proposed to be incorporated is the VILLAGE OF WOODBURY, Washington County, Minnesota.

Dated this ____ day of December, 1965.

<u>NAME</u>	<u>ADDRESS</u>
<u>Harold R. Jones</u>	<u>1281 Tower Dr Newport</u>
<u>Margaret L. Beck</u>	<u>266 So Century St Paul 19</u>
X <u>Orville Spelberg</u>	<u>3384 Bailey Rd</u>
<u>Lyle Thorstein</u>	<u>3456 Hudson Rd</u>
<u>Myron V. Dallis</u>	<u>3334 Hudson Rd</u>
<u>James Steen</u>	<u>3334 Hudson Rd</u>
<u>Richard M. Outh</u>	<u>3500 Afton Road</u>
<u>Bernard H. Ellett</u>	<u>113 Woodbine Ave.</u>
<u>Herman Lindeman</u>	<u>3951 Valley Creek Rd Lake Elmo,</u>

Earl George Bot 93, R.R. 1, Newport
 Amelbeten 201 Meadow Lane St Paul 19 *
 Reuben Niffeldt 3224 Tamarack Ln. *
 Dale Burmeister 3140 Ridge Dr. St Paul 19*
 Richard Jagetz 152 Dorby
 Mrs. Van Spitzer 144 Garbe
 Mr. Oscar J. Beck 1011 Willow Lane
 Mrs. Neil Dew Fresno 153 Martha Lane
 Marvin L. Madsen 1107 Tower Dr. R.R. 1 Newport
 Lorraine Hart 3668 Brookview Rd. Lake Elmo,
 Debra J. Jansen R.R. 1 Haven Ave Newport
 Robert J. Michelson 398 Pinewood Drive
 Roger E. Miller 381 - Pinewood Ct.
 Kenneth Mahl Jr 3154 Bailey Rd St Paul
 Art Warwick 3251 Steplerview Rd, St. Paul 19,
 Harvey Lillestok 173 Edgewood Ave St. Paul 19
 Mrs Paul H. Thore 168 Edgewood Ave, St. Paul 19
 Mrs Charles L. Austin 225 Meadow Lane
 Paula J. Lister 140 Edgewood Ave
 Edna L. Blum 189 Sherrie Lane St. P. C.
 Calvin T. Jansen 120 Woodbine Ct. St. Paul, 19
 Robert A. Schultz 3037 Cedarwood Dr. St Paul 19
 Mel Woodruff Newport 1926

Howard A Simmons

3568 Military Rd Rt #2

Dorothy E Simmons

3568 Military Rd Rt #2

NAME	ADDRESS
Dorille Bolenberg	3384 Barby Rd Newport Minn
Robert Watterstaff	3597 Military Road Newport Minn
Alice M. Bernard	Hudson Rd Lake Elmo Minn
John H. Stauffer	3236 Coakwood Rd St. Paul 19, Minn
BA Hill	109 Woodbine
W L Vick	3144 Ridge Drive
Paul E. Garbe	710 Woodbine Drive St. Paul - 19
George McHattie	R2 Box 427 Newport
Les Ewert	3050 Highwood Ave

Laurena J. Chrel	3189 Lower Apple Road
John Lurvey	550 Cottage Grove Dr. Newport
George Schilling	Newport Minn
Conrad Ruck	Newport Minn
George Seerson	3464 Dale Rd. Newport
Orvis Schilling	Newport Rt 1 Box 64
Morris H. Richter	1253 Tower Dr. Rt #2
Melford Metzger	355 21 St.
James M. Morgan	Tower Dr.
Jonas A. Sheppard	552 Woodbury Drive
Rufus W. Brown	Box 97 Rt 1 Newport, Minn 55055
Thomas J. Mangay	160 Garbe Ave St Paul 19, Minn
Kenneth Walteroff	709 Woodlawn Drive, St. Paul, Minn
Howard Papel	152 Edgewood Ave
Merlin Jakobe	Upper of St Paul, Minn
Leslie Calderon	297 Woodbury Drive Lake Elmo Minn
Howard Radbe	148 meadow lane
W.E. Maki	1781 Woodlane Dr.
Maynard J. Hees	3779 Bailey Rd Newport Minn.
Walter Raths	Newport Minn Rt. 1, Box 68
Ed. John M. Johnson	Rt 1 Box 73 Newport Minn
Thomas S. Pariseau	3325 Glen Road Newport Minn
Groves Kraemer	112 Ridge Dr. St Paul Minn
Bernard J. Grundhauser	3121 Ridge Dr. St Paul Minn
Misty E. Soy	168 Meadow Lane St Paul Minn
Chubert	101 Radio Dr Lake Elmo 1, Minn
	172 Hattie Lane St Paul 19.
	112 woodbury Ct

34 L.V. Rambo
 Lowell Wilson
 Anthony J. Mangione
 Erich Scheel
 Paul S. Morris Jr.
 10 Theo. M. Schultz
 W.O. Stevenson
 Mrs. J. Connally
 Mrs. G. Hilker
 Alfred G. Brander
 Ralph V. Alder
 David B. Ubel
 Lois M. Ubel
 Ronald C. Longsett
 Ed Genevieve Longsett
 Ed W. Burkhardt
 Joan G. Burkhardt
 Rod Haugland
 Paul Wind
 Kenneth Jay
 Tobias Acciani
 F. Craig Jilk
 Paul Jensen
 Greg E. Anderson
 Van S. Spidauer
 Neal E. Moore
 James Jensen
 Joseph Jensen

3336 Hudson Road Lake Elmo
 3396 " " " "
 3425 Hudson Rd " "
 Lake Elmo Minn.
 993 Woodbury Drive Lake Elmo
 3229 Foxboro Lane St. Paul 19
 3225 Foxboro Lane St. Paul 19
 460 Lamplight Dr. St Paul 19
 3216 Windgate Rd St. Paul, 19
 3236 Windgate Rd St Paul 19
 3241 Windgate Road St Paul
 514 Lamplight Dr St Paul 19
 514 Lamplight Dr. St Paul 19
 3225 Windgate Rd St Paul 19
 3225 Windgate Rd St Paul 19
 3233 Foxboro Lane
 ST Paul 19
 3233 Foxboro Lane St Paul 19
 3001 Upper Afton Rd St Paul
 3108 Ridge Drive St Paul 19
 380 Pinewood Drive, St Paul 19
 355 Parkwood Dr. St Paul 19
 350 Pine wood Ct. St. Paul 19
 3205 Carwood Circle St Paul 19
 384 Woodhill Drive St. Paul 19
 360 Woodhill Dr. St. Paul 19.
 355 Woodhill Dr. St. Paul
 351 Woodhill Dr St Paul 19
 359 Willowood Dr. St. Paul

Arman P. DeLo
Glen Cehlke
Ronald Edmund
Robert A. Neill
Robert E. Grover
Mrs. Richard Orth
Mrs. Ray Southward
Raymond G. Southward
Orwin DeBighamer
Glean Newport

Paul L. Smy
Mrs John L. Casseur
Duane Kingan
Gleam Sorensen
Jess Gilbert
Duane Smith
Mrs Duane Smith
Billy J. Gouff
James V. Hostmann
Tom I. Lick
John W. Moore
Donald J. Frasher
Allen N. Webster Jr.
Mrs. Corvill Lichtenberg

3080 Pinewood Dr, St Paul
Newport Minn.
184 Hattie Lane
141 Sherris Lane
161 Esther Lane
Rt. 1, Box 829, Newport
125 Woodbine St Paul 19
Minn
125 Woodbine St Paul
Minn
3225 Coakwood Rd. St Paul
55119
3422 Hudson Rd.
Lake Elmo

104 Garbe
Rt 1 Box 55A 2nd St
3488 Hudson Rd.
188 Hattie Lane
3022ruppenator
104 Edgewood Ave
104 Edgewood Ave
185 Hattie Lane
189 HATTIE LANE
104 Willow Lane
100 Meadow Ct.
144 Edgewood Ave
205 Meadow Lane
Rt. 1, Box 66, Newport

WOODBURY

TOWNSHIP 28 N.

RANGE 21W

CODE LETTER K

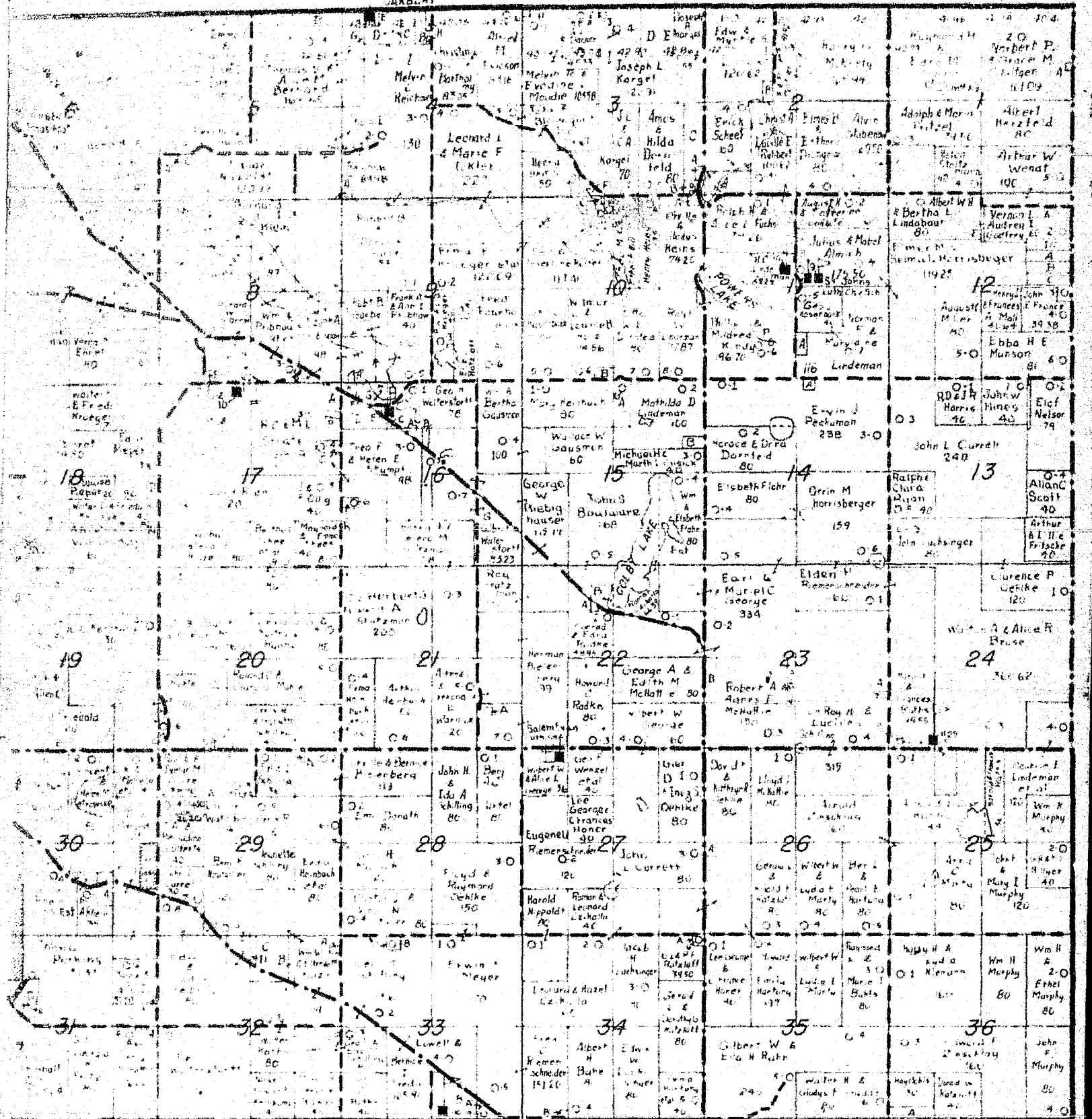

STAGE GROVE

TWP

THE PRECEDING

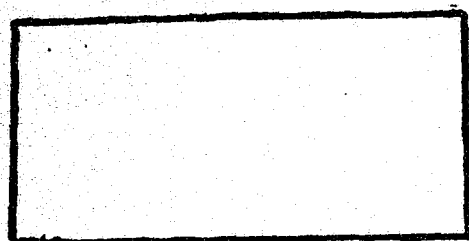

DOCUMENT(S)

HAVE BEEN

REFILMED

TO ENSURE

LEGIBILITY



WOODBURY

TOWNSHIP 28 N.

RANGE 21W

CODE LETTER K

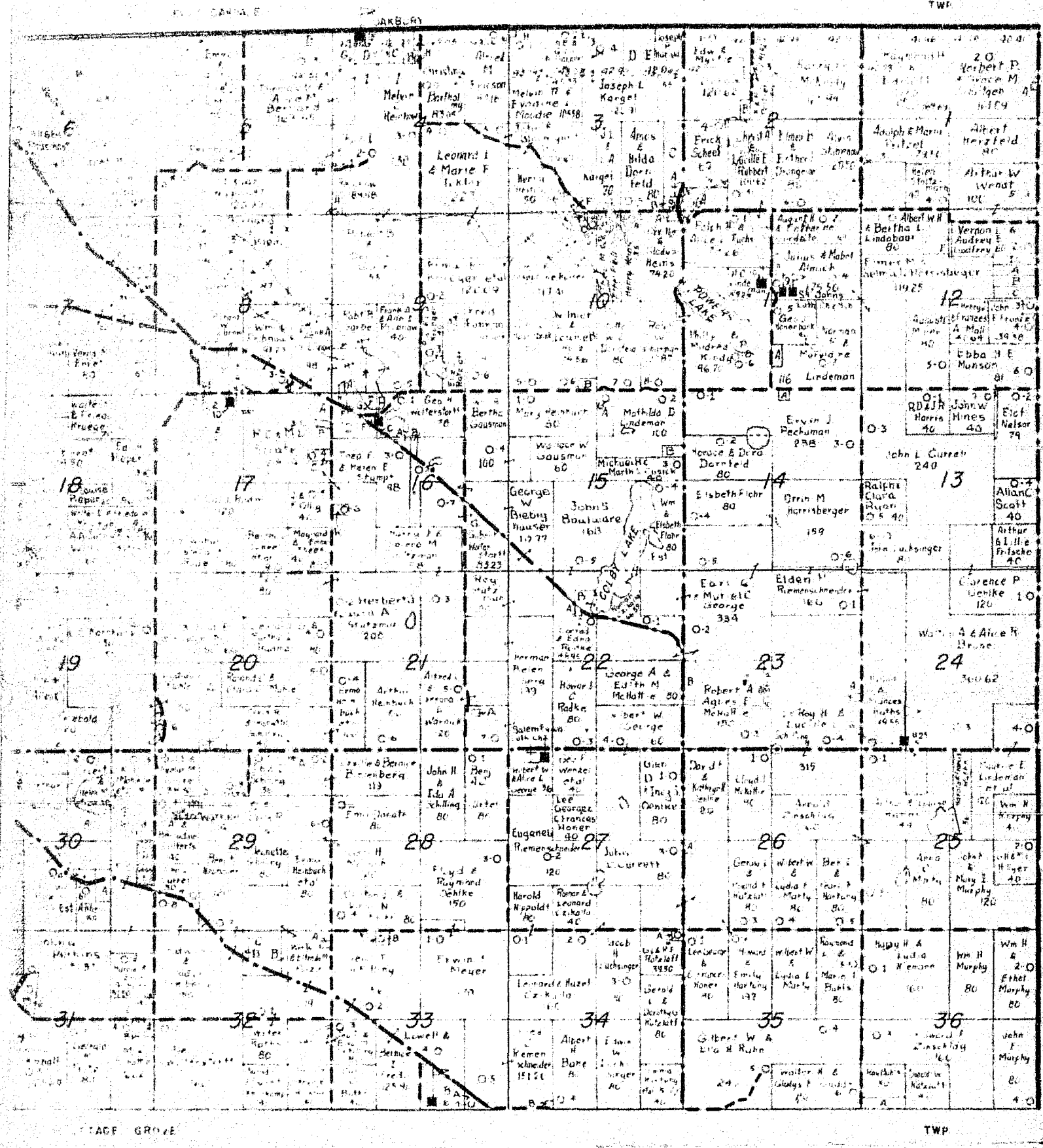

SMALL TRACT OWNERS

ACRES	SEC	TRACT	ACRES	SEC	TRACT	ACRES	SEC	TRACT
1000	12	A Fredt Jennette Colburn	1000	18	C Peter Graywack	1841	3	A Harris J & Be. of M Jekler
1000	12	B Peter J Zweber	1000	18	D John S. Peeper	1841	3	B Lawrence E Larsson
1000	12	C Walter J Lanning	1000	18	E J. Howard H. Hare of Chas. W. Hare	1841	3	C Chas. C Jackson
1000	12	D Henry & A. M. Haren	1000	18	F Woodbury Twp	1841	3	D Sunny Park Ridge to H. S. Hare
1000	12	E Woodbury Township	1000	18	G The Neighborhood House Assn	1841	3	E A. Harris & A. S. Wacker
1000	12	F Robert R. H. Hartford	1000	18	H Anderson H. Hare	1841	3	F Harris A. Hare
1000	12	G H. Bert L. A. J. J. J.	1000	18	I ...	1841	3	G ...
1000	12	H ...	1000	18	J ...	1841	3	H ...
1000	12	I ...	1000	18	K ...	1841	3	I ...
1000	12	J ...	1000	18	L ...	1841	3	J ...
1000	12	K ...	1000	18	M ...	1841	3	K ...
1000	12	L ...	1000	18	N ...	1841	3	L ...
1000	12	M ...	1000	18	O ...	1841	3	M ...
1000	12	N ...	1000	18	P ...	1841	3	N ...
1000	12	O ...	1000	18	Q ...	1841	3	O ...
1000	12	P ...	1000	18	R ...	1841	3	P ...
1000	12	Q ...	1000	18	S ...	1841	3	Q ...
1000	12	R ...	1000	18	T ...	1841	3	R ...
1000	12	S ...	1000	18	U ...	1841	3	S ...
1000	12	T ...	1000	18	V ...	1841	3	T ...
1000	12	U ...	1000	18	W ...	1841	3	U ...
1000	12	V ...	1000	18	X ...	1841	3	V ...
1000	12	W ...	1000	18	Y ...	1841	3	W ...
1000	12	X ...	1000	18	Z ...	1841	3	X ...

C E N S U S

<u>ADDRESS</u>	<u>RESIDENTS</u>	<u>ADDRESS</u>	<u>RESIDENTS</u>
3240 Coachwood Road	6	384 Parkwood Drive	6
3236 " "	3	385 " "	5
3233 " "	4	388 " "	4
3229 " "	2	392 " "	5
3201 " "	5	395 " "	4
3197 " "	5	396 " "	4
3193 " "	2		
3185 " "	4	378 Woodhill Drive	3
		380 " "	5
497 Lamplight Drive	4	384 " "	5
514 " "	6	388 " "	3
460 " "	6	390 " "	4
444 " "	4	394 " "	3
439 " "	4	400 " "	3
435 " "	7	401 " "	4
428 " "	4	405 " "	2
		407 " "	3
3244 Foxboro Lane	5		
3241 " "	4	381 Woodhill Court	4
3240 " "	2	383 " "	3
3236 " "	2	385 " "	9
3233 " "	5	387 " "	2
3229 " "	6	389 " "	3
3225 " "	4	391 " "	2
3220 " "	3	393 " "	7
3217 " "	4	395 " "	5
		397 " "	6
3216 Windgate Road	3	399 " "	4
3225 " "	5		
3221 " "	4	380 Pinewood Drive	4
3212 " "	3	381 " "	2
3220 " "	6	384 " "	3
3224 " "	3	388 " "	4
3229 " "	3	389 " "	3
3233 " "	5	390 " "	7
3228 " "	2	391 " "	5
3232 " "	4	394 " "	5
3236 " "	4	395 " "	4
3237 " "	5	398 " "	5
3241 " "	3	3079 " "	4
		3080 " "	5
351 Parkwood Drive	3	3081 " "	5
353 " "	3	3084 " "	4
355 " "	5	3085 " "	2
361 " "	4	3091 " "	4
363 " "	7	3099 " "	6
364 " "	2		
365 " "	3	351 Pinewood Court	3
370 " "	2	349 " "	4
371 " "	4	350 " "	4
372 " "	4	352 " "	5
373 " "	5	354 " "	4
374 " "	4	356 " "	6
375 " "	4	355 " "	3
380 " "	3	358 " "	4

<u>ADDRESS</u>	<u>RESIDENTS</u>	<u>ADDRESS</u>	<u>RESIDENTS</u>
360 Pinewood Drive	5	104 Edgewood Avenue	5
362 " "	4	105 " "	4
361 " "	4	108 " "	3
364 " "	2	109 " "	5
368 " "	6	112 " "	2
369 " "	8	113 " "	3
370 " "	4	116 " "	5
371 " "	3	117 " "	5
375 " "	3	120 " "	4
374 " "	5	121 " "	8
378 " "	4	124 " "	4
		125 " "	8
367 Woodhill Circle	6	128 " "	6
379 " "	4	129 " "	6
365 " "	5	132 " "	3
369 " "	5	133 " "	3
371 " "	6	136 " "	5
373 " "	6	137 " "	4
375 " "	3	140 " "	4
377 " "	4	141 " "	4
		145 " "	6
3023 Cedarwood Circle	7	149 " "	4
3027 " "	4	152 " "	8
		153 " "	5
370 Woodhill Drive	5	156 " "	4
368 " "	4	157 " "	5
364 " "	2	160 " "	6
360 " "	4	161 " "	5
363 " "	5	164 " "	6
361 " "	4	165 " "	5
357 " "	4	169 " "	7
354 " "	3		
355 " "	3	101 Woodbine Avenue	7
352 " "	7	104 " "	2
353 " "	4	105 " "	3
350 " "	4	108 " "	3
351 " "	3	109 " "	4
		112 " "	12
3041 Cedarwood Drive	5	113 " "	6
3037 " "	2	116 " "	6
3034 " "	2	117 " "	4
3031 " "	7	120 " "	6
3029 " "	3	121 " "	6
3026 " "	5	124 " "	2
3022 " "	5	125 " "	6
3018 " "	4	128 " "	4
3010 " "	3	132 " "	3
3006 " "	3	133 " "	12
3000 " "	4	136 " "	6
		137 " "	5
3007 Birchwood Road	6	140 " "	3
3024 " "	6	141 " "	5
		144 " "	3
3009 Cedarwood Court	5	145 " "	4
3011 " "	3	149 " "	0

<u>ADDRESS</u>	<u>RESIDENTS</u>	<u>ADDRESS</u>	<u>RESIDENTS</u>
160 Woodbine Avenue	7	137 Sherrie Lane	2
164 " "	6	141 " "	5
165 " "	6	145 " "	5
168 " "	7	161 " "	5
169 " "	5	165 " "	4
		169 " "	2
104 Woodbine Court	7	173 " "	5
108 " "	3	177 " "	6
112 " "	5	181 " "	2
116 " "	6	185 " "	6
120 " "	6	189 " "	5
		193 " "	5
100 Dell Lane North	6	197 " "	5
104 " " "	0	128 " "	3
108 " " "	6	132 " "	4
112 " " "	5	136 " "	3
116 " " "	3	140 " "	8
120 " " "	4	144 " "	3
124 " " "	5	148 " "	2
128 " " "	5	160 " "	5
132 " " "	6	164 " "	4
		168 " "	6
101 Dell Lane South	2	172 " "	5
105 " " "	6	176 " "	5
109 " " "	5	180 " "	2
113 " " "	1	184 " "	2
117 " " "	7	188 " "	6
121 " " "	6	192 " "	5
125 " " "	4	196 " "	7
129 " " "	4	200 " "	7
133 " " "	3	204 " "	5
137 " " "	7	208 " "	5
141 " " "	4	212 " "	4
145 " " "	6		
		144 Esther Lane	2
100 Meadow Court	7	145 " "	7
104 " "	5	148 " "	5
108 " "	3	149 " "	2
112 " "	5	152 " "	0
		153 " "	5
200 Scheel Drive	7	156 " "	3
204 " "	6	157 " "	4
208 " "	6	160 " "	6
212 " "	5	161 " "	6
216 " "	3	164 " "	3
217 " "	6	165 " "	4
220 " "	6	168 " "	4
		169 " "	6
124 Sherrie Lane	3	172 " "	6
120 " "	4	173 " "	5
121 " "	2	176 " "	3
125 " "	3	177 " "	5
129 " "	4	180 " "	4
133 " "	5	181 " "	3

<u>ADDRESS</u>	<u>RESIDENTS</u>
184 Esther Lane	5
185 " "	8
188 " "	3
144 Martha Lane	4
145 " "	3
148 " "	3
149 " "	3
152 " "	3
153 " "	2
157 " "	6
161 " "	4
164 " "	11
165 " "	6
168 " "	5
169 " "	6
172 " "	2
173 " "	9
176 " "	4
177 " "	5
180 " "	3
181 " "	5
184 " "	5
185 " "	2
188 " "	5
189 " "	5
192 " "	7
193 " "	5
195 " "	7
197 " "	5
200 " "	3
201 " "	8
160 Hattie Lane	5
161 " "	6
164 " "	4
165 " "	5
168 " "	5
169 " "	4
172 " "	5
173 " "	4
176 " "	6
177 " "	5
180 " "	6
181 " "	4
184 " "	5
185 " "	4
188 " "	5
189 " "	5
192 " "	5
193 " "	5
196 " "	6
197 " "	9
200 " "	5

<u>ADDRESS</u>	<u>RESIDENTS</u>
200 Rath Drive	5
201 " "	6
204 " "	7
205 " "	4
208 " "	3
209 " "	5
213 " "	5
217 " "	2
221 " "	3
225 " "	4
229 " "	8
144 Meadow Lane	4
145 " "	4
148 " "	4
149 " "	5
152 " "	5
153 " "	7
156 " "	6
157 " "	10
160 " "	4
161 " "	4
164 " "	6
165 " "	5
168 " "	7
169 " "	5
172 " "	8
173 " "	4
176 " "	4
177 " "	6
181 " "	6
185 " "	5
188 " "	7
192 " "	5
193 " "	5
196 " "	6
197 " "	5
200 " "	5
201 " "	8
204 " "	6
205 " "	4
209 " "	6
221 " "	3
224 " "	3
225 " "	6
228 " "	4
229 " "	6
232 " "	6
233 " "	5
237 " "	2
241 " "	4
245 " "	4
249 " "	4
257 " "	2

<u>ADDRESS</u>	<u>RESIDENTS</u>	<u>ADDRESS</u>	<u>RESIDENTS</u>
117 Upper Afton Circle	5	104 Oak Knoll Plaza	5
113 "	7	100 "	5
109 "	6	108 "	6
105 "	6	112 "	9
		116 "	7
3001 Upper Afton Road	6	120 "	4
3004 "	4	124 "	5
3005 "	2		
3006 "	4	128 Willow Lane	4
3009 "	6	133 "	5
3017 "	3	129 "	8
3018 "	4	124 "	5
3019 "	3	125 "	4
3022 "	4	121 "	4
3025 "	5	120 "	4
		116 "	5
100 Ridge Drive	6	117 "	6
104 "	5	113 "	4
108 "	4	112 "	6
112 "	5	108 "	5
116 "	3	109 "	5
120 "	6	100 "	4
124 "	3	104 "	6
128 "	6	105 "	6
132 "	2		
136 "	7	164 Garbe Avenue	3
140 "	3	161 "	5
144 "	5	160 "	6
148 "	4	156 "	4
152 "	1	157 "	3
156 "	4	153 "	8
117 "	4	152 "	6
121 "	7	149 "	3
125 "	5	148 "	4
133 "	5	145 "	5
141 "	5	144 "	6
149 "	8	141 "	4
		140 "	2
108 Oak Knoll Drive	6	137 "	4
116 "	4	136 "	5
124 "	5	133 "	4
132 "	4	132 "	5
109 "	6	129 "	2
105 "	3	128 "	7
113 "	6	124 "	5
117 "	2	125 "	6
121 "	5	120 "	2
125 "	4	121 "	6
129 "	8	117 "	5
133 "	4	113 "	2
137 "	7	108 "	6
141 "	5	109 "	4
140 "	4	104 "	4
144 "	4	105 "	3
148 "		101 "	5

<u>ADDRESS</u>	<u>RESIDENTS</u>	<u>ADDRESS</u>	<u>RESIDENTS</u>
100 Garbe Avenue	7	Section 3	
104 Edgewood	5	NW $\frac{1}{4}$	6
105 "	4	SE $\frac{1}{4}$	30
109 "	5	SW $\frac{1}{4}$	4
113 "	3	Section 4	
117 "	5	NE $\frac{1}{4}$	2
108 "	3	NW $\frac{1}{4}$	59
121 "	8	SE $\frac{1}{4}$	5
112 "	2	SW $\frac{1}{4}$	13
116 "	5	Section 5	
125 "	8	NE $\frac{1}{4}$	67
120 "	4	NW $\frac{1}{4}$	3
129 "	6	SE $\frac{1}{4}$	0
133 "	3	SW $\frac{1}{4}$	10
124 "	4	Section 6	
128 "	6	NE $\frac{1}{4}$	0
137 "	4	NW $\frac{1}{4}$	-
132 "	3	SE $\frac{1}{4}$	6
141 "	4	SW $\frac{1}{4}$	34
136 "	5	Section 7	
145 "	6	NE $\frac{1}{4}$	5
149 "	4	NW $\frac{1}{4}$	7
140 "	4	SE $\frac{1}{4}$	3
153 "	5	SW $\frac{1}{4}$	7
157 "	5	Section 8	
152 "	8	NE $\frac{1}{4}$	5
161 "	5	NW $\frac{1}{4}$	1
156 "	4	SE $\frac{1}{4}$	9
160 "	6	SW $\frac{1}{4}$	36
165 "	5	Section 9	
169 "	7	NE $\frac{1}{4}$	2
164 "	6	NW $\frac{1}{4}$	5
173 "	5	SE $\frac{1}{4}$	10
168 "	6	SW $\frac{1}{4}$	16
177 "	6	Section 10	
172 "	4	NE $\frac{1}{4}$	24
181 "	8	NW $\frac{1}{4}$	19
176 "	8	SE $\frac{1}{4}$	11
185 "	7	SW $\frac{1}{4}$	3
193 "	6	Section 11	
197 "	3	NE $\frac{1}{4}$	13
201 "	7	NW $\frac{1}{4}$	2
		SE $\frac{1}{4}$	15
		SW $\frac{1}{4}$	15
Section I.		Section 12	
NE $\frac{1}{4}$	12	NE $\frac{1}{4}$	26
NW $\frac{1}{4}$	4	NW $\frac{1}{4}$	3
SE $\frac{1}{4}$	11	SE $\frac{1}{4}$	10
SW $\frac{1}{4}$	10	SW $\frac{1}{4}$	0
Section II			
NE $\frac{1}{4}$	-		
NW $\frac{1}{4}$	14		
SE $\frac{1}{4}$	9		
SW $\frac{1}{4}$	10		
Section 3			
NE $\frac{1}{4}$	11		

<u>ADDRESS</u>	<u>RESIDENTS</u>	<u>ADDRESS</u>	<u>RESIDENTS</u>
Section 13		Section 22	
NE $\frac{1}{4}$	10	SE $\frac{1}{4}$	12
NW $\frac{1}{4}$	12	SW $\frac{1}{4}$	6
SE $\frac{1}{4}$	18		
SW $\frac{1}{4}$	11	Section 23	
		NE $\frac{1}{4}$	3
Section 14		NW $\frac{1}{4}$	30
NE $\frac{1}{4}$	16	SE $\frac{1}{4}$	8
NW $\frac{1}{4}$	12	SW $\frac{1}{4}$	8
SE $\frac{1}{4}$	4		
SW $\frac{1}{4}$	7	Section 24	
		NE $\frac{1}{4}$	12
Section 15		NW $\frac{1}{4}$	0
NE $\frac{1}{4}$	31	SE $\frac{1}{4}$	14
SE $\frac{1}{4}$	7	SW $\frac{1}{4}$	11
NW $\frac{1}{4}$	1		
SW $\frac{1}{4}$	4	Section 25	
		NE $\frac{1}{4}$	0
Section 16		NW $\frac{1}{4}$	2
NE $\frac{1}{4}$	6	SE $\frac{1}{4}$	2
NW $\frac{1}{4}$	120	SW $\frac{1}{4}$	2
SE $\frac{1}{4}$	15		
SW $\frac{1}{4}$	5	Section 26	
		NE $\frac{1}{4}$	0
Section 17		NW $\frac{1}{4}$	5
NE $\frac{1}{4}$	17	SE $\frac{1}{4}$	8
NW $\frac{1}{4}$	0	SW $\frac{1}{4}$	3
SE $\frac{1}{4}$	7		
SW $\frac{1}{4}$	9	Section 27	
		NE $\frac{1}{4}$	9
Section 18		NW $\frac{1}{4}$	6
NE $\frac{1}{4}$	6	SE $\frac{1}{4}$	6
NW $\frac{1}{4}$	54	SW $\frac{1}{4}$	5
SE $\frac{1}{4}$	28		
SW $\frac{1}{4}$	22	Section 28	
		NE $\frac{1}{4}$	3
Section 19		NW $\frac{1}{4}$	3
NE $\frac{1}{4}$	7	SE $\frac{1}{4}$	2
NW $\frac{1}{4}$	16	SW $\frac{1}{4}$	5
SE $\frac{1}{4}$	3		
SW $\frac{1}{4}$	7	Section 29	
		NE $\frac{1}{4}$	24
Section 20		NW $\frac{1}{4}$	20
NE $\frac{1}{4}$	13	SE $\frac{1}{4}$	0
NW $\frac{1}{4}$	10	SW $\frac{1}{4}$	34
SE $\frac{1}{4}$	2		
SW $\frac{1}{4}$	4	Section 30	
		NE $\frac{1}{4}$	17
Section 21		NW $\frac{1}{4}$	16
NE $\frac{1}{4}$	2	SE $\frac{1}{4}$	22
NW $\frac{1}{4}$	4	SW $\frac{1}{4}$	4
SE $\frac{1}{4}$	21		
SW $\frac{1}{4}$	7	Section 31	
		NE $\frac{1}{4}$	28
Section 22		NW $\frac{1}{4}$	31
NE $\frac{1}{4}$	3	SE $\frac{1}{4}$	29
NW $\frac{1}{4}$	18	SW $\frac{1}{4}$	5

<u>ADDRESS</u>	<u>RESIDENTS</u>	<u>ADDRESS</u>	<u>RESIDENTS</u>
Section 32	44		
NE $\frac{1}{4}$	30		
NW $\frac{1}{4}$	20		
SE $\frac{1}{4}$	11		
SW $\frac{1}{4}$			
Section 33	6		
NE $\frac{1}{4}$	15		
NW $\frac{1}{4}$	23		
SE $\frac{1}{4}$	17		
SW $\frac{1}{4}$			
Section 34	26		
NE $\frac{1}{4}$	4		
NW $\frac{1}{4}$	4		
SE $\frac{1}{4}$	8		
SW $\frac{1}{4}$			
Section 35	2		
NE $\frac{1}{4}$	10		
NW $\frac{1}{4}$	6		
SE $\frac{1}{4}$	2		
SW $\frac{1}{4}$			
Section 36	3		
NE $\frac{1}{4}$	2		
NW $\frac{1}{4}$	2		
SE $\frac{1}{4}$	6		
SW $\frac{1}{4}$			
3221 Coachwood Circle	4		
3217 "	4		
3209 "	4		
3205 "	3		
124 Lamplight Circle	3		
120 "	3		
116 "	3		
108 "	3		
104 "	6		
3245 Steepleview Road	4		
3210 "	5		
3213 "	4		
3206 "	2		
3221 "	6		

TOTAL: 4,396

#18662

STATE OF MINNESOTA)
) ss.
COUNTY OF WASHINGTON)

HOWARD PAGEL, KENNETH WOLTERSTORFF and WILLIAM R. KRUEGER, being first duly sworn on oath say: That they took the census as indicated on the preceding eight (8) pages attached to the petition for incorporation of the Town of Woodbury as a Village; that said census was accurately taken; that the taking of said census was commenced on the 5 day of January, 1966, and concluded on the 24 day of January, 1966; that the statements contained in the petition are true to the best of the knowledge and belief of said census takers.

Howard Pagel
Howard Pagel

Kenneth Wolterstorff
Kenneth Wolterstorff

William R. Krueger
William R. Krueger

Subscribed and sworn to before me
this 27th day of April, 1966.

Lyle J. Eckberg
Lyle J. Eckberg
Wash. Co., Minn., Notary Public
My commission expires June 25, 1968

(Notarial Seal)