

"Up Where the Lakes Begin"

CITY OF WILLMAR

OFFICE OF THE CITY CLERK

MUNICIPAL AUDITORIUM
WILLMAR, MINNESOTA

CERTIFICATE OF CITY CLERK:

I, Einar H. Brogren, City Clerk of the City of Willmar, Kandiyohi County, Minnesota do hereby certify that the Ordinance hereto attached is a true and correct copy of Ordinance No. 407 (Annexation of Palm's Addition) passed and adopted by the City Council of the City of Willmar, on November 4, 1959.

Dated at Willmar, Minnesota, November 5, 1959.



City Clerk

(S E A L)

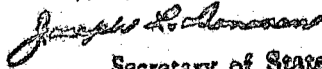
#14326
STATE OF MINNESOTA
DEPARTMENT OF STATE
FILED
NOV 5 1959

Secretary of State

(Special)

An Ordinance Annexing Certain Territory to the City of Willmar to be Known as PALM'S ADDITION TO THE CITY OF WILLMAR, and Extending the Corporate Limits to Include said Property.

(Adopted pursuant to Laws 1959, Chapter 686, Section 3, Subdivision 7, paragraph 4.)

Section 1. A petition has been filed with the City Council of the City of Willmar, Minnesota, by the sole owner or all of the owners in number of the following described real estate to have such land included within the City of Willmar, Minnesota, which land is described as follows:

That part of the Northwest Quarter (NW 1/4) of Section Twenty Two (22), Township One Hundred Nineteen (119), Range Thirty Five (35), described by metes and bounds as follows: Beginning at a point Five Hundred Twenty Eight (528) feet west and Thirty Three (33) feet south of the Northeast corner of the said Northwest Quarter (NW 1/4), thence south on a line parallel with the east line of the said Northwest Quarter (NW 1/4) a distance of Four Hundred Thirty Three (433) feet, thence west on a line parallel with the north line of the said Section Twenty Two (22), a distance of Two Hundred Forty Seven and five-tenths (247.5) feet, thence north on a line parallel with the east line of the said Northwest Quarter (NW 1/4) a distance of Two Hundred (200) feet, thence east on a line parallel with the north line of the said Section Twenty Two (22), a distance of One Hundred Ninety Seven and five-tenths (197.5) feet, thence north on a line parallel with the east line of the said Northwest Quarter (NW 1/4) a distance of Two Hundred Thirty Three (233) feet, thence east on a line parallel with the north line of the said Section Twenty Two (22) a distance of Fifty (50) feet to the point of beginning.

Section 2. The quantity of land embraced within the foregoing description, and bounded as described, is 1.4 acres.

Section 3. The City Council hereby determines:

- (1) That the annexation will be to the best interest of the City of Willmar, Minnesota, and of the territory affected;
- (2) That the territory described herein abuts upon the City and is so condition as properly to be subjected to City government.

Section 4. The corporate limits of the City are hereby extended to include the property described in Section 1 hereof, and the same is hereby annexed to and included in the City as effectually as if it had originally been a part thereof.

Section 5. The City Clerk is hereby directed to file certified copies of this Ordinance with the Minnesota Municipal Commission, the County Auditor of the County of Kandiyohi, and the Secretary of State of the State of Minnesota.

STATE OF MINNESOTA
DEPARTMENT OF STATE
FILED
NOV 30 1959
James K. Johnson
Secretary of State

14326
OD

Section 6. The said property, upon the taking effect of this Ordinance, as described in Section 1, having been heretofore platted, shall hereafter be known as "PALM'S ADDITION TO THE CITY OF WILLMAR".

Section 7. This Ordinance takes effect upon its passage and publication and the filing of the certified copies as directed herein.

Approved _____



Mayor

This Ordinance was given its first reading on October 7, 1959, the second reading on October 21, 1959, and the third and final reading on November 4, 1959. This Ordinance was published on November , 1959.

~~First Reading October 7, 1959~~

~~Second Reading October 21, 1959~~

~~Third Reading November 4, 1959~~

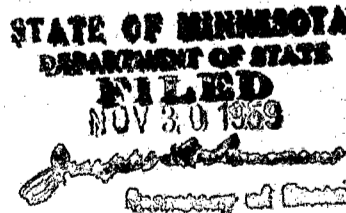

PLAT OF
PALM'S ADDITION TO THE CITY OF WILLMAR

33'

WILLMAR

AVENUE

33'



33'

528'

#14326

HALVERSON'S
ADDITION

INCLUDED

Outside Boundaries
150'

TENTH STREET WEST

50'

INCLUDED

NOT

83'

INCLUDED

383'

Outside Boundaries

71.75'

59.75'

66'



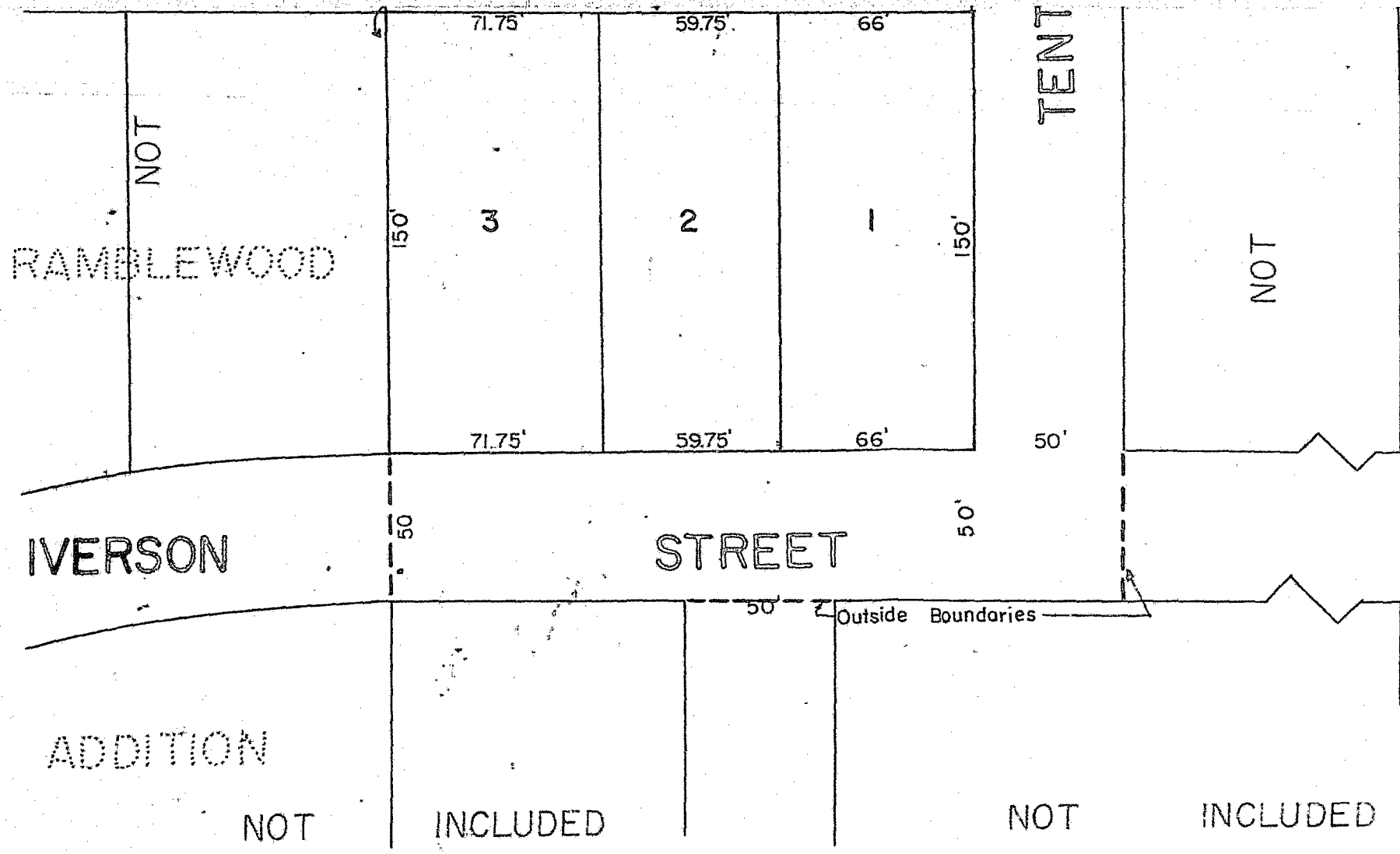

SCALE: 1"=50'

STATE OF MINNESOTA)
 COUNTY OF KANDIYOHI)

Know all men by these presents: That Andrew M. Goedert and Elizabeth Goedert, his wife; Alfred B. Swansson and Phyllis M. Swansson, his wife; Donald E. Palm and Doris Palm, his wife; E. Oscar Iverson and Elenora A. Iverson, his wife; and the First Federal Savings and Loan Association of Willmar, a corporation, being owners and proprietors of that part of the Northwest Quarter (NW1/4) of Section Twenty-two (22), Township One Hundred Nineteen (119), Range Thirty-five (35), described by metes and bounds as follows: Beginning at a point five hundred twenty-eight (528) feet west and thirty-three (33) feet south of the northeast corner of the said Northwest Quarter (NW1/4), thence south on a line parallel with the east line of the said Northwest Quarter (NW1/4) a distance of four hundred thirty-

corporation, being owners and proprietors of that part of the Northwest quarter (NW1/4) of Section Twenty-two (22), Township One Hundred Nineteen (119), Range Thirty-five (35), described by metes and bounds as follows: Beginning at a point five hundred twenty-eight (528) feet west and thirty-three (33) feet south of the northeast corner of the said Northwest quarter (NW1/4), thence south on a line parallel with the east line of the said Northwest Quarter (NW1/4) a distance of four hundred thirty-three (433) feet, thence west on a line parallel with the north line of the said Section Twenty-two (22) a distance of two hundred forty-seven and five-tenths (247.5) feet, thence north on a line parallel with the east line of the said Northwest Quarter (NW1/4) a distance of two hundred (200) feet, thence east on a line parallel with the north line of the said Section twenty-two (22) a distance of one hundred ninety-seven and five-tenths (197.5) feet, thence north on a line parallel with the east line of the said Northwest Quarter (NW1/4) a distance of two hundred thirty-three (233) feet, thence east on a line parallel with the north line of the said Section Twenty-two (22) a distance of fifty (50) feet to the point of beginning, have caused the same to be surveyed and platted as PALM'S ADDITION TO THE CITY OF WILLMAR, and do hereby donate and dedicate to the said City of Willmar for use as public roads forever, the avenues and streets shown on the plat.

In witness whereof the said individuals have signed these presents and the said Corporation has caused these presents to be executed by their proper officers and their corporate seal to be hereunto affixed this ___ day of _____, 19__.

In Presence of:

THE FIRST FEDERAL SAVINGS
 AND LOAN ASSOCIATION OF
 WILLMAR, MINNESOTA

By _____
 its President

By _____
 its Secretary

SEAL

STATE OF MINNESOTA)
)
 COUNTY OF KANDIYOHI)

On this ___ day of _____, 19__, before me, a Notary Public within and for said County, personally appeared Andrew M. Goedert and Elizabeth Goedert, his wife; Alfred B. Swansson and Phyllis M. Swansson, his wife; Donald E. Palm and Doris Palm, his wife; and E. Oscar Iverson and Elenora A. Iverson, his wife, to me personally known to be the persons who executed the foregoing instrument, and acknowledged the same to be their free act and deed.

Notary Public, Kandiyohi County, Minnesota
 My Commission expires _____, 19__.

STATE OF MINNESOTA)
)
 COUNTY OF KANDIYOHI)

STATE OF MINNESOTA)
COUNTY OF KANDIYOHI)

On this ___ day of _____, 19___, before me, a Notary Public, within and for said County, personally appeared Emil C. Lundquist and Doaine Bakken, to me personally known, who, being each by me duly sworn, did say that they are respectively, the President and the Secretary of the First Federal Savings and Loan Association of Willmar, Minnesota, the Corporation named in the foregoing instrument, and that the seal affixed to said instrument is the corporate seal of said corporation, and that said instrument was signed and sealed in behalf of said corporation by authority of its Board of Directors, and said Emil C. Lundquist and Doaine Bakken acknowledged said instrument to be the free act and deed of said corporation.

Notary Public, Kandiyohi County, Minnesota
My Commission expires _____, 19___.

STATE OF MINNESOTA)
COUNTY OF KANDIYOHI)

This is to certify: That I have surveyed and platted the property described in this plat as PALM'S ADDITION TO THE CITY OF WILLMAR: That the plat is a correct representation of said survey; That all distances are shown correctly thereon in feet and decimals of a foot; That the monuments for the guidance of future surveys have been correctly placed in the ground as shown in the plat; That the outside boundaries are correctly designated therein; That there are no wet lands or public highways to be shown in said plat other than as shown therein; That I am a Land Surveyor, Registered under Sections 326.02 to 326.16, Minnesota Statutes for 1941; That my Registration Number is 2185.

Subscribed and sworn to before me this ___ day of _____, 19___.

Notary Public, Kandiyohi County, Minnesota
My Commission expires _____, 19___.

Approved this ___ day of _____, 19___ by the City Planning Commission of the City of Willmar.

_____, Clerk

Approved this ___ day of _____, 19___.

_____, City Engineer

Approved as to form and execution this ___ day of _____, 19___.

_____, City Attorney

STATE OF MINNESOTA)
COUNTY OF KANDIYOHI)

The annexed plat of PALM'S ADDITION TO THE CITY OF WILLMAR was approved and accepted by the City Council of the City of Willmar at a regular meeting thereof, held this ___ day of _____, 19___.

_____, City Clerk