

# 11373  
C.D.

COUNTY OF RAMSEY  
STATE OF MINNESOTA

OFFICE OF

EUGENE A. MONICK COUNTY AUDITOR



JOHN P. KARTHEISER  
CHIEF DEPUTY

RAMSEY COUNTY COURT HOUSE  
SAINT PAUL 2  
MINNESOTA

February 14, 1951

Hon. Mike Holm  
Secretary of State  
State Capitol  
St. Paul, Minnesota

Dear Sir:

We are transmitting herewith a certified copy of the original document in the matter of the incorporation of the Village of "Arden Hills". The document consists of copies of the following:

The original petition, including the affidavit of three voters resident within the area for at least two years prior to the date of the petition.

The census list.

A map of the area.

The original resolution of the County Board setting the time for the Election and appointing three Judges of Election.

The original Notice and Proof of Posting.

The Certificate of the Judges of Election as to the result of the Election, and the affidavit of the Judges of Election.

We are also enclosing a duplicate copy of the aforesaid document, and will appreciate your acknowledgment of the receipt of this document thereon.

Yours very truly,

EUGENE A. MONICK, County Auditor

By *James D. Swan, Jr.*  
James D. Swan, Jr., Executive Secretary

STATE OF MINNESOTA  
DEPARTMENT OF STATE  
FILED  
FEB 14 1951  
*Miss Holm*  
Secretary of State

JDS:F

11373

OFFICE OF COUNTY AUDITOR )  
RAMSEY COUNTY, MINNESOTA ) ss

I, Eugene A. Monick, duly elected and qualified County Auditor in and for Ramsey County, Minnesota, do hereby certify that I have compared the hereto attached copies of the documents on the incorporation of the village of "Arden Hills" with the originals thereof on file in my office.

That the original petition was filed in my office on December 18, 1950.

That the original resolution was adopted by the Board of Ramsey County Commissioners and filed on January 15, 1951.

That Notice of Election and Proof of Posting was filed in my office on January 20, 1951.

That the Certificate of Inspectors and Affidavit of Inspectors was filed in my office on February 14, 1951.

I further certify that the said documents are true and correct copies of said originals and the whole thereof.

WITNESS My hand and official seal this 14th day of February, 1951.

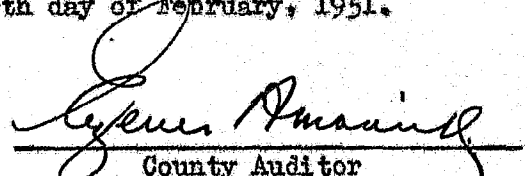
  
County Auditor  
Ramsey County, Minnesota

STATE OF MINNESOTA )  
  ) SS  
COUNTY OF RAMSEY )

William E. Kowalski, Karl E. McClung and Herman J. Doepner being first duly sworn upon oath depose and say that they are the Inspectors of Election appointed by the County Board of Ramsey County as set forth in the foregoing certificate of Inspectors and know the contents thereof and that the same is true of their own knowledge.

William E. Kowalski

Karl E. McClung

Herman J. Doepner

Subscribed and sworn to by  
William E. Kowalski, Karl E. McClung,  
and Herman J. Doepner, before me this  
15th day of February, 1951.

Walter J. Mack  
Notary Public, Ramsey County, Minnesota  
My Commission expires: Nov 13-1956

CERTIFICATE OF INSPECTORS

We, the undersigned Electors, resident in the area, having been appointed by the County Board to act as Judges of a Special Election held February 13, 1951, between the hours of 12:00 Noon and 9:00 p.m. at the "Mounds View Town Hall" located on the South side of State Trunk Highway No. 96, midway between Hamline Avenue and Lexington Avenue, on the proposed incorporation of the village of "Arden Hills", hereby certify as follows:

(1) That a map was prominently displayed during the election showing the boundaries of the affected territory, which are County Road "J", Lexington Avenue, County Road "D", and a line running North (N) from the Southwest (SW) corner of Southeast quarter (SE 1/4) of the Southeast quarter (SE 1/4) of Section 33, Township 30, Range 23, a distance of one and three-quarter (1 3/4) miles, thence West one-quarter (W 1/4) mile, thence North one-half (N 1/2) mile, thence East one-quarter (E 1/4) mile, thence North one-quarter (N 1/4) mile, thence West three-quarter (W 3/4) mile, thence North two and one-half (N 2 1/2) miles to County Road "J".

(2) Each voter was over twenty-one years of age, and a duly qualified voter within the territory described to be incorporated in the village of "Arden Hills" and has so resided therein for not less than thirty days, and in the State for not less than six months.

(3) That we have canvassed the ballots cast of such election and found:

TOTAL BALLOTS . . . . .	(739)
FOR THE INCORPORATION	
YES . . . . .	(139)
NO . . . . .	(100)

The National Flag was displayed on a suitable staff over the voting place during all the hours of voting.

WE FURTHER CERTIFY The above statement is true.

Wm. E. Kowalski  
Judge  
Karl W. Blum  
Judge  
Herman J. Kasper  
Judge

STATE OF MINNESOTA )  
                          ) SS  
COUNTY OF RAMSEY )

Milton Bohn, of said County, being duly sworn, deposes and says that on the 20th day of January, A. D. 1951, he posted a notice of which the annexed is a true and correct copy, at each of the following places, viz:

One on the Bulletin Board located on the Mounds View Town Hall, on Highway Ninety-six (96), between Snelling Ave. and Hamline Ave.; one on a tree located on the southeast corner of County Road F and Hamline Ave.; and one on Carl's Tavern located at Highway Ten (10) and Fifty-one (51); and being three of the most public places in said County of Ramsey.

Milton H. Bohn

Sworn and subscribed to before  
me this 20th day of January,  
A. D. 1951.

Charles J. Matzke  
Notary Public, Ramsey County, Minn.  
My commission expires: Jan 2nd 1956

CHARLES J. MATZKE  
Notary Public, Ramsey County, Minn.  
My commission expires Jan. 2, 1956.

**RECEIVED**  
JAN 20 1951  
EUGENE A. MONICK,  
Auditor, Ramsey County, Minn.

NOTICE

IN THE INCORPORATION OF VILLAGE OF  
ARDEN HILLS IN RAMSEY COUNTY, MINNESOTA

NOTICE OF ELECTION

I, Eugene A. Monick, County Auditor of said Ramsey County, do hereby certify that the attached petition asking that the territory therein described be incorporated into the village of "Arden Hills" and that an election be held for that purpose, was duly presented to the Board of County Commissioners of said Ramsey County at its meeting held in the Court House in the City of St. Paul, in said County on the 18th day of December, 1950; and that on the 15th day of January, 1951, the said Board of County Commissioners duly adopted a resolution directing the undersigned to give notice that an election would be held on the 13th day of February, 1951, and appointing William E. Kowalski, Carl E. McClung and Herman J. Doepner, residents of said territory, as electors to act as Judges of the said election.

NOW, THEREFORE, PURSUANT to the said resolution.

NOTICE IS HEREBY GIVEN to the voters of the territory described in the said petition that an election will be held at the "Mounds View Town Hall" located on the South side of State Trunk Highway No. 96, midway between Hamline Avenue and Lexington Avenue, on Tuesday, February 13, 1951, at which election the Voters of the said territory described in said petition may vote FOR or AGAINST the incorporation of said territory into the village of "Arden Hills" and the polls will be opened on said date at twelve (12) Noon and be closed at Nine O'Clock (9:00) p.m. of that day.

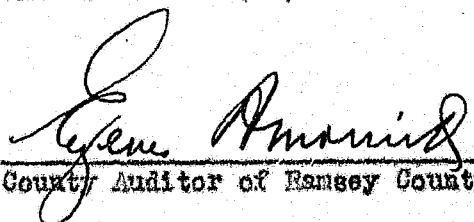
  
County Auditor of Ramsey County, Minn.

**COUNTY BOARD**File No. 1465  
Resolution  
No. 9-2567**County Auditor's Office**

St. Paul, Minn.,

January 15,

1945

The attention of the

is respectfully called to the following Resolution of the Board of County Commissioners of Ramsey County, Minnesota, adopted at the meeting held on the 15th inst.

By Commissioner Neeller

WHEREAS, A petition was, on December 18, 1950, filed with the Board of County Commissioners of Ramsey County, Minnesota, praying that the following described territory situated in the Township ofounds View, County of Ramsey, State of Minnesota, and bounded as follows:

Commencing at the Southwest (S.W.) corner of the Southeast quarter (S.E.  $\frac{1}{4}$ ) of the Southeast quarter (S.E.  $\frac{1}{4}$ ) of Section Thirty-three (33), Township Thirty (30), Range Twenty-three (23); thence North one and three-quarter (1- $\frac{3}{4}$ ) miles; thence West one-quarter (1/4) mile; thence North one-half (1/2) mile; thence East one-quarter (1/4) mile; thence North one-quarter (1/4) mile; thence West three-quarter (3/4) miles; thence North two and one-half mile (2-1/2) miles to Northwest (N.W.) corner of Section Nine (9), Township Thirty (30), Range Twenty-three (23); thence East two (2) miles to Northeast (N.E.) corner of Section Ten (10), Township Thirty (30), Range Twenty-three (23); thence South five (5) miles to Southeast (S.E.) corner of Section Thirty-four (34); Township Thirty (30), Range Twenty-three (23); thence West one and one-quarter (1-1/4) miles to point of beginning

be incorporated under the name of village of "Arden Hills" under the provisions of Minnesota Statutes 1949, Chapter 412.

NOW, THEREFORE, BE IT RESOLVED, that an election be held atounds View Town Hall, located on the South side of State Trunk Highway No. 96, midway between Hamline Ave. and Lexington Ave., on February 13, 1951, within the territory described in said petition, where the voters, duly qualified and actually residing within the said described territory may vote for or against said incorporation, and

BE IT FURTHER RESOLVED, that the polls for said election be opened between the hours of 12:00 Noon and 9:00 P.M., and

BE IT FURTHER RESOLVED, that William B. Nowelski, Karl F. McCaughey and Herman J. Roepner residents of said territory be and they are hereby appointed electors to act as Judges of said election and are directed to conduct same in accordance with the statutes in such case made and provided and insofar as practicable in accordance with the laws regulating the election of town officers, and

BE IT FURTHER RESOLVED, that Eugene A. Monick, County Auditor be and he is hereby directed to cause copies of the said petition together with a notice of said election to be posted in three public places within said territory.

EUGENE A. MONICK, County Auditor

By James D. Swain Deputy.

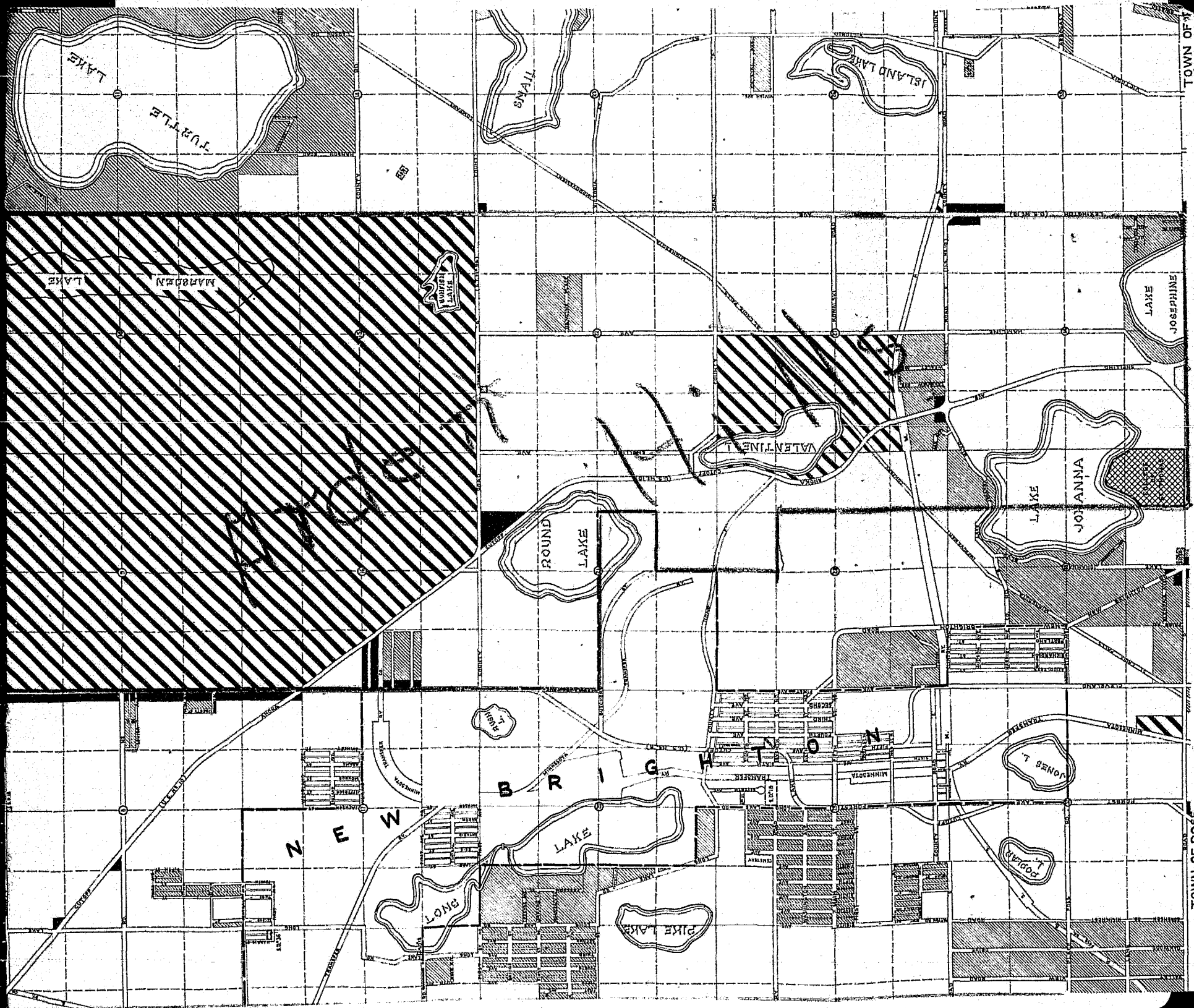

TOWN OF W

TOWNSHIP OF MOUNDS VIEW

TOWN OF ROSE

FURBYLE LAKE

SWAIL

ISLAND LAKE

MARREN LAKE

SWAIN LAKE

JOSEPHINE LAKE

VALENTIN LAKE

JOHANNA LAKE

ROUND LAKE

ROBERT LAKE

BRIGTON

JONES LAKE

LAKE

PIKE LAKE

LONG

NEW



P E T I T I O N

To the Board of County Commissioners, Ramsey County, State of Minnesota:

The undersigned hereby propose the incorporation as a village of the following territory, situated in the Township of Mounds View, County of Ramsey, State of Minnesota, and bounded as follows:

Commencing at the Southwest (S.W.) corner of the Southeast quarter (S.E.  $\frac{1}{4}$ ) of Southeast quarter (S.E.  $\frac{1}{4}$ ) of Section Thirty-three (33), Township Thirty (30), Range Twenty-three (23); thence North one and three-quarter ( $1\frac{3}{4}$ ) miles; thence West one-quarter ( $\frac{1}{4}$ ) mile; thence North one-half ( $\frac{1}{2}$ ) mile; thence East one-quarter ( $\frac{1}{4}$ ) mile; thence North one-quarter ( $\frac{1}{4}$ ) mile; thence West three-quarter ( $\frac{3}{4}$ ) miles; thence North two and one-half ( $2\frac{1}{2}$ ) miles to Northwest (N.W.) corner of Section Nine (9), Township Thirty (30), Range Twenty-three (23); thence East two (2) miles to Northeast (N.E.) corner of Section Ten (10), Township Thirty (30), Range Twenty-three (23); thence South five (5) miles to Southeast (S.E.) corner of Section Thirty-four (34), Township Thirty (30), Range Twenty-three (23); thence West one and one-quarter ( $1\frac{1}{4}$ ) miles to point of beginning, a plat of which is attached hereto, marked Exhibit "A" and made a part hereof, the territory proposed to be incorporated being that shown within the purple lines on said plat.

The undersigned represent as follows:

They are voters who have resided continuously in the area above described for at least two years immediately prior to the date of this petition. The area contains approximately five thousand two hundred eighty (5,280) acres. Included within the area are fifteen (15) plats duly and legally certified and filed in the Office of the Register of Deeds in and for Ramsey County, Minnesota. The platted property contains approximately five hundred ninety six (596) acres and consists of the following plats: Arden Hills No. 3; Hackney Park; Arden Hills No. 2; Arden Hills; Hackney Park Plat 2; Weck's Addition; Valentine Hills; Lakeshore Homesites; and Shady Oaks Addition; Josephine Hills, Lake Josephine Villas and Josephine Lake Park; Darsted Addition; Brook Land Acres and Mounds Center. Included within this area is a built-up and fully developed territory commonly known and described as the Twin Cities Ordinance Plant. The unplatted area is adjacent to the said plats.

The said platted areas are largely used for residential purposes. A large portion of the unplatted area is divided into small miscellaneous descriptions and has been so conveyed and is being largely used for residential purposes. Part of the westerly line of the said area is adjacent to the limits of the Village of New Brighton. The said platted area is largely developed as a suburban area to the said cities. The remainder is rapidly being platted, divided, and used for residential purposes. The entire area is used and developed so as to be properly subjected to village government.

A census of the resident population of the said area was accurately taken commencing December 10, 1950, and ending December 12, 1950, and the number of actual residents is 916. The proposed name of the said village is ARDEN HILLS.

Attached hereto and made a part hereof are the oaths of three of the said petitioners verifying the accuracy of the census and the truth of the statements made herein.

WHEREFORE, YOUR PETITIONERS REQUEST the Board of County Commissioners of Ramsey County to call an election for the determination of the proposed incorporation of the said village as provided by law.

December 18th, 1950.

<u>Name</u>	<u>Address</u>
W. M. Krautkramer	1524 County Road "G" West
K. R. McClung	4370 No. Snelling Ave.
W. G. Read	3162 Hamline Ave. N
D. M. Hustad	1445 Forest Lane
L. W. Neck	4444 N. Snelling Ave.
John J. Sexton	Hamline & Snelling - Lake Josephine
Herman Doepner	3401 N Snelling Ave.
Joseph Modasette	4097 No. Snelling Av.
Gerald Buetow	1433 Forest Lane
Mrs Geo. B. Peterson	4355 Highway 10
Mrs. J. J. Sexton	Snelling & Hamline
Evelyn Sexton	Snelling & Hamline - Lake Josephine
Kathryn Sexton	Snelling & Hamline - Lake Josephine
Mrs W. G. Read	3162 Hamline Ave. No.
C. A. Ingerson	Josephine Hills
Mrs. G. A. Ingerson	Josephine Hills
Mrs. Frederic F. Stoebe	Hamline and Snelling Ave. #3238
Mrs. Jane P. Bradford	Hamline Ave N - Lake Josephine
Vernon S. Smith	1175 Edgewater Road
Vince R. Lennon	3140 No. Hamline
Margaret Lennon	3140 No. Hamline
John Dooley	3136 No. Hamline
Elizabeth B. Dooley	3136 No. Hamline

<u>Name</u>	<u>Address</u>
G. M. Goble	3170 Hamline
Ralph W. Hunt	1450 E. Skiles Lane
Lottie M. Hunt	1450 W. Skiles Lane
Bethel P. Smith	1175 Edgewater Road
Ernest H. Mohland	1200 W. Edgewater Road
Earl S. Paquin	1203 Edgewater Road
Betty B. Phiffer	1151 Edgewater St.
Vernon K. Phiffer	1151 Edgewater St.
Wayne L. Sievers	3224 Lake Lane
June R. Sievers	3224 Lake Lane
John Briquet	Lake Lane
Cornelia Briquet	Lake Lane
Larry W. Kuehn	3199 North Lexington Ave.
Elvera E. Kuehn	3199 North Lexington Ave.
Evelyn Paquin	1203 Edgewater Road

Affidavit

Ralph W. Hunt , Vernon S. Smith , and  
Herman Doepner , being each duly sworn do severally depose  
and say, that they are voters who have resided continuously, for at least two  
years prior to the date of the foregoing petition, within the area proposed to  
be incorporated; that the census required by law to be taken as a basis for  
said petition was accurately taken commencing December 10th, 1950 and ending  
December 12th, 1950; and that the affiants have read the foregoing petition and  
know the contents thereof and that the statements made therein are true, and  
a copy of the census list is hereby attached and made a part hereof.

Ralph W. Hunt

Vernon S. Smith

Herman Doepner

Subscribed and sworn to before me  
this 18th day of December, 1950

D. D. Wozniak Notary Public

Hamsey County, Minnesota  
My Commission Expires Sept. 21, 1956

CENSUS

3611 N. Hamline Ave.	2	Forwarded	208
4097 Highway #10	2		
1412 W. Co. Rd. E	4		
1404 "	5	3645 N. Hamline	3
1400 "	4	3797 N. Hamline Ave.	2
1392 "	2	1445 Forest Lane	3
Co. Rd. E (W. Hamline)	2	3673 No. Hamline	4
3632 Lakeview	1	1434 Arden Place	4
3511 Siem Court	3	Engen Home "	5
1401 W. Co. Rd. E	3	1414 Arden Place	3
3265 Snelling No.	3	1433 Forest Lane	7
3401 "	1	1407 Forest Lane	4
3377 "	3	1401 Forest Lane	7
3421 "	3	3371 No. Snelling	2
1450 Skiles Lane W	2	1695 Valentine Ave.	3
1466 W. Skiles Lane	2	4087 No. Hwy. #10	3
3505 N. Ridgewood Rd.	3	1695 Valentine Ave.	3
3511 N. Ridgewood Rd.	4	Res. Betw. Hwy. 10	
1450 Arden Place	3	& Valentine Lake	2
3445 Glenarden Court	3		<u>263</u>
3438 "	2		
3426 "	4	Nazareth Hall	<u>245</u>
3415 "	2		
3420 "	3		
3430 "	5		508
1401 Skiles Lane	2		
1385 "	3		
1557 Oak Ave.	4		
1557 1/2 "	2		
1617 Johanna	5		
Jahanna Blvd.	2		
1616 "	1		
3464 Siem Court	2		
3615 Snelling No.	3		
1423 W. Co. Rd. E.	3		
3672 Snelling No.	2		
3631 Lakeview	2		
3626 Lakeview	4		
1622 Johanna Blvd.	4		
1628 Johanna Blvd.	2		
1632 "	2		
1634 "	2		
Snelling Ave. & Hwy. #10	2		
1467 W. Co. Rd. E	5		
1369 Forest Lane	4		
1385 "	4		
Snelling & #10	4		
1434 W. Co. Rd. E	2		
1426 "	4		
1420 "	4		
3632 Lakeview	2		
3614 No. Snelling	3		
1535 Johanna Blvd.	3		
1543 Oak Ave.	2		
1579 Oak Ave.	3		
1567 Oak Ave.	5		
1619 Johanna Blvd.	4		
(Glenarden Place			
Hjelm's res.	4		
1437 Arden Place	5		
1431 Arden Place	6		
1423 Arden Place	4		
1417 Arden Place	2		
1419 Arden Place	3		
1411 Arden Place	4		
1386 Skiles Lane	4		
3655 N. Hamline	9		
	<u>208</u>		

CENSUS

Co. Rd. D to Ingerson Road, and N. Lexington Ave. to Lake Josephine

L. P. Heiman residence	2
W. I. Heiman " 3255 N. Lexington	4
P. Hutten "	3
W. W. Culbert "	2
L. Gwynn "	3
R. W. Stolp " 3235 Lex. Ave.	3
L. W. Kuehn " Lex Ave. & Lake Josephine	3
John F. Grosskopf, Jr., res	2
J. A. Briguet "	3
W. L. Sievers "	4
V. K. Phiffer "	4
Mrs. E. Paquin "	2
Mrs. E. H. Bohland "	2
E. W. Fyten "	2
N. Richardson "	5
Henry Meisinger "	2
A. E. Neson "	3
W. J. Bachman "	3
Karl Nilsson "	2
J. J. Jwanouskos, Jr. "	9
Wm. Neamy "	3
Earl Sargeant (omit summer res. 4)	
Vernon S. Smith "	3

CENSUS

HAMLIN AVENUE, WEST SIDE OF LAKE JOSEPHINE, MOUNDS VIEW TWP.

Mrs. Emma Perkins	1
John Dooley & Mrs.	2
Miss Marie Hays	1
Mr. & Mrs. Vincent Lennon	2
Mr. and Mrs. Worth Read & dtr.	3
Dr. & Mrs. Clarence Goble	2
John J. Sexton residence	6
Mrs. Jane Bradford	1
Mr. & Mrs. Sawyer Rank & son & dtr	4
Edw. Eddy residence	3
Mrs. Kitty Lennon	1
F. F. Stoebe residence	4

INGERSON ROAD, NORTH SHORE LAKE JOSEPHINE:

J. E. Kraemer	1
Guy Bergren residence	2
Dr. Carl Ingerson "	4
Vincent Blake residence	3
Westly J. Kinne residence	2
Albert M. Olen residence	4
Adolph G. Sollom residence	3
Geo. Zilliox residence, C.Rd.E & Lexington	3
Joe Zilliox " Co.Rd.E.No.of Lex.	4
A. M. Cingura	1
Wm. Koalska → Koalska Rd.	1
Victor Sabilski, Circle X Ranch, "F" & Lexington	1
H. A. Christensen res., Hy 96 betw Hamline & Lexington	5
	<u>64</u> (forwarded)

Forwarded . . . . . 64

Kenneth Iust residence, Hwy. 96 Lexington  
& Hamline 3

G. T. Kenyon residence, Lexington Ave.  
near Co. Rd. F 2

W. Cummings residence, Lexington Ave.  
near Co. Rd. F 2

---

71



CENSUS

J. E. Johnson residence		Hamline Ave. N.	5
Norbert N. Tschida	"	"	4
Reid England	"	"	2
Anot Gale	"	"	2
J. Hernandez	"	"	3
Irving Giere	"	"	3
Mr. Bussing	"	"	7
Jim Streitz	"	"	5
Wm. Mickrine	"	"	4
R. K. Amundson	"	"	3
A. Kotzer	"	Amble Road	3
J. F. Medlin	"	Hamline Ave. No.	4
Ed. Bloom	"	"	1
Robert Manuel	"	"	4
Herbert Winkel		Amble Road	3
Oscar Amble	"	"	3
Evelyn Peterson	"	"	3
Leo J. LeMay	"	"	4
E. F. Wankauf	"	"	4
Bert Schutta	"	Hamline Ave. N.	3
Geo. Schutta	"	"	2
K. F. Goodchild	"	"	3
Geo. Kuehнке	"	"	2
Bert	"	"	1
Harold Grudnoske	"	Hwy. 96	5
S. R. Day	"	"	2
Wm. Krautkramer	"	"	4
Frank Schmitt	"	"	4

For warded. . .93

Brought forward		93
John Nesky residence	Hwy. #96	3
F. H. Gniel "	"	7
J. A. Gniel "	"	7
Geo. Turcutta "	Hwy. #8	8
Mike Kuchunske "		2
Frank Skiba "		1
Robert Kolberg		1
Mr. & Mrs. Mongoven		2
" Boreau		<u>2</u>
Mr. & Mrs. Roy Stormquist	Hwy. #10	2
Jack Grudnoske residence	"	1
Mr. George Peterson residence "		3
Mr. & Mrs. _____ "		13
Andrew Podlasek residence	Snelling Ave. N.	2
Lester Meck residence	"	2
Joe Podlasek "	"	5
K. R. McClung residence	"	4
Martin Malaska "		<u>4</u>
		162

CENSUS

HIGHWAY NO. 8

Rudy Delzer residence	6
L. L. Neuman "	4
R. B. Martinson #1018 Hwy. No. 8	5
K. S. McKay 1022 "	4
M. E. Danielson 1030 "	3
L. E. McCormick 1034 "	2
Capt. H.H. Jacobs #1038 "	4
J. T. Masterson 1042 "	4
Capt. H.M. Ingabritzen - 1046 Highway 8	4
F. S. Raushel 1050 Highway 8	3
Ralph H. Evans 1054 "	2
M. Berg 1058 "	5
Lt. Col. E.G. Miller - 1062 Highway 8	8
4 residences on Hwy 8 between Hys 96 & (10)	<u>20</u>
	74
<u>Hwy 96 East of Hwy 8:</u>	
Five residences occupied by 7, 4, 5, 6, 3 persons	25
Hwy 51, between Hwy 8 & 96, 7 residences occupied by 4, 4, 2, 4, 2, 4, 1 persons	<u>21</u>
	46

#  
15  
12  
03

SUMMARY OF CENSUS

Sheet 1 . . . . .	508
Sheet 2 . . . . .	69
Sheets 3 & 4 . . . . .	71
Sheets 5 & 6 . . . . .	162
Sheet 7 . . . . .	74
Sheet 7 . . . . .	<u>46</u>

TOTAL 930

ATTESTED BY STATE  
STATE OF MISSISSIPPI  
1930  
MISSISSIPPI  
STATE OF MISSISSIPPI

11373

INDEX TO VOLUMES

P. 2.

202	.....	1
203	.....	2
204	.....	3
205	.....	4
206	.....	5
207	.....	6
208	.....	7

202

203

STATE OF MINNESOTA  
 DEPARTMENT OF STATE  
 FILED  
 FEB 14 1951

*W. A. ...*  
 Secretary of State

202