



NOTICE OF ELECTION ON THE AMENDED  
PROPOSED INCORPORATION OF THE VILLAGE  
OF LAKELAND SHORES

NOTICE IS HEREBY GIVEN, that the election appointed by the Board of County Commissioners of the County of Washington, State of Minnesota at Mary Irene Kerr's Garage in the Town of Lakeland, County of Washington, State of Minnesota, on the 9th day of August, 1949 has been postponed by reason of the fact that an amended petition for the incorporation of the Village of Lakeland Shores has been submitted to, and approved by, the said county board, and

EASTFORD,

NOTICE IS HEREBY GIVEN, that an election on the said amended petition for the proposed incorporation of the Village of Lakeland Shores will be held at Mary Irene Kerr's Garage in the Town of Lakeland, County of Washington, State of Minnesota on the 26th day of August, 1949, between the hours of nine o'clock A. M. and eight o'clock P. M. for the purpose of voting upon the question as to whether or not the territory situated in the town of Lakeland in the County of Washington and State of Minnesota, and embraced within the following boundaries, to-wit:

Commencing at a point in the center line of State Highway 95 where said center line intersects the South line of Putnam Street on the plat of Lakeland City, according to the plat thereof on file and of record in the office of the Register of Deeds of Washington County, Minnesota; thence easterly on the South line of said Putnam Street to a point on said line where said line intersects the easterly line of Minnesota Street extended southeasterly; thence northwesterly on the easterly line of Minnesota Street in the plat of Stearn's Addition to Lakeland, according to the plat thereof on file and of record in the office of the Register of Deeds of Washington County, Minnesota and the extension thereof to the Northwest corner of Lot 10 of Block 6 of said plat; thence northeasterly on the North line of said Lot 10 and extension thereof to the Northwest corner of Lot 3 of said Block 6; thence northwesterly at right angles to said last mentioned line to the Northwest corner of Lot 6 of Block 6; thence northeasterly in a straight line to the Northwest corner of Lot 27 of Lakeland Bluffs, according to the plat thereof on file and of record in the office of the Register of Deeds of Washington County, Minnesota; thence northeasterly on the North line of said Lot 27 and extension thereof to the East line of the

State of Minnesota; thence northwesterly on the East line of the State of Minnesota to a point where the Northerly line of Fuller Street, in the plat of Lakeland City Addition, according to the plat thereof on file and of record in the office of the Register of Deeds of Washington County, Minnesota, extended westerly intersects the westerly boundary of the State of Minnesota; thence westerly on said last mentioned line, being the North line of said Fuller Street and westerly extension thereof, to the center line of State Highway 95; thence North on the center line of said highway 95 to the place of beginning.

shall be incorporated as a Village. Only voters residing within said territory shall be entitled to vote at said election.

Dated this 3rd day of August, 1949.

By order of the Board of County Commissioners of Washington County, Minnesota.

(SEAL)

Ray F. Johnson  
County Auditor of Washington County,  
Minnesota

c o p y

Wednesday, August 3rd, 1949

Board reconvened, With Chairman Whalen, Commissioners Wright, Brodeen, Pederson County Attorney Wm. T. Johnson and R. F. Johnson, County Auditor present.

An amended petition was presented to the Board for the Incorporation of the Village of Lakeland Shores.

Commissioner Wright offered the following resolution, and moved for its adoption. The motion was seconded by Commissioner Pederson and the roll being called was unanimously adopted.

RESOLVED, By the Board of County Commissioners of the County of Washington in the State of Minnesota, that the amended petition presented to said Board by ten or more resident voters of that certain territory in the Town of Lakeland, in the County of Washington, and State of Minnesota, which amended petition is verified on the 2nd day of August, 1949 by Elsie A. Smisek, Georginia Distel and Mary Irene Kerr praying for the incorporation of said territory described in said amended petition, under the name of "VILLAGE OF LAKE LAND SHORES" be and the same is hereby approved.

IT IS FURTHER RESOLVED, That an election be held in and for said territory on the 26th day of August, 1949 between the hours of 9:00 o'clock a. m. and 8:00 o'clock p. m. at Mary Irene Kerr's Garage in Lakeland Township, County of Washington and State of Minnesota, being within said territory for the purpose of submitting to the voters of and within said territory, described in said amended petition, the question as to whether or not the said territory should be incorporated.

IT IS FURTHER RESOLVED, That Elsie A. Smisek, Georginia Distel and Mary Irene Kerr, three resident voters of the said territory, be and they are hereby appointed inspectors to act as Judges of said election, and that they conduct the same so far as practicable in accordance with the laws regulating the election of Village officers.

IT IS FURTHER RESOLVED, that the ballot to be used at said election shall be substantially as follows:

"BALLOT  
SPECIAL ELECTION  
August 26th, 1949.

-----  
To Determine the Question of Incorporation the  
Territory Herein Described as the Village of  
"LAKELAND SHORES"

-----  
(Description of territory proposed to be incorporated)

For Incorporation

yes (  )  
no (  )

(If in favor of incorporation, put an "X" mark in the square  
opposite the word "Yes". If not in favor of incorporation  
put an "X" in the square opposite the word "No".)

IT IS FURTHER RESOLVED, That the notice of said election be substan-  
tially as follows:

"NOTICE OF ELECTION"  
ON THE AMENDED PROPOSED INCORPORATION OF THE  
VILLAGE OF LAKELAND SHORES

NOTICE IS HEREBY GIVEN, that the election appointed by the Board of  
County Commissioners of the County of Washington, State of Minnesota at  
Mary Irene Kerr's Garage in the Town of Lakeland, County of Washington,  
State of Minnesota, on the 9th day of August, 1949 has been postponed by  
reason of the fact that an amended petition for incorporation of  
the Village of Lakeland Shores has been submitted to, and approved by,  
the said county board, and therefore,

NOTICE IS HEREBY GIVEN, that an election on the said amended petition  
for the proposed incorporation of the Village of Lakeland Shores will be  
held at Mary Irene Kerr's Garage in the Town of Lakeland, County of  
Washington, State of Minnesota on the 26th day of August, 1949 between the  
hours of nine o'clock a. m. and eight o'clock p. m. for the purpose of  
voting upon the question as to whether or not the territory situated in  
the town of Lakeland in the County of Washington and State of Minnesota, and  
embraced within the following boundaries, to-wit:

Commencing at a point in the center line of State Highway 95 where said center line intersects the South line of Putnam Street on the plat of Lakeland City, according to the plat thereof on file and of record in the office of the Register of Deeds of Washington County, Minnesota; thence Easterly on the South line of said Putnam Street to a point on said line where said line intersects the Easterly line of Minnesota Street extended Southeasterly; thence northwesterly on the Easterly line of Minnesota Street in the plat of Stearn's Addition to Lakeland, according to the plat thereof on file and of record in the office of the Register of Deeds of Washington County, Minnesota and the extension thereof to the Northwest corner of Lot 10 of Block 8 of said plat; thence Northeasterly on the North line of said Lot 10 and extension thereof to the Northwest corner of Lot 3 of said Block 8; thence Northwesterly at right angles to said last mentioned line to the Northwest corner of Lot 6 of Block 8; thence northeasterly in a straight line to the Northwest corner of Lot 27 of Lakeland Bluffs, according to the plat thereof on file and of record in the office of the Register of Deeds of Washington County, Minnesota; thence Northeasterly on the North line of said Lot 27 and extension thereof to the East line of the State of Minnesota; thence Southwesterly on the East line of the State of Minnesota to a point where the Northerly line of Fuller Street, in the plat of Lakeland City Addition, according to the plat thereof on file and of record in the office of the Register of Deeds of Washington County, Minnesota extended Easterly intersects the Easterly boundary of the State of Minnesota; thence Westerly on said last mentioned line, being the North line of said Fuller Street and Easterly extension thereof, to the center line of State Highway 95; thence North on the center line of said Highway 95 to the place of beginning.

shall be incorporated as a Village. Only voters residing within said territory shall be entitled to vote at said election.

Dated this 3rd day of August, 1949.

By order of the Board of County Commissioners of Washington County, Minnesota.

SEAL

ROY F. JOHNSON  
County Auditor of Washington  
County, Minnesota.

Approved:

H. C. WHALEN, Chairman  
Washington County Board  
of Commissioners."

IT IS FURTHER RESOLVED, That the Inspectors herein named to conduct said election, cause to be prepared the necessary aforesaid ballots, and ballot boxes and other supplies for said election, and to do whatever is necessary to conduct said election according to law.

IT IS FURTHER RESOLVED, That the Sheriff of Washington County, Minnesota, be and he is hereby directed to post the aforesaid notice of said election together with a copy of said petition attached thereto, in three public places within the boundaries described in said notice, not more than thirty (30) nor less than twenty (20) days prior to said date of said election.

Adopted August 3rd, 1949.

BOARD OF COUNTY COMMISSIONERS  
OF WASHINGTON COUNTY, MINNESOTA

H. C. WHALEN  
Chairman, County Board.

Attest:

ROY F. JOHNSON, AUDITOR  
Washington County, Minn.

On motion the Board adjourned.

BOARD OF COUNTY COMMISSIONERS  
*H. C. Whalen*  
Chairman

Attest:

*Roy F. Johnson*  
County Auditor

AMENDED PETITION FOR THE INCORPORATION OF THE  
VILLAGE OF LAKELAND SHORES

TO THE BOARD OF COUNTY COMMISSIONERS OF THE COUNTY OF  
WASHINGTON, IN THE STATE OF MINN. SOTA:

We, the undersigned, being we, or more, of the voters residing within the territory hereinafter described, and proposed to be incorporated as a village, and situated in the Town of Lakeland in the County of Washington and State of Minnesota, do hereby respectfully petition your Honorable Board and allegos:

(1) That all of your petitioners are legal voters of and in the territory hereinafter described, and reside in said territory, and have resided therein continuously for a period of at least two years prior to the date of this amended petition.

(2) That all of your petitioners are the same petitioners who originally petitioned your Honorable Board on the 27th day of June, 1949 for the incorporation of the village of Lakeland Shores, which said petition was approved by your Honorable Board on the 5th day of July, 1949.

(3) That all of your petitioners now desire to amend said petition heretofore filed by eliminating therefrom that part of the real estate described in the original petition lying northerly of the following described lines:

Commencing at the Northwest corner of Lot 10, Block 8 of Stearn's Addition to Lakeland, according to the plat thereof on file and of record in the office of the Register of Deeds of Washington County, Minnesota; thence Northeasterly on the North line of said Lot 10, Block 8, extended Northeasterly to the Northwest corner of Lot 3, Block 8; thence Northwesterly at right angles to said last described line to the Northwest corner of Lot 5, Block 8 of said addition; thence Northeasterly in a straight line to the Northwest corner of Lot 27 of Lakeland Bluffs Addition, according to the plat thereof on file and of record in the office of the



Register of Deeds of Washington County, Minnesota;  
thence Northeastly on the Northerly line of said  
Lot 27 to the St. Croix River.

(h) That your petitioners respectfully petition your  
Honorable Board to approve the following described territory  
for the incorporation of which, as a village, this amended  
petition is made, all of which territory lies within the  
boundaries contained in the original petition, the amended  
description being as follows, to-wit:

Commencing at a point in the center line of State  
Highway 95 where said center line intersects the  
South line of Putnam Street on the plat of Lakeland  
City, according to the plat thereof on file and of  
record in the office of the Register of Deeds of  
Washington County, Minnesota; thence Easterly on the  
South line of said Putnam Street to a point on said  
line where said line intersects the Easterly line of  
Minnesota Street extended Southeastly; thence North-  
westerly on the Easterly line of Minnesota Street in  
the plat of Stearn's addition to Lakeland, according  
to the plat thereof on file and of record in the office  
of the Register of Deeds of Washington County, Minnesota  
and the extension thereof to the Northwest corner of  
Lot 10 of Block 6 of said plat; thence Northeastly  
on the North line of said Lot 10 and extension thereof  
to the Northwest corner of Lot 3 of said Block 6; thence  
Northwesterly at right angles to said last mentioned  
line to the Northwest corner of Lot 6 of Block 6; thence  
Northeastly in a straight line to the Northwest corner  
of Lot 27 of Lakeland Bluffs, according to the plat  
thereof on file and of record in the office of the  
Register of Deeds of Washington County, Minnesota; thence  
Northeastly on the North line of said Lot 27 and ex-  
tension thereof to the East line of the State of Minne-  
sota; thence Southwesterly on the East line of the State  
of Minnesota to a point where the Northerly line of  
Fuller Street, in the plat of Lakeland City Addition,  
according to the plat thereof on file and of record  
in the office of the Register of Deeds of Washington  
County, Minnesota, extended Easterly intersecting the Easterly  
boundary of the State of Minnesota; thence Westerly  
on said last mentioned line, being the North line of  
said Fuller Street and Easterly extension thereof, to  
the center line of State Highway 95; thence North on  
the center line of said Highway 95 to the place of  
beginning.

(5) That the territory embraced within said boundaries is contiguous to the State line between the State of Minnesota and the State of Wisconsin, ~~to-wit~~ ~~to-wit~~; that the said territory contains 175 acres more or less, all of which has been platted into lots and blocks; the plats of which have been duly and legally certified according to the laws of the State of Minnesota, and have been filed for record in the office of the Register of Deeds of the County of Washington, in the State of Minnesota.

(6) That no part of said territory is embraced in any incorporated village in the State of Minnesota; that hereto attached and made a part hereof is a map or plat of said territory, marked "Exhibit A" and showing in red thereon the territory above described, and proposed to be incorporated.

(7) That the territory embraced within the aforesaid boundaries contains a resident population of not more than 10,000 inhabitants, and <sup>not</sup> less than 50 inhabitants.

(8) That your petitioners heretofore, to-wit, on and between the 23rd day of June, 1949, and the 24th day of June, 1949, caused to be taken a census of the resident population of said territory, and ascertained and determined by the taking of said census that the said territory contains a resident population of 73 inhabitants, who are actual residents within said territory.

(9) That the name which is proposed to be given to the said territory which is hereby proposed to be incorporated is the "village of Leland Shores."

(10) That this <sup>amended</sup> petition is made for the purpose

of having an election held to determine whether or not the said territory shall be incorporated as a village under the name aforesaid.

WHEREFORE, Your petitioners pray:

(1) That your Honorable Board approve said Amended petition, and that it fix a time and place for holding an election within said territory at which the question of the said proposed incorporation of the said territory as a village shall be submitted and voted upon.

(2) That it cause notice of said election to be published and posted, according to law, and cause ballots to be prepared and three inspectors of election to be appointed who shall act as Judges of said election, and that your Honorable Board take such other steps and proceedings as the law requires, to the end that it may be determined whether or not said territory shall be incorporated.

WILLIAM E. DISTEL

H. V. IMHOLTE

GEORGINA DISTEL

ANGELINE MILLER

DOROTHY HERRY

ESTHER SHOCKEY

FRANCIS E. BERG

LUCILLE A. IMHOLTE

MARY IRENE KERR

COURTNEY V. KERR

MARY A. QUINN

MAXINE MARY BACHTLE

WALTER E. BACHTLE

CHAS MILLER

WALTER J. JERRY

EDWARD C. DISTEL



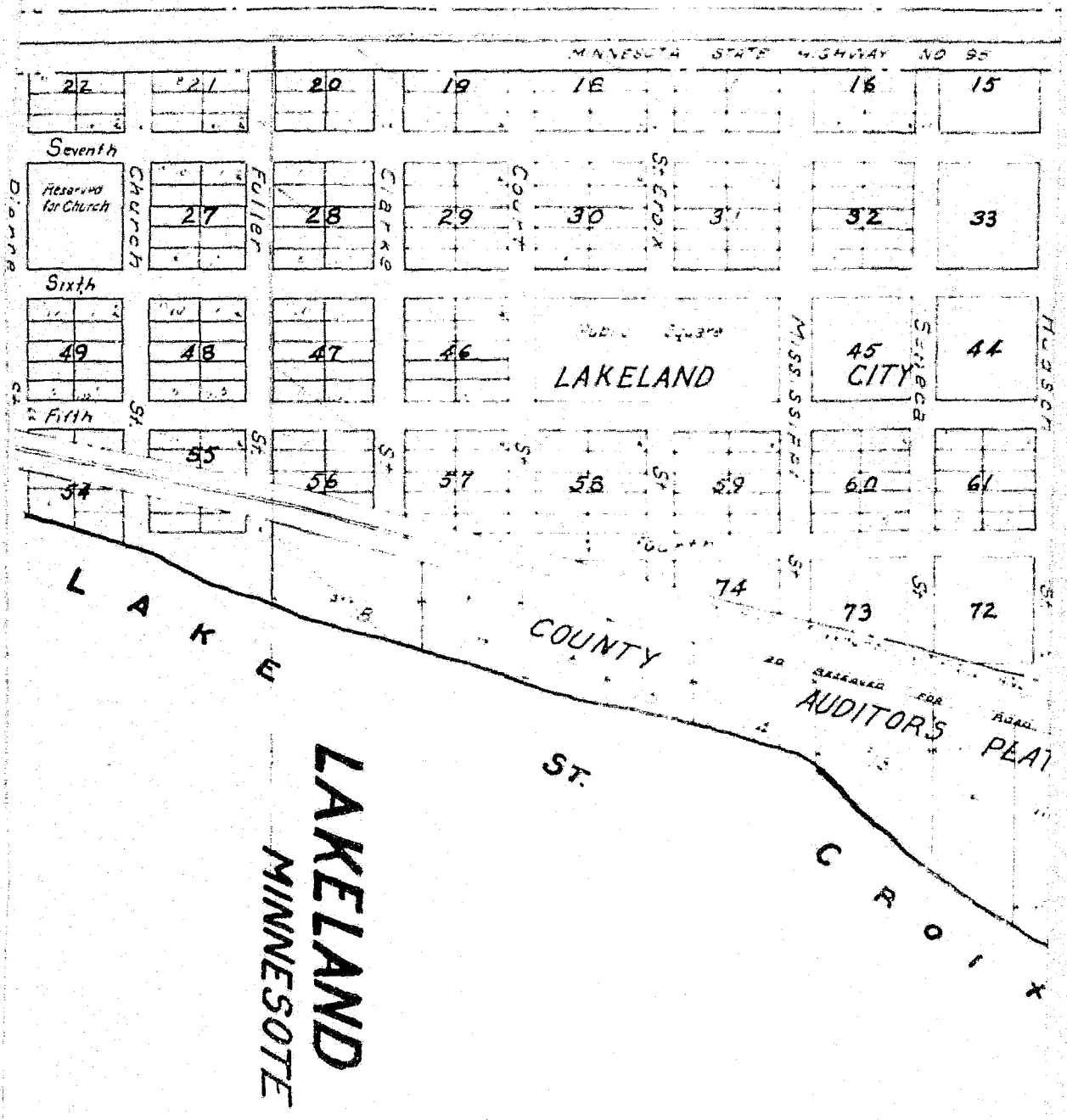

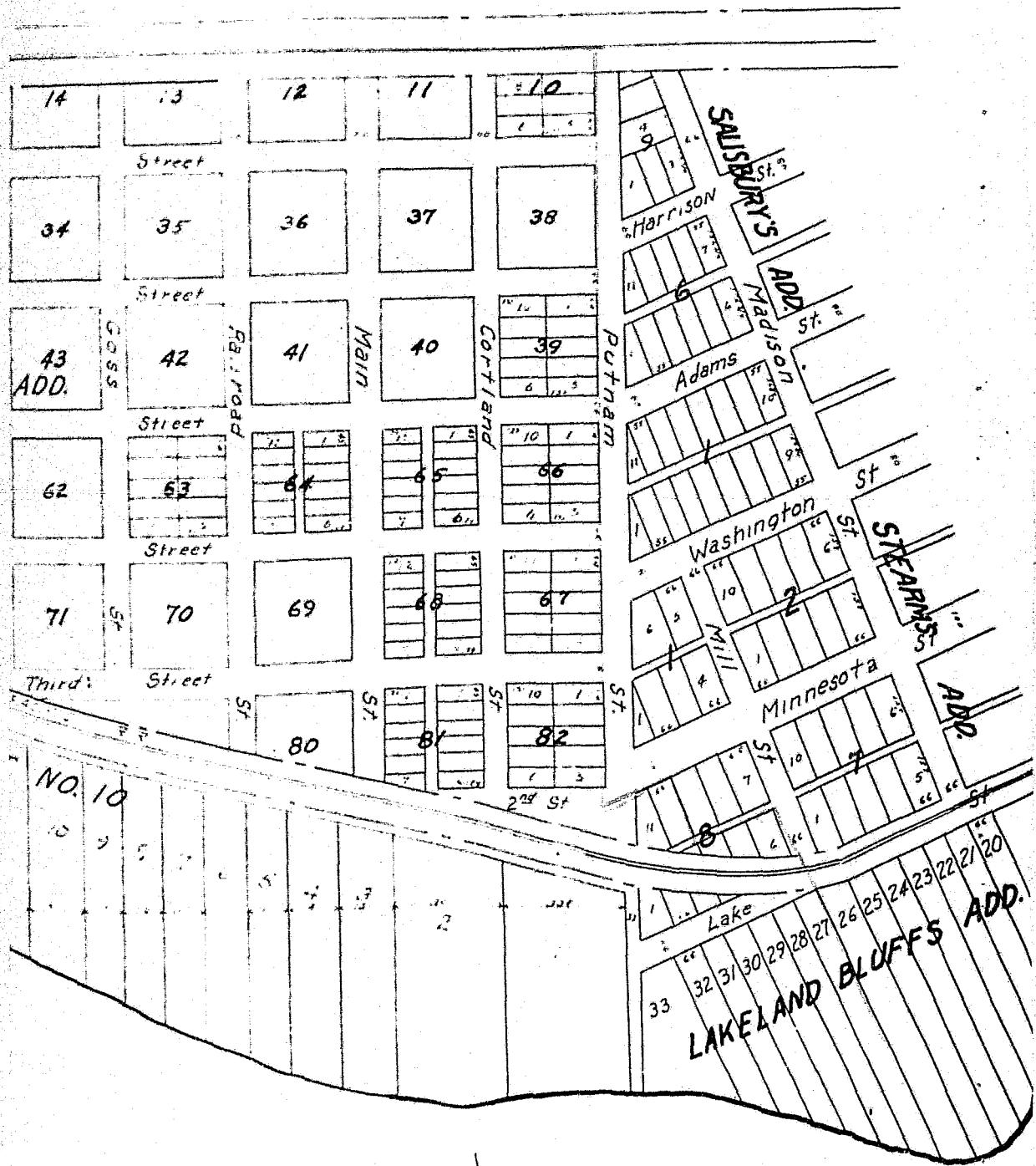

PETITION FOR THE INCORPORATION OF THE  
VILLAGE OF LAKELAND SHORES

TO THE BOARD OF COUNTY COMMISSIONERS OF THE COUNTY OF  
WASHINGTON, IN THE STATE OF MINNESOTA:

We, the undersigned, being ten, or more, of the voters residing within the territory hereinafter described, and proposed to be incorporated as a village, and situated in the Town of Lakeland in the County of Washington and State of Minnesota, do hereby respectfully petition your Honorable Board and alleges:

(1) That all of your petitioners are legal voters of and in the territory hereinafter described, and reside in said territory, and have resided therein continuously for a period of at least two years prior to the date of this petition.

(2) That the said territory for the incorporation of which as a village this petition is made, is contained within the following boundaries:

Commencing at a point in the center line of State Highway 95 where said center line intersects the South line of Putnam Street on the plat of Lakeland City, according to the plat thereof on file and of record in the office of the Register of Deeds of Washington County, Minnesota; thence Easterly on the South line of said Putnam Street to a point on said line where said line intersects the Easterly line of Minnesota Street extended Southeasterly; thence Northwesterly on the Easterly line of Minnesota Street in the plat of Stearn's Addition to Lakeland, according to the plat thereof on file and of record in the office of the Register of Deeds of Washington County, Minnesota and the extension thereof to the South line of Madison Street on said last mentioned plat; thence Northeasterly on the South line of said Madison Street extended Northeasterly to the shores of the St. Croix River; thence Southwesterly along the shore of the St. Croix River to a point where the Northerly line of Fuller Street, in the plat of Lakeland City, extended Easterly intersects the shore of St. Croix River; thence Westerly on the North line of said Fuller Street and extensions thereof to the center line of State Highway 95; thence Northerly on the center line of Highway 95 to the place of beginning.

(3) That the territory embraced within said boundaries is contiguous to the State line between the State of Minnesota and the State of Wisconsin, to-wit, the St. Croix River; that the said territory contains 185 acres more or less, all of which has been platted into lots and blocks; the plats of which have been duly and legally certified according to the laws of the State of Minnesota, and have been filed for record in the office of the Register of Deeds of the County of Washington, in the State of Minnesota.

(4) That no part of said territory is embraced in any incorporated village in the State of Minnesota; that hereto attached and made a part hereof is a map or plat of said territory, marked "Exhibit A" and showing in red thereon the territory above described, and proposed to be incorporated.

(5) That the territory embraced within the aforesaid boundaries contains a resident population of not more than 10,000 inhabitants, and less than 50 inhabitants.

(6) That your petitioners heretofore, to-wit, on and between the 23rd day of June, 1949, and the 24th day of June, 1949, caused to be taken a census of the resident population of said territory, and ascertained and determined by the taking of said census that the said territory contains a resident population of 73 inhabitants, who are actual residents within said territory.

(7) That the name which is proposed to be given to the said territory which is hereby proposed to be incorporated is the "Village of Lakeland Shores."

(8) That this petition is made for the purpose



of having an election held to determine whether or not the said territory shall be incorporated as a village under the name aforesaid.

WHEREFORE, Your petitioners pray:

(1) That your Honorable Board approve said petition, and that it fix a time and place for holding an election within said territory at which the question of the said proposed incorporation of the said territory as a village shall be submitted and voted upon.

(2) That it cause notice of said election to be published and posted, according to law, and cause ballots to be prepared and three inspectors of election to be appointed who shall act as Judges of said election, and that your Honorable Board take such other steps and proceedings as the law requires, to the end that it may be determined whether or not said territory shall be incorporated.

Mary A. Quinn

Courtney V. Kerr

Mary Irene Kerr

Walter E. Bachtle

Maxine Mary Bachtle

Esther H. Shockey

Francis E. Benz

Edward C. Distel

Dorothy J. Jerry

Chas Miller

Angeline Miller

Walter J. Jerry

William E. Distel

Georgina Distel

H. V. Imholte

Lucille A. Imholte

State of Minnesota  
County of Washington ss:

Elsie A. Smisek, Georgia Distel  
and Mary Irene Kerr, being first duly sworn, on  
oath deposes and says each for himself and herself:

That the census of the inhabitants of the territory  
embraced within the boundaries set forth in the foregoing  
petition was accurately taken, within the dates specified  
in said petition, and that the statements made in the  
foregoing petition are true.

Mrs. Elsie A. Smisek

Mrs. Georgia Distel

Mary Irene Kerr

Subscribed and sworn to before me  
this 27<sup>th</sup> day of June, 1949.

Notary Public, Washington  
~~Ramsey~~ County, Minn.

My commission expires,

JOHN E. HARRIGAN, Notary Public  
Washington County, Minn.  
My Commission Expires March 3, 1952

STATE OF MINNESOTA  
DEPARTMENT OF STATE  
FILED  
NOV 16 1949

*Walter A. ...*  
Secretary of State.

CERTIFICATE AND RETURN

STATE OF MINNESOTA     )  
                                  { SS  
COUNTY OF WASHINGTON )

We, the undersigned, certify and return that we are two of the duly appointed inspectors and judges of the election for voting upon the question of incorporating the Village of Lakeland Shores; that pursuant to the resolution of the County Board of Commissioners of the County of Washington, State of Minnesota, an election was held on the 26th day of August, 1949, between the hours of 9:00 A.M. and 8:00 P.M. at Mary Irene Kerr's garage in the Township of Lakeland, said County of Washington; that we have canvassed the ballots cast at said election on the question of incorporating the territory described in the ballots as a village under the name of Village of Lakeland Shores; that there were thirty-nine (39) voters who registered at said election; that there were thirty-nine (39) ballots cast at said election; that twenty-nine (29) ballots were cast in favor of incorporating said territory as a village and there were ten (10) ballots cast against incorporating said territory as a village.

That this certificate and return is made pursuant to Minnesota Statutes Annotated, Section 412.05.

IN WITNESS WHEREOF, we have hereunto set our hands this 25th day of October, 1949.

Elsie G. Souick  
Marjorie Distel



NOTICE OF ELECTION BY THE AMENDED  
PETITION FOR THE INCORPORATION OF THE VILLAGE  
OF LAKELAND SHORES

NOTICE IS HEREBY GIVEN, that the election appointed by the Board of County Commissioners of the County of Washington, State of Minnesota at Mary Irene Herr's Garage in the Town of Lakeland, County of Washington, State of Minnesota, on the 9th day of August, 1949 has been postponed by reason of the fact that an amended petition for the incorporation of the Village of Lakeland Shores has been submitted to, and approved by, the said county board, and

HEREFORE,

NOTICE IS HEREBY GIVEN, that an election on the said amended petition for the proposed incorporation of the Village of Lakeland Shores will be held at Mary Irene Herr's Garage in the Town of Lakeland, County of Washington, State of Minnesota on the 26th day of August, 1949, between the hours of nine o'clock A. M. and eight o'clock P. M. for the purpose of voting upon the question as to whether or not the territory situated in the town of Lakeland in the County of Washington and State of Minnesota, and embraced within the following boundaries, to-wit:

Commencing at a point in the center line of State Highway 95 where said center line intersects the south line of Putnam Street on the plat of Lakeland City, according to the plat thereof on file and of record in the office of the Register of Deeds of Washington County, Minnesota; thence easterly on the south line of said Putnam Street to a point on said line where said line intersects the easterly line of Minnesota Street extended southeasterly; thence northwesterly on the easterly line of Minnesota Street in the plat of Stearn's addition to Lakeland, according to the plat thereof on file and of record in the office of the Register of Deeds of Washington County, Minnesota and the extension thereof to the northwest corner of Lot 10 of Block 6 of said plat; thence northeasterly on the north line of said Lot 10 and extension thereof to the northwest corner of Lot 3 of said Block 6; thence northwesterly at right angles to said last mentioned line to the northwest corner of Lot 6 of Block 6; thence northwesterly in a straight line to the northwest corner of Lot 27 of Lakeland Bluffs, according to the plat thereof on file and of record in the office of the Register of Deeds of Washington County, Minnesota; thence northwesterly on the north line of said Lot 27 and extension thereof to the east line of the

State of Minnesota; thence Southwesterly on the East line of the State of Minnesota to a point where the Northerly line of Fuller Street, in the plat of Lakeland City Addition, according to the plat thereof on file and of record in the office of the Register of Deeds of Washington County, Minnesota, extended Easterly intersects the Easterly boundary of the State of Minnesota; thence Easterly on said last mentioned line, being the North line of said Fuller Street and Easterly extension thereof, to the center line of State Highway 95; thence North on the center line of said Highway 95 to the place of beginning.

shall be incorporated as a Village. Only voters residing within said territory shall be entitled to vote at said election.

Dated this 23<sup>rd</sup> day of August, 1949.

By order of the Board of County Commissioners of Washington County, Minnesota.

(SEAL)

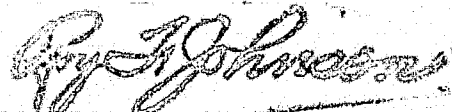

County Auditor of Washington County,  
Minnesota

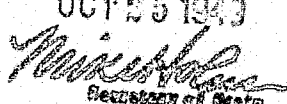
10954  
STATE OF MINNESOTA  
DEPARTMENT OF STATE  
FILED  
OCT 25 1949  
  
Secretary of State