

DISASTER SERVICES FACILITY



The Salvation Army has developed plans and laid the groundwork for a new Emergency Disaster Services (EDS) warehouse, centrally located on its headquarters property in Roseville. The facility is being proposed to strengthen and improve our ability to respond to natural and man-made disasters, and to further our longstanding mission to serve those affected by disaster and in immediate need.

EDS WAREHOUSE SPECIFICATIONS

- ✦ Total space: 38,720 square feet
- ✦ Warehouse storage: 25,000 square feet
- ✦ 4,400 sq.ft. commercial kitchen to produce 9,000 meals daily
- ✦ Large walk-in freezer and refrigerator storage
- ✦ Indoor parking and staging for EDS canteens
- ✦ Loading dock for delivery of donations and supplies
- ✦ Estimated cost: \$12 million

EDS WAREHOUSE BENEFITS

This project will create a disaster response hub to provide rapid responses to both natural and man-made disasters with improved efficiency.

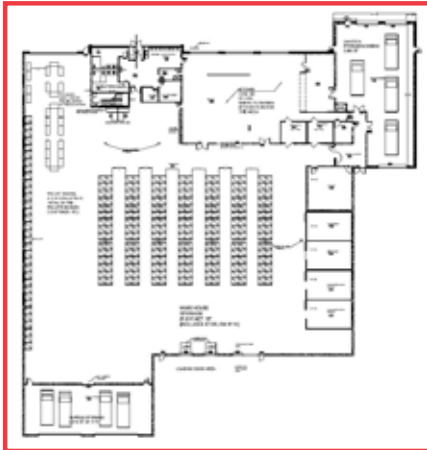

Location: The warehouse is strategically located to serve the entire state of Minnesota, allowing for organized and immediate responses, alleviating logistical challenges that often follow a major disaster.

Storage: The facility will provide ample space for safe storage and rapid distribution, delivering

immediate access to critical supplies and resources, including food, water, blankets, first aid, and other life-saving supplies.

Kitchen: A critical component of the facility is an industrial scale kitchen that will produce thousands of meals a day, providing proper nutrition to both dedicated disaster workers and survivors.

Mission: The Salvation Army has a longstanding history of helping during times of need, and this facility will further our mission of compassion and service, as well as strengthen the resilience of all our communities in the years ahead.

Support: There is no facility in Minnesota that currently offers the immediate access to material and supplies at the scale to be offered by this new Salvation Army warehouse. While \$2 million of the total project cost has already been secured through a grant from Lilly Foundation, there is a clear public interest and benefit to the State of Minnesota in providing modest public funds for the project.