

HIGHWAY 169 / ELM CREEK BLVD RECONSTRUCTION PROJECT

IMPROVED SAFETY, JOB CREATION, AND TRANSIT ACCESS

US HIGHWAY 169/ELM CREEK BOULEVARD. For almost four decades, the City of Maple Grove has been in the process of planning development of the nearly 2,000-acre area known as the Gravel Mining Area (GMA). The GMA is generally located in the northwest quadrant of I-94 and US Hwy 169. This area is served by two regional interchanges: I-94 / Hemlock Lane and US Hwy 169 / Elm Creek Boulevard (CSAH 130). The US Hwy 169 and Elm Creek Boulevard (CSAH 130) interchange is located along the east side, with Elm Creek Boulevard playing an important role as an east-west transportation corridor extending through the GMA. The current interchange has insufficient geometrics for current traffic causing long delays. To address existing area operational and safety issues and accommodate new development, the city is planning for the continued transformation of the area, which includes the proposed interchange improvements to enhance freight mobility and provide for inter-community connectivity.

In order to complete the interchange modifications, the City of Maple Grove is working with Hennepin County and MnDOT to complete the design, environmental documents, public involvement, and secure the necessary funding. The total costs for these improvements is estimated at \$19.3 million. As with many future transportation projects, funding remains the largest hurdle to completing the US Hwy 169/Elm Creek Boulevard (CSAH 130) interchange reconstruction project. City staff submitted an application to pursue Metropolitan Council 2022 Regional Solicitation funding in the summer of 2022, and was recently awarded \$7 million in funding. The City of Maple Grove along with their local partners (Hennepin County and MnDOT) are now working to close the remaining \$12.3 million funding gap to make this important project a reality.

During the 2023 session, the City of Maple Grove is requesting \$12.3million in transportation funding for the US Hwy 169/Elm Creek Boulevard (CSAH 130) interchange reconstruction project.

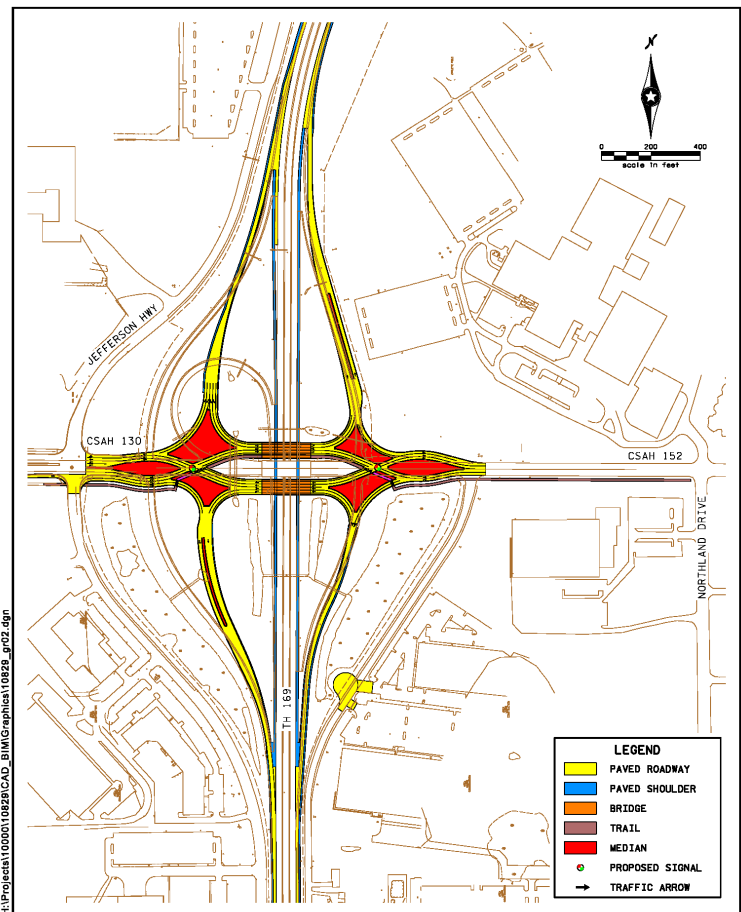

Diverging Diamond Interchange
TH 169 & Elm Creek Blvd Interchange Reconstruction
City of Maple Grove, Minnesota

Figure 2