

# Commons Park

6249 - 7TH STREET NE

**PARK TYPE:** COMMUNITY PARK  
**SIZE:** 23-ACRES  
**SPECIAL USES:** SLEDDING HILL

## DESCRIPTION:

Commons Park is the City's most popular park and includes a rentable shelter, hockey rinks, warming house, playground, volleyball courts, tennis courts, basketball court, sledding hill, ballfields, and turf fields used for football and soccer. Commons Park is well-used for recreation programming, athletic groups, and active play and adjoins the Fridley Middle School with combined recreational spaces.



## EXISTING PARK FEATURES:



**PLANNING BACKGROUND:**

A Concept Plan for Commons Park was initially created that removed the existing baseball and softball fields (shown below) and included more flexible turf space with a central winter recreation area and splash pad. During the community engagement it was determined that it was highly desired to keep the baseball field due to the current athletic needs and its relation to the school sites for joint programming.

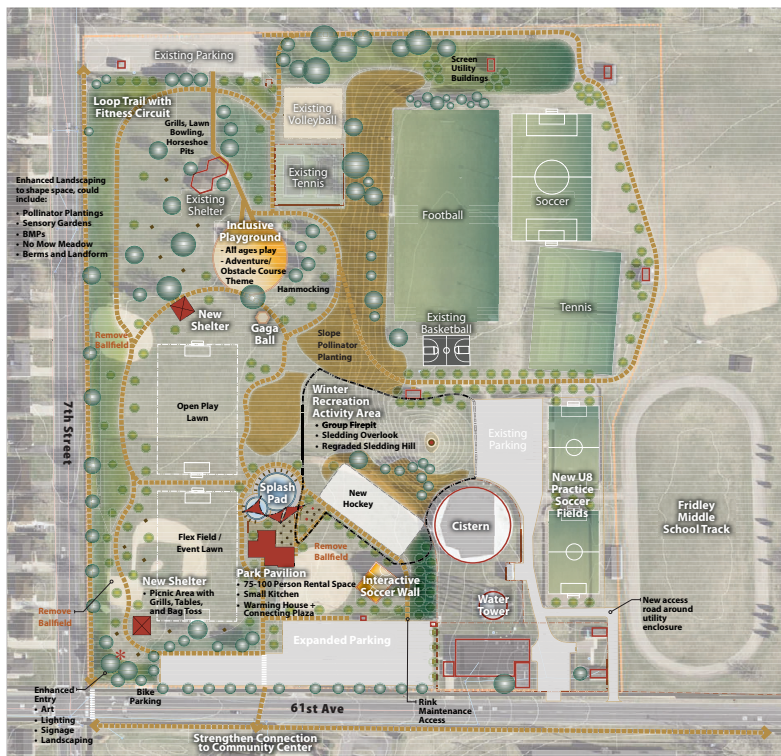

**COMMONS PARK PLANNING FRAMEWORK A** DRAFT January 2020

**RECOMMENDATIONS - YOUTH AND PLAY:**

General recommendations include improving and replacing existing amenities with some reorganization to improve overall function, accessibility and user satisfaction while still meeting the needs of programmed athletics by keeping the primary baseball field. New amenities are identified to meet current demands and trends, as well as to expand upon four-season recreation. Coordination and partnership with the school district will be necessary for some of the recommendations shown on school property and necessary for a balance of recreational amenities.

Recommendations include:

- Integration of winter activities within a central location with an improved sledding hill and relocated paved hockey rink for multi-season use with optimal N-S orientation
- Community pavilion building with meeting room, outdoor fire pit, gathering spaces and restrooms
- Inclusive playground with a focus on unique and challenging equipment meeting a broad range of ages and abilities
- Loop trails for improved connectivity within the park
- Reorganization and improved athletic fields for greater function and flexibility
- Addition of splash pad with adjoining seating plaza with shade
- Expansion of picnic spaces and picnic shelters
- Addition of dedicated pickleball court complex (includes removal of two existing tennis courts)
- Improved and expanded parking
- Expanded volleyball courts
- Replace existing basketball court

**PRIORITY LEVEL:**



This is a popular destination park that also serves a large neighborhood service area containing high density and low income populations and provides a broad range of outdoor recreational amenities for varying user groups and therefore is ranked high.

Estimate of Probable Costs is a range of \$8.5 to \$12 million for base preferred improvements and an additional \$1.8 to \$2.6 million for deferred or alternate improvements.





# Fridley Park Concepts - Commons Park

Fridley, Minnesota  
 December 9, 2021 WSB Project number: 016927-000

